

PHILLIPS

KEYPLAN

CONSULTANT



PROFICIENT ENGINEERING
6991 Peachtree Industrial Blvd Building 700
Peachtree Corners, Georgia 30092
404.333.9789
PROJECT # 110289

SEAL



ISSUE & REVISION RECORD

#	DATE	DESCRIPTION
1	06.10.2019	30% DESIGN REVIEW SET
2	08.15.2019	90% REVIEW SET
3	08.23.2019	PERMIT SET

This document is © Phillips Partnership, PC and is considered an Instrument of Service and is solely for use with respect to the project as indicated herein. All rights reserved. This document may not be reproduced without the prior written consent of Phillips Partnership, PC.

PROJECT

**Fairfield
BY MARRIOTT
INN & SUITES**

DAWSONVILLE, GEORGIA

PROTOTYPE VERSION 2016
REV 7.12.21.16

4 STORY, 92 UNITS
w/ INDOOR POOL

**FAIRFIELD
DAWSON FOREST ROAD
DAWSONVILLE, GA
30534**

CLIENT

RIMROCK COMPANIES
10000 RIVERSIDE AVE
SUITE 32201
JACKSONVILLE, FL 32204

PHILLIPS JOB NUMBER 1972101

ISSUE DATE 08/23/2019

DRAWN BY/CHECKED BY SA MR

DRAWING TITLE
**FLOOR PLAN LEVEL 1 -
SANITARY & STORM**

SHEET NUMBER

P-1.0

5901 PEACHTREE DUNWOODY RD.
BUILDING A, SUITE 450
ATLANTA, GEORGIA 30328

PHILLIPS PART. COM 770-394-1616

- KEYNOTES
- 1 2" V DN
 - 2 4" S DN
 - 3 2" S DN
 - 4 3" V DN
 - 5 4" EST DROP IN EXTERIOR WALL & DISCHARGE TO EXTERIOR @ 12" AFG WITH DOWNSPOUT NOZZLE (DSN-L)
 - 6 6" EST DROP IN EXTERIOR WALL & DISCHARGE TO EXTERIOR @ 12" AFG WITH DOWNSPOUT NOZZLE (DSN-L)
 - 7 ROUTE WATER HEATER INTAKE AND EXHAUST VENTS UP & OVERHEAD, MINIMIZE ELBOWS AND INSTALL IN STRICT ACCORDANCE WITH MANUFACTURER'S VENTING REQUIREMENTS AND RECOMMENDATIONS
 - 8 WATER HEATER MANUFACTURER'S CONCENTRIC SIDEWALL VENT TERMINATION KIT (SEE DETAIL), INSTALL IN STRICT ACCORDANCE WITH MANUFACTURER'S VENTING REQUIREMENTS AND RECOMMENDATIONS
 - 9 2" PD DN & DISCHARGE INTO LAUNDRY TRENCH WITH AIR GAP
 - 10 2" PD DN & DISCHARGE INTO LAUNDRY TRENCH WITH AIR GAP
 - 11 INSTALL DRAIN THROUGH BY HIGH MARK, ABOVE FLOOR, WITH HINGED U/D, LINT SCREEN AND SIDE OUTLET
 - 12 4" S AV FROM DRAIN THROUGH TO 4" S DN, 2" V UP
 - 13 3" ST & 3" EST DN FROM ROOF DRAINS TO 3" ST S EST STACK
 - 14 1" CONDENSATE RISER, CONNECT CONDENSATE FROM MFR WATER DOOR, OFFSET RISER ON & DISCHARGE INTO FL DRAIN WITH AIR GAP
 - 15 3" ST DN
 - 16 3" EST DISCHARGE OVERHEAD OUT OF CANOPY WITH DOWNSPOUT NOZZLE (DSN-L)
 - 17 3" ST & 3" EST STACK
 - 18 4" ST STACK
 - 19 6" ST DN
 - 20 4" EST DN THROUGH ROOF @ 12" AFG

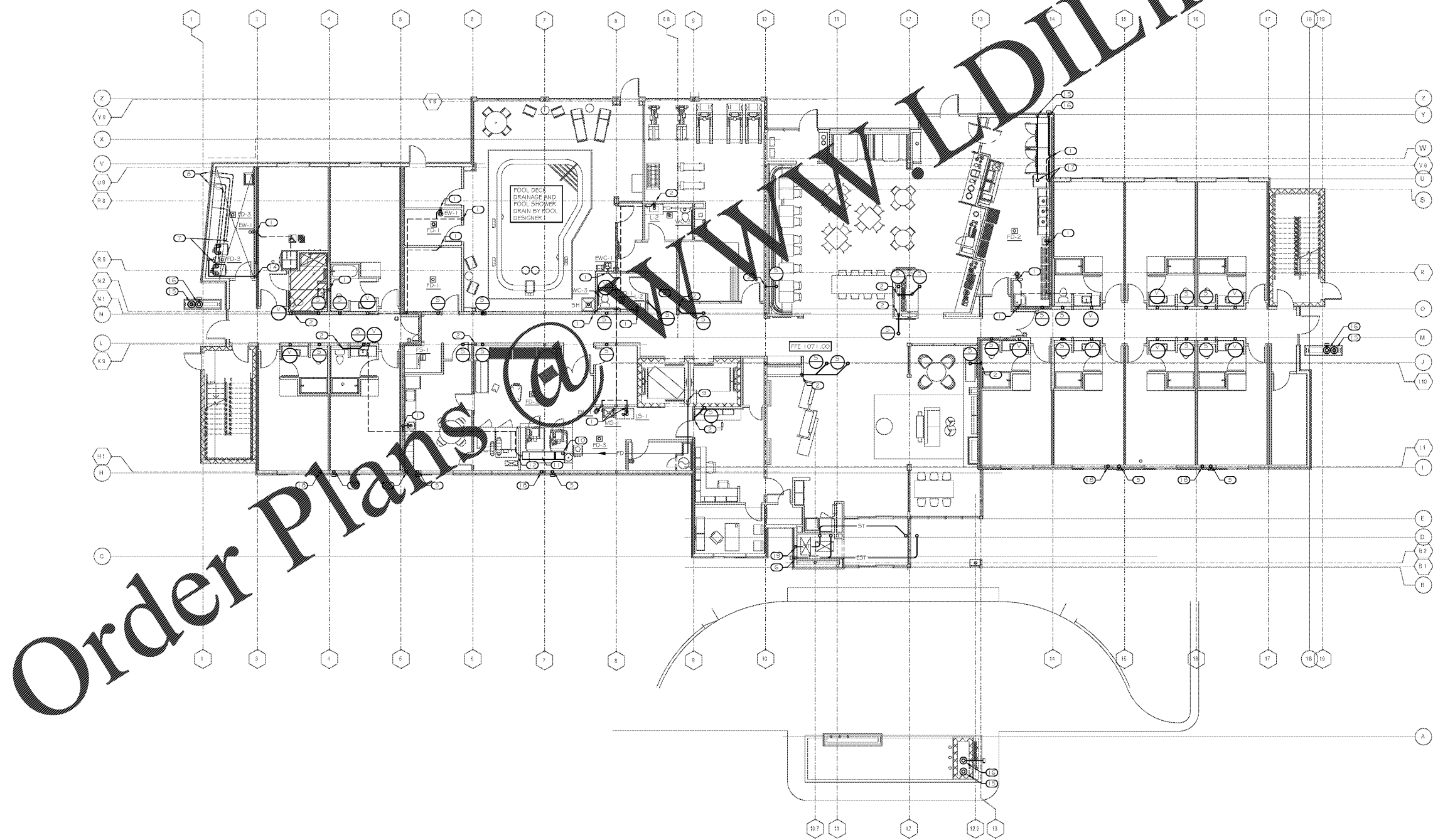

1 FLOOR PLAN - LEVEL 1 - SANITARY & STORM
P-1.0 1/8" = 1'-0"