

PHILLIPS

KEYPLAN

CONSULTANT



PROFICIENT ENGINEERING  
6901 Peachtree Industrial Blvd Building 700  
Peachtree Corners, Georgia 30092  
404.330.9750  
PROJECT # 119288

SEAL



ISSUE & REVISION RECORD

#	DATE	DESCRIPTION
06	06.10.2019	30% DESIGN REVIEW SET
08	08.15.2019	90% REVIEW SET
08	08.23.2019	PERMIT SET

This document is ©Phillips Partnership, PC and is considered an Instrument of Service and is solely for use with respect to the project as indicated herein. All rights reserved. This document may not be reproduced without the prior written consent of Phillips Partnership, PC.

PROJECT

**Fairfield**  
BY MARRIOTT  
INN & SUITES  
DAWSONVILLE, GEORGIA

PROTOTYPE VERSION 2016  
REV 7.12.21.16

4 STORY, 92 UNITS  
w/ INDOOR POOL

FAIRFIELD  
DAWSON FOREST ROAD  
DAWSONVILLE, GA  
30534

CLIENT

RIMROCK COMPANIES  
10000 RIVERSIDE AVE  
SUITE 32201  
JACKSONVILLE, FL 32204

PHILLIPS JOB NUMBER 1972101

ISSUE DATE 08/23/2019

DRAWN BY/CHECKED BY AT/RK

DRAWING TITLE

FLOOR PLAN LEVEL 3 -  
POWER

SHEET NUMBER

**E-1.3**

5901 PEACHTREE DUNWOODY RD.  
BUILDING A, SUITE 450  
ATLANTA, GEORGIA 30328

PHILLIPSPART.COM 770-394-1816

GENERAL NOTES

REFER TO ARCHITECTURAL REFLECTED CEILING PLAN FOR EXACT LOCATIONS OF ALL CEILING MOUNTED DEVICES.

ALL RECEPTACLES SHALL BE GROUNDED AS REQUIRED BY ARTICLE 250-146.

REFER TO ENLARGED PLANS FOR ADDITIONAL GUESTROOM INFORMATION.

FOR GUESTROOM CIRCUITS IN EXCESS OF 100, UPSIZE HOMERUN AS FOLLOWS:

- 100'-200' #10
- GREATER THAN 201' #8

KEYNOTES

1 LOCATE HOUSE PHONES 12" FROM DOOR U.L.O., 44" AFF. HOUSE TELEPHONE LOCATION AND REQUIREMENTS TO BE COORDINATED WITH OWNER/ARCHITECT.

2 POWER FOR FIRE SMOKE DAMPERS. SEE MECHANICAL DRAWINGS FOR ADDITIONAL REQUIREMENTS, TYPICAL.

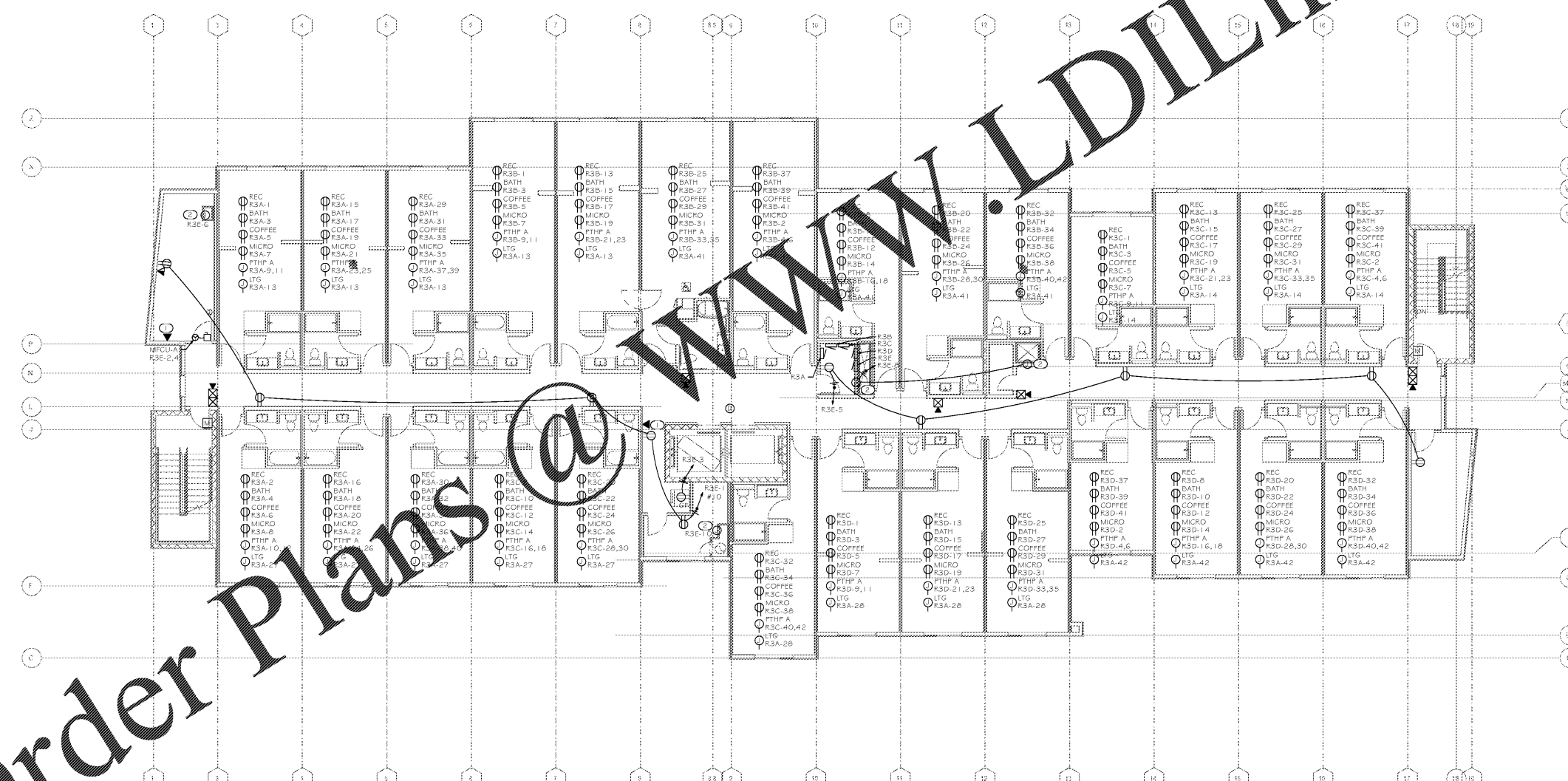

Order Plans @

WWW.LDILine.com