



PHILLIPS

KEYPLAN

CONSULTANT

SEAL

ISSUE & REVISION RECORD

| # | DATE | DESCRIPTION |
|---|------|-------------|
| | | |
| | | |
| | | |
| | | |
| | | |
| | | |
| | | |
| | | |
| | | |
| | | |
| | | |
| | | |
| | | |
| | | |
| | | |
| | | |
| | | |
| | | |
| | | |
| | | |

PROJECT

Fairfield
BY MARRIOTT
INN & SUITES

DAWSONVILLE, GEORGIA

PROTOTYPE VERSION 2016
REV 7 12-21-16

4 STORY, 92 UNITS
w/ INDOOR POOL

FAIRFIELD
DAWSON FOREST ROAD
DAWSONVILLE, GA
30534

CLIENT

RIMROCK COMPANIES
10000 RIVERSIDE AVE
SUITE 32201
JACKSONVILLE, FL 32204

PHILLIPS JOB NUMBER 1972101

ISSUE DATE 08/23/2019

DRAWN BY/CHECKED BY ZS / JU

DRAWING TITLE

'A2' KING SUITE
GUESTROOM PLANS

SHEET NUMBER

A-6.9

5901 PEACHTREE DUNWOODY RD.
BUILDING A, SUITE 450
ATLANTA, GEORGIA 30328

PHILLIPSPART.COM 776-384-1616

REFERENCE NOTES

- A. REFER TO DESIGN STANDARDS "GUESTROOM" CHAPTER FOR MAIN REQUIREMENTS RELATED TO THIS SHEET ARCHITECT IS RESPONSIBLE FOR DESIGNING PROJECT IN ACCORDANCE WITH THE LISTED DESIGN STANDARDS.
- B. REFER TO INTERIOR DESIGN SPECIFICATION MANUAL - VISUAL DECOR MAP TO PROPERLY SELECT INTERIOR FINISHES, ARTWORK AND OPTIONAL ITEMS FOR ALL GUESTROOM TYPES.
- C. REFER TO STC DIAGRAMS FOR ACOUSTIC REQUIREMENTS FOR PARTITIONS BETWEEN GUESTROOMS AND AT PUBLIC SPACE ADJACENCIES.

GENERAL NOTES

- 1. DIMENSIONS ARE TO FACE OF PARTITION UNLESS NOTED OTHERWISE. INCLUDE MINIMUM CLEAR DIMENSIONS.

CRITERIA NOTES

CRITERIA NOTES ARE SHOWN CATEGORIZED BY DISCIPLINE AND SHOULD BE INTERPRETED TO APPLY TO MORE THAN ONE DISCIPLINE. FOR EFFICIENCY, NOTES ARE ONLY SHOWN UNDER ONE-PRINCIPAL DISCIPLINE. CONSULTANT'S SHALL FAMILIARIZE THEMSELVES WITH ALL CRITERIA NOTES.

- ARCHITECTURE:
 - A1 LOCATE OPERABLE SASH ON EXTERIOR WALLS. PTAC UNIT SEE WALL PROFILE DETAILS AND WALL DETAIL.
 - A2 CONNECTING ACCESS TO GUESTROOMS. COORDINATE WITH MANUFACTURER'S REQUIREMENTS. COORDINATE WITH MANUFACTURER'S INSTALLATION REQUIREMENTS WHERE CLEARING HEIGHT IS HIGHER THAN 8'-0" SEE 1010 FOR BUSHING DETAIL ON SHEET 550.
 - A3 EXPOSED PARTITIONS ABOVE BACK AND SEES OF WARDROBE TO BE FINISHED.
 - A5 LOCATE OUTLET LOCATION WITHIN WALL CONSTRUCTION TO AVOID OUTLETS OCCURRING IN SAME CAVITY WITHIN PARTITION HATCHED AREA INDICATES SPACE WHERE OUTLETS SHOULD OCCUR. SEE ALSO DETAIL ON STC DIAGRAM SHEET 240.
 - A6 12" X 12" OUT-GUT AT SIDE OF CABINET FOR ACCESS TO REFRIGERATOR OUTLET.
 - A7 WALL MOUNTED STOP LOCATION WHEN CONNECTING DOOR OPENS NEAR FURNITURE. SEE DETAIL ON 550 FOR ADDITIONAL INFORMATION.
 - A8 INDICATE LOCKING IN WALL FOR ALL CABINETS. COORDINATE WITH MANUFACTURERS INSTALLATION REQUIREMENTS.
- INTERIOR DESIGN:
 - E1 ALL EXTERIOR CORNERS SHALL HAVE FULL HEIGHT CORNER GUARDS PER FINISH INDEX.
 - E2 CENTER ARTWORK ON SOFA.
 - E3 WHERE REQUIRED FOR ACCESSIBILITY PROVIDE MOTORIZED SHADES. REFER TO DRAPERY MANUAL AND ID SPEC MANUAL FOR ADDITIONAL INFORMATION AND POWER REQUIREMENTS.
 - E4 IRON AND HANGING BOARD STORAGE ACCESSORY TO BE LOCATED INSIDE WARDROBE.
 - E5 FOR ACCESSIBLE GUESTROOM TYPES WITH A TUB OR ROLL-IN SHOWER, THE ORIENTATION OF THE WARDROBE UNIT IS ROTATED AND REVERSED. TAKE ADDITIONAL PRECAUTION TO ENSURE THE CORRECT UNIT IS SPECIFIED AND THE OUTLETS ARE CORRECTLY ORIENTED.
 - E6 TEXTURED WALL COATING IS THE REQUIRED FINISH FOR EXTERIOR GUESTROOM WALLS TO ELIMINATE MOLD AND MILDEW.
 - E7 SEE DETAIL 7550 FOR HEAD HEIGHT RELATIONSHIP BETWEEN DRAPERY OVERHANG AT WINDOW SILL AND HEIGHT OF WOODLENS OVER PTAC UNIT.
 - E8 REFER TO INTERIOR DESIGN SPECIFICATION MANUAL WINDOW TREATMENT SPECIFICATIONS AND ELEVATIONS FOR ROLLER SHADE INFORMATION.
 - E9 REFER TO INTERIOR DESIGN SPECIFICATION MANUAL FOR READING LIGHT X-499 & HEADBOARDS G-201 & G-201 ADA WITH OUTLETS.
- ENGINEERING:
 - E11 OUTLETS FOR TV, CABLE AND POWER FOR TV MOUNTED IN OPENING OF WALL MOUNTED TV PANEL. COORDINATE HEIGHT WITH PANEL AS REQUIRED.
 - E12 CONVENIENCE OUTLET LOCATION WHEN ROOM HAS A COMMUNICATING DOOR TO ADJACENT ADA ROOM.
 - E13 THERMOSTAT ALIGN WITH OUTLET BELOW WHERE OCCURS. SEE ELEVATION FOR ADDITIONAL INFORMATION. ALIGN DEVICES VERTICALLY 6" FROM EDGE OF WALL.
 - E14 SWITCHED OUTLET FOR CABINET LIGHTS. CABINET LIGHTS PROVIDED BY FURNITURE VENDOR. WARDROBE INCLUDES PLUG-IN LIGHT UNDER SHELF. ADDITIONAL PLUG-IN OVER-CABINET LIGHT IS OPTIONAL. REFER TO ID SPEC MANUAL.
 - E15 DUPLEX OUTLET FOR MICROWAVE AND POWER STRIP.
 - E16 DOORBELL SWITCH, LIGHT, AND DISCONNECT SWITCH TO BE PROVIDED AT HEARING IMPAIRED AND ACCESSIBLE GUESTROOMS. SEE DETAIL SHEET 521.
 - E17 CENTER FIXTURE IN SHOWER/TUB.
 - E18 REFRIGERATOR OUTLET.
 - E19 EXHAUST FAN LIGHT LOCATION. TO BE SWITCHED WITH MAIN ROOM LIGHT. WHEN CONTINUOUS VENTING IS USED, INSTALL FURNITURE TYPE D800X-400.
 - E20 WALL OUTLET ABOVE AND CENTERED ON DESK AS POSSIBLE. OUTLET SPEC: 1500MM RANANT; (2) 150MM SPOK; 150MM 2 GANG WALL PLATE.
 - E21 PROVIDE WALL OUTLETS FOR DESK & FLOOR LAMP, COFFEE MAKER, READING LIGHTS, AND CONVENIENCE.
 - E22 RECEPTACLES AT HEADBOARD FOR LIGHTS AND PHONE. LOCATE BEHIND HEADBOARD AND CENTERED ON SIDE OR CENTER PANEL AT 14" AFF. (PHEN).

ELECTRICAL LEGEND

- WALL MOUNTED LIGHT FIXTURE
- CEILING LIGHT FIXTURE
- LIGHT SWITCH
- MASTER SWITCH
- DUPLEX RECEPTACLE
- GROUND FAULT INTERRUPTER
- DUPLEX RECEPTACLE
- DUPLEX DUPLEX RECEPTACLE
- THERMOSTAT
- TELEPHONE OUTLET
- DATA
- TV OUTLET
- JUNCTION BOX
- RACEWAY & WIRING

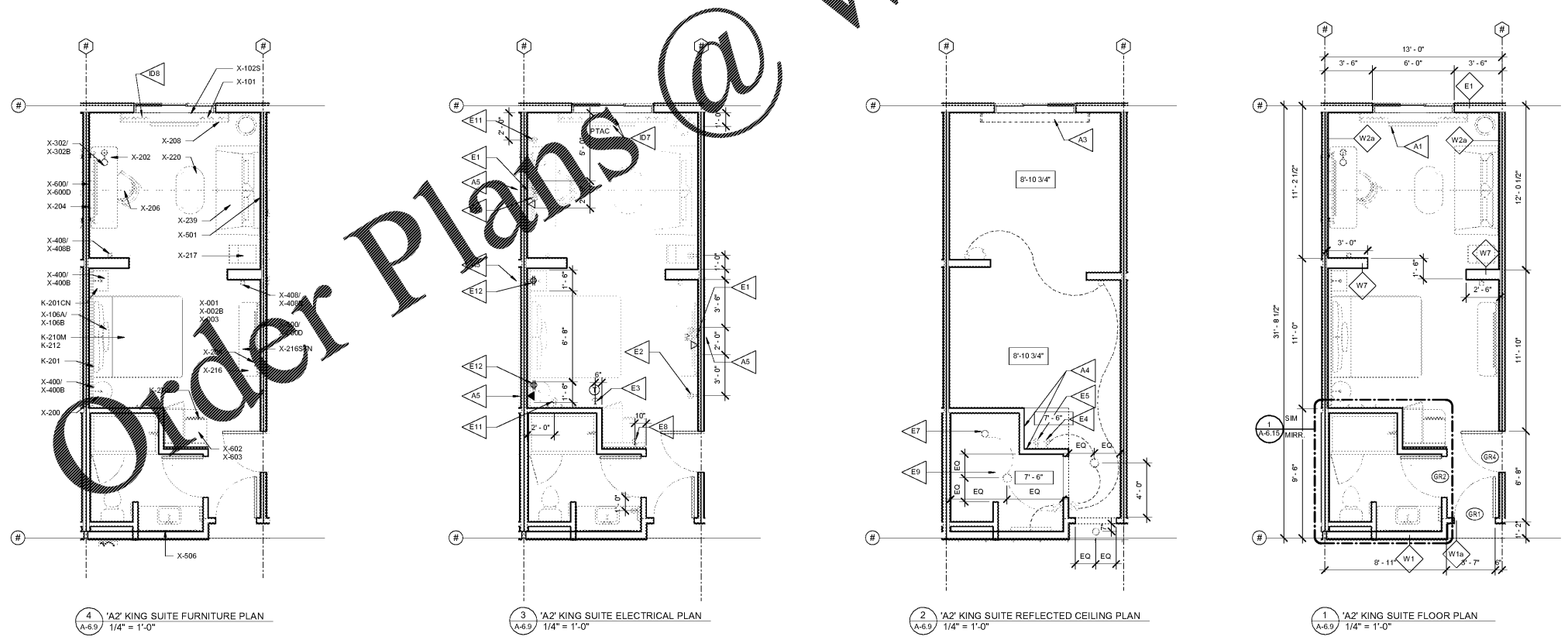

4 'A2' KING SUITE FURNITURE PLAN
A-6.9
1/4" = 1'-0"

3 'A2' KING SUITE ELECTRICAL PLAN
A-6.9
1/4" = 1'-0"

2 'A2' KING SUITE REFLECTED CEILING PLAN
A-6.9
1/4" = 1'-0"

1 'A2' KING SUITE FLOOR PLAN
A-6.9
1/4" = 1'-0"

Order Plans @

www.LDILine.com