

PHILLIPS

KEYPLAN _____

CONSULTANT _____

SEAL _____

ISSUE & REVISION RECORD

#	DATE	DESCRIPTION

PROJECT

Fairfield
BY MARRIOTT
INN & SUITES

DAWSONVILLE, GEORGIA

PROTOTYPE VERSION 2016
REV 1/12-21-18

4 STORY, 92 UNITS
w/ INDOOR POOL

CLIENT

FAIRFIELD
DAWSON FOREST ROAD
DAWSONVILLE, GA
30534

RIMROCK COMPANIES
10000 RIVERSIDE AVE
SUITE 3201
JACKSONVILLE, FL 32204

PHILLIPS' JOB NUMBER 1972101
ISSUE DATE 08/23/2019
DRAWN BY/CHECKED BY ZS / JU
DRAWING TITLE
WALL TYPES &
FLOOR/CEILING/ROOF
TYPES
SHEET NUMBER

A-0.6

5901 PEACHTREE DUNWOODY RD.
BUILDING A, SUITE 450
ATLANTA, GEORGIA 30328
PHILLIPS PART 000001 778-394-1616

E# EXTERIOR WALLS

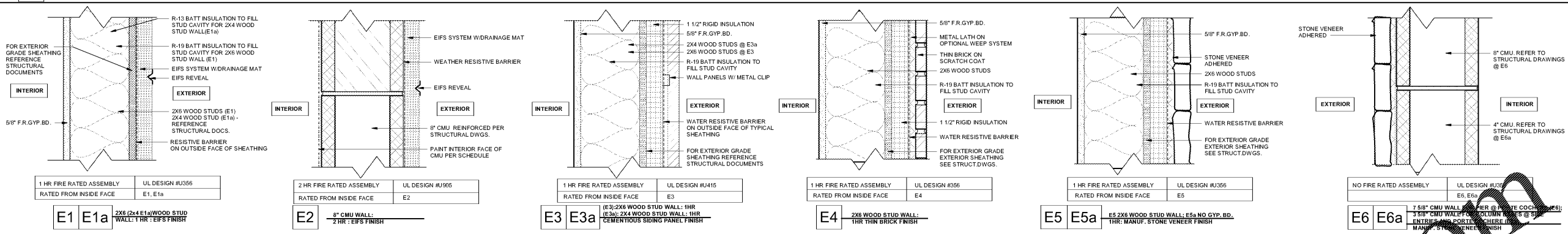

S# FIRE BARRIERS: SHAFT WALLS & OCCUPANCY SEPARATION WALLS, MISC.

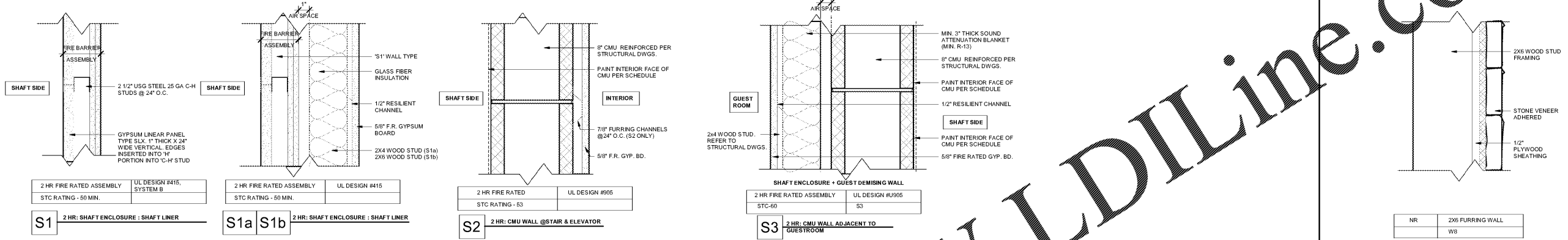

W# INTERIOR WALLS

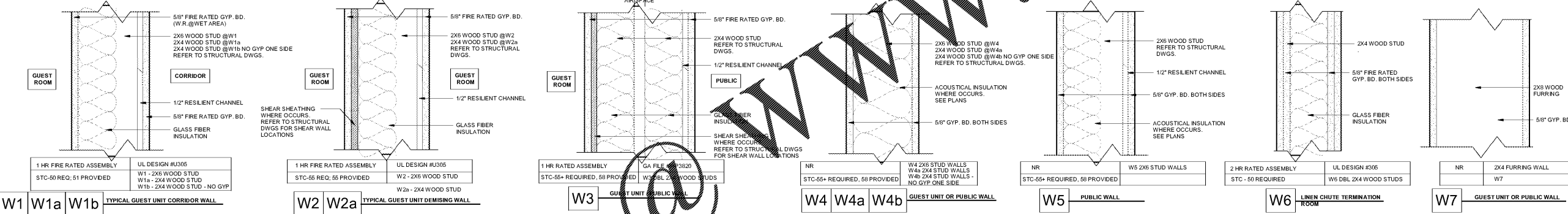

FLOOR/CEILING & ROOF ASSEMBLIES

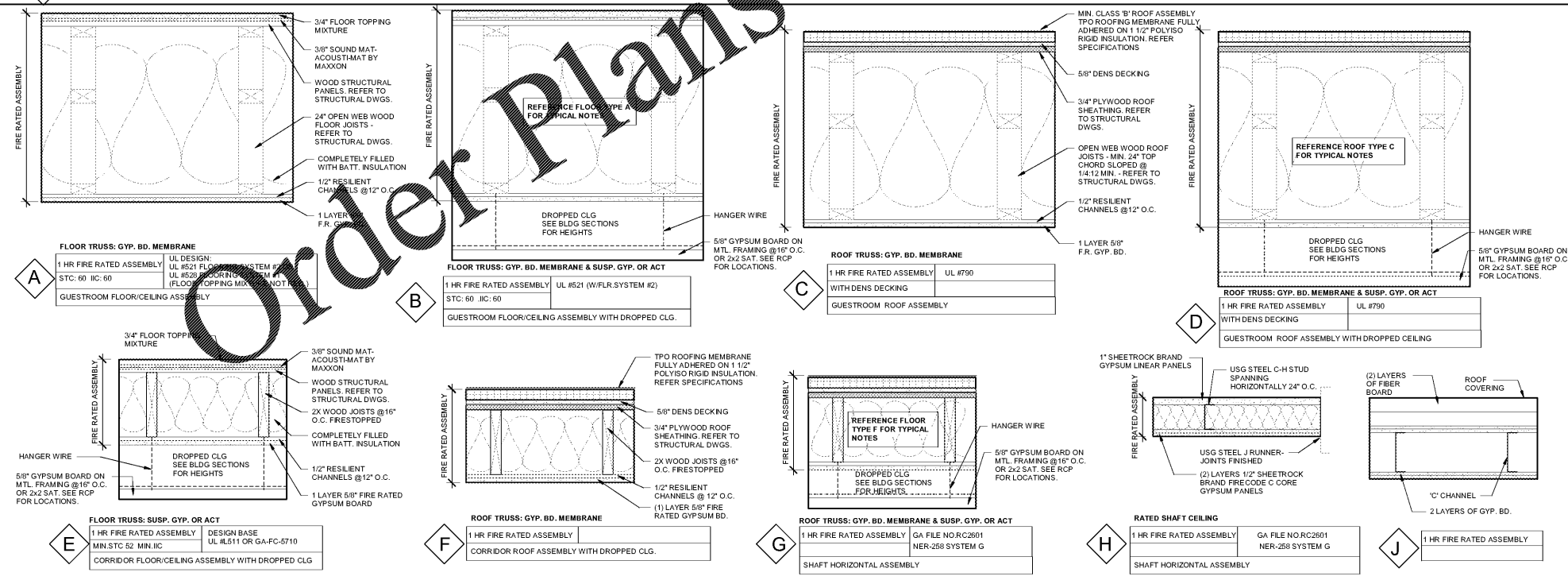

GENERAL NOTES:

- ALL FIRE RATED ASSEMBLIES TO BE CONSTRUCTED PER SPECIFIED UL DESIGN NUMBER, G.A. FILE NO. CRITERIA OR AN APPROVED, TESTED SUBSTITUTE.
- PROVIDE MINIMUM SOUND TRANSMISSION CLASS (STC) AND IMPACT INSULATION CLASS (IIC) RATINGS AT EACH GUEST UNIT AS FOLLOWS:

	STC 55 (MARRIOTT 57A.3)	IIC 55 (2012 IBC s1207.3)
- FLOOR/CEILING ASSEMBLIES	STC 55 (MARRIOTT 57A.3)	IIC 55 (2012 IBC s1207.3)
- DEMISING/PARTY WALLS	STC 55 (MARRIOTT 57A.3)	IIC 55 (2012 IBC s1207.3)
- DEMISING WALLS ADJ. TO PUBLIC/BOH AREAS	STC 65 (MARRIOTT 57A.3)	IIC 55 (2012 IBC s1207.3)
- CORRIDOR WALLS	STC 55+ (MARRIOTT 57A.3)	IIC 55 (2012 IBC s1207.3)
- CONTRACTOR TO VERIFY THE STC AND IIC RATING OF EACH WALL AND FLOOR/CEILING ASSEMBLY BEFORE START OF WORK FOR ANY DEVIATIONS OR PRODUCT SUBSTITUTIONS.
- REFER TO STRUCTURAL DRAWINGS FOR SHEAR WALL LOCATIONS & SHEATHING REQUIREMENTS.
- WALLS & PARTITIONS WITHIN 2 FEET OF SERVICE SINKS, URINALS AND WATER CLOSETS IN PUBLIC RESTROOMS SHALL HAVE A SMOOTH, HARD, NONABSORBENT SURFACE, TO A HEIGHT OF NOT LESS THAN 4 FEET AFF. & EXCEPT FOR STRUCTURAL ELEMENTS, THE MATERIALS USED IN SUCH WALLS SHALL BE OF A TYPE THAT IS NOT ADVERSELY AFFECTED BY MOISTURE. [2012 IBC s1201.2.2]
- GLASS MAT GYPSUM BACKING PANEL OR FIBER-CEMENT BACKER BOARD SHALL BE USED AS THE BASE FOR WALL TILE IN TUB AND SHOWER AREAS AND WALL AND CEILING PANELS IN SHOWER AREAS. WATER-RESISTANT GYPSUM BACKING BOARD SHALL BE USED AS A BASE FOR TILE IN WATER CLOSET COMPARTMENTS AND MOIST AREAS. [2012 IBC s2201] RATED BOARDS SHALL BE PROVIDED FIRE RATED ASSEMBLIES.
- ALL EXTERIOR WALLS TO HAVE EXTERIOR GRADE SHEATHING.
- STUCCO SHALL BE A MOISTURE DRAINABLE SYSTEMS. REF: SPECIFICATIONS.
- IN COMBUSTIBLE CONSTRUCTION, FIREBLOCKING SHALL BE INSTALLED TO CUT OFF CONCEALED DRAFT OPENINGS (BOTH VERTICAL AND HORIZONTAL) AND SHALL FORM AN EFFECTIVE BARRIER BETWEEN FLOORS, BETWEEN A TOP STORY AND A ROOF OR ATTIC SPACE. FIREBLOCKING SHALL BE INSTALLED IN THE FOLLOWING LOCATIONS: CONCEALED WALL SPACES, CONNECTIONS BETWEEN HORIZONTAL AND VERTICAL SPACES, STAIRWAYS, CEILING AND FLOOR OPENINGS EXTERIOR WALL COVERINGS & CONCEALED SLEEPER SPACES. [2012 IBC s716.1]
- DRAFTSTOPPING: PER NFPA 101 §6.10.2, PROVIDING DRAFTSTOPPING IN CONCEALED, COMBUSTIBLE SPACES IS NOT REQUIRED WHERE THE CONCEALED SPACE IS PROTECTED WITH AN AUTOMATIC SPRINKLER SYSTEM IN ACCORDANCE WITH SECTION 9.7. DRAFTSTOPPING IS NOT REQUIRED IN BUILDINGS EQUIPPED THROUGHOUT WITH AN AUTOMATIC SPRINKLER SYSTEM IN ACCORDANCE WITH NFPA 13 SYSTEM. [2012 IBC s718.3.2, EXCEPT, 1]
- PROVIDE SOUND BLOCKING AT ALL WALL MOUNTED ITEMS. VERIFY WITH FFRE SUPPLIER.
- ALL PENETRATIONS IN FIRE RATED ASSEMBLIES TO BE CONSTRUCTED PER UL DESIGN CRITERIA.
- MINIMUM R-VALUE FOR INSULATION TO BE:

	REF. CS-2	INTERIOR WALLS	R-13 MIN.
CEILING	REF. CS-2	FLOOR/CEILING	R-13 MIN.
- ALL BATHROOM WALLS SHALL HAVE SOUND ATTENUATION INSULATION.
- ROOF ASSEMBLY SHALL BE MIN. CLASS B FOR TYPE VA CONSTRUCTION.
- ALL BEAMS AND COLUMNS THAT SUPPORT MORE THAN TWO FLOORS OR ONE FLOOR AND ROOF SHALL BE INDIVIDUALLY NOTICED ON ALL SIDES IN COMPLIANCE WITH SECT. 704.2, 2012 IBC, PER UL DESIGN CRITERIA. REF. SHEET A-0.1.
- ALL ENVELOPE THERMAL REQUIREMENTS TO COORD/COMPLY W/ MINIMUM CRITERIA FROM ENVELOPE COMPLIANCE CERTIFICATE ON SHEET CS-3.
- REFER TO BUILDING ELEVATIONS AND WALL SECTIONS FOR FINISH MATERIAL LOCATIONS AND DETAILS.
- CONCEALED SPACES OF FLOOR/CEILING ASSEMBLIES COMPLETELY FILLED WITH NON-COMBUSTIBLE INSULATION SHALL NOT REQUIRE SPRINKLER PROTECTION.