

GENERAL PHOTOMETRIC SCHEDULE	
AVERAGE FOOT-CANDELES	3.14
MAXIMUM FOOT-CANDELES	7.0
MINIMUM FOOT-CANDELES	0.4
MINIMUM TO MAXIMUM FC RATIO	0.05
MAXIMUM TO MINIMUM FC RATIO	18.86
AVERAGE TO MINIMUM FC RATIO	8.41

CALLOUT	SYMBOL	LAMP	DESCRIPTION	MODEL	VOLTS
Z64		(48)	GALLEON AREA AND ROADWAY LUMINAIRE(3) 70 CRI, 4000K, 1.050mA LIGHTSQUARES WITH 16 LEDS EACH AND TYPE V MEDIUM OPTICS	EATON - MCGRAW-EDISON (FORMER COOPER LIGHTING) GLEON-AF-OS-LED-E1-5M2	120V 1P 2W

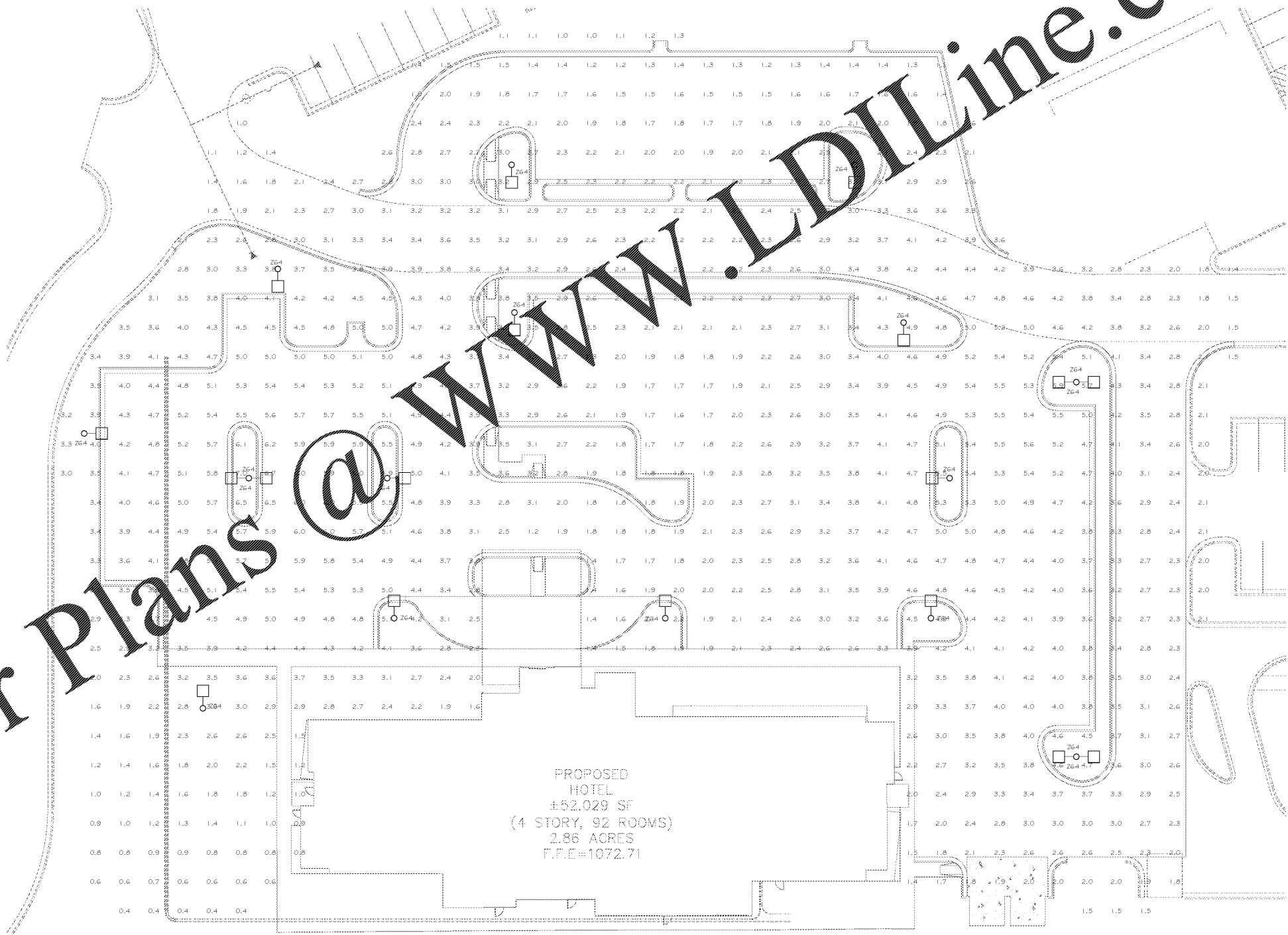

Order Plans @

**PHILLIPS**

KEY PLAN

CONSULTANT



**PROFICIENT ENGINEERING**  
6991 Peachtree Industrial Blvd Building 700  
Peachtree Corners, Georgia 30092  
404.333.9798  
PROJECT # 110288

SEAL



ISSUE & REVISION RECORD

#	DATE	DESCRIPTION
1	06.10.2019	30% DESIGN REVIEW SET

This document is © Phillips Partnership, PC and is considered an Instrument of Service and is solely for use with respect to the project as indicated herein. All rights reserved. This document may not be reproduced without the prior written consent of Phillips Partnership, PC.

PROJECT

**Fairfield BY MARRIOTT INN & SUITES**

DAWSONVILLE, GEORGIA

PROTOTYPE VERSION 2016  
REV 7.12.21.18

4 STORY, 92 UNITS  
w/ INDOOR POOL

**FAIRFIELD DAWSON FOREST ROAD DAWSONVILLE, GA 30534**

CLIENT

**RIMROCK COMPANIES**  
10000 RIVERSIDE AVE  
SUITE 32201  
JACKSONVILLE, FL 32204

PHILLIPS JOB NUMBER 1972101

ISSUE DATE 06/10/2019

DRAWN BY/CHECKED BY DC BA

DRAWING TITLE FLOOR PLAN LEVEL 1

SHEET NUMBER

**E-1.0**