

C:\LAS_CADD\Central_10958-00_L18_RNW.rvt
4/16/2019 9:47:28 PM

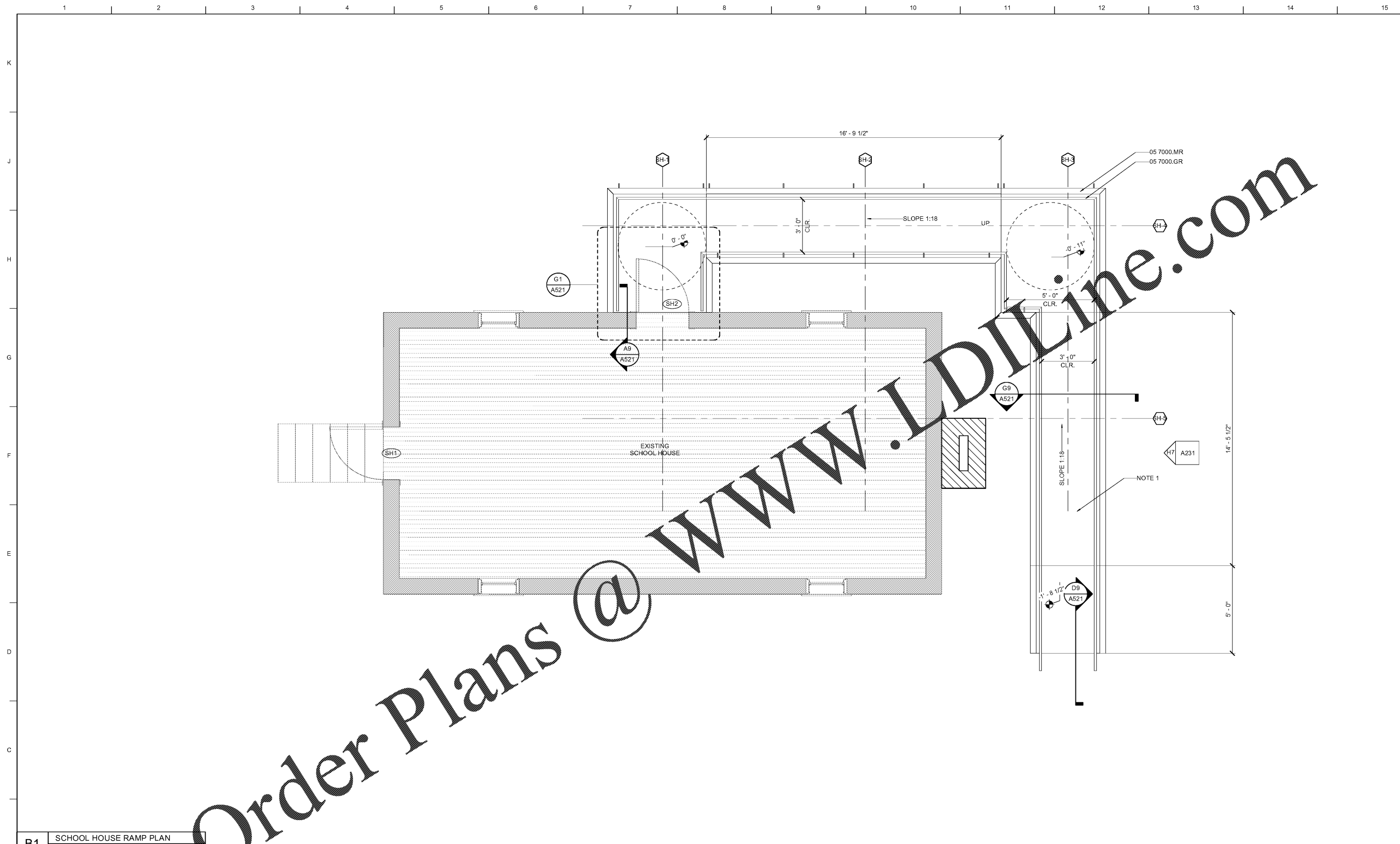

Order Plans @ WWW.LDILine.com

B1 SCHOOL HOUSE RAMP PLAN

MATERIAL KEYNOTES

05 7000.GR	STAINLESS STEEL GRIP RAIL
05 7000.MR	METAL RAILING

GENERAL NOTES

A. SCOPE OF WORK LIMITED TO NEW RAMP ONLY. NO WORK AT EXISTING SCHOOL HOUSE.

SHEET SPECIFIC NOTES

1. NEW ADA RAMP, RAMP AND LANDING SURFACE TO BE ALUMINUM PLANK WITH STAINLESS STEEL TRACTION COATING. BASIS OF DESIGN IKG BORDEN HD-70 PLANK WITH HARSCO MEBAC EZ-WELD COATING.

WINNETT CO. STAMP CDP2019-00035 KEY PLAN

ISSUE DATE
02/12/2019
JOB NO.
10958-00
DWG. NO.
A132

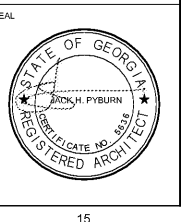

**LORD
AECK
SARGENT**

© 2018 Lord Aeck Sargent
LordAeckSargent.com

Unless otherwise agreed to in writing this document is the sole property of Lord Aeck Sargent and is to be returned upon demand. The information herein is confidential and may not be used or divulged without the written permission of Lord Aeck Sargent.

REVISION:

SHEET TITLE
SCHOOL HOUSE RAMP - FLOOR PLAN

SCALE (IN/FT)
0 4 8 FT

JOB NAME
WINNETT COUNTY
ELISHA WINN HOUSE SITE
IMPROVEMENTS

LOCATION
Dacula, Georgia 30019

FOR CONSTRUCTION