

**CRITICAL NOTE:**  
 LANDSCAPE PLAN INDICATES DIAGRAMMATIC LOCATIONS ONLY. PLANTS ARE TO BE BROUGHT TO THE SITE AND SET IN GENERAL LOCATION (NOT INSTALLED), AS INDICATED ON THE LANDSCAPE PLANS. LANDSCAPE ARCHITECT TO APPROVE PLANT LAYOUT PRIOR TO ACTUAL INSTALLATION. IF PLANTS ARE INSTALLED PRIOR TO LANDSCAPE ARCHITECT'S REVIEW, ALL PLANTS WILL HAVE TO BE REPLANTED AT NO ADDITIONAL COSTS TO THE OWNER. CONTRACTOR TO COORDINATE SCHEDULE FOR REVIEW WITH LANDSCAPE ARCHITECT (48 HOUR NOTICE MINIMUM). NO PORTION OF THE CONTRACTOR'S PAY APPLICATION WILL BE APPROVED FOR LANDSCAPING UNTIL THE LANDSCAPE ARCHITECT HAS SIGNED OFF ON THE PLANT INSTALLATION.

**GENERAL LANDSCAPE NOTES:**

- WARRANTY: ALL PLANTS SHALL BE WARRANTED TO REMAIN ALIVE, HEALTHY, AND IN THRIVING CONDITION FOR A PERIOD OF ONE YEAR FROM FINAL ACCEPTANCE.
- PLANTS SHALL MEET DOT SPECIFICATIONS AND AMERICAN STANDARD FOR NURSERY STOCK STANDARDS.
- PLANTS SHALL BE SPECIMEN QUALITY. PLANTS SHALL BE SOUND, HEALTHY AND VIGOROUS, WELL BRANCHED, AND DENSELY FOLIATED WHEN IN LEAF.
- HEIGHT AND SPREAD DIMENSIONS SPECIFIED REFER TO THE MAIN BODY OF THE PLANT AND NOT FROM BRANCH TIP TO TIP. IF A RANGE OF SIZE IS GIVEN, NO PLANT SHALL BE AS LARGE AS THE MAXIMUM SIZE SPECIFIED.
- SHADE TREES SHALL BE STRAIGHT UNLESS OTHERWISE SPECIFIED.
- PLANTS SHALL BE SUBJECT TO REVIEW BY LANDSCAPE ARCHITECT. LANDSCAPE ARCHITECT SHALL BE THE SOLE JUDGE OF THE QUALITY AND ACCEPTABILITY OF MATERIALS AND PLACEMENT.
- PLACE PLANTS UPRIGHT AND TURNED SO THAT THE MOST ATTRACTIVE SIDE IS VIEWED.
- BE FAMILIAR WITH UNDERGROUND UTILITIES BEFORE DIGGING. THE CONTRACTOR SHALL BE FULLY RESPONSIBLE FOR ALL DAMAGE OF UTILITY LINES.
- PROVIDE SHOVEL-CUT TRENCH AT SHRUB BEDS IN LAWN AREAS UNLESS OTHERWISE NOTED.
- PROVIDE 3" THICKNESS MULCH AT ALL PLANTS AND PLANTING BEDS. MULCH MUST BE 3" THICK AT TIME OF FINAL WALK-THROUGH. MULCH IN SHRUB AND TREE PLANTING BEDS SHALL BE PINE STRAW UNLESS OTHERWISE NOTED. MULCH IN GROUNDCOVER BEDS TO BE SHREDDED HARDWOOD UNLESS OTHERWISE NOTED. MULCH SAMPLE IS TO BE SUBMITTED FOR APPROVAL PRIOR TO INSTALLATION. MULCH IS TO BE REPLACED AT CONTRACTOR'S OWN EXPENSE IF LAID PRIOR TO APPROVAL.
- MAINTENANCE WORK SHALL BE PERFORMED UNTIL DATE OF FINAL ACCEPTANCE BY OWNER'S REPRESENTATIVE.
- CONTRACTOR'S PRICES SHALL INCLUDE ALL LABOR AND MATERIAL NECESSARY TO COMPLETE THE WORK, E.G. MULCH, PLANTING, SOIL MIX, WOOD AND WIRE STAKING MATERIAL, ETC.
- QUANTITIES NECESSARY TO COMPLETE THE WORK ON THE DRAWING SHALL BE FURNISHED. QUANTITY ESTIMATES HAVE BEEN MADE CAREFULLY, BUT THE OWNER'S REPRESENTATIVE ASSUMES NO LIABILITY FOR OMISSION OR ERRORS. HIS ESTIMATES ARE ONLY AN AID FOR CLARIFICATION OF UNITS AND A CHECK FOR THE CONTRACTOR TO COMPARE WITH HIS OWN ESTIMATES. DIFFERENCES SHALL BE BROUGHT TO THE ATTENTION OF OWNER'S REPRESENTATIVE. NO EXTRA COMPENSATION SHALL BE ALLOWED FOR EXTRA QUANTITIES NECESSARY TO COMPLETE THE WORK.
- WHERE LANDSCAPING AREAS ADJOIN GRASSED RIGHTS-OF-WAY, SUCH AREAS SHALL BE CONSIDERED PART OF THE LANDSCAPED AREA FOR PURPOSES OF MAINTENANCE AS OF COMPLETION OF SITE IMPROVEMENTS. THE PROPERTY OWNER SHALL HAVE AN IMPLIED EASEMENT OF THE RIGHT-OF-WAY EXTENDING FROM THE SITE TO THE ROAD PAVEMENT IN ORDER TO COMPLETE THE REQUIRED MAINTENANCE.
- A MAINTENANCE INSPECTION OF TREES WILL BE PERFORMED AFTER TWO FULL GROWING SEASONS FROM THE DATE OF THE FINAL CONSTRUCTION INSPECTION. PROJECT OWNERS AT THE TIME OF THE MAINTENANCE INSPECTION ARE RESPONSIBLE FOR ORDINANCE COMPLIANCE.
- CONTRACTOR TO DESIGN-BUILD IRRIGATION SYSTEM. IRRIGATION HEADS TO BE INSTALLED FLUSH WITH GRADE.

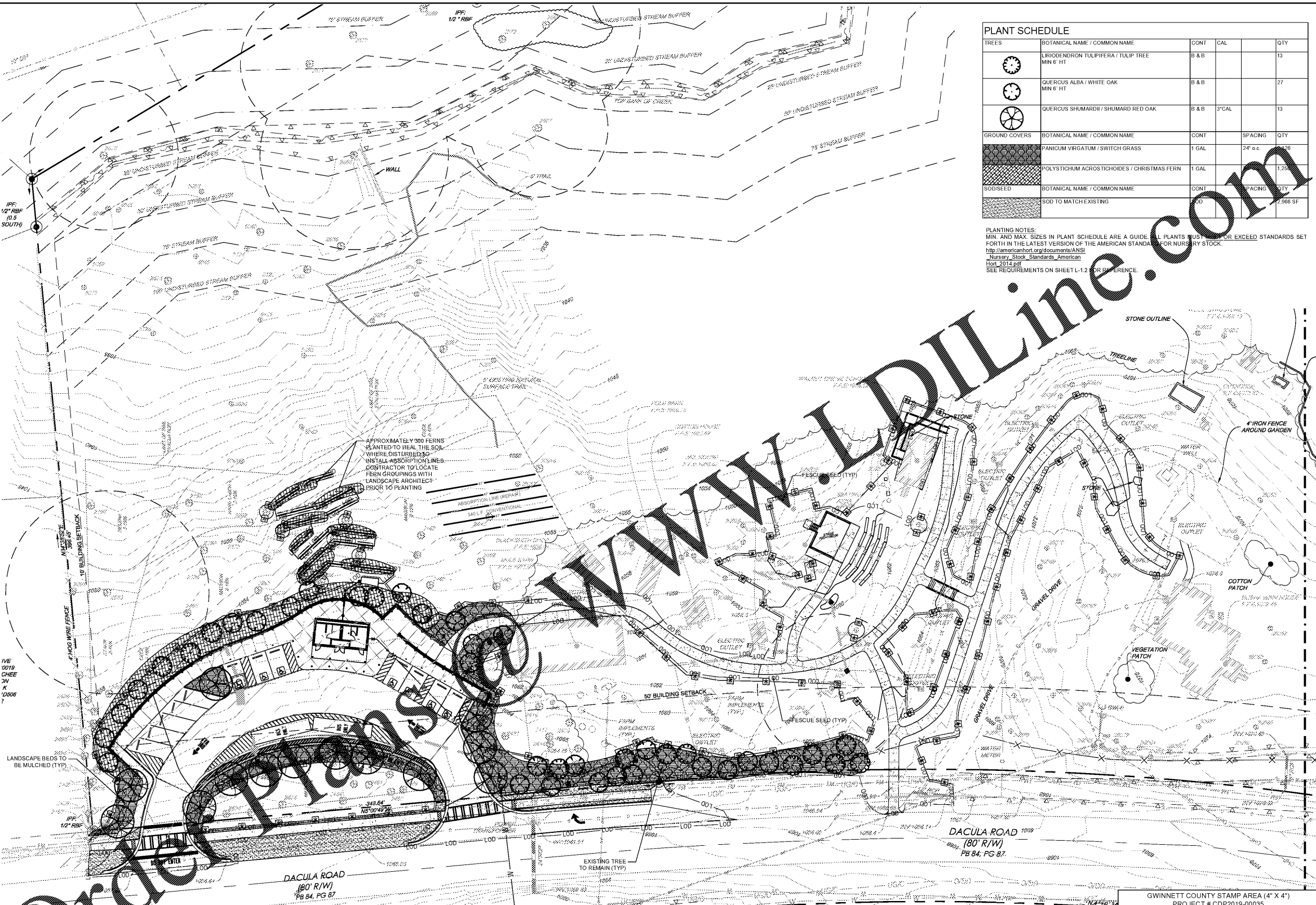

**PLANT SCHEDULE**

TREES	BOTANICAL NAME / COMMON NAME	CONT	CAL	QTY
	LIRIODENDRON TULIPIFERA / TULIP TREE MIN 6" HT	B & B		13
	QUERCUS ALBA / WHITE OAK MIN 6" HT	B & B		27
	QUERCUS SHUMARDII / SHUMARD RED OAK	B & B	3" CAL	13
GROUND COVERS	BOTANICAL NAME / COMMON NAME	CONT	SPACING	QTY
	PANICUM VIRGATUM / SWITCH GRASS	1 GAL	24" o.c.	178
	POLYSTICHUM ACROSCHOIDES / CHRISTMAS FERN	1 GAL		125
SOD/SEED	BOTANICAL NAME / COMMON NAME	CONT	SPACING	QTY
	SOD TO MATCH EXISTING	SOD		2,966 SF

**PLANTING NOTES:**  
 MIN AND MAX SIZES IN PLANT SCHEDULE ARE A GUIDE. ALL PLANTS MUST EXCEED STANDARDS SET FORTH IN THE LATEST VERSION OF THE AMERICAN STANDARD FOR NURSERY STOCK  
[http://americanhort.org/documents/ANSI\\_Nursery\\_Stock\\_Standards\\_American\\_Hort\\_2014.pdf](http://americanhort.org/documents/ANSI_Nursery_Stock_Standards_American_Hort_2014.pdf)  
 SEE REQUIREMENTS ON SHEET L-1.2 FOR REFERENCE.

**WINNETT COUNTY LANDSCAPE NOTES:**

- OPPING TREES NOT ALLOWED. TREES REMOVED OR WINING THEIR TOPS CUT AFTER COMPLIANCE WITH THIS FINANCE. SI BE REPLACED WITH THE EQUIVALENT IN SPECIES REMOVED.
- DECIDUOUS TREES SHALL BE AT LEAST 2 INCHES IN DIAMETER AND EVERGREEN TREES SHALL BE AT LEAST 6 FEET IN HEIGHT AT TIME OF PLANTING.
- THINNING IS ALLOWED AND MAY INCLUDE MANUAL REMOVAL OF NON-SPECIMEN TREES WITHIN THE CRITICAL ROOT ZONE OR DRIPLINE OF THE SPECIMEN TREE IN THE LANDSCAPE INSTALLATION PHASE OF DEVELOPMENT ONLY. THINNING INCLUDES MANUAL REMOVAL (NO MOTORIZED/WHEELED OR TRACK VEHICLES ALLOWED WITHIN THE CRITICAL ROOT ZONE OF THE SPECIMEN TREE.
- ALL BUFFERS AND TREE SAVE AREAS SHALL BE CLEARLY IDENTIFIED WITH TREE PROTECTION FENCING PRIOR TO COMMENCEMENT OF ANY LAND DISTURBANCE.

**NON-VEGETATIVE MATERIAL TO BE REMOVED MANUALLY.**

- APPROVAL OF THESE PLANS DOES NOT CONSTITUTE APPROVAL BY WINNETT COUNTY OF ANY LAND DISTURBING ACTIVITIES WITHIN WETLAND AREAS. IT IS THE RESPONSIBILITY OF THE PROPERTY OWNER TO CONTACT THE APPROPRIATE REGULATORY AGENCY FOR APPROVAL OF ANY WETLAND DISTURBANCE.
- IT IS THE RESPONSIBILITY OF THE PROPERTY OWNER TO MAINTAIN ANY DETENTION FACILITY CONSTRUCTED ON THEIR PROPERTY AND TO ENSURE THE FACILITY IS FREE OF OBSTRUCTION, SILT, OR DEBRIS.
- A COMMERCIAL APPLICATOR LICENSE AND A PESTICIDE CONTRACTOR LICENSE ARE REQUIRED BY THE CONTRACTOR IF THE USE OF HERBICIDES ARE NECESSARY FOR NOXIOUS PLANT MATERIAL REMOVAL.
- STREET TREES TO BE A MINIMUM OF 3 INCHES CALIPER AT TIME OF PLANTING.
- STREET TREES SHALL BE LOCATED NO CLOSER THAN 11 FEET FROM THE BACK OF CURB.

**TREE CALCULATIONS:**

TOTAL SITE AREA: 14.58 ACRES (635,104 SF)  
 TOTAL SITE AREA DISTURBED: 1.38 ACRES (60,113 SF)

**TREE CANOPY**  
 SITE AREA DISTURBED: 60,113 SF  
 CANOPY COVERAGE: 3,190 SF  
 PERCENTAGE OF CANOPY COVERAGE: 5.29%

**TREE DENSITY**  
 PROVIDE 20 TREE DENSITY UNITS (TDU) PER ACRE, EXCLUDING SANITARY SEWER EASEMENT  
 14.58 ACRES x 20 = 291.6 TDUS REQUIRED  
 815.25 TDUS EXISTING

**LANDSCAPING REQUIREMENTS:**

**STREET FRONTAGE LANDSCAPE STRIP**  
 PROVIDE (1) TREE PER 40 LF AND (1) SHRUB PER 4 LF OF STRIP LENGTH OF THE 10' LANDSCAPE STRIP.  
 DACULA RD LANDSCAPE STRIP = 513 LF  
 513 LF / 40 LF = 13 TREES REQUIRED  
 13 TREES EXISTING  
 129 SHRUBS REQUIRED  
 129 SHRUBS PROPOSED

**PARKING LOT**  
 PROVIDE (1) CANOPY TREE PER 7 PARKING SPACES  
 12 PARKING SPACES  
 12 / 7 = 2 CANOPY TREES REQUIRED  
 2 CANOPY TREES PROPOSED

ALL PARKING SPACES MUST BE WITHIN 80 FEET OF A TREE TRUNK

**MISCELLANEOUS**  
 50% OF TREES TO BE 3" CALIPER OR GREATER  
 1 TREES @ 3" CALIPER REQUIRED  
 2 TREES @ 3" CALIPER PROPOSED

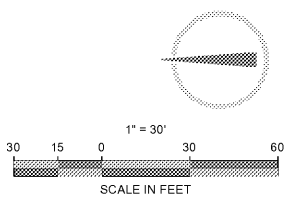

ENGINEER  
**FORESITE group**  
 Foresite Group, Inc. w | www.fg-inc.net  
 3740 Davinci Ct. o | 770.368.1399  
 Suite 100 f | 770.368.1944  
 Peachtree Corners, GA 30092

DEVELOPER  
  
 75 LANGLEY DR.  
 LAWRENCEVILLE, GEORGIA 30046  
 770-822-8964  
 CONTACT: MR. REX SCHUDER

PROJECT  
**ELISHA WINN HOUSE**  
 SITE IMPROVEMENTS  
 908 DACULA RD  
 DACULA, GA 30019  
 LL # 1, DISTRICT 2, ZONE R-100

SEAL  
  
 4/08/19

REVISIONS	DATE
GWINNETT CO. RESUBMITTAL	03/20/2019

PROJECT MANAGER: AWP  
 DRAWING BY: SSH  
 JURISDICTION: GWINNETT COUNTY  
 DATE: 08/10/2018  
 SCALE: 1" = 30'  
 TITLE: LANDSCAPE PLAN

SHEET NUMBER: **L-1**

COMMENTS: RELEASED FOR CONSTRUCTION

JOB/FILE NUMBER: 223.082



FORESITE GROUP, INC. 3740 DAVINCI CT. SUITE 100 PEACHTREE CORNERS, GA 30092  
 770.368.1399  
 www.fg-inc.net  
 FORESITE GROUP, INC. IS AN EQUAL OPPORTUNITY EMPLOYER