

C-6 SIDEWALK POLE MOUNTED ACCESSIBLE SIGNAGE  
NOT TO SCALE

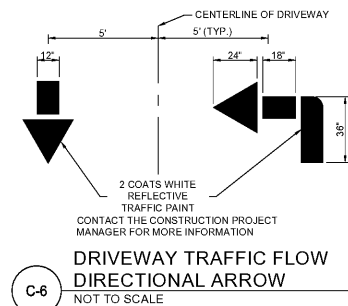

C-6 DRIVEWAY TRAFFIC FLOW DIRECTIONAL ARROW  
NOT TO SCALE

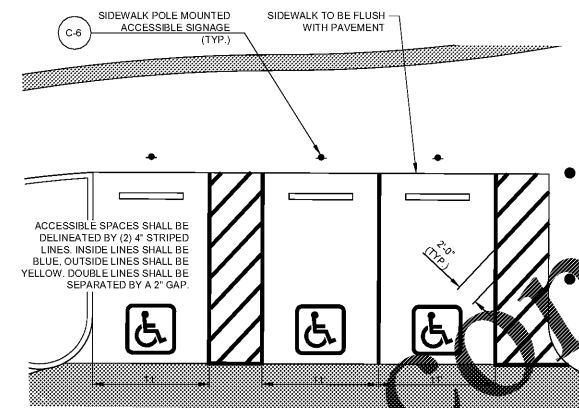

C-6 ACCESSIBLE PARKING STRIPING  
NOT TO SCALE

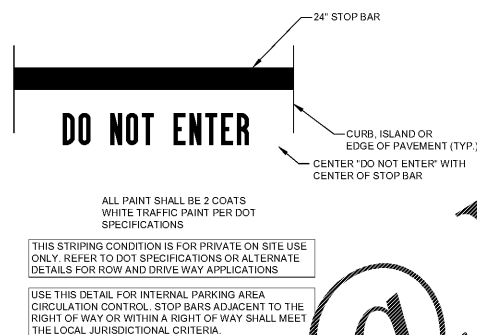

C-6 "DO NOT ENTER" LABEL STRIPING  
NOT TO SCALE

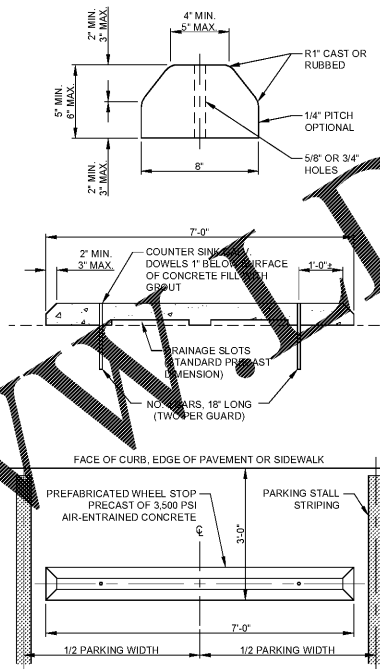

C-6 CONCRETE WHEEL STOP  
NOT TO SCALE

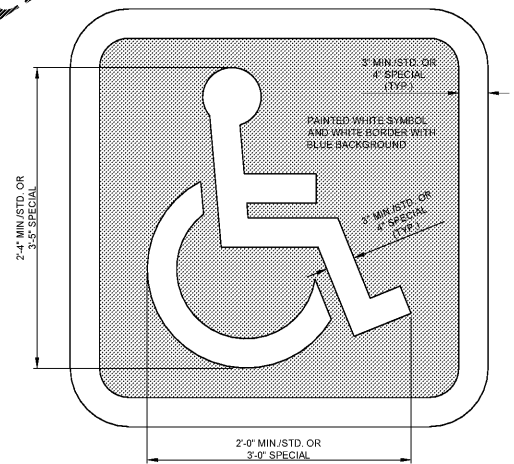

C-6 INTERNATIONAL SYMBOL OF ACCESSIBILITY PARKING SPACE MARKING  
NOT TO SCALE

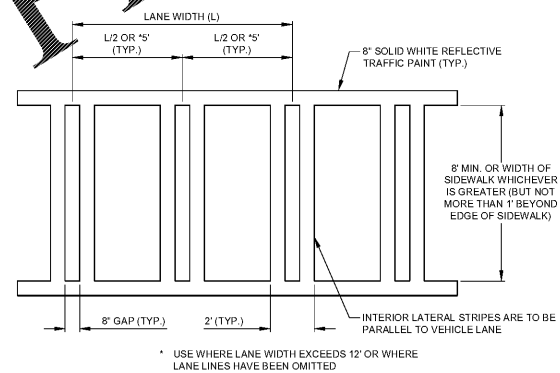

C-6 CROSSWALK STRIPING  
NOT TO SCALE

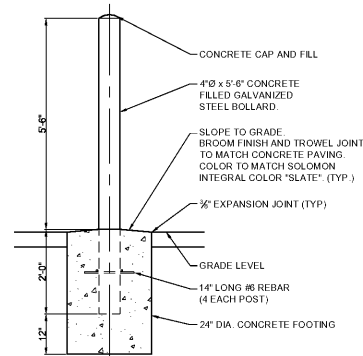

C-6 BOLLARD  
NOT TO SCALE

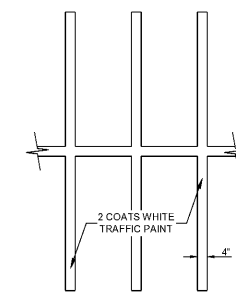

C-6 PAVEMENT STRIPING  
NOT TO SCALE

GWINNETT COUNTY STAMP AREA (4" X 4")  
PROJECT # CDP2019-00035

ENGINEER:  
**FORESITE** group  
Foresite Group, Inc. | www.fg-inc.net  
3740 Davinci Ct. | 770.368.1399  
Suite 100 | 770.368.1944  
Peachtree Corners, GA 30092

DEVELOPER:  
  
75 LANGLEY DR.  
LAWRENCEVILLE, GEORGIA 30046  
770-822-8864  
CONTACT: MR. REX SCHUDER

PROJECT:  
**ELISHA WINN HOUSE**  
SITE IMPROVEMENTS  
908 DACULA RD  
DACULA, GA 30019  
LL # 1, DISTRICT 2, ZONE R-100  
PARCEL #R2001 158

SEAL:  
  
4/08/19  
GEORGIA LEVEL II CERTIFIED  
PROFESSIONAL # 000058923  
EXPIRATION DATED: 08/21/2021

REVISIONS	DATE
GWINNETT CO. RESUBMITTAL	03/20/2019
PROJECT MANAGER:	AWP
DRAWING BY:	SSH
JURISDICTION:	GWINNETT COUNTY
DATE:	08/10/2018
SCALE:	AS SHOWN
TITLE:	

CONSTRUCTION DETAILS  
SHEET NUMBER: **C-6**  
COMMENTS: RELEASED FOR CONSTRUCTION  
JOB/FILE NUMBER: 223.082



Order Plans @ [WWW.DIline.com](http://WWW.DIline.com)