

SIGHT DISTANCE PROFILE 1L
1" = 30' H, 1" = 15' V

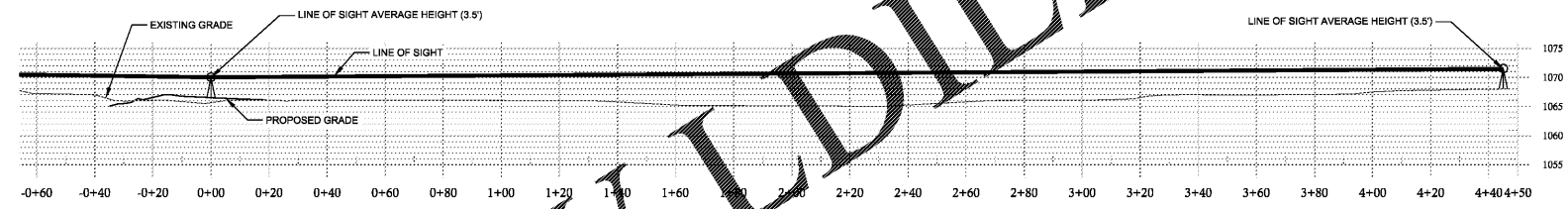

SIGHT DISTANCE PROFILE 1R
1" = 30' H, 1" = 15' V

**CORNER SIGHT DISTANCE FOR COMMERCIAL SITES
UTILIZING THE UNIFIED DEVELOPMENT ORDINANCE**

I, THE UNDERSIGNED, HEREBY CERTIFY THAT THE PROPOSED ENTRANCE(S) FOR THE ELIJAH WINN HOUSE PROJECT ARE DESIGNED WITH ADEQUATE CORNER SIGHT DISTANCE IN EACH DIRECTION. THE REGULATED SPEED LIMIT AT THE ENTRANCE IS 20 MILES PER HOUR. THE SIGHT DISTANCE PROVIDED AT THE ENTRANCE IS 65 FEET IN THE NORTH DIRECTION AND 45 FEET IN THE SOUTH DIRECTION.

THE CORNER SIGHT DISTANCE PROVIDED FROM THE ENTRANCE IS EQUAL TO OR EXCEEDS THE 45 FEET OF SIGHT DISTANCE REQUIRED IN THE UNIFIED DEVELOPMENT ORDINANCE. SIGHT DISTANCE IS MEASURED WITH THE DRIVER'S EYE HEIGHT OF 3.5 FEET AT A DISTANCE OF 15 FEET FROM THE NEAREST THROUGH LANE TO THE CENTER OF EACH TRAVEL LANE.

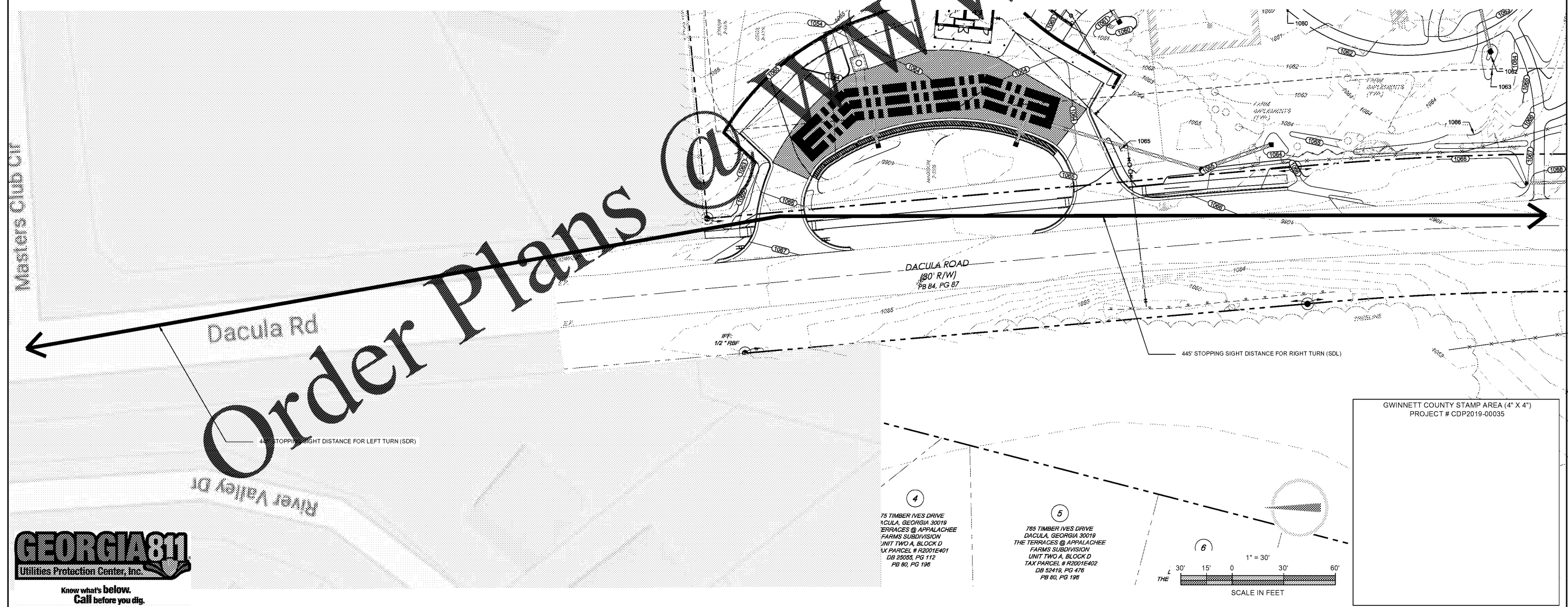

4
75 TIMBER IVES DRIVE
DACULA, GEORGIA 30019
ERRACES @ APPALACHEE
FARMS SUBDIVISION
UNIT TWO A, BLOCK D
UX PARCEL # R2001E401
DB 29053, PG 112
PB 80, PG 198

5
765 TIMBER IVES DRIVE
DACULA, GEORGIA 30019
THE TERRACES @ APPALACHEE
FARMS SUBDIVISION
UNIT TWO A, BLOCK D
TAX PARCELS # R2001E402
DB 52419, PG 476
PB 80, PG 198

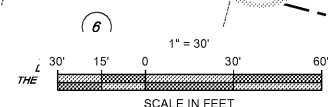

GWINNETT COUNTY STAMP AREA (4" X 4")
PROJECT # CDP2019-00035

ENGINEER:
FORESITE
group

Foresite Group, Inc. w | www.fg-inc.net
3740 Davinci Ct. o | 770.368.1399
Suite 100 f | 770.368.1944
Peachtree Corners, GA 30092

DEVELOPER:

75 LANGLEY DR.
LAWRENCEVILLE, GEORGIA 30046
770-822-8864
CONTACT: MR. REX SCHUDER

PROJECT:
ELISHA WINN HOUSE
SITE IMPROVEMENTS

908 DACULA RD
DACULA, GA 30019
LL # 1, DISTRICT 2, ZONE R-100
PARCEL # R2001 158, <#####>

SEAL:

4/08/19
GEORGIA LEVEL II CERTIFIED
PROFESSIONAL # 0000058923
EXPIRATION DATED: 08/21/2021

REVISIONS	DATE
△ GWINNETT CO. RESUBMITTAL	03/20/2019
△ GWINNETT CO. RESUBMITTAL	03/25/2019

PROJECT MANAGER: AWP
DRAWING BY: SSH
JURISDICTION: GWINNETT COUNTY
DATE: 08/10/2018
SCALE: 1" = 30'
TITLE:

SIGHT DISTANCE 1
SHEET NUMBER:
C-2.3
COMMENTS: RELEASED FOR CONSTRUCTION
JOB/FILE NUMBER: 223.082

