

**GENERAL NOTES:**

- 1) THE CONTRACTOR IS RESPONSIBLE FOR OBTAINING THE DEMOLITION PERMIT FROM GWINNETT COUNTY, GA PRIOR TO DEMOLITION OF THE SITE.
- 2) ALL INITIAL EROSION AND SEDIMENT CONTROL MEASURES SHALL BE INSTALLED PRIOR TO ANY WORK INCLUDING DEMOLITION.
- 3) ALL CONSTRUCTION RELATED PERMITS DURING THE CONSTRUCTION PHASE OF THIS PROJECT ARE THE RESPONSIBILITY OF THE CONTRACTOR.
- 4) REMOVE SHRUBS AND TREES AS NOTED. GRUB OUT ROOTS AND STUMPS AND LEGALLY DISPOSE OF DEBRIS.
- 5) CONTRACTOR SHALL BE FAMILIAR WITH AND FOLLOW ALL RECOMMENDATIONS GIVEN BY THE GEOTECHNICAL REPORT BY UNITED CONSULTING DATED 02/06/2019 DURING DEMOLITION AND SITE CONSTRUCTION.

**DEMOLITION NOTES:**

- 1) CONTRACTOR TO FLAG ALL TREES TO BE REMOVED FOR APPROVAL BY OWNERS REPRESENTATIVE PRIOR TO REMOVAL.
- 2) ALL NEW WORK SHOWN IN THESE SHEETS SHALL COMPLY WITH APPLICABLE STATE, FEDERAL, AND LOCAL BUILDING AND UTILITY INSTALLATION CODES.
- 3) ALL MATERIALS AND CONSTRUCTION METHODS SHALL BE IN ACCORDANCE WITH GWINNETT COUNTY DOT STANDARD SPECIFICATIONS FOR ROADS AND STRUCTURES EXCEPT IN CASES WHERE, WITHIN GWINNETT COUNTY, GA JURISDICTION, THE COUNTY STANDARD SPECIFICATIONS ARE MORE STRINGENT.
- 4) THERE MAY BE ADDITIONAL UTILITIES NOT SHOWN ON THESE PLANS. THE ENGINEER ASSUMES NO RESPONSIBILITY FOR LOCATIONS SHOWN, AND IT SHALL BE THE RESPONSIBILITY OF THE CONTRACTOR TO FIELD VERIFY THE LOCATIONS OF ALL UTILITIES WITHIN THE LIMITS OF CONSTRUCTION AND TO NOTIFY THE OWNER IN CASE OF DISCREPANCIES THAT AFFECT THE CONSTRUCTION PROJECT.
- 5) THE CONTRACTOR IS RESPONSIBLE FOR NOTIFICATION OF AND LIAISON WITH UTILITY COMPANIES IN THE PROCESS OF LOCATION AND RELOCATION OF AND TIE-IN TO PUBLIC UTILITIES.
- 6) CONTRACTOR IS RESPONSIBLE FOR ANY DAMAGE THAT MAY OCCUR TO ANY ADJACENT STRUCTURES OR PROPERTY, OR ANY EXISTING STRUCTURES WITHIN LIMITS OF CONSTRUCTION THAT ARE DESIGNATED ON THE PLANS TO REMAIN, AND SHALL REPAIR OR REPLACE SUCH DAMAGED PROPERTY TO THE PROPERTY OWNERS SATISFACTION AT NO COST TO THE OWNER.
- 7) THE CONTRACTOR SHALL NOT DEVIATE FROM THESE PLANS AND SPECIFICATIONS WITHOUT THE PRIOR WRITTEN CONSENT OF THE ENGINEER.
- 8) CONTRACTOR IS RESPONSIBLE FOR CONTACTING GWINNETT COUNTY, GA AND ALL EXISTING UTILITY PROVIDERS BEFORE REMOVING ANY/ALL UTILITIES FROM THEIR EXISTING LOCATION ON THE SITE. THE CONTRACTOR SHALL PERFORM ALL UTILITY DEMOLITION OR RELOCATION ACTIVITIES IN ACCORDANCE WITH THE EXISTING UTILITIES SPECIFICATIONS, MATERIALS, AND REQUIREMENTS.

- 9) THE CONTRACTOR SHALL SEQUENCE THE WORK AND PROVIDE TEMPORARY MEASURES AS NECESSARY TO MAINTAIN ACCESS TO THE SITE THROUGH ALL ENTRANCES AT ALL TIMES DURING CONSTRUCTION. TEMPORARY PROVISIONS MAY INCLUDE, BUT ARE NOT LIMITED TO, BARRICADES, FLASHING LIGHTS, FLAGMAN, TEMPORARY PAVEMENT, AND DIRECTIONAL SIGNAGE AS NECESSARY TO ACCOMPLISH THE WORK.
- 10) CONTRACTOR SHALL CONSIDER COORDINATION ASPECTS OF CRANES AND CONSTRUCTION EQUIPMENT OPERATIONS DURING DEMOLITION ACTIVITY.
- 11) CONTRACTOR EQUIPMENT SHALL NOT BE PARKED IN COUNTY, CITY OR STATE RIGHT-OF-WAY, AND MUST BE STORED WITHIN SITE.
- 12) COORDINATE WITH GWINNETT COUNTY, GA AS REQUIRED DURING ALL DEMOLITION AND NEW CONSTRUCTION ACTIVITIES.
- 13) APPROVAL OF THESE PLANS DOES NOT CONSTITUTE APPROVAL BY GWINNETT COUNTY, GA OF ANY LAND DISTURBING ACTIVITIES WITHIN WETLAND AREAS. IT IS THE RESPONSIBILITY OF THE PROPERTY OWNER TO CONTACT THE APPROPRIATE REGULATORY AGENCY FOR APPROVAL OF ANY WETLAND AREA DISTURBANCE.
- 14) ALL BUFFERS AND SAVE AREAS SHALL BE CLEARLY IDENTIFIED BY FLAGGING AND/OR FENCING PRIOR TO COMMENCEMENT OF ANY LAND DISTURBANCE.
- 15) THE CONTRACTOR SHALL DISPOSE OF ANY HAZARDOUS MATERIALS IN STRICT ACCORDANCE WITH ALL APPLICABLE LOCAL, STATE, AND FEDERAL LAWS.
- 16) ALL ITEMS DESIGNATED FOR REMOVAL SHALL BE LEGALLY DISPOSED OF, OFF SITE.
- 17) CONTRACTOR TO CONTACT UTILITIES PROTECTION CENTER PRIOR TO ANY EXCAVATION.
- 18) CONTRACTOR TO POT HOLE EXISTING WATER LINE, UNDERGROUND ELECTRICAL LINES, GAS LINE, UNDERGROUND TELEPHONE, FIBER OPTIC, AND ANY OTHER UTILITY LINES WITHIN THE RIGHT OF WAY DURING DEMOLITION ACTIVITIES AND COORDINATE FIELD LOCATIONS AND DEPTHS OF THESE UTILITIES WITH ENGINEER FOR PROPOSED UTILITY CROSSINGS AND PROPOSED PAVEMENT OVER EXISTING LINES. THESE LINES MAY REQUIRE RELOCATION.

**EROSION CONTROL NOTES**

- 19) EROSION CONTROL DEVICES ARE TO BE INSTALLED PRIOR TO ANY CLEARING OR EARTHWORK OPERATIONS AND SHALL BE MAINTAINED THROUGHOUT CONSTRUCTION AND UNTIL PERMANENT GROUND COVER IS ESTABLISHED IN ALL DISTURBED AREAS.
- 20) THE CONTRACTOR SHALL PROVIDE DUST CONTROL AND SHALL PROTECT ADJACENT PAVEMENTS FROM SOIL ACCUMULATION DURING CONSTRUCTION.
- 21) ADDITIONAL EROSION CONTROL DEVICES MAY BE REQUIRED BY THE ENGINEER OR OTHER INSPECTORS AS DETERMINED BY FIELD CONDITIONS.

SOIL TYPE	
Wre2	WEDOWEE SANDY LOAM, 10 TO 25 PERCENT SLOPES, ERODED
PB2	PACOLET SANDY LOAM, 2 TO 6 PERCENT SLOPES, MODERATELY ERODED
GeB2	GWINNETT CLAY LOAM, 2 TO 6 PERCENT SLOPES, ERODED
GeE2	GWINNETT CLAY LOAM, 10 TO 25 PERCENT SLOPES, ERODED

LEGEND	
[Symbol]	STRUCTURES TO BE REMOVED
[Symbol]	ASPHALT, GRAVEL, AND/OR CURB & GUTTER TO BE REMOVED
[Symbol]	TREES, BRUSH & SOD TO BE REMOVED
[Symbol]	EXISTING FENCE
[Symbol]	PROPERTY LINE
[Symbol]	LIMITS OF DISTURBANCE
[Symbol]	TREE PROTECTION FENCE
[Symbol]	EXISTING TREE TO BE REMOVED

EXISTING SITE DATA	
TOTAL SITE AREA *	58 AC.
TOTAL SITE DISTURBED AREA *	1.24 AC.
EXISTING PERVIOUS AREA	1.52 AC.
EXISTING IMPERVIOUS AREA	0.14 AC.

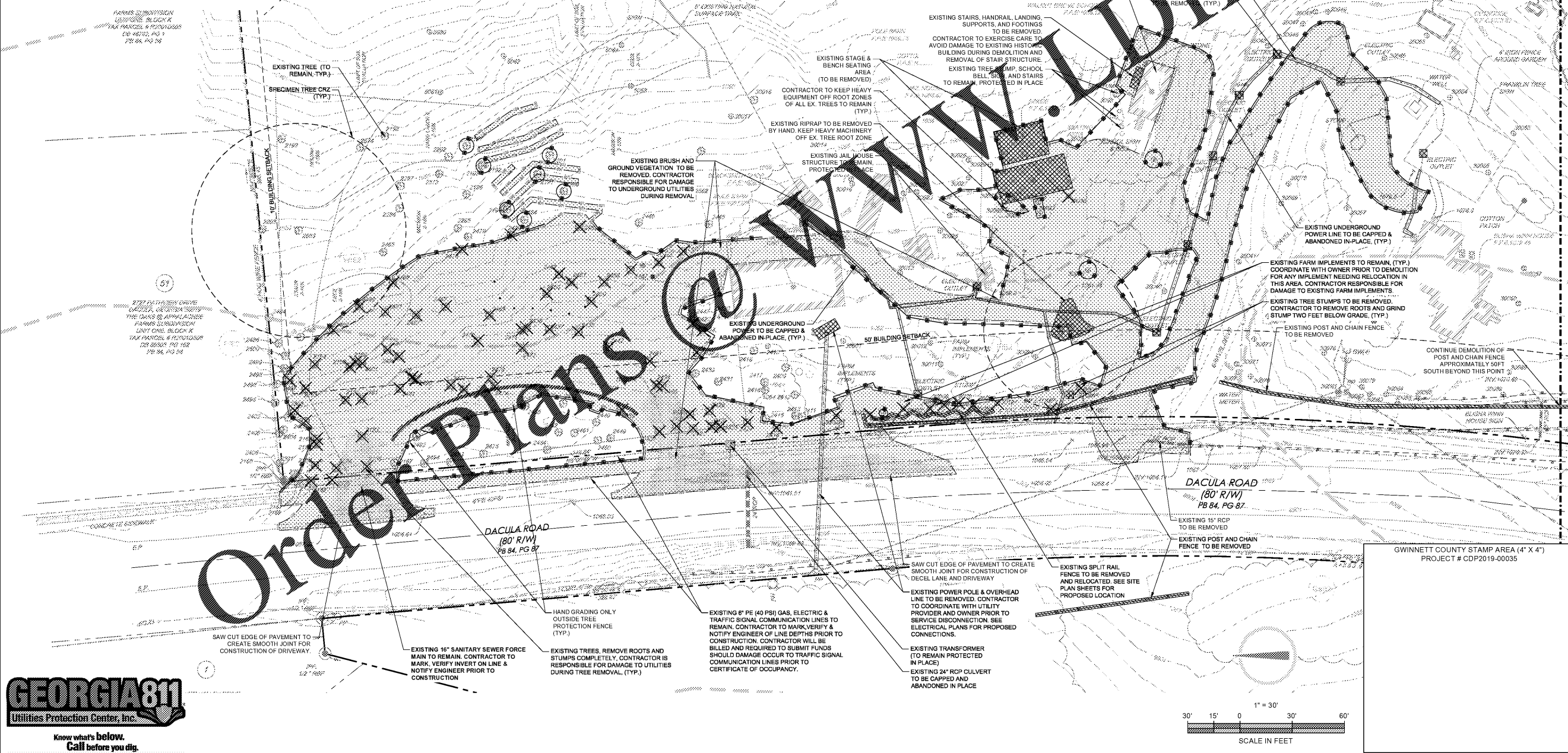

ENGINEER

**FORESITE**  
group

Foresite Group, Inc. | www.fg-inc.net  
3740 Davinci Ct. | 770.368.1399  
Suite 100 | 770.368.1944  
Peachtree Corners, GA 30092

DEVELOPER

75 LANGLEY DR.  
LAWRENCEVILLE, GEORGIA 30046  
770-822-8864

CONTACT: MR. REX SCHUDER

PROJECT:

**ELISHA WINN HOUSE**  
SITE IMPROVEMENTS

908 DACULA RD  
DACULA, GA 30019  
LL # 1, DISTRICT 2, ZONE R-100  
PARCEL #R2001 158

SEAL

4/08/19

GEORGIA LEVEL II CERTIFIED PROFESSIONAL # 000058923  
EXPIRATION DATED: 08/21/2021

REVISIONS	DATE
△ GWINNETT CO. RESUBMITTAL	03/20/2019
△ GWINNETT CO. RESUBMITTAL	03/25/2019

PROJECT MANAGER:	AWP
DRAWING BY:	SSH
JURISDICTION:	GWINNETT COUNTY
DATE:	08/10/2018
SCALE:	1" = 30'
TITLE:	

DEMOLITION PLAN

SHEET NUMBER: **C-0**

COMMENTS: RELEASED FOR CONSTRUCTION

JOB/FILE NUMBER: 223.082

**GEORGIA811**  
Utilities Protection Center, Inc.

Know what's below.  
Call before you dig.