

Belt Drive Upblast Centrifugal Roof Exhaust Fan

MARK INFORMATION		FAN INFORMATION							MOTOR INFORMATION					
QTY	MARK	MODEL	VOLUME (CFM)	TOTAL EXTERNAL SP (IN WG)	FAN RPM	OPERATING POWER (HP)	WEIGHT (LB.)	SIZE (HP)	V/C/P	ENCLOSURE	MOTOR RPM	WINDINGS	NEC FLA*	
1	M-4C - EF1	XRUB-180HP-20	2,500	1.75	1,416	1.25	136	2	208/60/3	OP	1725	1	7.5	

*NEC FLA - Based on tables 150 or 148 of National Electrical Code 2002. Actual motor FLA may vary, for sizing thermal overload, consult factory.

M-4C - EF1 : SELECTED OPTIONS AND ACCESSORIES

UL/cUL 762 Listed - "Power Ventilators for Rest. Exh. Appliances"
 Switch, NEMA-1, Toggle, Shipped with Unit
 Hinged Base (Attached)
 High Temp Curb Seal Rated for Continuous Duty at 2000 F (Attached)
 Grease Trap (PN 475538)
 Heat Baffle (Attached)
 Bearings with Grease Fittings, L10 life of 100,000 hrs (L50 avg. life 500,000 hrs)

Belt Drive Upblast Centrifugal Roof Exhaust Fan

MARK INFORMATION		FAN INFORMATION							MOTOR INFORMATION					
QTY	MARK	MODEL	VOLUME (CFM)	TOTAL EXTERNAL SP (IN WG)	FAN RPM	OPERATING POWER (HP)	WEIGHT (LB.)	SIZE (HP)	V/C/P	ENCLOSURE	MOTOR RPM	WINDINGS	NEC FLA*	
1	M-4C - EF2	XRUB-180HP-20	2,500	1.75	1,416	1.25	136	2	208/60/3	OP	1725	1	7.5	

*NEC FLA - Based on tables 150 or 148 of National Electrical Code 2002. Actual motor FLA may vary, for sizing thermal overload, consult factory.

M-4C - EF2 : SELECTED OPTIONS AND ACCESSORIES

UL/cUL 762 Listed - "Power Ventilators for Rest. Exh. Appliances"
 Switch, NEMA-1, Toggle, Shipped with Unit
 Hinged Base (Attached)
 High Temp Curb Seal Rated for Continuous Duty at 2000 F (Attached)
 Grease Trap (PN 475538)
 Heat Baffle (Attached)
 Bearings with Grease Fittings, L10 life of 100,000 hrs (L50 avg. life 500,000 hrs)

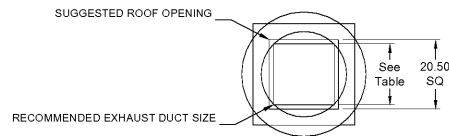

DUCT TYPE	SIZE
STANDARD	18 SQ
FIRE-WRAPPED	10 SQ

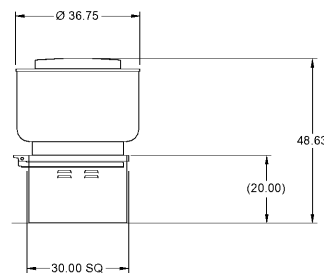
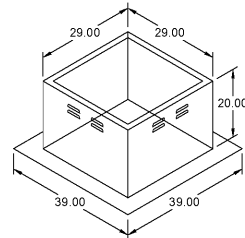

DUCT DIMENSIONS ARE LARGEST POSSIBLE TO FIT THROUGH CURB.
 CONSULT SYSTEM DESIGN ENGINEER FOR RECOMMENDED DUCT SIZE.

OVERALL HEIGHT MAY BE GREATER DEPENDING ON MOTOR.

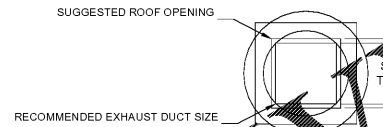

DUCT TYPE	SIZE
STANDARD	18 SQ
FIRE-WRAPPED	10 SQ

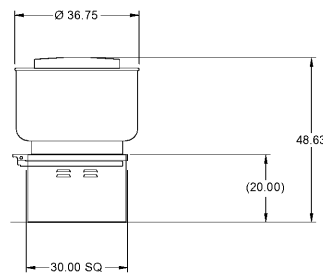
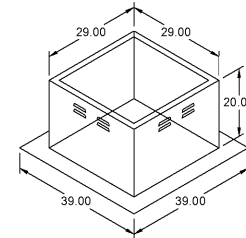

DUCT DIMENSIONS ARE LARGEST POSSIBLE TO FIT THROUGH CURB.
 CONSULT SYSTEM DESIGN ENGINEER FOR RECOMMENDED DUCT SIZE.

OVERALL HEIGHT MAY BE GREATER DEPENDING ON MOTOR.

Order Plans @

WWW.LDILine.com

ACCUREX

ACCUREX KS NE WESTERN MO
 BENJAMIN.OBRIEN@ACCUREX.COM
 (816)888 9742

PROJECT 5/31/2019
 MARK BAD DADDY'S MARIETTA GA
 M-4C - EF1, EF-2

Consultant:
ARWIN PRIEST P.E., P.Eng.
 MECHANICAL * ENGINEER * ELECTRICAL
 242 MOUNTAIN CLOUD CIRCLE
 HIGHLANDS RANCH, CO 80126
 (303) 898-2664 pc5744@gmail.com

5280 Engineering
 www.DesignMEP.com
 720-320-7744 rjg@5280engineering.com

SEAL

DATE :

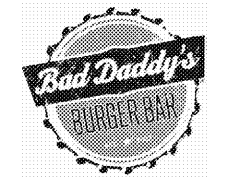

GOOD TIMES RESTAURANTS, INC.
 141 Union Blvd, Suite 410
 Lakewood, CO 80228
 tel: (303) 384-1430

BAD DADDY'S BURGER BAR
 "SANDY PLAINS"
 3460 SANDY PLAINS RD
 SUITE 110
 MARIETTA, GA 30062

Issue Record:
 06.07.2019 FOR PLAN REVIEW

Revisions:
 08.01.2019 BAR FIXT. TO GREASE WST.
 08.28.2019 QCR

Drawn:
 DRAWN BY: F Long

Checked:
 CHECKED BY: R Blank

Project No.
 PROJ.FCT#: 2019-041

Consultant:
 ACCUREX HOOD DESIGN

THESE DRAWINGS WERE OBTAINED FROM ACCUREX. VERIFY LATEST DRAWINGS PRIOR TO ORDERING EQMT