

1 CEILING PLAN

1/4" = 1'-0" NOTE:

GENERAL NOTES:

- DINING/BAR CEILINGS: PAINT EXPOSED DINING CEILING AREAS AT DINING PT-1A, UNLESS NOTED OTHERWISE.
- BATHROOM CEILINGS: PAINT BATHROOM CEILINGS PT-2.
- ALL LAYIN CEILINGS TO BE PROVIDED WITH VINYL FACED CEILING TILE (ACT-1).
- DINING DUCTWORK DIFFUSERS TO BE MILL ALUMINUM FINISH, DO NOT PAINT.
- PROVIDE WHITE SILICONE JOINT WHERE CEILING GRID MEETS FRP, TYP. ALL KITCHEN AREAS.

KEY NOTES:

- SOFFIT OR WALL MOUNTED TV.
- HEAVY DASHED LINE INDICATES SOFFIT THAT RUNS UP TO ROOF DECK.
- WALKIN BOX LIGHTS BY LIGHTING SUPPLIER. GC TO INSTALL.
- TV MOUNTED ON METAL SCREEN
- HANG TRACK LIGHTS FROM TRAPEZE AT 13'-0" IN OPEN DINING CEILING.
- NOT USED.
- INSTALL TECTUM BOARD TO BOTTOM OF ROOF DECK BETWEEN JOISTS, TYP. AT ALL OPEN CEILING AREAS OF DINING. GC TO PROVIDE AS SEPARATE LINE ITEM IN BID. PAINT EXPOSED FACES OF PANELS P-1A.
- PROVIDE HIGH LAYIN CEILING OVER MOP SINK AREA. LOCATE CEILING AS HIGH AS POSSIBLE BELOW ROOF STRUCTURE TO ALLOW MAXIMUM CLEARANCE FOR HOT WATER HEATER INSTALLATION & SERVICING.

CEILING FINISH: WALKIN, RAINMAN #F582-ORB, OIL RUBBED BRONZE FINISH, SEE ELEC. FOR LAMPING.

STRING LIGHTS @ 10'-1". WELD STEEL RINGS TO SUPPORT WIRE.

GYP. BD. CEILING TO MATCH TOP OF STOREFRONT.

LIGHTING SCHEDULE (ABBREV.): SEE A800 FOR COMPLETE SCHEDULE

SYMBOL	DESCRIPTION	MANUFACTURER	MODEL	REMARKS
A	PENDANT LIGHT, PUBLIC AREAS, DIMMABLE, LED	HI-LITE MFG.	FIXTURE: H-18116-96-CB8-91 LAMP: 9 WATT LED, GU-24 BASE	MOUNT B.O. LIGHT AT 10'-0" AFF IN OPEN CE AT 8'-0" OVER BOOTHS AT SOFFITS, OR UNLI CEILING PLAN. PROVIDE DIMMABLE LIGHT S
B	3" RECESSED LIGHT, DIMMABLE U.N.O., LED	CSL	FIXTURE: EDL-NC-WW-3, EDL-1302-3 TRIM LAMP: 2700K COLOR TEMPERATURE	MOUNT IN CEILING, LIGHTS TO BE DIMMABLE OTHERWISE ON CEILING PLAN
C	TRACK LIGHT, LED, DIMMABLE	JUNO LIGHTING GROUP	FIXTURE: RL541BL_TRACK R4BL, R8BL, R8BL LAMP: 12W LED, 2700K COLOR TEMPERATURE	MOUNT IN CEILING, LIGHTS TO BE DIMMABLE DIMMABLE LIGHT SWITCH
D	DECORATIVE PENDANT CHANDELIER, DIMMABLE, LED	HI-LITE MFG.	FIXTURE: HMCUS-6S-96-FR-XXST-HDMSC-96 LAMP: 9 WATT LED, GU-24 BASE	MOUNT B.O. LIGHT AT 10'-0" AFF, UNLESS NC PLAN. PROVIDE DIMMABLE LIGHT SWITCH.
F	2X4 RECESSED FLAT PANEL LED FIXTURE (KITCHEN)	BARRON LTG.	FIXTURE: TRACE LITE-LP24-47-39K	MOUNT IN LAYIN CEILING
F2	2X2 RECESSED FLAT PANEL LED FIXTURE (KITCHEN)	BARRON LTG.	FIXTURE: TRACE LITE-LP22-40-39K	MOUNT IN LAYIN CEILING
G	VANITY LIGHT (BATHROOMS), DIMMABLE, LED	HI-LITE MFG.	FIXTURE: H-CGU-F2F-98 LAMP: 9 WATT LED, GU-24 BASE	MOUNT CENTER OF LIGHT ARM TO WALL AT VANITY
K	PENDANT LIGHT (BAR), DIMMABLE, LED	HI-LITE MFG.	FIXTURE: H-GCU-10-FR-CB8-91 LAMP: 9 WATT LED, GU-24 BASE	SUSPEND LIGHT FROM ROOF DECK WITH B.C BARS, 8'-0" AT STANDARD BARS (BAR BACKL CONFIGURATIONS. PROVIDE DIMMABLE LIGI
LB	LED TAPE LIGHT (UNDER BAR COUNTER, BARTENDER SIDE)	LED INSPIRATIONS	FIXTURE: NU-V2-2700-SB, MOUNT IN STRIPCHAN8	SEE DETAIL 3/A400, DIMMER CONTROL SEPA
LC	LED TAPE LIGHT (UNDER BAR COUNTER, CUSTOMER SIDE)	LED INSPIRATIONS	FIXTURE: NU-V2-2700-SB, MOUNT IN STRIPCHAN8	SEE DETAIL 3/A400, DIMMER CONTROL SEPA
O	PATIO DECORATIVE FESTOON LIGHT, (LED)	AMERICAN LIGHTING	FIXTURE: LS-1-15-BK-330 LAMP: 1W LED - PG40-E17-WW	SUSPEND STRING LIGHTS TAUGHT AND LEV BOLTED TO PERIMETER WALL.
W	LOW PROFILE ENCLOSED GASKETED WET LOCATION LED FIXTURE	LITHONIA	FIXTURE: FEM-L48-4000LM-LPACL-MVOLT-GZ10-40K-80CRI	

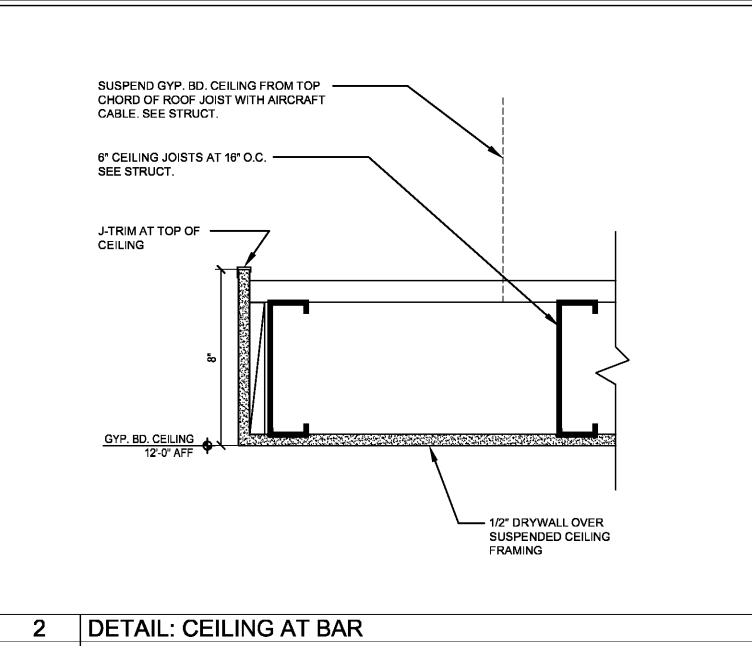

2 DETAIL: CEILING AT BAR

3" = 1'-0" NOTE:

CONSULTANT:
JOHN SPONSELLER, ARCHITECT
8025 W. 25TH PL.
LAKEWOOD, CO 80214
TEL: (303) 815-0161

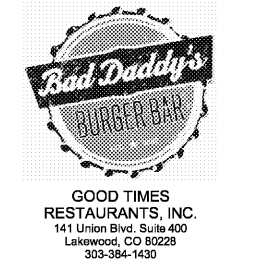

BAD DADDY'S BURGER BAR "SANDY PLAINS"
3460 SANDY PLAINS RD N.E.
SUITE 110
MARIETTA, GA 30062

Issue Record:

6.7.2019	FOR PLAN REVIEW

Revisions:

08.01.2019	BAR FIXT. TO GREASE WST.
08.28.2019	OWNER REVS

Drawn:
DRAWN BY: JS, KC

Checked:
CHECKED BY: JS

Project No.
PROJECT#: 19-213

Contact:

CEILING PLAN

A140

Date of Last Print:
8.28.2019