

Consultant  
**W** WESTSIDE  
 5525 Interstate North Pkwy  
 Suite 200  
 Atlanta, GA 30328  
 404-965-1287 tel  
 404-601-9859 fax  
 westside@westside-engineering.com

**EDGAR'S ABOVE BROAD  
 699 BROAD ST.  
 AUGUSTA, GEORGIA 30901**

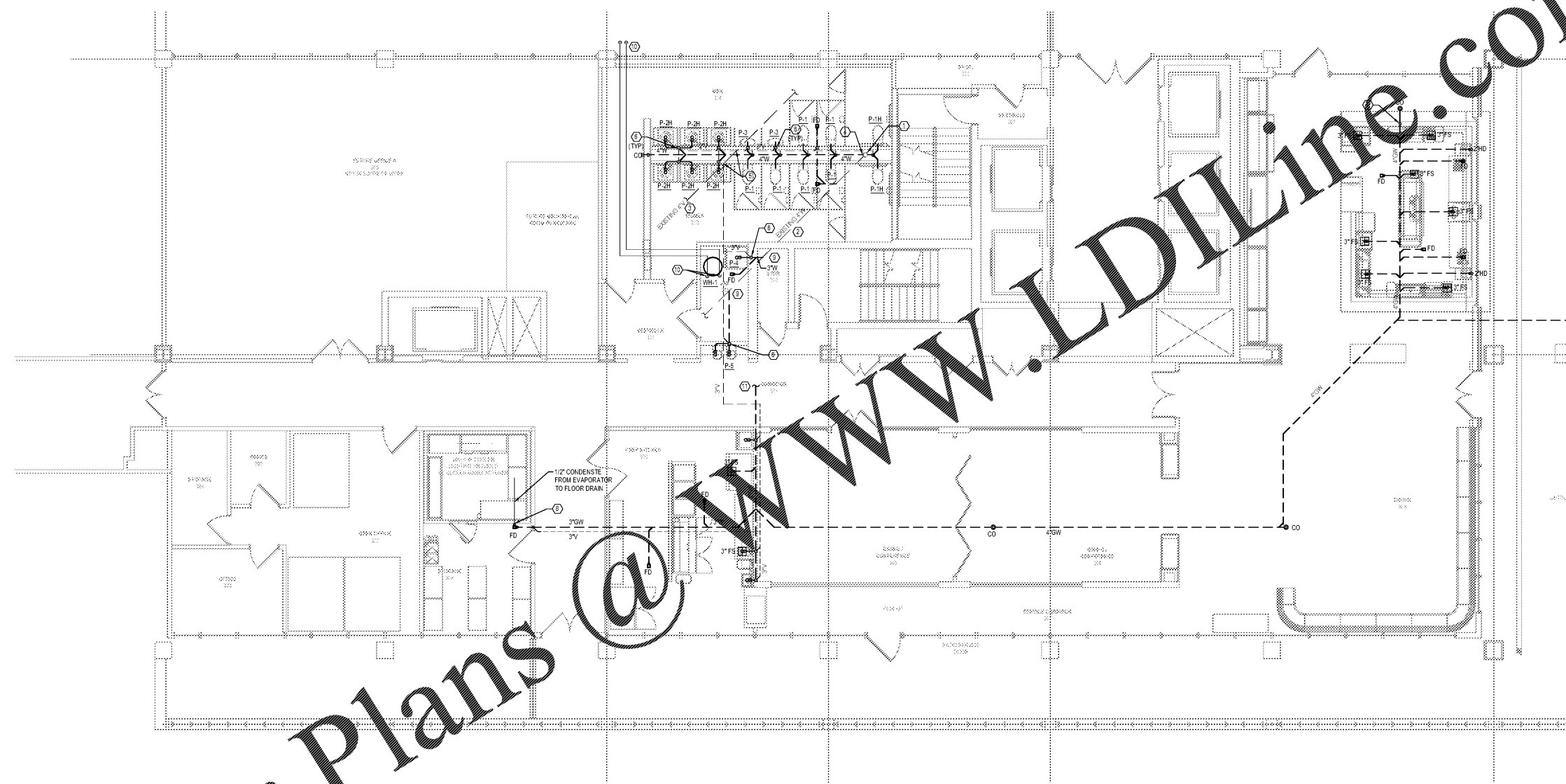

Order Plans @ [www.LDILine.com](http://www.LDILine.com)

**1 PLUMBING PLAN - SAN & VENT**  
 SCALE: 3/16" = 1'-0"

**GENERAL NOTES: (APPLY TO THIS SHEET ONLY)**

- ROUTE ALL KITCHEN EQUIPMENT DRAINS TO NEAREST FLOOR SINK, HUB DRAIN, OR FLOOR DRAIN WITH FUNNEL. SEE FOOD SERVICE DRAWINGS FOR EQUIPMENT CONNECTION LOCATIONS AND SIZES.
- FLOOR TROUGH PROVIDED BY KITCHEN EQUIPMENT VENDOR SHALL BE INSTALLED BY THIS CONTRACTOR.

**KEY NOTES: ○**

- EXISTING 6" SAN STACK. FIELD VERIFY EXACT LOCATION.
- EXISTING 4" SAN B/F. FIELD VERIFY EXACT LOCATION.
- EXISTING 4" VENT A/C. FIELD VERIFY EXACT LOCATION.
- CONNECT NEW 4"W TO EXISTING 6" SAN STACK BELOW FLOOR AS SHOWN.
- CONNECT NEW 3"V TO EXISTING 4" VENT PIPE ABOVE CEILING AS SHOWN.
- 2"W S/V.
- INSTALL AIR ADMITTANCE VALVE FOR VENT. AIR ADMITTANCE VALVE SHALL BE 4" STIDER MANU VENT OR APPROVED EQUAL CAPABLE OF VENTING UP TO 500 DRU. VALVE SHALL BE INSTALLED 8" MINIMUM ABOVE FLOOD LEVEL OF ALL CONNECTED FIXTURES.
- 1/2" CONDENSATE DN OUTSIDE THE COOLER WALL TO INDIRECTLY DRAIN INTO FLOOR DRAIN.
- CONNECT NEW 4"W TO EXISTING SAN PIPING BELOW FLOOR. FIELD VERIFY EXACT LOCATION.
- PROVIDE COMBUSTION AIR AND FLUE PIPING FROM WATER HEATER TO OUTDOOR SOFFIT. COMBUSTION AIR PIPE OPENING SHALL BE PROTECTED WITH 1/2" SCREEN. PIPING MATERIAL AND SIZE SHALL BE AS SPECIFIED BY THE WATER HEATER MANUFACTURER.
- CONNECT NEW 4" GW TO EXISTING GW RISER. FIELD VERIFY EXACT LOCATION.

|                  |          |                            |
|------------------|----------|----------------------------|
| Project Number   |          | 1817                       |
| Revisions        |          |                            |
| Revision History |          |                            |
| Number           | Date     | Description                |
|                  | 08/30/19 | ISSUED FOR CONSTRUCTION    |
| Drawing Title    |          | PLUMBING PLAN - SAN & VENT |
| Drawing Status   |          | ISSUED FOR CONSTRUCTION    |
| Drawing Number   |          |                            |