

Order Plans @ www.LDILine.com

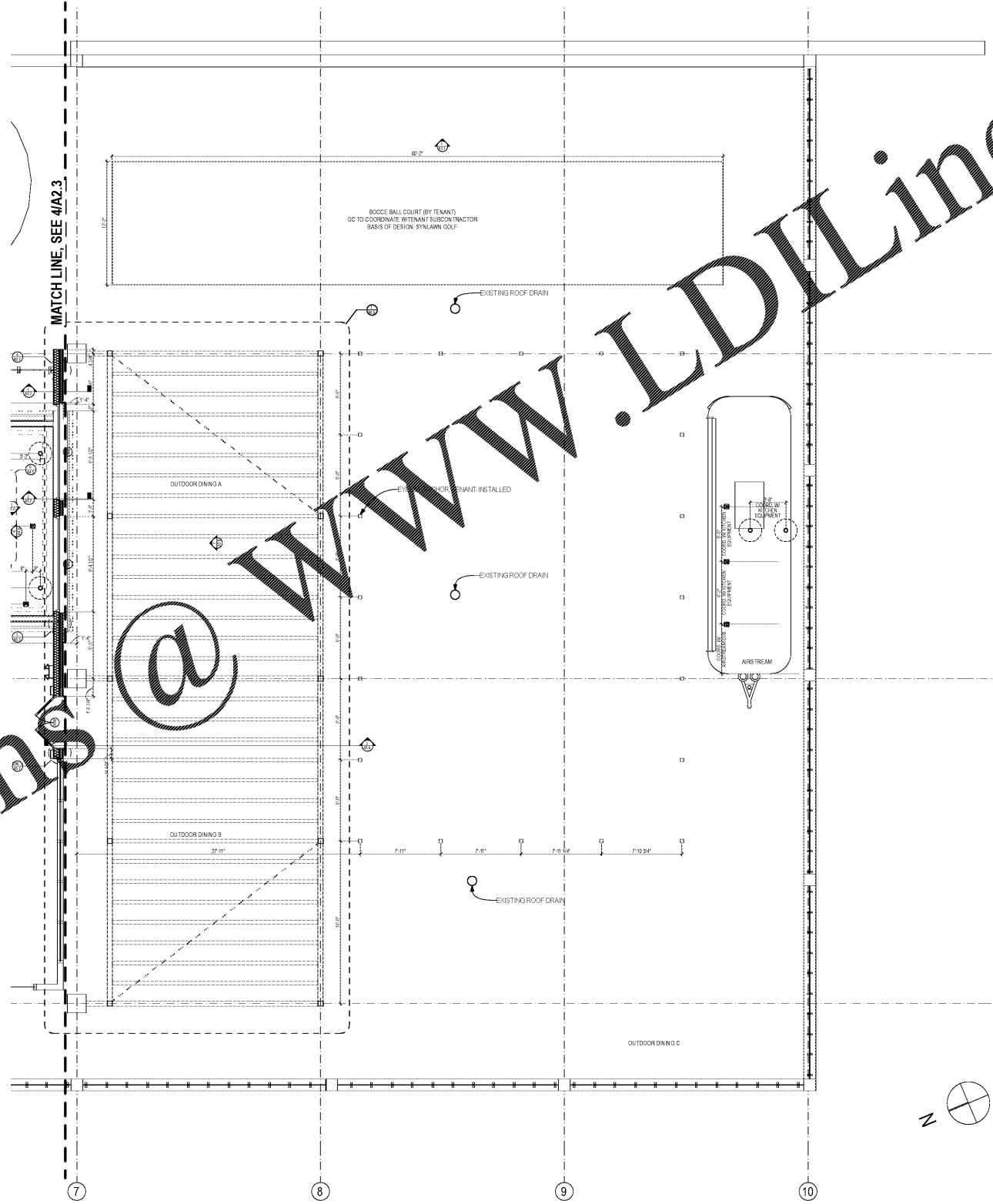

1 3RD FLOOR PLAN
SCALE: 3/16" = 1'-0"

<p>FLOOR PLAN KEY</p> <p>— EXISTING WALL TO REMAIN</p> <p>▨ EXISTING BRICK WALL TO REMAIN</p>	
<p>FLOOR PLAN GENERAL NOTES</p> <p>1. GENERAL CONTRACTOR TO CONFIRM DIMENSIONS ON-SITE. CONTACT ARCHITECT IF DISCREPANCY IS FOUND BETWEEN PLAN DIMENSIONS AND ON-SITE DIMENSIONS.</p> <p>2. CLEAR MIN. SPECIFIED DIMENSIONS MUST BE MAINTAINED FOR CODE COMPLIANCE OR FIXTURE REQUIREMENTS.</p> <p>3. DO NOT SCALE DIMENSIONS OR FINISH HATCHES FROM DRAWINGS.</p> <p>4. PROTECT ALL EXISTING FINISHES TO REMAIN. PATCH AND REPAIR AS REQUIRED.</p>	
<p>PARTITION KEY</p> <p>— THE LAST LETTER REPRESENTS THE FINISH TYPE LISTED BELOW FOR THE PARTITION</p> <p>— THE FIRST LETTER REPRESENTS THE FINISH TYPE LISTED BELOW FOR THE REAR SIDE OF THE PARTITION</p> <p>— THE NUMBER REPRESENTS THE PARTITION TYPE LISTED BELOW</p> <p>310 INVERTED BACKGROUND ON PARTITION TAG REPRESENTS RATED WALL CONSTRUCTION</p>	
<p>NOTES</p> <p>1. ALL DIMENSIONS ARE FROM METAL STUD TO THE FACE OF EXISTING CONCRETE BLOCK OR COLUMN LINE.</p> <p>2. SEE INTERIOR ELEVATIONS FOR DIMENSIONAL EXTENTS OF FINISHES.</p> <p>3. SEE PRODUCT INFORMATION SHEET FOR MATERIAL SPECIFICATIONS.</p> <p>4. GC TO VERIFY ALL EXTERIOR WALL CAVITIES PROVIDE A MINIMUM INSULATION VALUE OF R-19.</p> <p>5. SEE INTERIOR ELEVATIONS, BASIS OF DESIGN SPREADSHEET, AND FINISH PLANS FOR ADDITIONAL FINISH INFORMATION.</p> <p>— LINE INDICATED LOCATION OF RETRACTABLE INSECT SCREEN SYSTEM. SCREENS TO REMAIN CLOSED WHILE WINDOWS / DOORS ARE OPEN.</p>	
<p>PARTITION TYPES:</p> <p>FRAMING</p> <p>0 EXISTING FRAMING</p> <p>1 3/8" STEEL STUDS @ 24" O.C. MAX.</p> <p>2 3/8" STEEL STUDS @ 24" O.C. MAX. WITH SOUND-ATTENUATING BATT INSULATION.</p> <p>3 3/8" STEEL STUDS @ 24" O.C. MAX. WITH SOUND-ATTENUATING FIRE BLANKET.</p> <p>4 3/8" STEEL STUDS @ 18" O.C. MAX. MIN. 3/4" MINERAL WOOL BATT INSULATION.</p> <p>5 1" STEEL STUDS @ 24" O.C. MAX.</p> <p>6 1" STEEL STUDS SPACED 24" O.C. MAX. MIN. 3/4" MINERAL WOOL BATT INSULATION. 2x-6A 1/2" FURRING CHANNELS INSTALLED HORIZONTALLY @ 24" O.C.</p> <p>7 1" STEEL STUDS SPACED 24" O.C. MAX. MIN. R-19 CONT. INSULATION.</p> <p>8 7/8" STEEL STUDS @ 24" O.C. MAX.</p> <p>9 7/8" METAL FURRING CHANNELS @ 24" O.C. MAX.</p> <p>MATERIALS</p> <p>A 5/8" GYP. BOARD</p> <p>B 5/8" TYPE-X GYP. BOARD TO STRUCTURE</p> <p>C 5/8" CEMENTITIOUS BACKER BOARD</p> <p>D 5/8" CEMENTITIOUS BACKER BOARD TO STRUCTURE</p> <p>E 5/8" BUILDING SHEATHING</p> <p>NOTE: SEE SHEET A6.0 FOR DOOR SCHEDULE AND HARDWARE</p>	
<p>SLAB PLAN LEGEND</p> <p>⊙ FLOOR DRAIN SLOPE FLOOR TO DRAIN</p> <p>Ⓚ FLOOR SINK COORDINATE LOCATION WITH KITCHEN EQUIPMENT</p>	
<p>SLAB PLAN GENERAL NOTES</p> <p>1. VERIFY ALL EXISTING FIELD CONDITIONS AND DIMENSIONS PRIOR TO INSTALLATION OF UNDER SLAB APPURTENANCES. NOTIFY ARCHITECT OF ANY DISCREPANCY WITH DRAWINGS AND EXISTING CONDITIONS.</p> <p>2. ALL DIMENSIONS ARE TO EXISTING COLUMN LINES.</p> <p>3. FOR ALL DRAINS AND SINKS TO BE INSTALLED IN QUARRY TILE FLOORING - SET DRAIN HIGH PER FLOORING MANUFACTURER SPECIFICATIONS.</p> <p>4. SEE SHEET A1 FOR PRODUCT SPECIFICATIONS.</p> <p>5. ALL DIMENSIONS ARE FROM COLUMN LINE AND/OR CENTER OF FIXTURE UNLESS NOTED OTHERWISE.</p> <p>6. PROVIDE 2" RADIUS SLOPED FLOOR DRAIN. SET DRAIN 1/2" BELOW FINISHED FLOOR TYPICAL. AT ALL DASHED CIRCLES ON SLAB PLAN.</p> <p>7. PROVIDE 12" LEAVE OUT AROUND ENTIRE TROUGH DRAIN. INS ALL DRAIN 1" BELOW FIN. SLOPE CONCRETE TO DRAIN AND DRAIN. PATCH SLAB W/ #3 @ 24" O.C. TYPICAL. COORDINATE SIZE WITH KITCHEN EQUIPMENT.</p> <p>8. COORDINATE FLOOR SINK LOCATIONS WITH KITCHEN EQUIPMENT AND PLUMBING DRAWINGS.</p> <p>9. TRANSITIONS TO FOLLOW WALL LOCATIONS ON A2.3 AND A2.4</p>	

seiberdesign

675 Drewry St. NE
Studio 10
Atlanta GA 30308
404.875.9785
www.seiberdesign.com

8/30/19

EDGAR'S ABOVE BROAD + LANDLORD BUILDOUT
699 BROAD ST.
AUGUSTA, GEORGIA 30901

Project Number
1617

Revisions

Number	Date	Description
1		<NAME OF ISSUE> RELEASE FOR

Drawing Title
THIRD FLOOR PLAN

Drawing Status
ISSUED FOR CONSTRUCTION

Drawing Number
A2.4