



SCOPE DOCUMENTS

The Contract Documents issued for (Conceptual Design, Schematic Design, Design Development, Partial Construction Documents or Other Issuance up to Issued for Construction) are intended to be at that level of completion and as such, may be further complete and coordinated. The (Construction Manager, Contractor, Design/Builder) is responsible for complete and coordinated pricing (and execution) of the Work, and shall include items necessary for the proper execution and completion of the Work, as shown, specified, reasonably inferred or required for a complete Project. For Work of designed designs, systems, assemblies, components and materials shall comply with national, state and local code requirements. The (Construction Manager, Contractor, Design/Builder) shall inform the Owner and Architect, in timely fashion, of any discovered omissions, inconsistencies or errors in the Contract Documents.

ISSUANCES		
No.	Drawing Issue Description	Date
	INTERIORS PRICING SET	08/13/19

WWW.LDILine.com

Order Plans

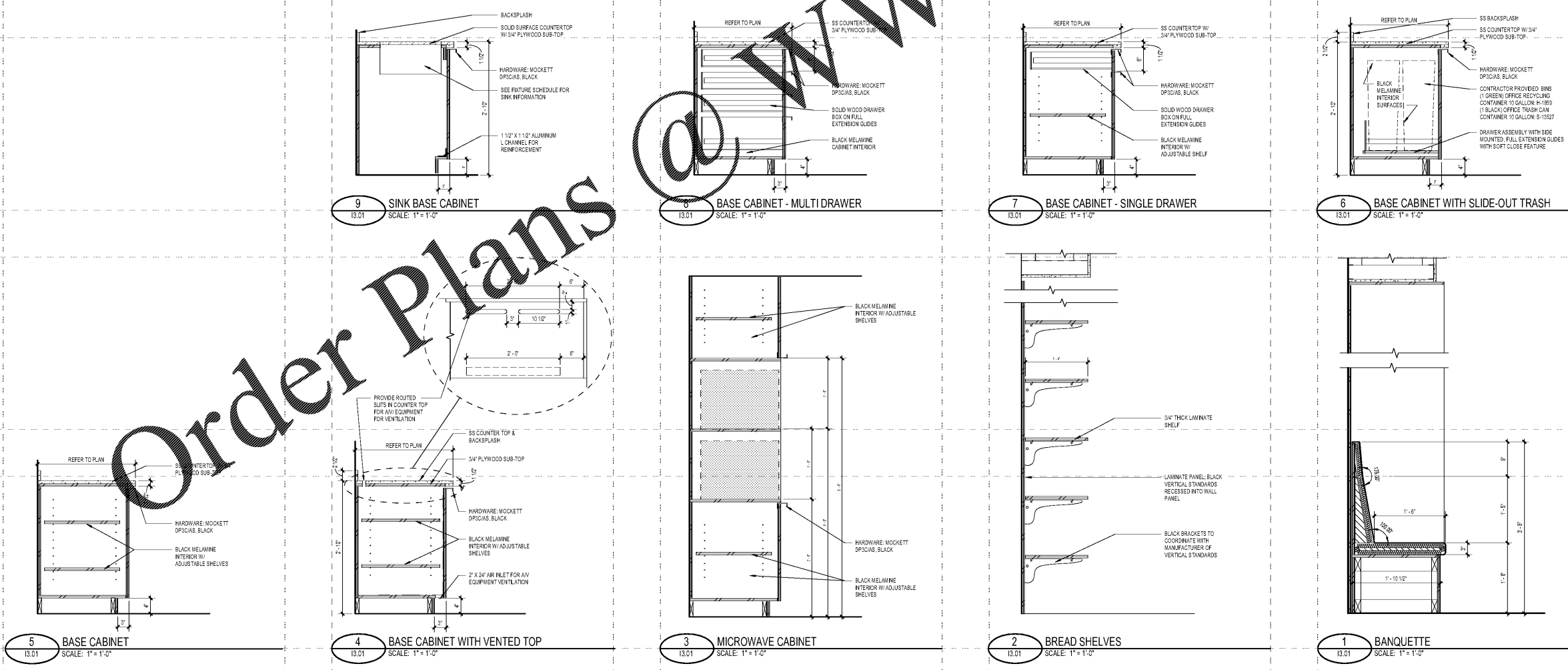

PROJECT NUMBER: 20180316 PROJECT NAME: St Vincent de Paul Georgia Council Headquarters
SHEET NUMBER: 03.01 INTERIOR DETAILS
M:\2018\20180316\03-7 Drawings\03-7-1 Revit\Users\0180316_2017_SVOP_07302019_baird02244.rvt
8/14/2019 10:40:10 AM

**St Vincent de Paul Georgia
Council Headquarters**

2050 Chamblee Tucker Rd
Unit C D & E
Chamblee, GA 30314

St Vincent de Paul Georgia

INTERIOR DETAILS

BRIAN PARKER 20180316
Principal Designer
GHENETH KOVAR 08/13/2019
Project Manager
M.S. & M.B.
Project Architect
WIVIAN MOWWANJA
SAP Architect

13.01