



SCOPE DOCUMENTS

The Contract Documents issued for (Conceptual Design, Schematic Design, Design Development, Partial Construction Documents or Other Issuance up to Issued for Construction) are intended to be at that level of completion and as such, may be neither complete nor coordinated. The (Construction Manager, Contractor, Design/Builder) is responsible for complete and coordinated pricing (and execution) of the Work, and shall include items necessary for the proper execution and completion of the Work, as shown, specified, reasonably inferred or required for a complete Project. For Work of designed designs, systems, assemblies, components and materials shall comply with national, state and local code requirements. The (Construction Manager, Contractor, Design/Builder) shall inform the Owner and Architect, in timely fashion, of any discovered omissions, inconsistencies or errors in the Contract Documents.

ISSUANCES

No.	Drawing Issue Description	Date
1	INTERIORS PRICING SET	08/13/19

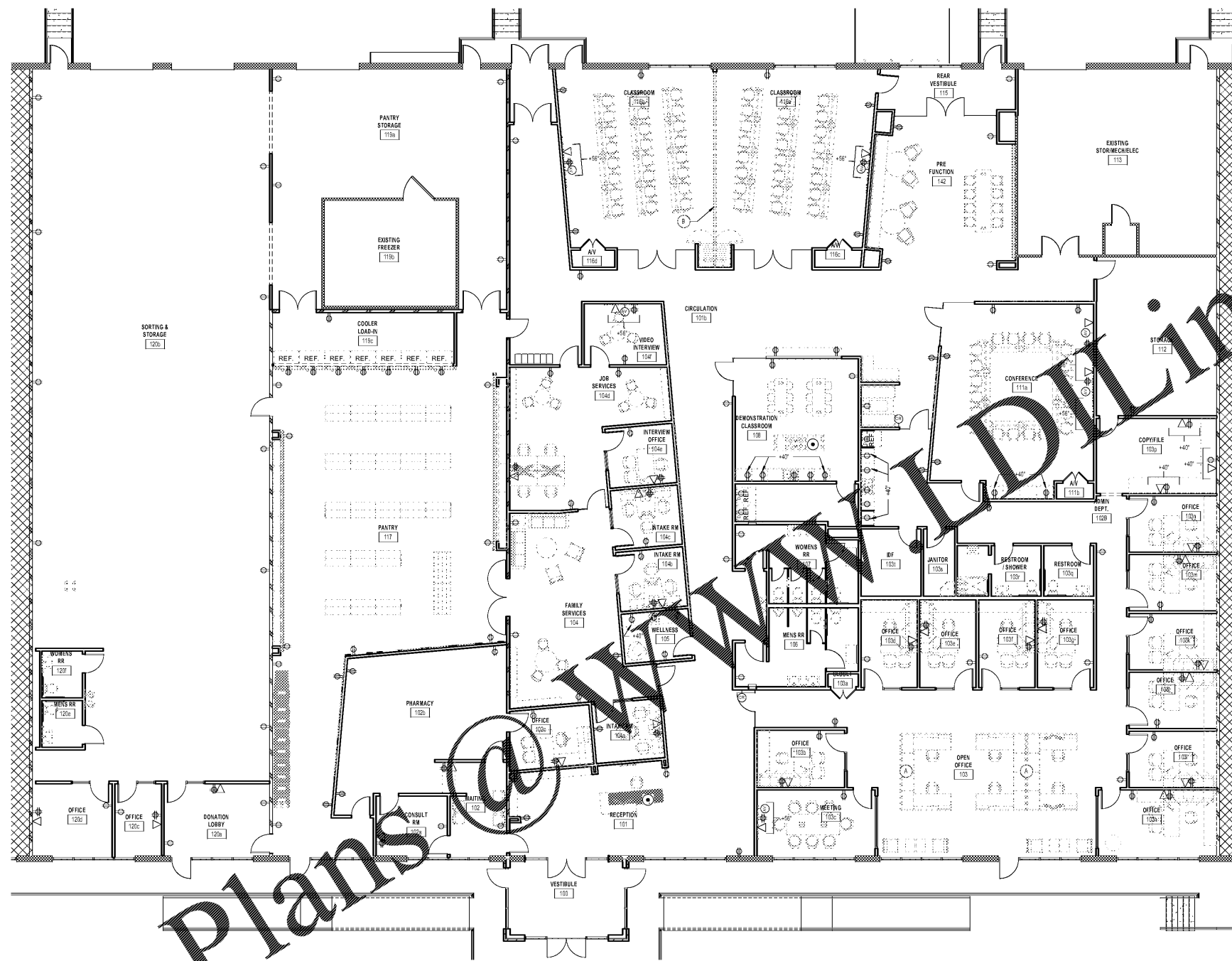

1 POWER AND COMMUNICATION PLAN
11.12
SCALE: 1/8" = 1'-0"

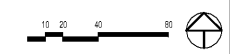

Order Plans @ www.dline.com

POWER & COMMUNICATION PLAN KEY NOTES

- A. POWER POLE AT THIS LOCATION - PROVIDE NECESSARY POWER, DATA AND CABLING FROM ABOVE.
- B. PROVIDE ELECTRICAL CONTROLS FOR OPERABLE PANEL PARTITION PER MANUFACTURER'S REQUIREMENTS

POWER & COMMUNICATION PLAN GENERAL NOTES

1. OUTLET LOCATION DIMENSIONS ARE TO CENTERLINE (IF A SINGLE OUTLET) OR TO CENTER OF A PANEL CENTER OF OUTLET(S) UNO.
2. WALL OUTLET HEIGHTS ARE TO BE 1'-0" A.F.F. UNO.
3. FLOOR OUTLET LOCATIONS WHICH CONFLICT WITH STRUCTURE SHALL BE REVIEWED BY DESIGNER BEFORE BEING RELOCATED.
4. FLOOR AND WALL OUTLETS IN PANS CLUSTERS SHALL BE 1" CENTER TO CENTER UNO.
5. WALL FACE PLATES SHALL BE WHITE UNO. COORDINATE WITH ARCHITECT AT WOOD OR OTHER SPECIALTY FINISH.
6. TELEPHONE SPEAKER, DATA AND ALL OTHER SUCH CABLE IN WALLS AND CEILING PLENUM SPACE SHALL BE INSTALLED IN ACCORDANCE WITH ALL APPLICABLE CODES AND WITH THE REQUIREMENTS OF THE PARTICULAR VENDOR(S) SUPPLIER INVOLVED.
7. AUDIO VISUAL ALARMS TO BE MOUNTED AT 8'-0" A.F.F. AND IS TO BE INSTALLED AND COMPLY WITH ADA ACCESSIBILITY GUIDELINES.
8. COORDINATE FLOOR CORE AND WALL OUTLET LOCATIONS WITH FURNITURE.
9. MAINTAIN REPAIR FIRE RATINGS WHERE FIRE RATED WALLS ARE PENETRATED.
10. ALL TELEPHONE OUTLETS TO BE 4'-0" A.F.F. UNO.
11. ARCHITECTURAL POWER AND DATA PLANS FOR GENERAL INFORMATION AND OUTLET LOCATION ONLY. REFER TO ELECTRICAL PLANS FOR MORE INFORMATION. NOTIFY ARCHITECT IF THERE IS A CONFLICT BETWEEN DRAWINGS.
12. CONTRACTOR SHALL COORDINATE OUTLETS LOCATED INSIDE CABINETS WITH THE MILLWORK CONTRACTOR.
13. VERIFY LOCATION OF NEW CARD READER SECURITY PANEL WITH OWNER AND SECURITY CONSULTANT.
14. LOCATIONS OF OUTLETS IN OFFICES TO BE COORDINATED WITH FURNITURE CENTER.
15. PROVIDE POWER FOR MOTORIZED SHADERS REFER TO REFLECTED CEILING PLANS FOR LOCATIONS.
16. STAGGER RECEPTACLES WHEN LOCATED BACK TO BACK ON WALLS.

SYMBOL LEGEND

- WALL MOUNT - DUPLEX RECEPTACLE
- WALL MOUNT - QUADRIplex RECEPTACLE
- WALL MOUNT - DEDICATED OUTLET
- FLOOR MOUNT - FLUSH MOUNT CORE COMBINATION POWER / DATA / AV
- FLOOR MOUNT - FLOOR CORE WEED FOR WORKSTATION. COORDINATE WITH FURNITURE MANUFACTURER FOR EXACT REQUIREMENTS
- WALL MOUNT - AV JUNCTION W/ CONDUIT AND PULL STRING TO CEILING
- WALL MOUNT - DATA OUTLET (2 WIRE PULL UNO)
- CARD READER
- REQUEST TO EXIT
- MAG LOCK
- MOTION SENSOR
- ELECTRIC STRIKE
- LIMITED SCOPE
- AREA NOT IN SCOPE

St Vincent de Paul Georgia
Council Headquarters

2050 Chamblee Tucker Rd
Unit C D & E
Chamblee, GA 30314

St Vincent de Paul Georgia

POWER AND COMMUNICATION PLAN

BRIAN PARKER Principal Designer	20180316
GIVENETH KOVAR Project Manager	08/13/2019
M.S.A.M.B. Project Architect	Date
WIVAN MOGWANJA Staff Architect	

11.12

PROJECT NUMBER: 20180316 PROJECT NAME: St Vincent de Paul Georgia Council Headquarters
SHEET NUMBER: 11.12 POWER AND COMMUNICATION PLAN
M:\2018\20180316\07 Drawings\11.12 Power and Communication Plan.dwg
8/14/2019 10:39:21 AM