

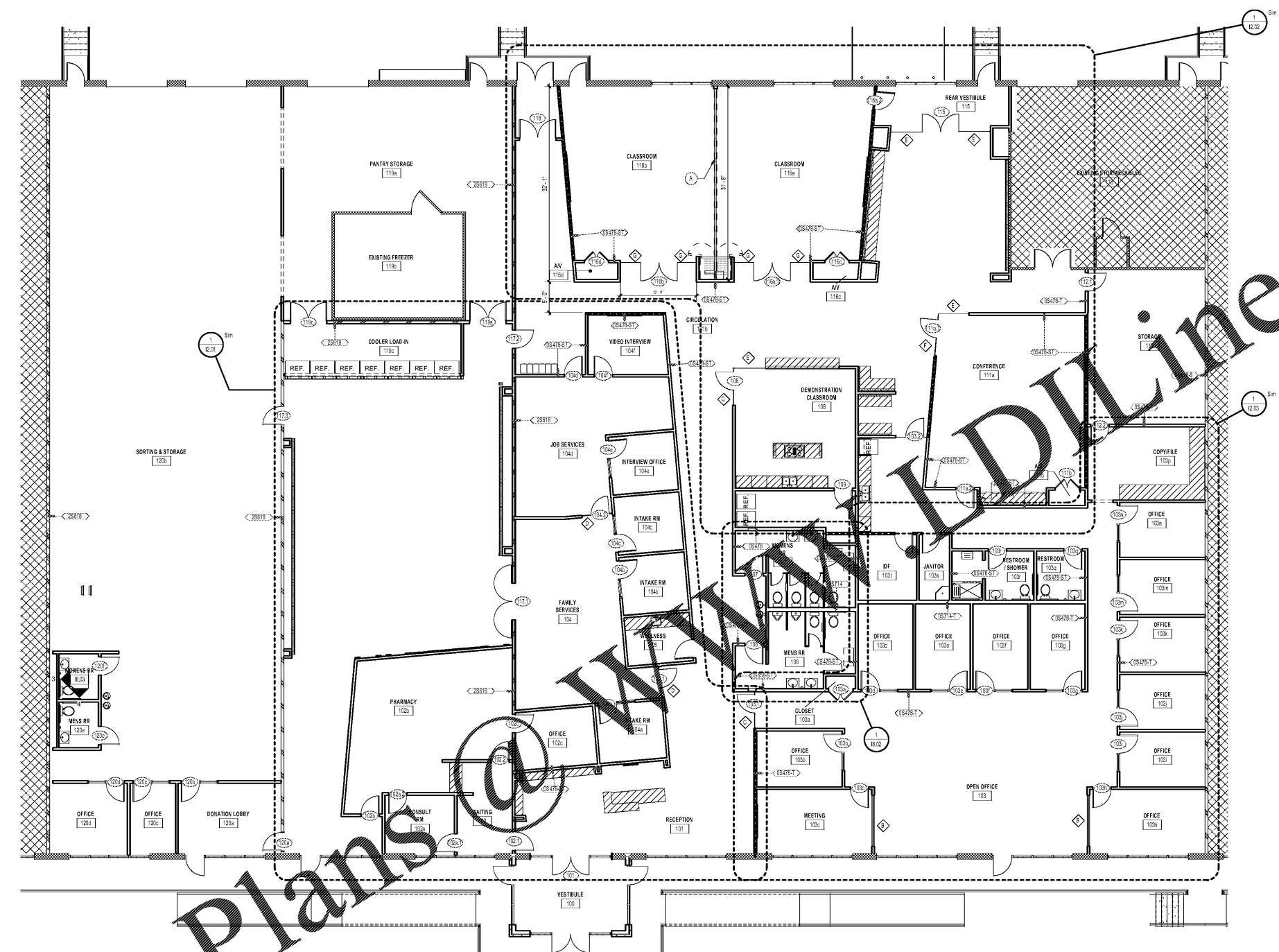

**SCOPE DOCUMENTS**  
The Contract Documents issued for (Conceptual Design, Schematic Design, Design Development, Partial Construction Documents or Other Issuance up to Issued for Construction) are intended to be at that level of completion and as such, may be neither complete nor coordinated. The (Construction Manager, Contractor, Design/Builder) is responsible for complete and coordinated pricing (and execution) of the Work, and shall include items necessary for the proper execution and completion of the Work, as shown, specified, reasonably inferred or required for a complete Project. For Work of designed designs, systems, assemblies, components and materials shall comply with national, state and local code requirements. The (Construction Manager, Contractor, Design/Builder) shall inform the Owner and Architect, in timely fashion, of any discovered omissions, inconsistencies or errors in the Contract Documents.

ISSUANCES		
No.	Drawing Issue Description	Date
1	INTERIORS PRICING SET	08/13/19



1 FLOOR PLAN  
SCALE: 1/8" = 1'-0"

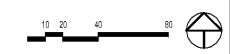

Order Plans @ [www.wdwonline.com](http://www.wdwonline.com)

**St Vincent de Paul Georgia Council Headquarters**

2050 Chamblee Tucker Rd  
Unit C D & E  
Chamblee, GA 30314

St Vincent de Paul Georgia

**FLOOR PLAN**

BRIAN PARKER Principal Designer	20180316
GIVENETH KOVAR Project Manager	08/13/2019
M.S. & M.B. Project Architect	
WIVIAN MOWWANJA Staff Architect	

11.10

PROJECT NUMBER: 20180316 PROJ NAME: St Vincent de Paul Georgia Council Headquarters  
SHEET NUMBER: 11.10 FLOOR PLAN  
M:\2018\20180316\7 Drawings\7-1 Revit\Users\20180316\_2017\_SVOP\_07302019\_baird02244.rvt  
8/14/2019 10:39:04 AM