



COOPER CARRY
THE CENTER FOR CONNECTIVE ARCHITECTURE

191 Peachtree Street NE
Suite 2400
Atlanta, GA 30303-1770
(404) 237-2000
coopercarry.com

ATLANTA NEW YORK WASHINGTON

0079 COOPER CARRY

SCOPE DOCUMENTS

The Contract Documents issued for [Conceptual Design, Schematic Design, Design Development, Partial Construction Documents and Other Issuances up to Issued for Construction] are intended to be at that level of completion and as such, may be neither complete nor coordinated. The Contractor is responsible for complete and coordinate pricing [and execution] of the Work, and shall include items necessary for the proper execution and completion of the Work, as shown, specified, reasonably inferred or required for a complete Project. For Work of delegated design, systems, assemblies, components and materials shall comply with national, state and local code requirements. The Contractor shall inform the Owner and Architect, in timely fashion, of any discovered omissions, inconsistencies or errors in the Contract Documents.

ISSUANCES

No.	Drawing Issue Description	Date
1	Design Development	05/28/2018

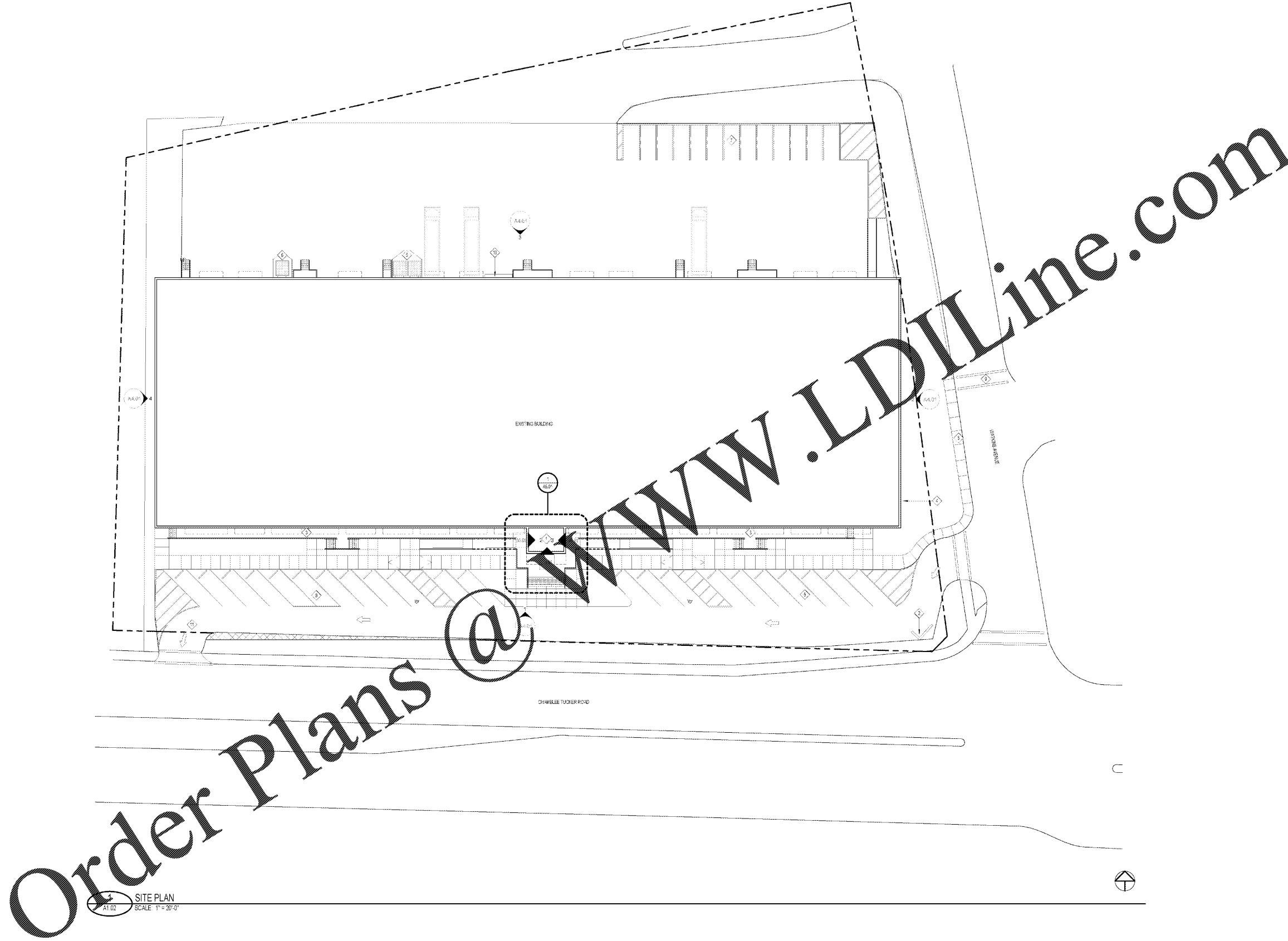

SITE PLAN
SCALE: 1" = 30'-0"

SITE PLAN LEGEND	
	NEW ENTRANCE VESTIBULE
	MONUMENTAL STORAGE
	NEW ELEVATED WALKWAY
	FUTURE WALL MURAL
	SIDEWALK EXTENSION ALONG WALKING AVENUE
	NEW DAMPSTER ENCLOSURE WITH CONCRETE FILLED BOLLARDS
	NEW STEEPED PARKING AT REAR OF BUILDING
	ANGLED PARKING WITH CURB STOP. SEE CIVIL
	NEW CROSSWALK ACROSS WALKING AVE
	NEW ELECTRICAL METER FENCE
	RE-GRADED DRIVEWAY. SEE CIVIL

PROJECT NUMBER: 20180106 PROJECT NAME: St Vincent de Paul Georgia Council Headquarters MAJOR DRAWING TITLE: CHAMBLEE TUCKER RD HEADQUARTERS EXTERIOR ARCHITECTURE: wongj20205.rvt 8/29/2018 5:32:38 PM

St Vincent de Paul Georgia Council Headquarters

2050 Chamblee Tucker Rd
Chamblee, GA 30314

St Vincent de Paul Georgia

ARCHITECTURAL SITE PLAN

BILL HALTER	20/180316
Project Manager	Project No.
MIKE SERVICE	09/20/19
Project Manager	Date

Checklist
Project Contract
TORRANCE WONG
SAC Architect

A1.02