

LAST SAVE: 04/15/2019 11:13 PM
 PLOTTED BY: RCP - SUES
 FILE: E:\Projects\1\Marion\1\Marion Perry County Shelter - MARION\1\Marion Perry County Shelter - WALL SECTIONS\1\Marion Perry County Shelter - WALL SECTIONS.dwg

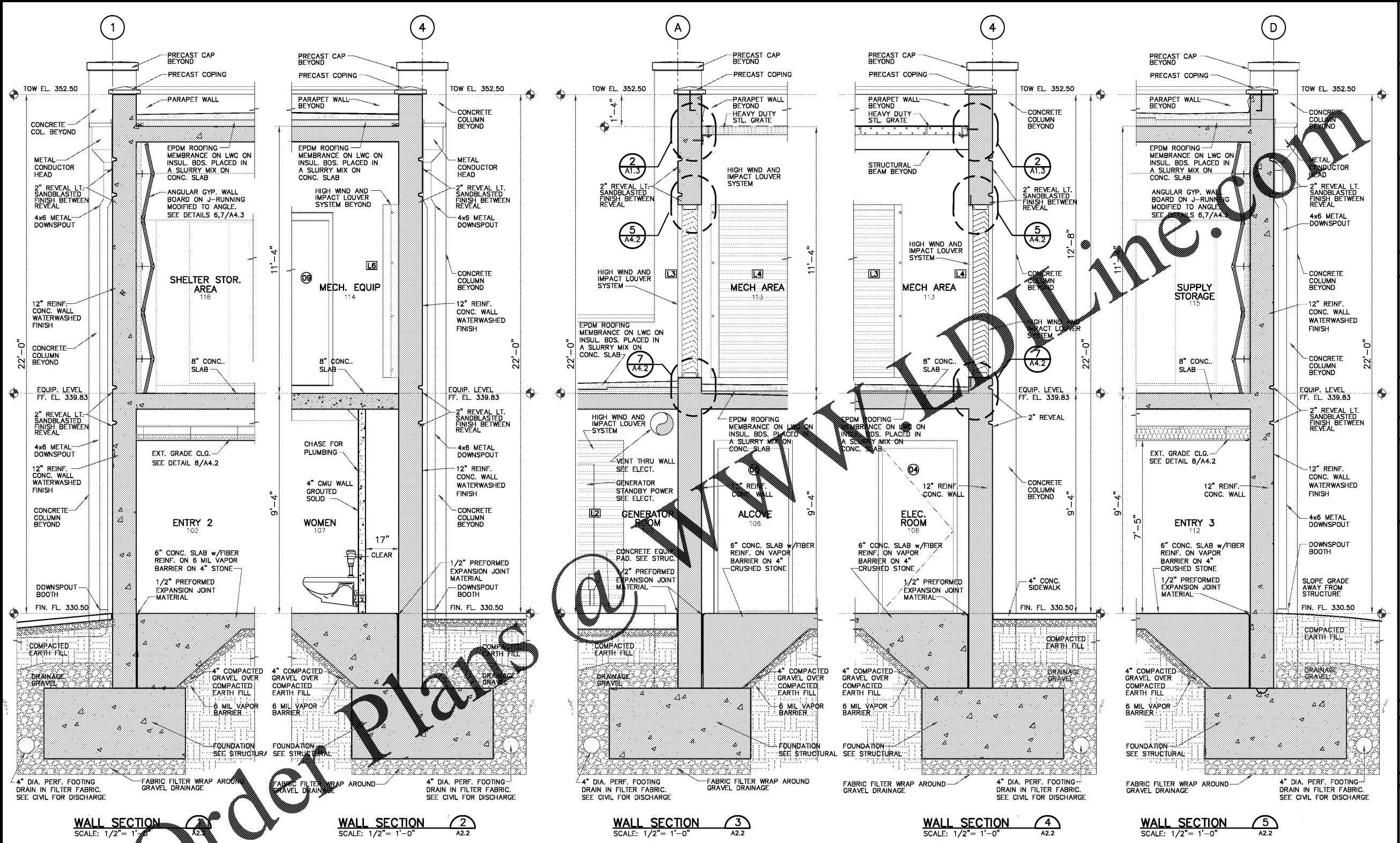

WALL SECTION 1 SCALE: 1/2" = 1'-0" A2.2
 WALL SECTION 2 SCALE: 1/2" = 1'-0" A2.2
 WALL SECTION 3 SCALE: 1/2" = 1'-0" A2.2
 WALL SECTION 4 SCALE: 1/2" = 1'-0" A2.2
 WALL SECTION 5 SCALE: 1/2" = 1'-0" A2.2

Order Plans

NO.	DATE	REVISION
1	04-25-2018	ABC'S COMMENTS AND REPLY
2	06-13-2018	PER REVIEW REVISIONS TO OMC
3	04-08-2019	SECOND REVISIONS AND REPLY

REUSE OF DOCUMENTS
 THIS DOCUMENT WITH THE IDEAS AND DESIGNS INCORPORATED HEREIN ARE AN INSTRUMENT OF PROFESSIONAL SERVICE AND MUST NOT BE USED IN WHOLE OR IN PART FOR ANY OTHER PROJECT WITHOUT THE WRITTEN AUTHORIZATION OF KHAFFRA

PROJECT: **COMMUNITY STORM SHELTER**
 B.C. NO. 2014346 FOR THE
PERRY COUNTY COMMISSION
 300 Washington Street, Marion Alabama
 Perry County, Alabama 36756

DATE:	APRIL 30, 2019
DRWN. BY:	RDSS
USGN. BY:	RDSS
CHKD. BY:	CWRE
APVD. BY:	CWRE
SCALE:	1/8" = 1'-0"

SHEET TITLE: **MARION STORM SHELTER WALL SECTIONS**

PROJECT No. 11M001
 DRAWING No. **A4.1**
 B.C. Project No. 2014346

CONSTRUCTION DOCUMENTS

THIS SET OF CONSTRUCTION DOCUMENTS ARE IN CONFORMITY WITH THE ICC/ANSI-500 2014 "STANDARD FOR THE DESIGN AND CONSTRUCTION OF STORM SHELTERS" REQUIREMENTS.

STRUCTURAL DRAWINGS ARE BASED ON ICC 500 "ICC/NSSA STANDARD FOR THE DESIGN AND CONSTRUCTION OF STORM SHELTERS," BASED ON THE "DESIGN WIND SPEED MAP FOR STORM SHELTERS," THE STRUCTURAL SYSTEMS FOR THE BUILDING WAS DESIGNED FOR ZONE IV (250 MILES PER HOUR) LOADS.