

- NOTES:
1. THE FOOTCANDLE LEVELS AS SHOWN ARE BASED ON THE FOLLOWING CRITERIA. ANY SUBSTITUTIONS IN SPECIFIED FIXTURES OR CHANGES TO LAYOUT WILL AFFECT LIGHTING LEVELS SHOWN AND WILL NOT BE THE RESPONSIBILITY OF SECURITY LIGHTING.
 2. THE CONTRIBUTION OF THE SOFFIT / BUILDING LIGHTING IS NOT REFLECTED ON THE DRAWING UNLESS SOFFIT / BUILDING LIGHTING IS SPECIFIED IN THE FIXTURE SCHEDULE BELOW.
 3. DISTANCE BETWEEN READINGS = 10'
 4. FINAL ADJUSTMENTS TO AIMING ANGLE/DIRECTION OF FIXTURES MAY BE REQUIRED TO ELIMINATE LIGHT TRESPASS OR GLARE ONTO ADJOINING PROPERTIES OR ROADWAYS.

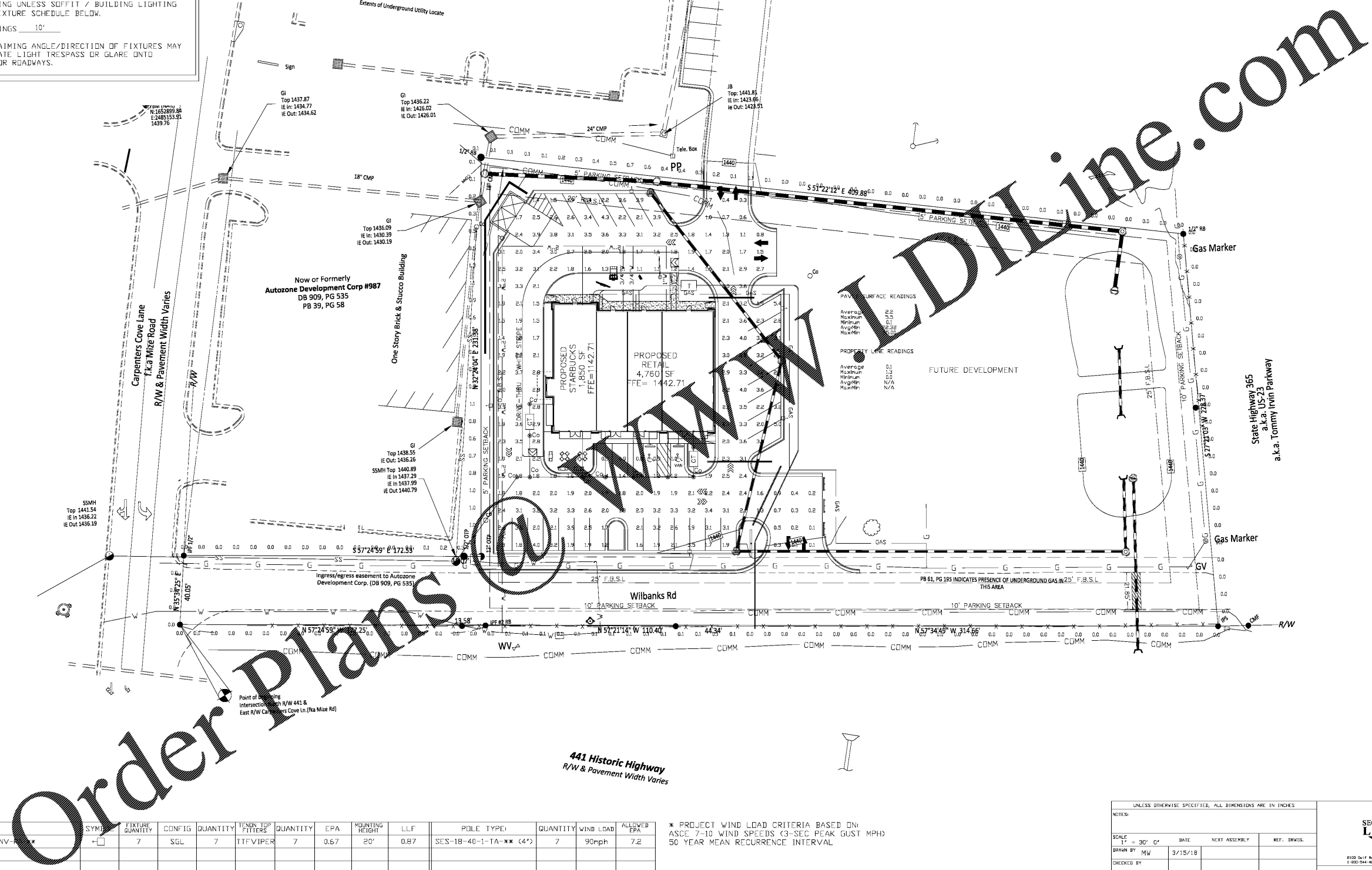

** - SPECIFY COLOR

FIXTURE TYPE	SYM	QUANTITY	CONFIG	QUANTITY	FIXTURE TYPE	QUANTITY	EPA	HOISTING HEIGHT	LLF	POLE TYPE	QUANTITY	WIND LOAD	ALLOWED EPA
VP-S-48NB-110-SK-T4-UNV-	+	7	SGL	7	ITFVIPER	7	0.67	20'	0.87	SES-18-40-1-TA-*** (4*)	7	90mph	7.2

* PROJECT WIND LOAD CRITERIA BASED ON:
ASCE 7-10 WIND SPEEDS (3-SEC PEAK GUST MPH)
50 YEAR MEAN RECURRENCE INTERVAL

THIS LAYOUT MAY NOT MEET TITLE 24 OR LOCAL ENERGY REQUIREMENTS. IF THIS LAYOUT NEEDS TO BE TITLE 24 COMPLIANT OR MEET OTHER ENERGY REQUIREMENTS, PLEASE CONSULT FACTORY WITH SPECIFIC DETAILS REGARDING PROJECT REQUIREMENTS SO THAT REVISIONS MAY BE MADE TO THE DRAWING.

THIS LIGHTING PATTERN REPRESENTS ILLUMINATION LEVELS CALCULATED FROM LABORATORY DATA TAKEN UNDER CONTROLLED CONDITIONS IN ACCORDANCE WITH ILLUMINATING ENGINEERING SOCIETY APPROVED METHODS. ACTUAL PERFORMANCE OF ANY MANUFACTURER'S LUMINAIRES MAY VARY DUE TO VARIATION IN ELECTRICAL VOLTAGE, TOLERANCE IN LAMPS, AND OTHER VISIBLE FIELD CONDITIONS.

UNLESS OTHERWISE SPECIFIED, ALL DIMENSIONS ARE IN INCHES

NOTES:

SCALE	1" = 30' 0"	DATE	3/15/18	NEXT ASSEMBLY	REF. DRWG.
DRAWN BY	MW				
CHECKED BY					
APPROVED BY					
APPROVED BY				FINISH	
APPROVED BY					
SHOP ORDER				MATERIAL	
PROJECT NO.					

SECURITY LIGHTING™

8100 Gulf Road, Suite 400, Rolling Meadows, IL 60008
1-800-244-6862

POINT-BY-POINT FOOTCANDLE PLOT FOR
STARBUCKS
216 CARPENTERS COVE LN
CORNELIA, GA

DRAWING NUMBER
1PCP38719