



SEAL 07/09/2019

**TRINITY  
ENGINEERING  
GROUP INC.**

1081 THOMPSON BRIDGE RD  
GAINESVILLE, GA 30501  
TEL: (770) 535-1044  
FAX: (770) 535-0037

CONSULTANT

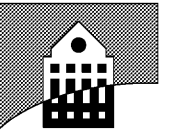

**HLH**

**H. LLOYD HILL  
ARCHITECTS  
& ASSOCIATES, INC.**

736 GREEN STREET  
GAINESVILLE, GA 30501  
(770) 534-8404

ARCHITECT

OWNERSHIP OF DOCUMENTS:  
DRAWINGS AND SPECIFICATIONS AS  
INSTRUMENTS OF SERVICE ARE  
EXCLUSIVE PROPERTY OF TRINITY  
ENGINEERING GROUP INC.  
WHETHER THE PROJECT FOR  
WHICH THEY WERE PREPARED IS  
EXECUTED & CONSTRUCTED OR  
NOT, THESE DOCUMENTS ARE NOT  
TO BE REPRODUCED IN ANY FORM  
AND ARE NOT TO BE USED BY THE  
PROJECT OWNER NOR ANY OTHER  
ENTITY ON OTHER PROJECTS OR  
FOR ANY EXTENSIONS OR  
ADDITIONS OR ALTERATIONS TO  
THE ORIGINAL PROJECT EXCEPT BY  
WRITTEN AUTHORIZATION &  
PERMISSION FROM AND  
AGREEMENT WITH TRINITY  
ENGINEERING GROUP INC.

**SANITARY PLAN - MAIN FLOOR**

NEST FEATHERS  
3621 MUNDY MILL ROAD  
OAKWOOD, GEORGIA

REVISION / ISSUE

JOB NUMBER

2018-103

DRAWN

--

DATE

07/09/2019

SHEET

P-1.1

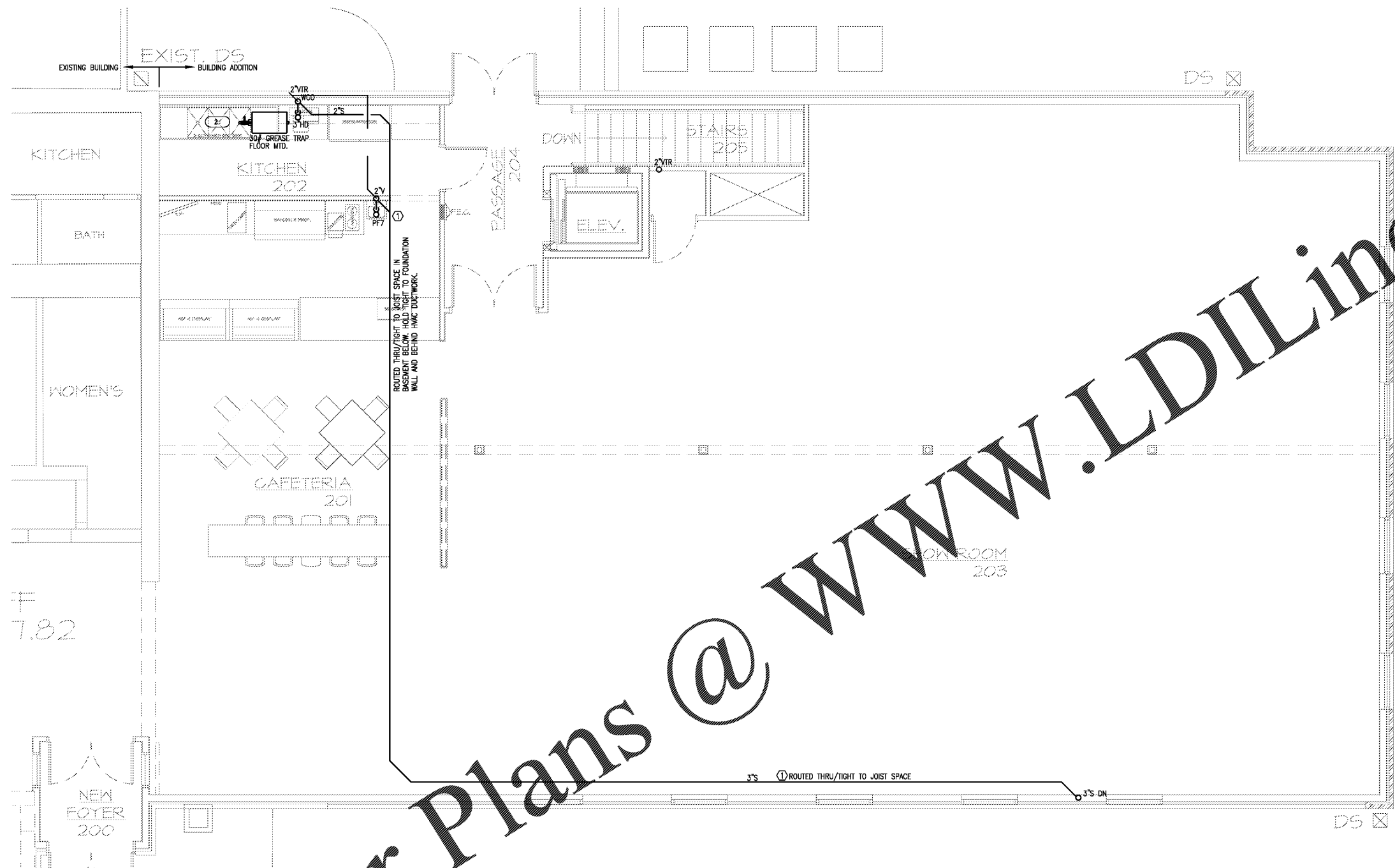

- KEYNOTES: ☒
1. PLUMBING CONTRACTOR TO FIELD CONFIRM EXACT EXIST ELEVATION TIE IN LOCATION. EXTEND NEW LINE AS REQUIRED TO OBTAIN SAME INVERT TIE IN ELEVATION.

1 PLUMBING SANITARY PLAN- MAIN FLOOR  
SCALE: 1/4" = 1'-0"

Order Plans @ [www.LDILine.com](http://www.LDILine.com)