



Quality Civil Designs  
Planners - Engineers - Environmental  
Landscape Architecture

2144 Buford Hwy  
Suite 212  
Buford, GA 30518  
Phone: 678.626.6723  
www.QualityCivilDesigns.com



for the firm  
Quality Civil Designs

Nest Feathers  
Gifts,  
LLC

3621 Mundy Mill Road

Parcel:  
08025 00003

City of Oakwood  
Land Lots 28 & 45,  
8th District  
Hall County  
Georgia

Owner/Developer

Nest Feathers  
3621 Mundy Mill Road  
Oakwood, GA 30566

24 hour Emergency Contact

Michelle Bajjani

Phone: 678-641-0009

Email:

michelle@nestfeathercafe.com

Copyright  
Quality Civil Designs, LLC

This drawing may be utilized only for the  
purpose of constructing or installing the work  
shown hereon, at the site of the work  
specified hereon.

Any other use of this drawing, including  
without limitation any reproduction or  
alteration of this drawing, without the prior  
written approval of Quality Civil Designs, LLC  
is prohibited.

### Revisions

Rev. #	Date	Description
4	06-14-19	City & County Comments
3	04-25-19	City & County Comments
2	02-18-19	City Comments
1	02-14-19	Progress Set
0	12-21-18	Initial Submittal

Sanitary Sewer  
Plan & Profile

Scale: 1" = 20'

FN: 18-052

C-5.1

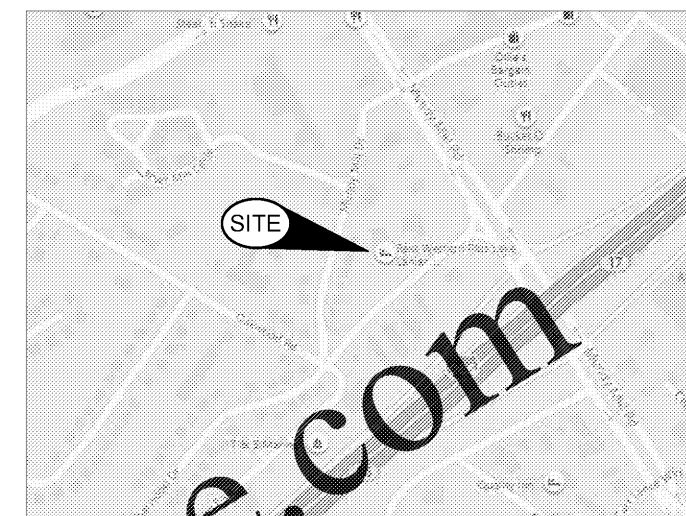

Vicinity Map

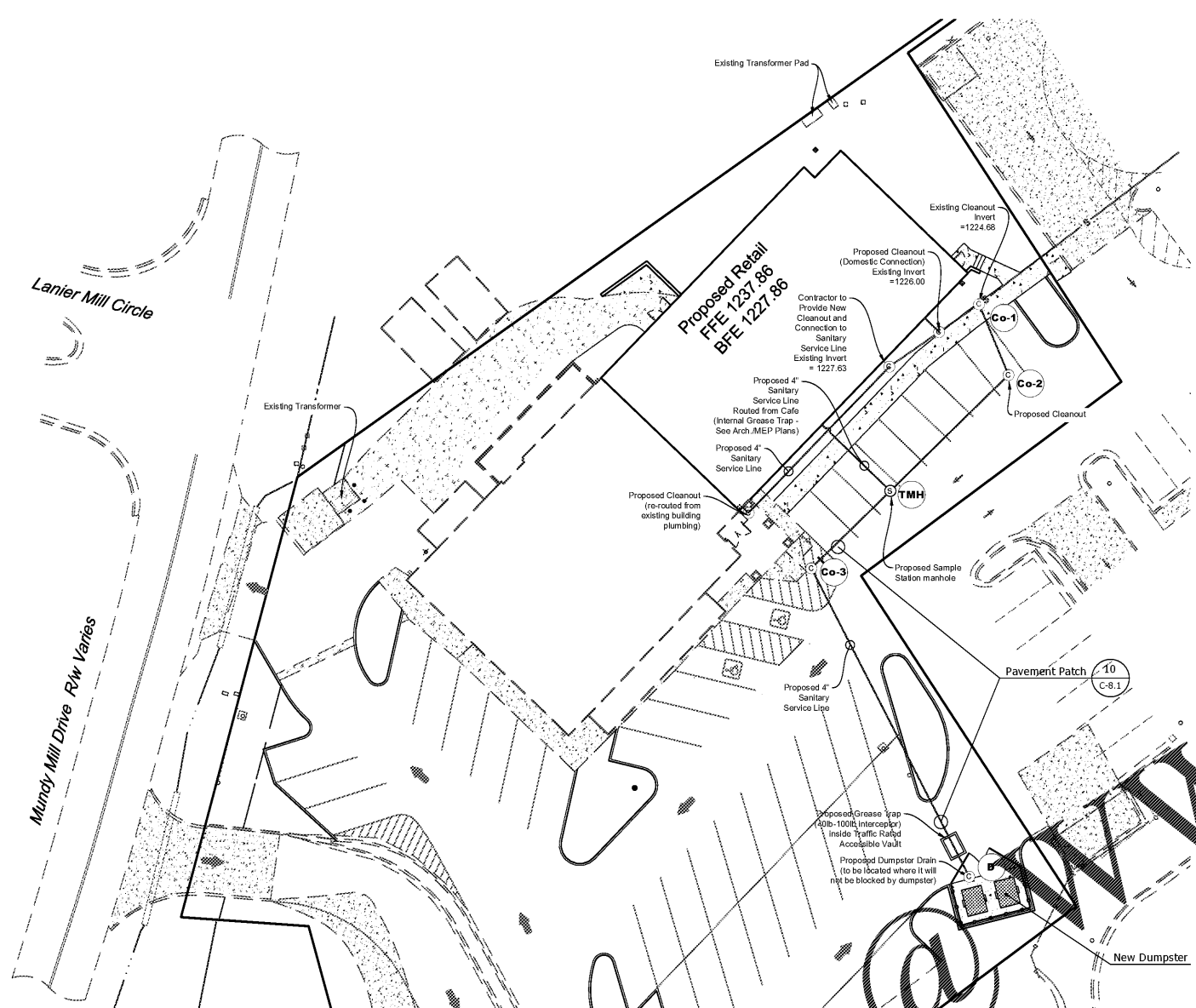

Grid North (GA West Zone - NAD 83)

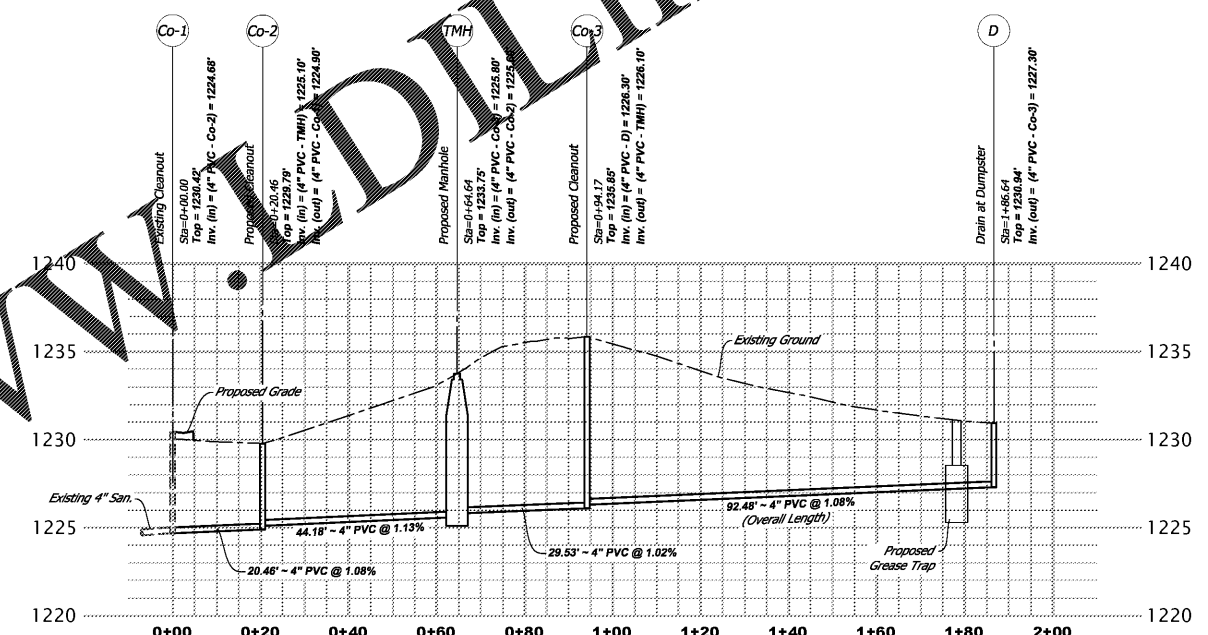

Note:  
Contractor shall verify the location of ALL existing utilities. Contractor shall have ALL utilities flagged with invert elevations PRIOR to construction. Contractor shall report Any AND ALL discrepancies or any additional utilities encountered to the project engineer.

### Legend

- (A) Sanitary Sewer Structure Identification
- ◄ Sanitary Pipe Flow Direction
- (S) (C) Proposed Sanitary Sewer Structures
- (W) Proposed Water Structures

### General Utility Notes

- Information regarding the reputed presence, size, character and location of existing underground utilities and structures is shown hereon. There is no certainty of the accuracy of this information and it shall be considered in that light by those using this drawing. The location and arrangement of underground utilities and structures shown hereon may be inaccurate and utilities and structures not shown may be encountered. The owner, his/her employees, his/her consultants and his/her contractors shall hereby distinctly understand that the engineer / surveyor is not responsible for the correctness or sufficiency of this information.
- Contractor shall verify ALL grades prior to starting work. Any discrepancies shall be reported, in writing, to the owner's representative.
- Contractor shall verify the location of ALL existing utilities. Contractor shall have ALL utilities flagged with invert elevations PRIOR to construction. Contractor shall notify project engineer of ANY AND ALL discrepancies or additional utilities encountered.

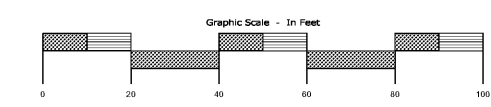

Order Plans @ [AWW@AWWLINE.COM](mailto:AWW@AWWLINE.COM)

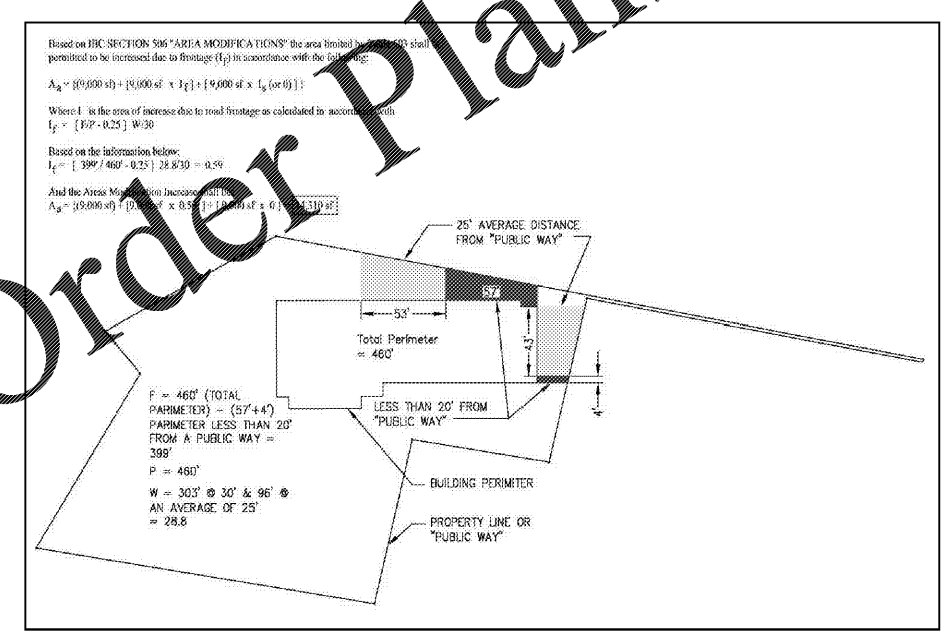

Area Increase Study, as provided by Architect, H. Lloyd Hill Architects & Associates

