

**LIGHTING FIXTURE SCHEDULE**

PROVIDED FOR INFORMATION ONLY. VERIFY AND INSTALL PER ELECTRICAL DRAWING

ITEM	SYMBOL	DESCRIPTION	QTY.	WATTS	MFR. & CAT. NO.	REMARK
<b>INTERIOR LIGHTING ITEM</b>						
L1	[Symbol]	T-BAR CEILING RECESSED MOUNTED LED LIGHTING FIXTURE, 2' X 4', 120V BAKED-ON WHITE ENAMEL FINISH.			LSI FIXTURE: SFP24-LED-50-UE-DIM-35	KITCHEN CEILING LIGHTS, FURNISHED BY OWNER INSTALLED BY GC
L1B	[Symbol]	T-BAR CEILING RECESSED MOUNTED LED LIGHTING FIXTURE, 2' X 2', 120V BAKED-ON WHITE ENAMEL FINISH.			LSI FIXTURE: SFP22-LED-30-UE-DIM-35-U	KITCHEN CEILING LIGHTS, FURNISHED BY OWNER INSTALLED BY GC
L1EM	[Symbol]	T-BAR CEILING RECESSED MOUNTED LED LIGHTING EMERGENCY FIXTURE, 2' X 4', 120V BAKED-ON WHITE ENAMEL FINISH.			LSI FIXTURE: SFP24-LED-50-UE-DIM-EM	EMERGENCY KITCHEN CEILING LIGHTS, FURNISHED BY OWNER INSTALLED BY GC
L4HD	[Symbol]	UNIVERSAL MOUNT EXIT SIGN, LED LIGHTED, 120/277V WITH BATTERY PACK, 2 FACE, GREEN LETTER			EXITRONIX GVEX-U-BP-WB-BL-R6	EXIT SIGN, FURNISHED BY OWNER, INSTALLED BY GC
L6A	[Symbol]	HOOD LIGHT			FURNISHED & INSTALLED BY EQUIPMENT SUPPLIER	LIGHTS SUPPLIED & PRE-WIRED BY HOOD VENDOR. ELECTRIC CONTRACTOR TO CONNECT MAIN WIRES TO SHUNT TRIP BREAKER AND HOOD CONTROL PANEL
L6B	[Symbol]	WALK-IN COOLER FLUORESCENT LIGHT, 120 V 48"			KASON FIXTURE: # 1810LX4000	FURNISHED BY WIC VENDOR, G.R.E., INSTALLED BY GC
L19	[Symbol]	DOWN LIGHT, RECESSED IN CEILING			ELITE HOUSING: LD6IC-AT LED MODULE: ELITE LED LIGHTING RL607-750L-DIMTR-120-30K-SN-SN-90+	FURNISHED BY OWNER, INSTALLED BY GC
L19EM	[Symbol]	EMERGENCY DOWN LIGHT, RECESSED IN CEILING			ELITE HOUSING: LD6IC-AT LED MODULE: ELITE LED LIGHTING RL607-750L-DIMTR-120-30K-SN-SN-90+	EMERGENCY RECESSED DOWN LIGHT - NORMALLY ON INVERTER UNIT - ISOLITE, MI-12-L-C-V1 FURNISHED BY OWNER INSTALLED BY GC
L20	[Symbol]	3 3/4" ADJUSTABLE MR16 DOWN LIGHT, RECESSED IN CEILING			LIGHTOLIER: LYTECASTER-378WHX FRAME-IN KIT: 302MRSPX BULB: MR16 - GE - PRECISE IR 37 WATT 40 ° BEAM	FURNISHED BY OWNER, INSTALLED BY GC
L30	[Symbol]	WHITE LED AT SERVICE COUNTER SOFFIT & DINING ROOM PARTIAL HEIGHT WALL			LUXEM BRIGHT FIXTURE: BLAZE LED	FURNISHED BY OWNER, INSTALLED BY GC
L35	[Symbol]	9.8" DIA. DECORATIVE ISLA PENDANT LF INCANDESCENT			LBL LIGHTING, MODEL # LF512CRSC BULB: LED EDISON LAMP: 1173467	HUNG @ 6'-6" AFF OVER DINING TABLES IN BETWEEN BOOTH FURNISHED BY OWNER, INSTALLED BY GC (VERIFY W/ PANDA)
L100	[Symbol]	MICRO INVERTER			ISOLITE #MI 125	FURNISHED BY OWNER, INSTALLED BY GC
S	[Symbol]	SPEAKER				FURNISHED BY MUSIC VENDOR, INSTALLED BY MUSIC VENDOR
L38	[Symbol]	12.6" DIA. DECORATIVE ALLEA PENDANT LED			LBL LIGHTING, MODEL # LP954 - BLGD BULB: LED EDISON LAMP: 1173467	HUNG @ 6'-6" AFF OVER DINING TABLES FURNISHED BY OWNER, INSTALLED BY GC (VERIFY W/ PANDA)

REFER TO ELECTRICAL SHEET E-001 FOR LIGHTING FIXTURE QUANTITY

**NIGHT LIGHTING REQUIREMENTS: "NL" DESIGNATION INDICATED NIGHT LIGHT ON UNSWITCHED CIRCUIT.**

- ONE NL BY SERVICE COUNTER, POS / CASHIER
- ONE NL BY POS / CASHIER AT DRIVE THRU STATION IF APPLICABLE
- ONE NL BY EACH EXIT DOORS IN DINNING ROOM & BACK OF HOUSE

**EXTERIOR LIGHTING**

ITEM	SYMBOL	DESCRIPTION	QTY.	WATTS	MFR. & CAT. NO.	REMARK
L86	[Symbol]	NAVILITE EMERGENCY LIGHT			EXITRONIX MLED1-G-WP	OVER EXTERIOR ENTRANCE & SERVICE DOORS. REFER ELEVATIONS FOR HEIGHT. FURNISHED BY OWNER, INSTALLED BY GC

Order Plans

**CEILING SCHEDULE** INSTALLED AND FURNISHED BY G.C. UNLESS NOTED OTHERWISE

NO	MANUFACTURER	DESCRIPTION	MATERIAL	FINISH
C1	ARMSTRONG	2' X 2' SUSPENDED T-BAR GRID CEILING SYSTEM	CL-100	T-BAR AND GRID COLOR: SEPIA CONTACT AT ARMSTRONG-SHERRY BRUNT 1-800-442-4212
C2	USG	2' X 4' SUSPENDED T-BAR GRID CEILING SYSTEM	"VINYL" PANELS	SMOOTH AND WASHABLE WHITE
C3	GOLD BOND	MONOLITHIC CEILING ON METAL FRAMING	5/8" GYP	SMOOTH PAINT - WHITE AND WASHABLE

SEE SHEET A-103 FOR PAINT SCHEDULE

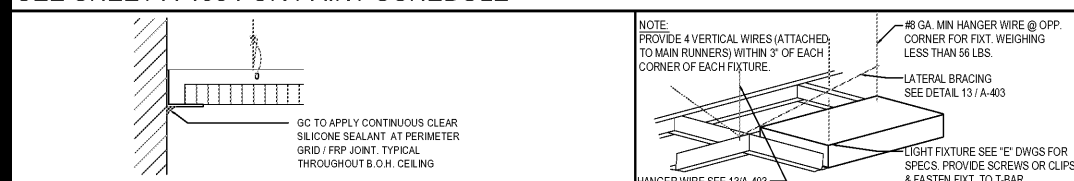

CEILING GRID DETAIL 3 Scale = NTS A-105

LIGHT FIXTURE DETAIL 2 Scale = NTS A-105

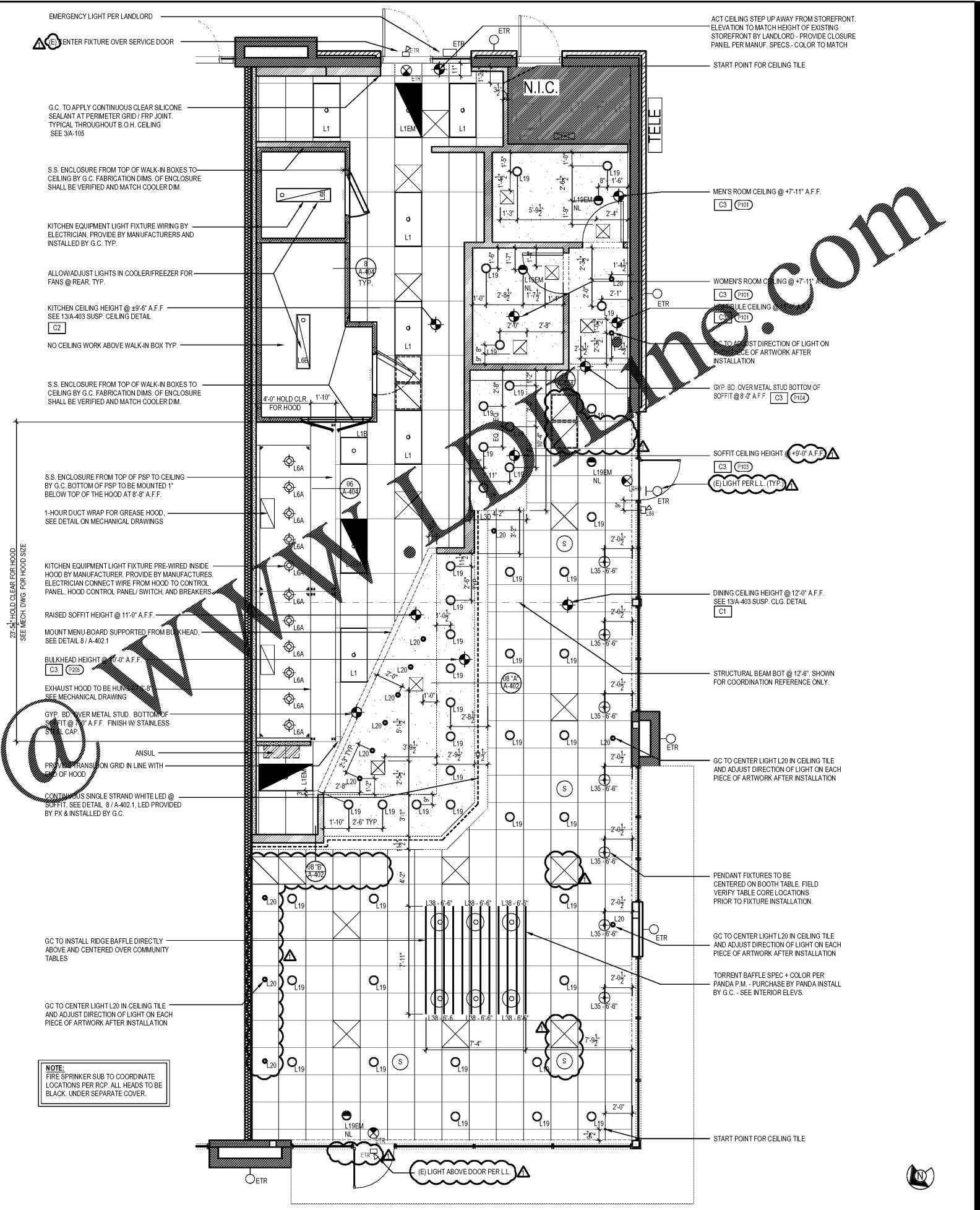

**NOTE:** FIRE SPRINKLER SUB TO COORDINATE LOCATIONS PER RCP. ALL HEADS TO BE BLACK. UNDER SEPARATE COVER.

REFLECTED CEILING PLAN 1 Scale = 1/4" = 1'-0" A-105



PANDA RESTAURANT GROUP INC.  
1683 Walnut Grove Ave.  
Rosemead, California 91770  
Telephone: 626.799.9898  
Facsimile: 626.372.8288

All ideas, designs, arrangement and plans indicated or represented by this drawing are the property of Panda Express Inc. and were created for use on this specific project. None of these ideas, designs, arrangements or plans may be used by or disclosed to any person, firm, or corporation without the written permission of Panda Express Inc.

REVISIONS:  
08.08.19 ISSUE FOR BID

ISSUE DATE:  
05.29.19 ISSUE FOR PERMIT  
08.08.19 ISSUE FOR BID

DRAWN BY: AL, LJD, JDV, JR

PANDA PROJECT # - S4-20-D7060  
C&P PROJECT # - 2190238



08.08.2019



**PANDA EXPRESS**  
TRUE WARM AND WELCOME  
3460 SANDY PLAINS RD, NE SUITE 210  
MARIETTA, GA 30066

**A-105**  
REFLECTED CEILING PLAN