

ROOM NAME	FLOOR	BASE	WALL	CEILING
100 DINING ROOM	T200 24" X 24" TILE	T109 6" X 48" TILE	P101, P104 T109 W102	C1 2' X 2' ARMSTRONG, SEPIA #N61311 C3 GYP BOARD W/ PAINT P103
101 SERVING AREA	QT 8" X 8" CONT. QUARRY TILE QT1 IN HIGH TRAFFIC AREAS	QT2 6" X 12" CONT. 1/8" RAD. MIN (KITCHEN EQUIPMENT ON 6" NSF APPROVED LEGS)	T109 TILE	C3 GYP BOARD W/ SMOOTH WASHABLE PAINT
103 KITCHEN	QT 8" X 8" CONT. QUARRY TILE QT1 IN HIGH TRAFFIC AREAS	QT2 6" X 12" CONT. 1/8" RAD. MIN (KITCHEN EQUIPMENT ON 6" NSF APPROVED LEGS)	WP3 S.S. BEHIND COOK LINE WP1 FRP PANEL	C2 2' X 4' SUSPENDED GRID WASHABLE VINYL COATED GYP BOARD PANELS
104 KITCHEN PREP.	QT 8" X 8" CONT. QUARRY TILE QT1 IN HIGH TRAFFIC AREAS	QT2 6" X 12" CONT. 1/8" RAD. MIN (KITCHEN EQUIPMENT ON 6" NSF APPROVED LEGS)	WP1 FRP PANEL	C2 2' X 4' SUSPENDED GRID WASHABLE VINYL COATED GYP BOARD PANELS
105 WALK-IN COOLER	QT 8" X 8" CONT. QUARRY TILE QT1 IN HIGH TRAFFIC AREAS	S.S. / ALUMINUM WITH 1/8" RADIUS	EXT S.S. INT ALUMINUM GALVANIZED S.S.	ALUMINUM GALVANIZED STAINLESS STEEL
105A WALK-IN FREEZER	GALVANIZED STAINLESS STEEL QT 8" X 8" CONT. QUARRY TILE UNDER W/F SUBFLOOR	S.S. / ALUMINUM WITH 1/8" RADIUS	EXT S.S. INT ALUMINUM GALVANIZED S.S.	ALUMINUM GALVANIZED STAINLESS STEEL
106 MEN'S ROOM	T200 24" X 24" TILE	SCHLUTER	T108 TILE	C3 GYP BOARD W/ P101 SMOOTH WASHABLE PAINT
107 WOMEN'S ROOM	T200 24" X 24" TILE	SCHLUTER	T108 TILE	C3 GYP BOARD W/ P101 SMOOTH WASHABLE PAINT
108 VESTIBULE	T200 24" X 24" TILE	T109 6" X 48" TILE	P104 PAINT GYP BOARD T109 TILE	C3 GYP BOARD W/ P101 SMOOTH WASHABLE PAINT

### WALL LEGEND

- NEW INTERIOR WALL (TO 18" ABOVE CEILING)
- NEW INTERIOR WALL (FULL HT.)
- WALL BY L.L. TYP
- WALK-IN BOX PANEL
- EXISTING 1 HOUR RATED DEMISING WALL

NOTE: THE FOLLOWING STAINLESS STEEL PROVIDED BY PX-INSTALLED BY G.C.:

- PANEL DIVIDERS AT WP3
- INSIDE CORNER AT WP2
- FLASHING AT TOP OF BASE WP3
- WP2 PIECE AT LENGTH OF WALL

NOTE: THE FOLLOWING STAINLESS STEEL PROVIDED BY G.C.-INSTALLED BY G.C.:

- INSTALL 18 GA STAINLESS STEEL CORNER GUARD & WALL CAP INSIDE KITCHEN

- 18 GA. STAINLESS STEEL CORNER GUARD - FULL HT.
- 18 GA. STAINLESS STEEL CORNER GUARD - 4'-0" HIGH
- 18 GA. STAINLESS STEEL CORNER GUARD/FRAME - ALL AROUND PERIMETER OF OPENING - FRAME TO BE WELDED WITH MITERED CORNERS TO FORM SINGLE UNIT.
- 18 GA. STAINLESS STEEL WALL CAP

ALL OTHER STAINLESS STEEL BY G.C.

NOTE:  
\*ALL INTERIOR DIMENSIONS ARE FACE OF GYPSUM BOARD TO GYPSUM BOARD

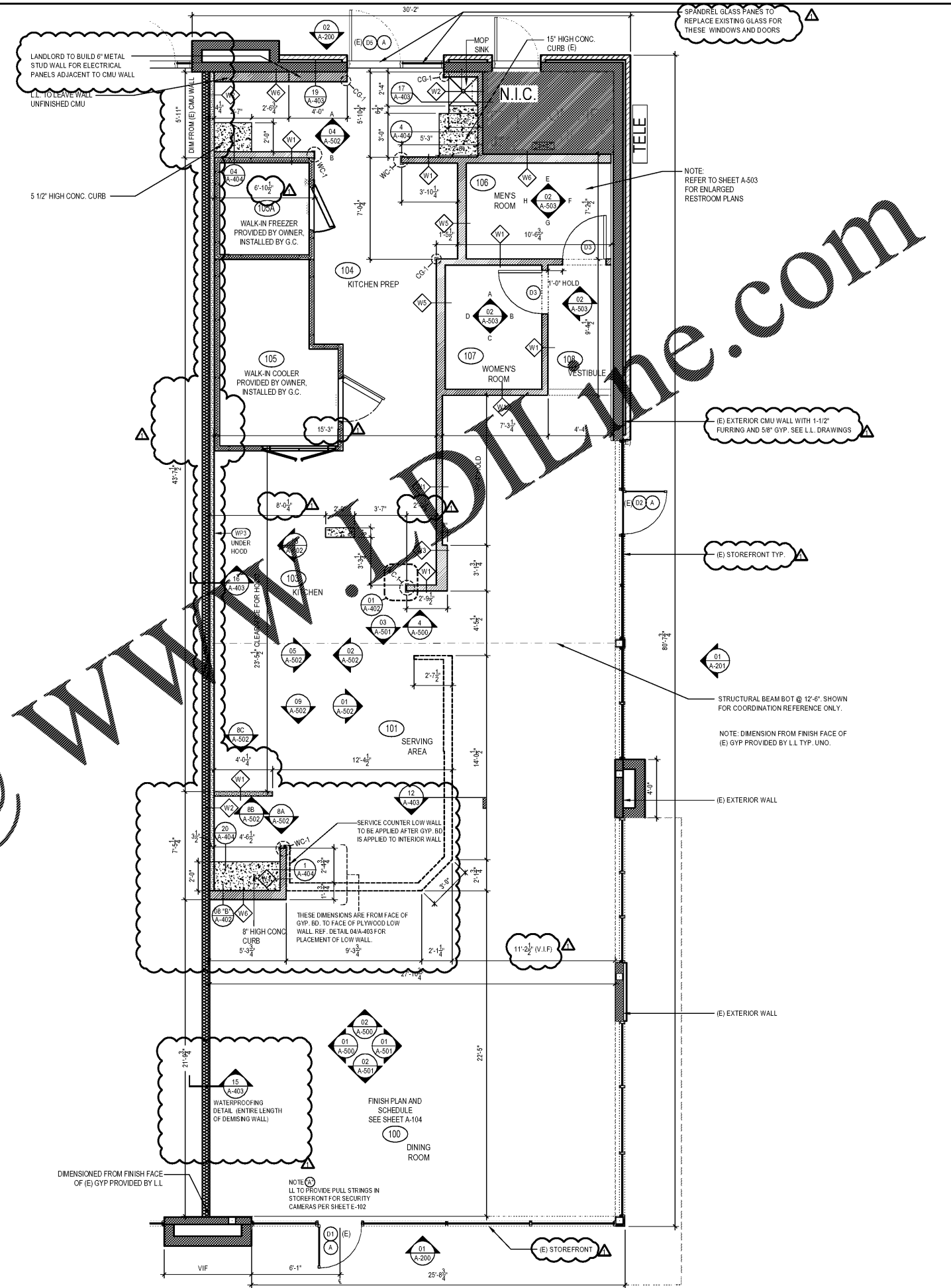

### DOOR & HARDWARE SCHEDULE

INSTALL AND FURNISHED BY G.C. UNLESS NOTED OTHERWISE

NO	DOOR MATERIAL	SIZE	FRAME	FACE EDGE	THK	CORE	LITE	RATE	PASSAGE	LOCKSET	PRIVACY	SF-FULL	PLANC	PLANT	CONT. PANING	FLOOR	WALL	THRESHOLD	LATCH GUARD	DEFY ALARM	SILENCERS	KICKPLATES	CLOSER	REMARKS
01	ALUMINUM STOREFRONT	3'-6" X 8'-0"	ALUM.	PER LANDLORD																				PROVIDE PULL ON EXTERIOR SIDE
02	ALUMINUM STOREFRONT	3'-6" X 8'-0"	ALUM.	PER LANDLORD																				PROVIDE PULL ON EXTERIOR SIDE
03	S.C. WOOD	3'-0" X 7'-0"	MTL	PLASTIC LAMINATE PRE-FINISHED	1 1/2"	SOLID																		KICKPLATE ON EACH SIDE OF DOOR
05	ALUMINUM STOREFRONT	3'-0" X 8'-0"	ALUM.	PER LANDLORD																				SPANDREL GLASS PER L.L. DWGS

### WALL SCHEDULE

INSTALL AND FURNISHED BY G.C. UNLESS NOTED OTHERWISE

NO	DESCRIPTION
01	3-5/8" 20GA. METAL STUD WALL W/ 1/2" TYPE 'X' GYP. BOARD BOTH SIDES (SEE ARCHITECTURAL DETAILS & ELEVATIONS)
02	3-5/8" 20GA. METAL STUD WALL W/ 1/2" TYPE 'X' GYP. BOARD ON ONE SIDE (SEE ARCHITECTURAL DETAILS & ELEVATIONS)
03	(2) 3-5/8" 20GA. METAL STUD WALLS W/ 1/2" TYPE 'X' GYP. BOARD BOTH SIDES (SEE ARCHITECTURAL DETAILS & ELEVATIONS)
04	3-5/8" 20GA. METAL STUD LOW WALL W/ 1/2" TYPE 'X' GYP. BD BOTH SIDES. PROVIDE 3 1/2" KNEE-WALL BRACE/POST @ CORNERS AND @ 48" O.C.
05	6" 20GA. METAL STUD WALL W/ 1/2" TYPE 'X' GYP. BOARD BOTH SIDES (SEE ARCHITECTURAL DETAILS & ELEVATIONS)
06	6" 20GA. METAL STUD WALL W/ 1/2" TYPE 'X' GYP. BOARD ONE SIDE (SEE ARCHITECTURAL DETAILS & ELEVATIONS)
07	6" 20GA. METAL STUD LOW WALL W/ 1/2" TYPE 'X' GYP. BOARD BOTH SIDES. PROVIDE 3 1/2" KNEE-WALL BRACE/POST @ CORNERS AND @ 48" O.C.

### WALL PANEL SCHEDULE

INSTALL AND FURNISHED BY G.C. UNLESS NOTED OTHERWISE

NO	MANUFACTURER	DESCRIPTION	MFG #	COLOR FINISH	REMARK
WP1	CRANE COMPOSITES INC.	F.R.P. THICKNESS: .075	LBOS.14	#636 (GRAY), SM/SM	CONTACT: LINDA RUISE 310.857.9036
WP2	-	S.S. PANEL (22 GA)	-	BRUSHED FINISH	FURNISHED BY PX, INSTALLED BY G.C.
WP3	-	S.S. PANEL (22 GA)	-	DIAMOND PATTERN FINISH	FURNISHED BY PX, INSTALLED BY G.C.
WP4	NOT USED	-	-	-	-
WP5	NOT USED	-	-	-	-
WP6	NOT USED	-	-	-	-
WP7	WOLF GORDON	PRINT WALLCOVERING	-	-	CONTACT: CATHY DY 310.770.1185 cathy@wolfgordon.com
WP8	WOLF GORDON	CLOUD WALLCOVERING	-	-	CONTACT: CATHY DY 310.770.1185 cathy@wolfgordon.com

### SPECIAL SURFACE SCHEDULE

INSTALL AND FURNISHED BY G.C. UNLESS NOTED OTHERWISE

NO	MANUFACTURER	PRODUCT	MFG #	STAIN / COLOR	FINISH	REMARK
CS1	NOT USED	-	-	-	-	-
CS2	NOT USED	-	-	-	-	-
CS3	CORIAN	ARTIFICIAL QUARTZ	-	LONDON SKY	POLISHED	SERVICE COUNTER & DRINK STATION PROVIDED BY PX, INSTALLED BY G.C.

### INTERIOR PAINT SCHEDULE

INSTALL AND FURNISHED BY G.C. UNLESS NOTED OTHERWISE

NO	MANUFACTURER	MFG #	COLOR	FINISH	REMARK
CP1	SHERWIN-WILLIAMS	SW 7065	ARGOS	PROMAR 200, ZERO VOC, LATEX SEMI-GLOSS	REAR SERVICE DOOR
CP2	NOT USED	-	-	-	-
CP3	SHERWIN-WILLIAMS	SW 6252	ICE CUBE	PROMAR 200, ZERO VOC, LATEX EGG-SHELL	RESTROOM & RESTROOM VESTIBULE CEILING, SERVICE LINE SOFFIT
CP4	NOT USED	-	-	-	-
CP5	SHERWIN-WILLIAMS	SW 7032	WARM STONE	PROMAR 200, ZERO VOC, LATEX EGG-SHELL	DROPPED SOFFITS
CP6	SHERWIN-WILLIAMS	SW 6155	RICE GRAN	PROMAR 200, ZERO VOC, LATEX EGG-SHELL	DINING RM. WALLS, RESTROOM VESTIBULE WALLS
CP7	NOT USED	-	-	-	-
CP8	SHERWIN-WILLIAMS	SW 7020	BLACK FOX	DTM ACRYLIC GLOSS, LOW VOC	RESTROOM DOOR FRAMES & LCD NICHE (BACK WALL)
CP9	SHERWIN-WILLIAMS	SW 7075	SEAL SKIN	PROMAR 200, ZERO VOC, LATEX EGG-SHELL	FRONT & BACK & UNDERSIDE FACES OF SERVICE COUNTER SOFFIT

TILE SCHEDULE (SEE SHEET A-104)

PANDA RESTAURANT GROUP INC.  
1683 Walnut Grove Ave.  
Rosemead, California  
91770  
Telephone: 626.799.9898  
Facsimile: 626.372.8288

All ideas, designs, arrangement and plans indicated or represented by this drawing are the property of Panda Express Inc. and were created for use on this specific project. None of these ideas, designs, arrangements or plans may be used by or disclosed to any person, firm, or corporation without the written permission of Panda Express Inc.

### REVISIONS:

NO	DATE	DESCRIPTION
1	08.08.19	ISSUE FOR BID

### ISSUE DATE:

1	05.29.19	ISSUE FOR PERMIT
2	08.08.19	ISSUE FOR BID

DRAWN BY: AL, LJD, JDV, JR  
PANDA PROJECT #: S4-20-D7060  
C&P PROJECT #: 2190238

1925 Prospect Ave. Orlando, FL 32814  
P (407) 661-9100  
F (407) 661-9101

08.08.2019

PANDA EXPRESS  
TRUE WARM AND WELCOME  
3460 SANDY PLAINS RD, NE SUITE 210  
MARIETTA, GA 30066

# A-103

FLOOR PLAN