



PANDA RESTAURANT GROUP INC.  
1683 Walnut Grove Ave.  
Rosemead, California  
91770  
Telephone: 626.799.9898  
Facsimile: 626.372.8288

All ideas, designs, arrangement and plans indicated or represented by this drawing are the property of Panda Express Inc. and were created for use on this specific project. None of these ideas, designs, arrangements or plans may be used by or disclosed to any person, firm, or corporation without the written permission of Panda Express Inc.

REVISIONS:  
1 08.08.19 ISSUE FOR BID

ISSUE DATE:  
1 05.29.19 ISSUE FOR PERMIT  
2 08.08.19 ISSUE FOR BID

DRAWN BY: LJD  
PANDA PROJECT # - S4-20-D7060  
C&P PROJECT # - 2190238



1925 Prospect Ave. Orlando, FL 32814  
P (407) 661-9100  
F (407) 661-9101

08.08.2019



PANDA EXPRESS  
TRUE WARM AND WELCOME  
3460 SANDY PLAINS RD, NE SUITE 210  
MARIETTA, GA 30066

LSP-101

LIFE SAFETY PLAN

LIFE SAFETY PLAN 1  
Scale: 1/4" = 1'-0" LSP-101

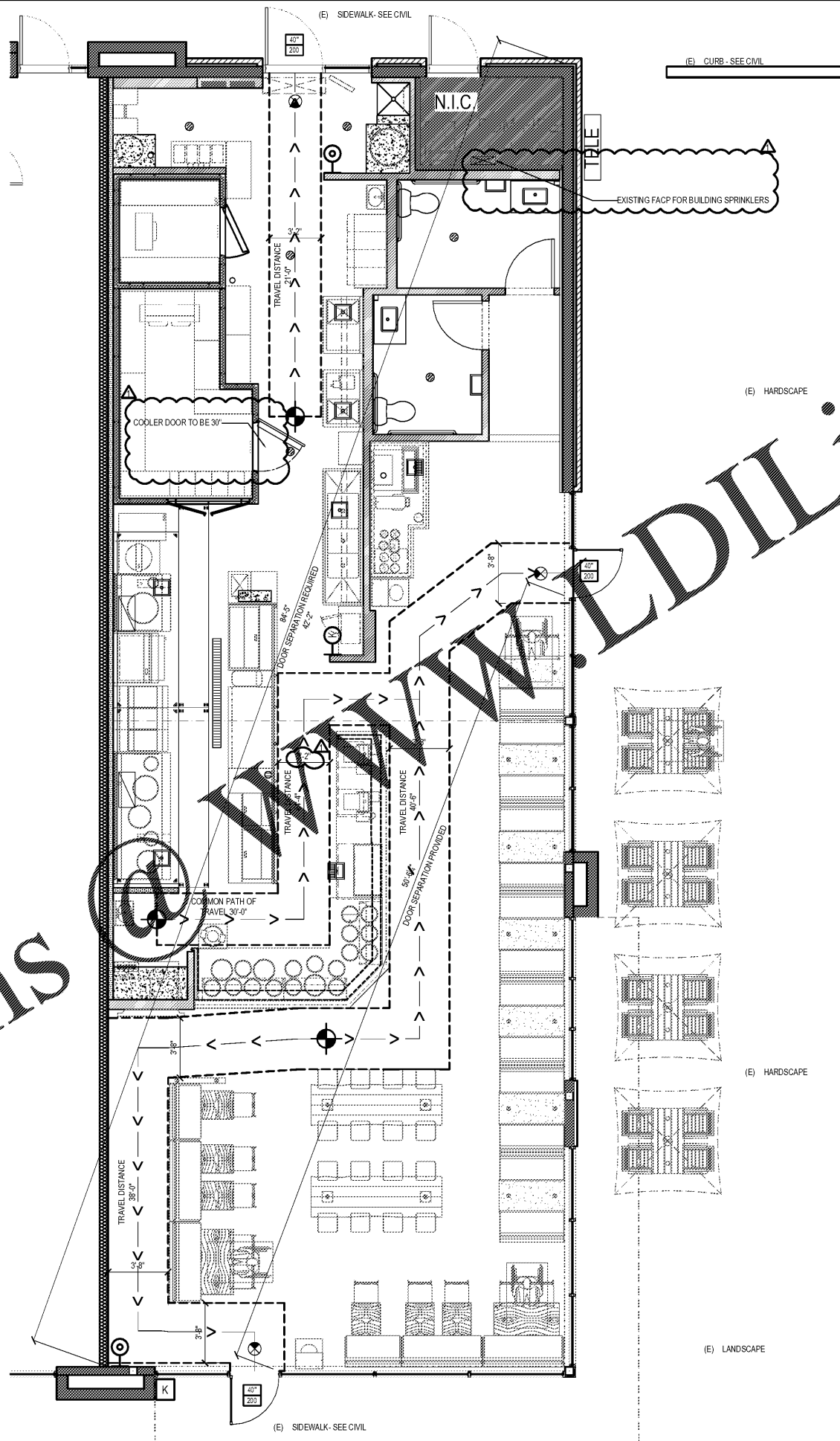

- EXIT LIGHTS SHALL BE PROVIDED AT ALL EXTERIOR DOORS ALONG THE EGRESS PATH.
- EMERGENCY LIGHTING SHALL BE PROVIDED AS REQUIRED BY CODE. REFER ELECTRICAL LIGHTING PLAN.
- ALL DOOR HARDWARE SHALL MEET ALL APPLICABLE CODE REQUIREMENTS FOR EGRESS AND HANDICAP ACCESSIBILITY.
- ALL DIMENSIONS SHOWN ON THIS PLAN ARE MINIMUM CLEAR DIMENSIONS.
- GC SHALL INSTALL A KNOX BOX AT THE MAIN ENTRANCE. GC SHALL COORDINATE THE EXACT LOCATION, MOUNTING HEIGHT, AND TYPE WITH THE LOCAL FIRE OFFICIAL.
- POST OCCUPANT LOAD PER LOCAL CODE. SEE COVER SHEET G-001 FOR OCCUPANT BREAKDOWN.

GENERAL NOTES 6  
NTS LSP-101

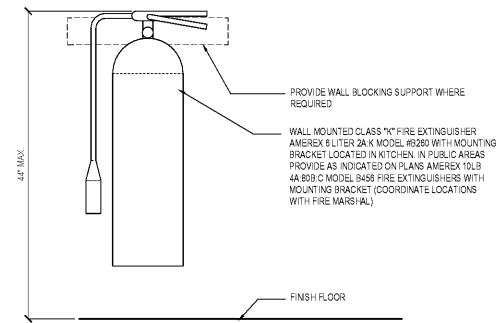

FIRE EXTINGUISHER DETAILS 5  
NTS LSP-101

- SYMBOL INDICATES ACCESSIBLE SEATING. AT EACH ACCESSIBLE SEAT, THE UNDERSIDE OF THE TABLE WILL BE 27" AFF. MIN. THE TOP OF THE TABLE WILL BE 34" AFF. MAX. A 30" WIDE WHEEL CHAIR WILL BE ABLE TO EXTEND UNDER THE TABLE A MIN. OF 12" FROM THE EDGE OF THE TABLE TOP.
- SYMBOL INDICATES FIRE EXTINGUISHER (10 LB. 4A:10BC) WITH MOUNTING BRACKET. ONE EACH TO BE MOUNTED NEXT TO THE MAIN EXIT DOORS FROM THE MAIN BUILDING. MOUNT 4" AFF. MAX. PROVIDE BLOCKING IN WALL FOR MOUNTING SUPPORT AS NEEDED. GC TO COORDINATE EXACT TYPE, LOCATION, AND MOUNTING HEIGHT WITH LOCAL FIRE OFFICIAL AS REQUIRED.
- SYMBOL INDICATES "K" TYPE FIRE EXTINGUISHER WITH MOUNTING BRACKET. TO BE MOUNTED IN KITCHEN IN THE LOCATIONS INDICATED. MOUNT 4" AFF. MAX. PROVIDE BLOCKING IN WALL FOR MOUNTING SUPPORT AS NEEDED. GC TO COORDINATE EXACT TYPE, LOCATION, AND MOUNTING HEIGHT WITH LOCAL FIRE OFFICIAL AS REQUIRED.
- SYMBOL INDICATES EMERGENCY "EXIT" ILLUMINATED SIGN FIXTURE.
- STARTING POINT OF MOST REMOTE POINT OF EGRESS
- DOOR CLEAR OPENING  
EGRESS CAPACITY (PEOPLE)
- EGRESS PATH
- KNOX BOX

SYMBOLS 4  
NTS LSP-101

TYPE OF SEATING	
4 TOP TABLES	9 (4 SEATS) = 36 SEATS
2 TOP TABLES	8 (3 SEATS) = 24 SEATS
8 TOP TABLES	2 (8 SEATS) = 16 SEATS
TOTAL	84 SEATS
OUTDOOR SEATING	
4 TOP FIXED TABLES	4 (4 SEATS) = 16 SEATS
TOTAL	18 SEATS
GRAND TOTAL - INTERIOR & EXTERIOR	88 SEATS

HANDICAP SEAT CALCULATION  
INTERIOR 84 TOTAL SEATS x 5% = 3 REQUIRED / 3 PROVIDED  
EXTERIOR 18 TOTAL SEATS x 5% = 1 REQUIRED / 1 PROVIDED

SEATING CALCULATIONS  
NTS LSP-101

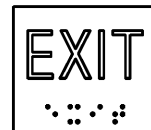

- PROVIDE ONE TACTILE SIGN STATING "EXIT" TO EACH EXTERIOR DOOR. SIGN SHALL COMPLY WITH ANSI A117.
- SIGNS SHALL BE 8" X 8". LETTERS AND CHARACTERS SHALL BE WHITE. BACKGROUND SHALL BE BLACK.
- LETTER WIDTH TO HEIGHT RATIO = 3:5 MIN., 1:1 MAX. STROKE WIDTH TO HEIGHT RATIO = 1:5 MIN., 1:10 MAX.
- LETTERS SHALL BE SIMPLE SERIF TYPE, UPPERCASE, 2" HIGH, AND SHALL BE RAISED 1/32".
- BRAILLE CHARACTERS SHALL BE GRADE 2 BRAILLE. DOTS SHALL BE 1/16" ON CENTER IN EACH CELL, WITH 2/16" SPACE BETWEEN CELLS. DOTS SHALL BE RAISED A MINIMUM OF 1/40" ABOVE THE BACKGROUND.
- SIGNS SHALL BE MOUNTED ON THE LATCH SIDE OF THE DOOR. SIGNS SHALL BE 80" AFF AND 9" FROM DOOR OPENING (EACH MEASURED TO CENTER OF SIGN).

LIFE SAFETY PLAN 2  
NTS LSP-101

Order Plans