

- IF NECESSARY, SLOPES, WHICH EXCEED EIGHT (8) VERTICAL FEET SHOULD BE STABILIZED WITH SYNTHETIC OR VEGETATIVE MATS, IN ADDITION TO HYDROSEEDING. IT MAY BE NECESSARY TO INSTALL TEMPORARY SLOPE DRAINS DURING CONSTRUCTION. TEMPORARY BERMS MAY BE NEEDED UNTIL THE SLOPE IS BROUGHT TO GRADE.
- STABILIZATION MEASURES SHALL BE INITIATED AS SOON AS PRACTICABLE IN PORTIONS OF THE SITE WHERE CONSTRUCTION ACTIVITIES HAVE TEMPORARILY OR PERMANENTLY CEASED, BUT IN NO CASE MORE THAN FOURTEEN (14) DAYS AFTER WORK HAS CEASED, EXCEPT AS STATED BELOW.
 - WHERE STABILIZATION BY THE 14TH DAY IS PRECLUDED BY SNOW COVER OR FROZEN GROUND CONDITIONS STABILIZATION MEASURES MUST BE INITIATED AS SOON AS PRACTICABLE.
 - WHERE CONSTRUCTION ACTIVITY ON A PORTION OF THE SITE IS TEMPORARILY CEASED, AND EARTH-DISTURBING ACTIVITIES WILL BE RESUMED WITHIN 14 DAYS, TEMPORARY STABILIZATION MEASURES DO NOT HAVE TO BE INITIATED ON THAT PORTION OF THE SITE.
- ALL SEDIMENT AND EROSION CONTROL DEVICES SHALL BE INSPECTED ONCE PERIODICALLY EVERY WEEK. IF PERIODIC INSPECTION OR OTHER INFORMATION INDICATES THAT A BMP HAS BEEN INAPPROPRIATELY, OR INCORRECTLY, THE PERMITTEE MUST ADDRESS THE NECESSARY REPLACEMENT OR MODIFICATION REQUIRED TO CORRECT THE BMP WITHIN 48 HOURS OF IDENTIFICATION.
- PROVIDE SILT FENCE AND/OR OTHER CONTROL DEVICES, AS MAY BE REQUIRED, TO CONTROL SOIL EROSION DURING UTILITY CONSTRUCTION. ALL DISTURBED AREAS SHALL BE CLEANED, GRADED, AND STABILIZED WITH GRASSING IMMEDIATELY AFTER THE UTILITY INSTALLATION, FILL, COVER, AND TEMPORARY SEEDING AT THE END OF EACH DAY ARE RECOMMENDED. IF WATER IS ENCOUNTERED WHILE TRENCHING, THE WATER SHOULD BE FILTERED TO REMOVE SEDIMENT BEFORE BEING PUMPED BACK INTO ANY WATERS OF THE STATE.
- ALL EROSION CONTROL DEVICES SHALL BE PROPERLY MAINTAINED DURING ALL PHASES OF CONSTRUCTION UNTIL THE COMPLETION OF ALL CONSTRUCTION ACTIVITIES AND ALL DISTURBED AREAS HAVE BEEN STABILIZED. ADDITIONAL CONTROL DEVICES MAY BE REQUIRED DURING CONSTRUCTION IN ORDER TO CONTROL EROSION AND/OR OFFSITE SEDIMENTATION. ALL TEMPORARY CONTROL DEVICES SHALL BE REMOVED ONCE CONSTRUCTION IS COMPLETE AND THE SITE IS STABILIZED.
- THE CONTRACTOR MUST TAKE NECESSARY ACTION TO MINIMIZE THE TRACKING OF MUD ONTO PAVED ROADWAY(S) FROM CONSTRUCTION AREAS AND THE GENERATION OF DUST. THE CONTRACTOR SHALL DAILY REMOVE MUD/SOIL FROM PAVEMENT, AS MAY BE REQUIRED.
- RESIDENTIAL SUBDIVISIONS REQUIRE EROSION CONTROL FEATURES FOR INFRASTRUCTURE AS WELL AS FOR INDIVIDUAL LOT CONSTRUCTION. INDIVIDUAL PROPERTY OWNERS SHALL FOLLOW THESE PLANS DURING CONSTRUCTION OR OBTAIN APPROVAL OF AN INDIVIDUAL PLAN IN ACCORDANCE WITH S.C. REG. 72-300 ET SEQ. AND SCR100000.
- TEMPORARY DIVERSION BERMS AND/OR DITCHES WILL BE PROVIDED AS NEEDED DURING CONSTRUCTION TO PROTECT WORK AREAS FROM UPSLOPE RUNOFF AND/OR TO DIVERT SEDIMENT-LADEN WATER TO APPROPRIATE TRAPS OR STABLE OUTLETS.
- ALL WATERS OF THE STATE (WOS), INCLUDING WETLANDS, ARE TO BE FLAGGED OR OTHERWISE CLEARLY MARKED IN THE FIELD. A DOUBLE ROW OF SILT FENCE IS TO BE INSTALLED IN ALL AREAS WHERE A 50-FOOT BUFFER CANT BE MAINTAINED BETWEEN THE DISTURBED AREA AND ALL WOS. A 10-FOOT BUFFER SHOULD BE MAINTAINED BETWEEN THE LAST ROW OF SILT FENCE AND ALL WOS.
- LITTER, CONSTRUCTION DEBRIS, OILS, FUELS, AND BUILDING PRODUCTS WITH SIGNIFICANT POTENTIAL FOR IMPACT (SUCH AS STOCKPILES OF FRESHLY TREATED LUMBER) AND CONSTRUCTION CHEMICALS THAT COULD BE EXPOSED TO STORM WATER MUST BE PREVENTED FROM BECOMING A POLLUTANT SOURCE IN STORM WATER DISCHARGES.
- A COPY OF THE SWPPP, INSPECTION RECORDS, AND RAINFALL DATA MUST BE RETAINED AT THE CONSTRUCTION SITE OR A NEARBY LOCATION EASILY ACCESSIBLE DURING NORMAL BUSINESS HOURS, FROM THE DATE OF COMMENCEMENT OF CONSTRUCTION ACTIVITIES TO THE DATE THAT FINAL STABILIZATION IS REACHED.
- INITIATE STABILIZATION MEASURES ON ANY EXPOSED STEEP SLOPE (3:1V OR GREATER) WHERE LAND-DISTURBING ACTIVITIES HAVE PERMANENTLY OR TEMPORARILY CEASED, AND WILL NOT RESUME FOR A PERIOD OF 7 CALENDAR DAYS.
- MINIMIZE SOIL COMPACTION AND, UNLESS INFEASIBLE, PRESERVE TOPSOIL.
- MINIMIZE THE DISCHARGE OF POLLUTANTS FROM DEWATERING OF TRENCHES AND EXCAVATED AREAS. THESE DISCHARGES ARE TO BE ROUTED THROUGH APPROPRIATE BMPs (SEDIMENT BASIN, FILTER BAG, ETC.).
- THE FOLLOWING DISCHARGES FROM SITES ARE PROHIBITED:
 - WASTEWATER FROM WASHOUT OF CONCRETE, UNLESS MANAGED BY AN APPROPRIATE CONTROL;
 - WASTEWATER FROM WASHOUT AND CLEANOUT OF STUCCO, PAINT, FORM RELEASE OILS, CURING COMPOUNDS AND OTHER CONSTRUCTION MATERIALS;
 - FUELS, OILS, OR OTHER POLLUTANTS USED IN VEHICLE AND EQUIPMENT OPERATION AND MAINTENANCE; AND SOAPS OR SOLVENTS USED IN VEHICLE AND EQUIPMENT WASHING.
- AFTER CONSTRUCTION ACTIVITIES BEGIN, INSPECTIONS MUST BE CONDUCTED AT A MINIMUM OF AT LEAST ONCE EVERY CALENDAR WEEK AND MUST BE CONDUCTED UNTIL FINAL STABILIZATION IS REACHED ON ALL AREAS OF THE CONSTRUCTION SITE.
- IF EXISTING BMPs NEED TO BE MODIFIED OR IF ADDITIONAL BMPs ARE NECESSARY TO COMPLY WITH THE REQUIREMENTS OF THIS PERMIT AND/OR SC'S WATER QUALITY STANDARDS, IMPLEMENTATION MUST BE COMPLETED BEFORE THE NEXT STORM EVENT WHENEVER PRACTICABLE. IF IMPLEMENTATION BEFORE THE NEXT STORM EVENT IS IMPRACTICABLE, THE SITUATION MUST BE DOCUMENTED IN THE SWPPP AND ALTERNATIVE BMPs MUST BE IMPLEMENTED AS SOON AS REASONABLY POSSIBLE.
- A PRE-CONSTRUCTION CONFERENCE MUST BE HELD FOR EACH CONSTRUCTION SITE WITH AN APPROVED ON-SITE SWPPP PRIOR TO THE IMPLEMENTATION OF CONSTRUCTION ACTIVITIES. FOR NON-LINEAR PROJECTS THAT DISTURB 10 ACRES OR MORE THIS CONFERENCE MUST BE HELD ON-SITE UNLESS THE DEPARTMENT HAS APPROVED OTHERWISE.

STANDARD NOTES - EROSION CONTROL

- CONTACT THE SEDIMENT CONTROL OFFICER NOT LESS THAN FORTY EIGHT (48) HOURS BEFORE COMMENCEMENT OF THE LAND DISTURBING ACTIVITY. THE DEVELOPER SHALL ALSO CONTACT THE COUNTY AFTER THE REMOVAL OF THE TEMPORARY SEDIMENT CONTROL MEASURES.
- BEGIN INSTALLATION OF INTERIM EROSION AND SEDIMENT CONTROL AND STORMWATER MANAGEMENT MEASURES WITHIN FORTY EIGHT (48) HOURS OF THE COMMENCEMENT OF LAND DISTURBING ACTIVITIES.
- THE DEVELOPER ENGAGED IN OR CONDUCTING THE LAND DISTURBING ACTIVITY SHALL BE RESPONSIBLE FOR INSTALLING AND MAINTAINING ALL TEMPORARY AND PERMANENT EROSION AND SEDIMENT CONTROL MEASURES AND FACILITIES DURING THE DEVELOPMENT OF A SITE AS REQUIRED BY THE APPROVED PLAN OR ANY PROVISION OF THE ORDINANCE. OPERATIONS AND MAINTENANCE CONDITIONS SHALL BE INCLUDED IN THE PLAN OUTLINING HOW THE DEVELOPER INTENDS TO PROVIDE FOR OPERATIONS AND MAINTENANCE DURING CONSTRUCTION.
- WITHIN SEVEN CALENDAR DAYS FOLLOWING SOIL DISTURBANCE OR REDISTURBANCE, ALL PERIMETER SEDIMENT CONTROLS SHALL BE INSTALLED AND TEMPORARY STABILIZATION MEASURES SHALL BE COMPLETED ON TOPSOIL STOCKPILES.
- AREAS AT FINAL GRADE SHALL RECEIVE PERMANENT STABILIZATION MEASURES WITHIN SEVEN CALENDAR DAYS OF REACHING FINAL GRADE.
- THE RESPONSIBILITY FOR MAINTAINING ALL PERMANENT EROSION AND SEDIMENT CONTROL MEASURES AND FACILITIES AFTER SITE LAND DISTURBING ACTIVITY IS COMPLETED SHALL LIE WITH THE LANDOWNER OR PERSON IN POSSESSION OR CONTROL. EXCEPT FACILITIES AND MEASURES INSTALLED WITHIN ROAD OR STREET RIGHT OF WAY OR EASEMENTS ACCEPTED FOR MAINTENANCE BY YORK COUNTY.
- APPROVED PLANS REMAIN VALID FOR FIVE YEARS FROM THE DATE OF APPROVAL.
- CONTRACTOR TO INSTALL TEMPORARY CHECK DAMS WHEN TEMPORARILY EXCEEDS 5% IN SLOPE.
- SLOPES WHICH EXCEED EIGHT (8) VERTICAL FEET SHOULD BE STABILIZED WITH SYNTHETIC OR VEGETATIVE MATS, IN ADDITION TO HYDROSEEDING.
- ALL SEDIMENT AND EROSION CONTROL DEVICES SHALL BE INSPECTED EVERY SEVEN (7) DAYS AND AFTER EACH RAINFALL OCCURRENCE THAT EXCEEDS ONE-HALF (1/2) INCH. DAMAGED OR INEFFECTIVE DEVICES SHALL BE REPAIRED OR REPLACED, AS NECESSARY.
- PROVIDE SILT FENCE AND/OR OTHER CONTROL DEVICES, AS MAY BE REQUIRED, TO CONTROL SOIL EROSION DURING UTILITY CONSTRUCTION. ALL DISTURBED AREAS SHALL BE CLEANED, GRADED, AND STABILIZED WITH GRASSING IMMEDIATELY AFTER THE UTILITY IS INSTALLED.
- ALL EROSION CONTROL DEVICES SHALL BE PROPERLY MAINTAINED DURING ALL PHASES OF CONSTRUCTION UNTIL THE COMPLETION OF ALL CONSTRUCTION ACTIVITIES AND ALL DISTURBED AREAS HAVE BEEN STABILIZED. ADDITIONAL CONTROL DEVICES MAY BE REQUIRED DURING CONSTRUCTION IN ORDER TO CONTROL EROSION AND/OR OFFSITE SEDIMENTATION. ALL TEMPORARY CONTROL DEVICES SHALL BE REMOVED ONCE CONSTRUCTION IS COMPLETE AND THE SITE IS STABILIZED.
- THE CONTRACTOR MUST TAKE NECESSARY ACTION TO MINIMIZE THE TRACKING OF MUD ONTO PAVED ROADWAY FROM CONSTRUCTION AREAS. THE CONTRACTOR SHALL DAILY REMOVE MUD/SOIL FROM PAVEMENT, AS REQUIRED.
- RESIDENTIAL SUBDIVISIONS REQUIRE EROSION CONTROL FEATURES FOR INFRASTRUCTURE AS WELL AS FOR INDIVIDUAL LOT CONSTRUCTION. INDIVIDUAL PROPERTY OWNERS SHALL FOLLOW THESE PLANS DURING CONSTRUCTION OR PROVIDE AN INDIVIDUAL PLAN MEETING SECTION R.72-307 OF THE STORMWATER MANAGEMENT & SEDIMENT REDUCTION ACT.
- ALL STOCKPILES SHALL BE SURROUNDED BY SILT FENCE TO CONTAIN THE STOCKPILED MATERIAL. STOCKPILED MATERIAL SHALL BE REMOVED AND/OR STABILIZED BEFORE THE SITE IS RELEASED FOR FINAL APPROVAL. WITHIN SEVEN CALENDAR DAYS, TEMPORARY STABILIZATION MEASURES SHALL BE COMPLETED ON TOPSOIL STOCKPILES. THE BURIAL OF ANY CELLULOSE DEBRIS WILL NEED TO BE PLATED. THE REMOVAL OF SOIL OR WASTE FROM THE PROPOSED SITE WILL NEED TO BE TAKEN TO A PERMITTED LANDFILL OR ANOTHER PERMITTED SITE WITH A VALID LAND DISTURBANCE PERMIT. THE ASSOCIATED SITE WOULD ALSO BE REQUIRED TO PROVIDE THE APPROPRIATE EROSION AND SEDIMENT CONTROL NECESSARY TO RETAIN SEDIMENT ON SITE (WITHIN THE LIMITS OF DISTURBANCE PERMITTED).
- NO OFFSITE MATERIAL, WASTE, BORROW OR CONSTRUCTION EQUIPMENT STORAGE AREAS ARE PROPOSED.

ADDITIONAL NOTES - EROSION CONTROL

STANDARD STRUCTURAL PRACTICES

CODE	PRACTICE	MAP SYMBOL	DESCRIPTION
Co	CONSTRUCTION EXIT	[Symbol]	A circular area used to control the construction exit to ensure a clean exit from the site to the public roadway.
Sd1	SEDIMENT BARRIER	[Symbol]	A barrier to prevent sediment from leaving the site. It is made of silt fence or other approved material.
Sd2	SEDIMENT TRAP TEMPORARY	[Symbol]	A small temporary ponding area to catch sediment before it enters a waterway.
Dm1	SLOPE DRAIN	[Symbol]	A shallow trench, open or covered, to collect and remove sediment from a slope.
St1	TEMP. FABRIC DROP INLET PROTECTION	[Symbol]	Temporary fabric barrier placed around a drop inlet.
St2	OUTLET STABILIZATION STRUCTURE	[Symbol]	A structure to stabilize the outlet of a stormwater pipe or ditch.
M	STABILIZED AREA WITH MULCHING (ONLY)	[Symbol]	Establishing a temporary vegetative cover with mulch to prevent erosion on disturbed areas.
TS	STABILIZED AREA WITH TEMPORARY SEEDING	[Symbol]	Establishing a temporary vegetative cover with temporary seeding to prevent erosion on disturbed areas.
PS	STABILIZED AREA WITH SOIL SEEDING	[Symbol]	Establishing permanent vegetative cover with soil seeding to prevent erosion on disturbed areas.
Td1	TEMPORARY DIVERSION DITCH	[Symbol]	Construct temporary ditch to divert runoff to prevent erosion.
Ro	SILT FENCE ROCK OUTLET	[Symbol]	Stone filter bank used to filter sediment from the runoff of the silt fence.

LEGEND

[Symbol]	PROPERTY LINE
[Symbol]	ADJACENT PROPERTY LINE
[Symbol]	SEDIMENT LINE
[Symbol]	CONSTRUCTION EXIT
[Symbol]	SEDIMENT BARRIER
[Symbol]	SEDIMENT TRAP TEMPORARY
[Symbol]	SLOPE DRAIN
[Symbol]	TEMP. FABRIC DROP INLET PROTECTION
[Symbol]	OUTLET STABILIZATION STRUCTURE
[Symbol]	STABILIZED AREA WITH MULCHING (ONLY)
[Symbol]	STABILIZED AREA WITH TEMPORARY SEEDING
[Symbol]	STABILIZED AREA WITH SOIL SEEDING
[Symbol]	TEMPORARY DIVERSION DITCH
[Symbol]	SILT FENCE ROCK OUTLET

Order Plans

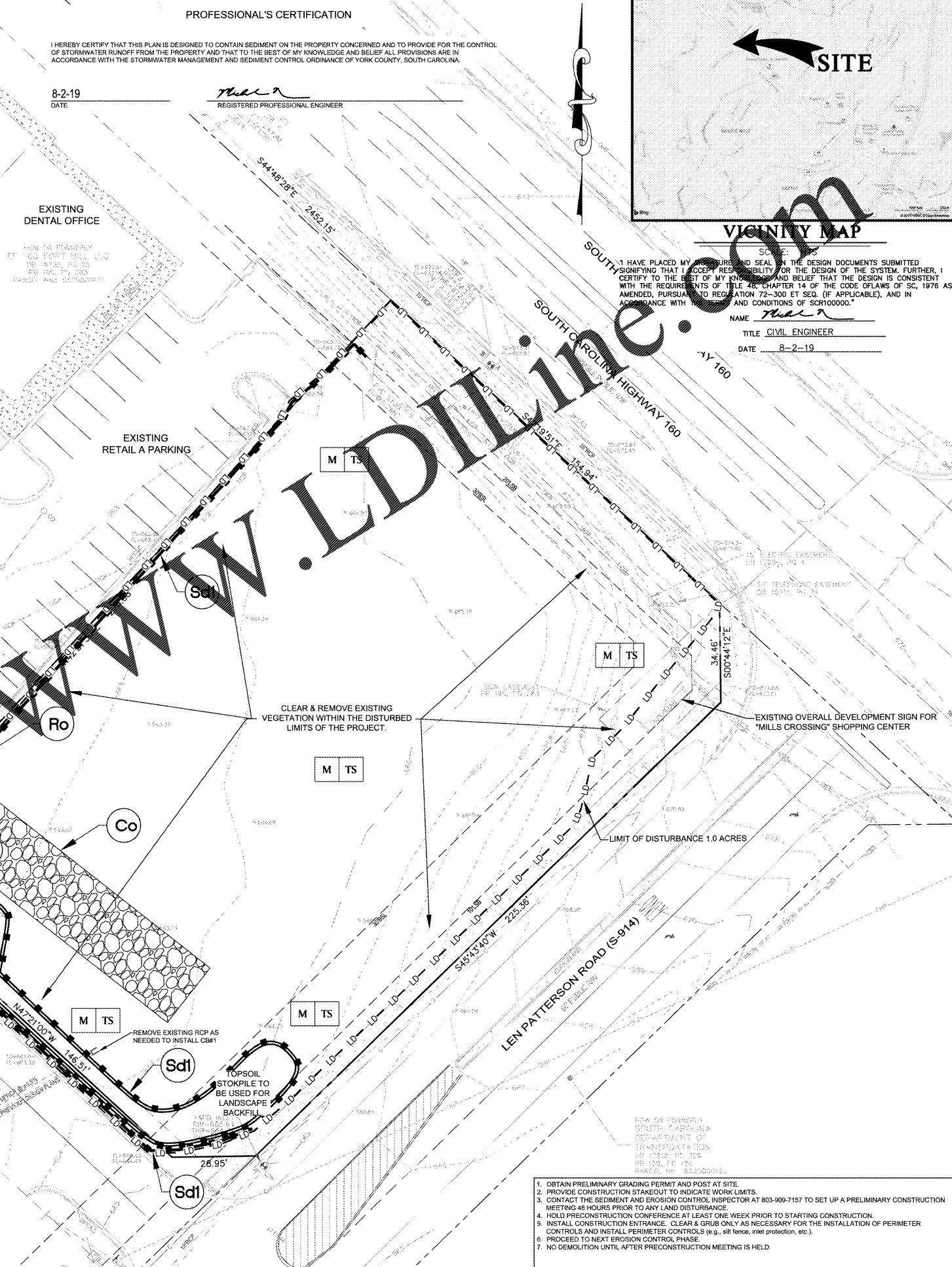

PROFESSIONAL'S CERTIFICATION

I HEREBY CERTIFY THAT THIS PLAN IS DESIGNED TO CONTAIN SEDIMENT ON THE PROPERTY CONCERNED AND TO PROVIDE FOR THE CONTROL OF STORMWATER RUNOFF FROM THE PROPERTY AND THAT TO THE BEST OF MY KNOWLEDGE AND BELIEF ALL PROVISIONS ARE IN ACCORDANCE WITH THE STORMWATER MANAGEMENT AND SEDIMENT CONTROL ORDINANCE OF YORK COUNTY, SOUTH CAROLINA.

DATE: 8-2-19
 REGISTERED PROFESSIONAL ENGINEER

VICINITY MAP

SCALE: 1" = 100'

NAME: [Signature]
 TITLE: CIVIL ENGINEER
 DATE: 8-2-19

I HAVE PLACED MY SEAL AND SIGNATURE ON THE DESIGN DOCUMENTS SUBMITTED FOR THE DESIGN OF THE SYSTEM. FURTHER, I CERTIFY TO THE BEST OF MY KNOWLEDGE AND BELIEF THAT THE DESIGN IS CONSISTENT WITH THE REQUIREMENTS OF TITLE 46, CHAPTER 14 OF THE CODE OF LAWS OF SC, 1976 AS AMENDED, PURSUANT TO REGULATION 72-300 ET SEQ. (IF APPLICABLE), AND IN ACCORDANCE WITH THE TERMS AND CONDITIONS OF SCR100000.

MDV Engineering

C/O Ayer Design Group
 215 Johnston Street
 Rock Hill, SC 29730
 Phone: 704-400-1044 Email: michael@mdveng.com

SOUTH CAROLINA ENGINEERING, LLC
 No. 021580
 8-2-19

PROJECT

Arbys

RESTAURANT with DRIVE-THRU

2385 LEN PATTERSON RD
 FORT MILL, SC 29708
 (YORK COUNTY)

FOR **BRG**
Brumit Restaurant Group

BRUMIT RESTAURANT GROUP, LLC
 P.O. BOX 15726
 ASHEVILLE, NC 28813
 PH: 828.274.5835

REVISIONS

NO.	DESCRIPTION

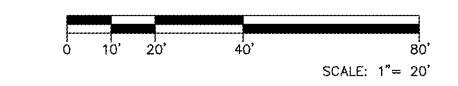

- OBTAIN PRELIMINARY GRADING PERMIT AND POST AT SITE.
- PROVIDE CONSTRUCTION STAKEOUT TO INDICATE WORK LIMITS.
- CONTACT THE SEDIMENT AND EROSION CONTROL INSPECTOR AT 803-909-7157 TO SET UP A PRELIMINARY CONSTRUCTION MEETING 48 HOURS PRIOR TO ANY LAND DISTURBANCE.
- HOLD PRECONSTRUCTION CONFERENCE AT LEAST ONE WEEK PRIOR TO STARTING CONSTRUCTION.
- INSTALL CONSTRUCTION ENTRANCE. CLEAR & GRUB ONLY AS NECESSARY FOR THE INSTALLATION OF PERIMETER CONTROLS AND INSTALL PERIMETER CONTROLS (e.g., silt fence, inlet protection, etc.).
- PROCEED TO NEXT EROSION CONTROL PHASE.
- NO DEMOLITION UNTIL AFTER PRECONSTRUCTION MEETING IS HELD.

CONSTRUCTION SEQUENCE

DWG. NAME : 2019-111
 DRAWN BY : MDN
 DATE : 8.2.19
 SCALE : 1:20

DEMOLITION & EROSION CONTROL PHASE I PLAN

C.0