

FRONT

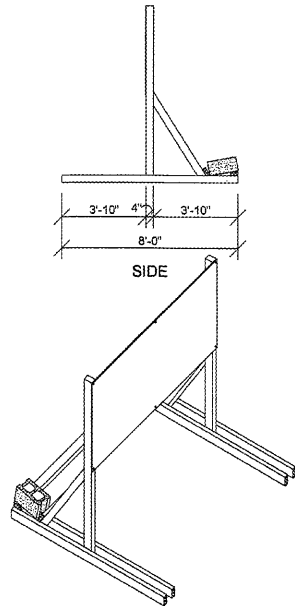

SIDE

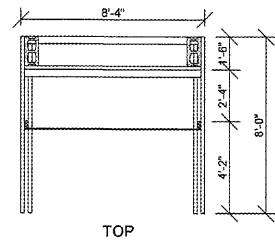

TOP

1 COMING SOON
TEMPORARY CONSTRUCTION SIGN
SG1.2 SCALE: 1/4" = 1'-0"

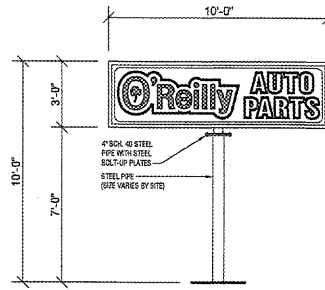

2 GROUND SIGN ELEVATION
SG1.2 SCALE: 1/4" = 1'-0"

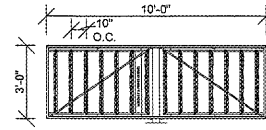

- (A) 14-1/2" deep extruded cabinet with support structure and 2 1/4" retainers
- (B) Internal steel pipe with external steel bolt-up plate(s)
- (C) GE-Tetra PowerStrip DS White LED's, Part #GEWHDFP66 (7500) 6 LED's per module (3 LED's per side) on GE-Tetra Mounting Rails, Part #GEDSR108. Rails on 10" centers. 64 total modules.
- (D) GE-Tetra Power Supplies, Part #GEPS24-180U 24 Volt 90-305VAC 50/60 HZ Load capacity: 16 modules per power supply. Total of four (4) per display.
- (E) Fabricated aluminum internal power supply wireway.

- (A) Faces are formed out of faces with 2" draw. "O'Reilly" graphics are double embossed. "Auto Parts" graphics are embossed with painted graphics on 2nd surface. Graphics to match PMS 201c Red, PMS 342c Green Black.
- (B) Extruded cabinet with retainers. Internal steel pipe with external steel bolt-up plate(s).
- (C) Vertical GE (GEWHDFP66) White DS LED illumination. Paint cabinet to: Gloss Black. Cabinet exposure calculation: C80
- (D) Cabinet to be installed with bolt-up plate(s), paint to: Gloss Black

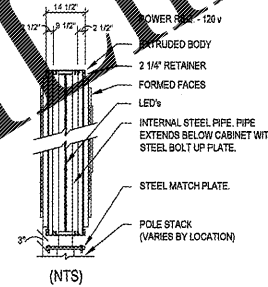

GENERAL NOTES

- (A) REFER TO PROJECT MANUAL FOR ADDITIONAL REQUIREMENTS.
- (B) CONTACT OWNER'S OR TENANT'S DESIGNATED PROJECT ADMINISTRATOR FOR QUESTIONS OR CLARIFICATIONS.
- (C) PERMANENT SIGNAGE OWNER FURNISHED AND INSTALLED. (REFER TO SCOPE OF WORK SCHEDULE). SIGNAGE GRAPHICS PROVIDED FOR REFERENCE ONLY (N.I.C.) AND CONTRACTOR'S COORDINATION WITH SPECIFIC PROJECT CONSTRUCTION CONDITIONS.
- (D) SITE SIGN ROUGH-IN ELECTRICAL TO BE PROVIDED BY CONTRACTOR.
- (E) REQUIRED GOVERNMENTAL PERMITS FOR PERMANENT TYPE SIGNAGE TO BE PROVIDED BY SIGN COMPANY PER OWNER'S DIRECTION (N.I.C.).
- (F) "COMING SOON" TEMPORARY CONSTRUCTION SIGN TO BE PROVIDED BY GENERAL CONTRACTOR. APPLIED SIGNAGE GRAPHIC TO BE OWNER FURNISHED AND GENERAL CONTRACTOR INSTALLED. LOCAL TEMPORARY CONSTRUCTION SIGN ON SITE SO AS TO BE VISIBLE TO PUBLIC FROM RIGHT-OF-WAY.
- (G) UNLESS OTHERWISE INDICATED, SITE POLE SIGN FOUNDATION CONSTRUCTION BY SIGN CONTRACTOR (BY OTHERS - NOT IN CONTRACT) AND SITE MONUMENT SIGN FOUNDATION CONSTRUCTION BY GENERAL CONTRACTOR (BASE BID).

SPECIAL NOTE:
SIGN DESIGN BY OTHERS, REFER TO SIGN CONTRACTOR'S SHOP DRAWINGS FOR ADDITIONAL REQUIREMENTS.

SITE SIGN SCHEDULE

TEMPORARY CONSTRUCTION SIGN:
TYPE: COMING SOON
DETAIL: REFER TO 1/SG1.2

SITE SIGN:
TYPE: POLE (3H X 10W X 10' OAH)
DETAIL: REFER TO 2/SG1.2

NOTE:
REFER TO SHEET S1.2 FOR SIGN FOUNDATION SYSTEM STRUCTURAL REQUIREMENTS.

Order Plans @ www.ldiinline.com

DESIGN BY OTHERS FOR REFERENCE ONLY

CRAIG A. SCHNEIDER, AIA
ARCHITECT

417.862.0658
Fax: 417.862.3265

1706 East Sunshine, Suite 417
Springfield, Missouri 65804

PROJECT: NEW O'REILLY AUTO PARTS STORE
N. MAIN ST.
WALNUT COVE, NC

O'Reilly AUTO PARTS
CORPORATE OFFICES
233 SOUTH PATTERSON
SPRINGFIELD, MISSOURI 65802
(417) 862-2674 TELEPHONE

COMM # 4300
DATE: 3-22-19
REVISION
DATE:

SG1.2