

RECEIVED
MAR 21 2019
1736 EAST SUNSHINE ST
SPRINGFIELD, MO 65802

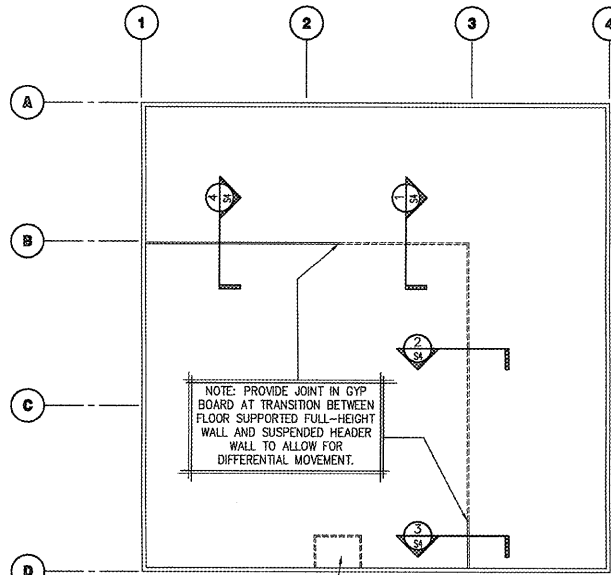

PROVIDE 16ga COLD-FORMED STEEL (CFS) FRAMING AT ENTRY LOCATION, WHERE APPLICABLE ALIGN FRAMING MEMBERS WITH METAL STUDS OVER STOREFRONT (SPACING NOT TO EXCEED 24" O.C.) ALL CFS-TO-CFS CONNECTIONS TO BE A MINIMUM OF (3) #8 SDS. REFER TO ARCHITECTURAL SECTIONS FOR FRAMING PROFILES AND MEMBER DEPTHS.

STRUCTURAL PLAN

SCALE: NONE

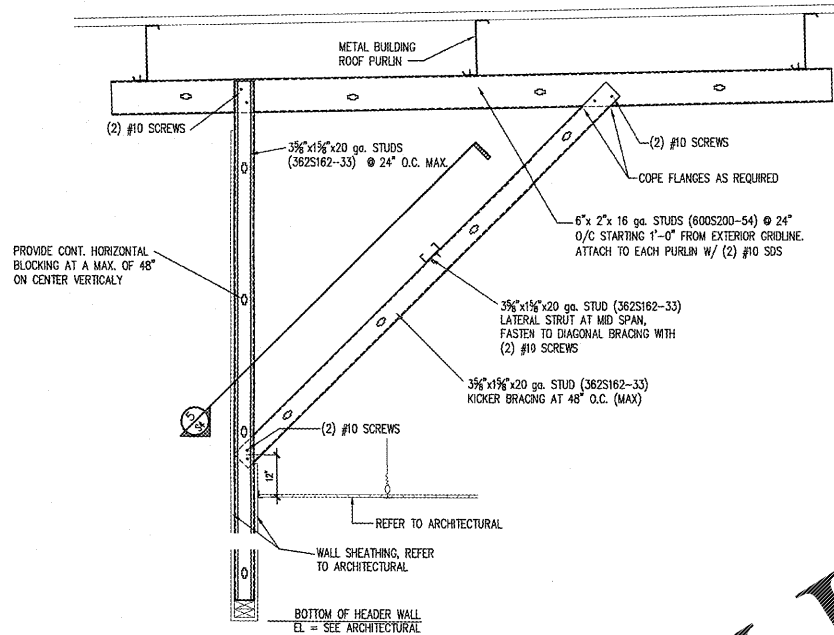

1 SECTION

S4 SCALE: 3/4" = 1'-0"

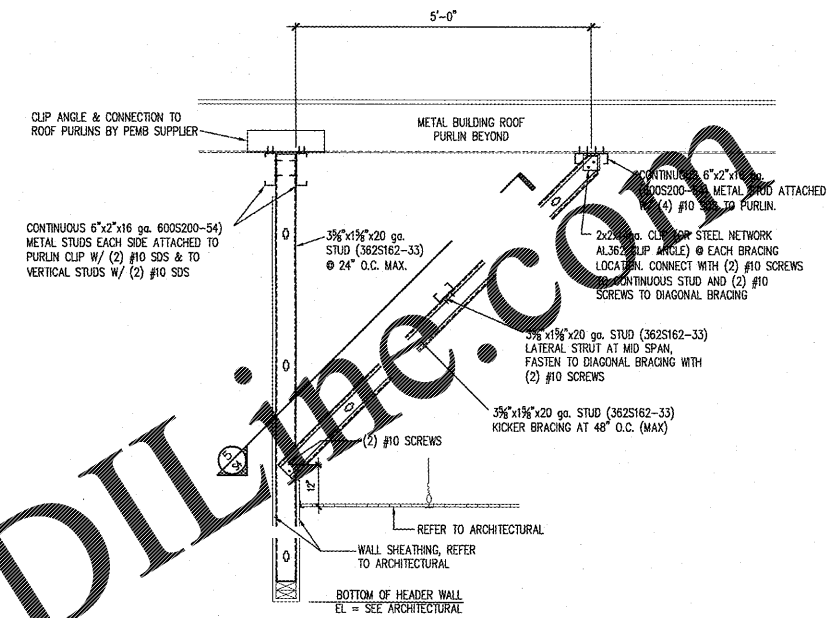

2 SECTION

S4 SCALE: 3/4" = 1'-0"

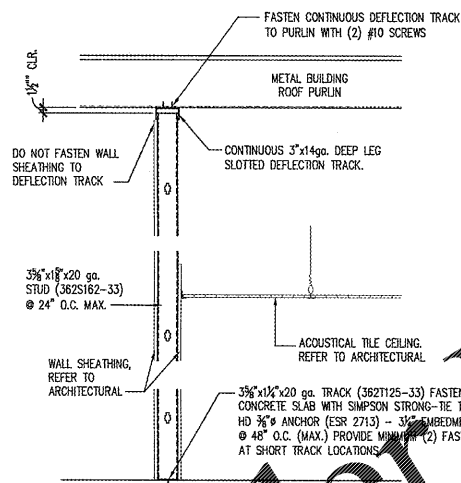

3 SECTION

S4 SCALE: 3/4" = 1'-0"

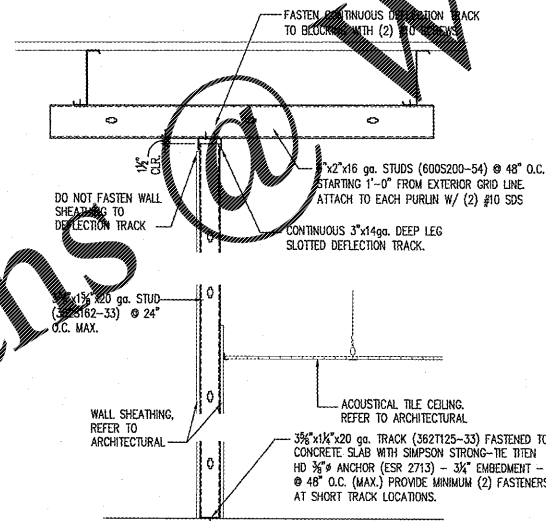

4 SECTION

S4 SCALE: 3/4" = 1'-0"

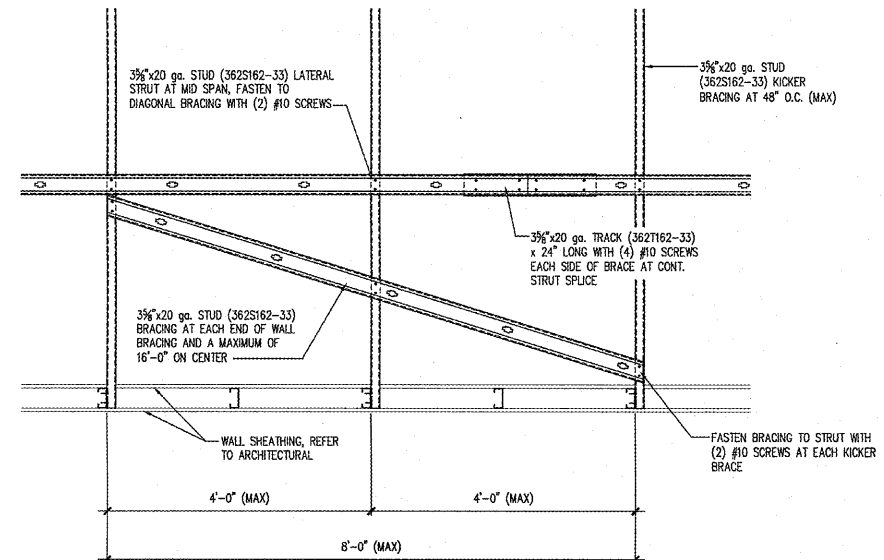

5 SECTION

S4 SCALE: 3/4" = 1'-0"

Order Plans @ WWW.LDILINE.COM



CRAIG A. SCHNIDER, AIA
ARCHITECT

1736 East Sunshine, Suite 417
Springfield, Missouri 65802
417-862-6558
417-862-3265
e-mail: architect@estortyschneider.com

PROJECT:
NEW O'REILLY AUTO PARTS STORE
N. MAIN ST.
WALNUT COVE, NC

FRAMING DETAILS

O'Reilly AUTO PARTS
CORPORATE OFFICES
233 SOUTH PATTERSON
SPRINGFIELD, MISSOURI 65802
(417) 862-2674 TELEPHONE

COMM # 4300
DATE: 3-22-19
REVISION
DATE:

Jeffrey S. Smith, P.E.
Jeffrey S. Smith P.E. 12812
1801 W 32nd St. Bldg B Ste 104 * JOPLIN, MISSOURI 64804
P.O. Box 8102 * JOPLIN, MISSOURI 64802
PHONE: 417-624-0444 * FAX: 417-624-0430