

222 cloister court
 chapel hill, nc 27514
 919.401.8586
 www.cra-aec.com

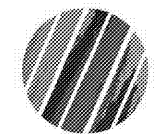

Renovation of
 920 Corporate Drive
 Orange County Schools
 920 Corporate Drive
 Hillsborough, North Carolina



no. revisions

The use of these plans and specifications shall be restricted to the original and for which they were prepared and publication thereof in any form, printed or electronic, is prohibited without the prior written consent of the architect. It is to be returned upon request to the architect. These plans and specifications are the property of the architect and shall remain confidential.

drawn JMG checked JSD

ATTIC LEVEL
 ELECTRICAL PLAN

sheet

E302

project no. 2019016.00

date 7.22.19

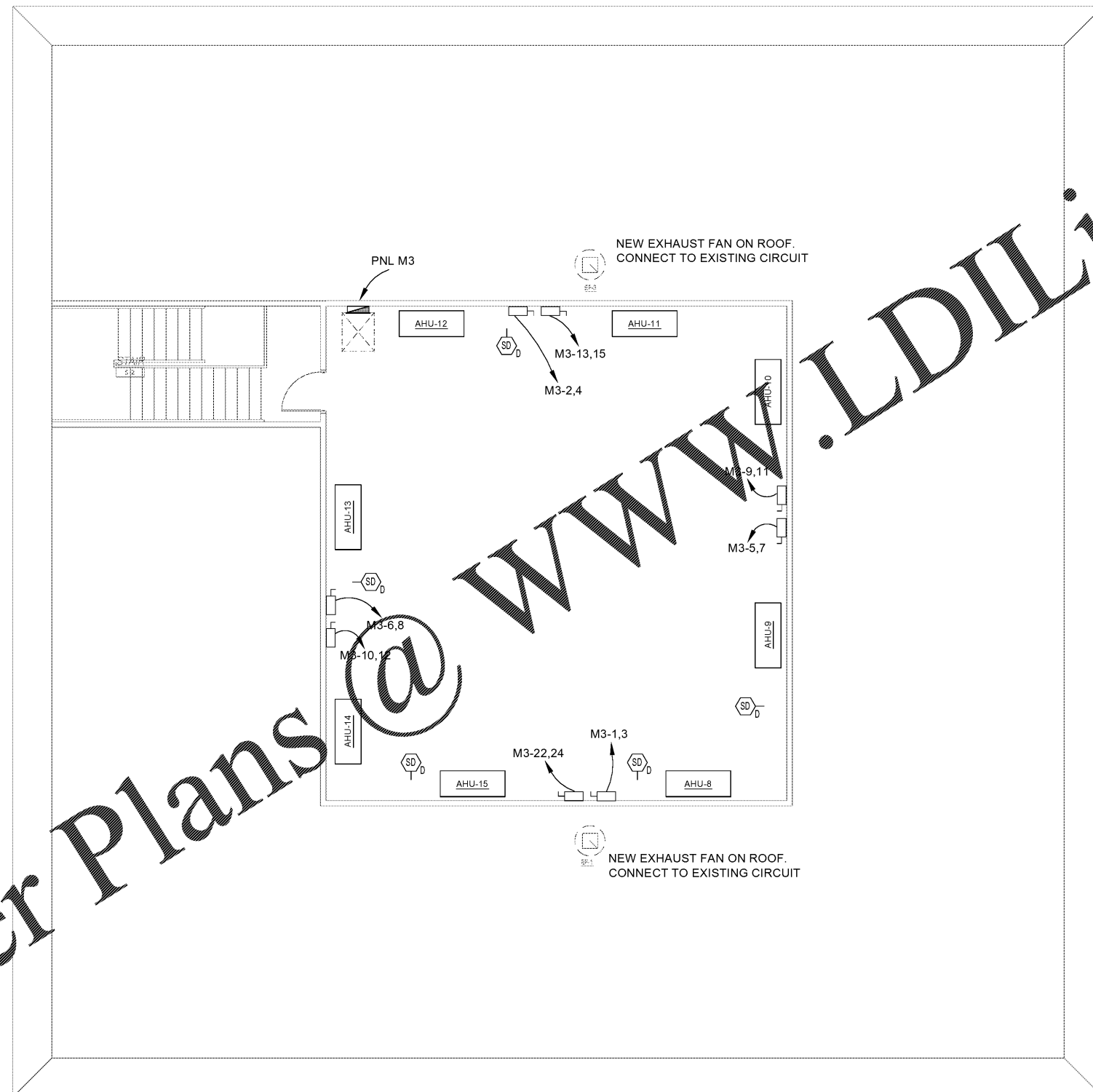

Order Plans @ WWW.LDILine.com

ATTIC LEVEL ELECTRICAL PLAN
 SCALE: 1/4" = 1'-0"