

JOB NO.

NORWOOD ARCHITECTS
 807 J. J. Forrest Blvd., NW
 Atlanta, Georgia 30318
 Ph. 678-921-0302 Fax. 678-921-0301
 www.norwoodarchitects.com

HUDDLE HOUSE
 EVO 2000 RESTAURANT
 US HIGHWAY 43 RUSSELVILLE, AL
 FRANKLIN CO. 35653

NO.	ISSUE DATE

DRAWING NUMBER

E300

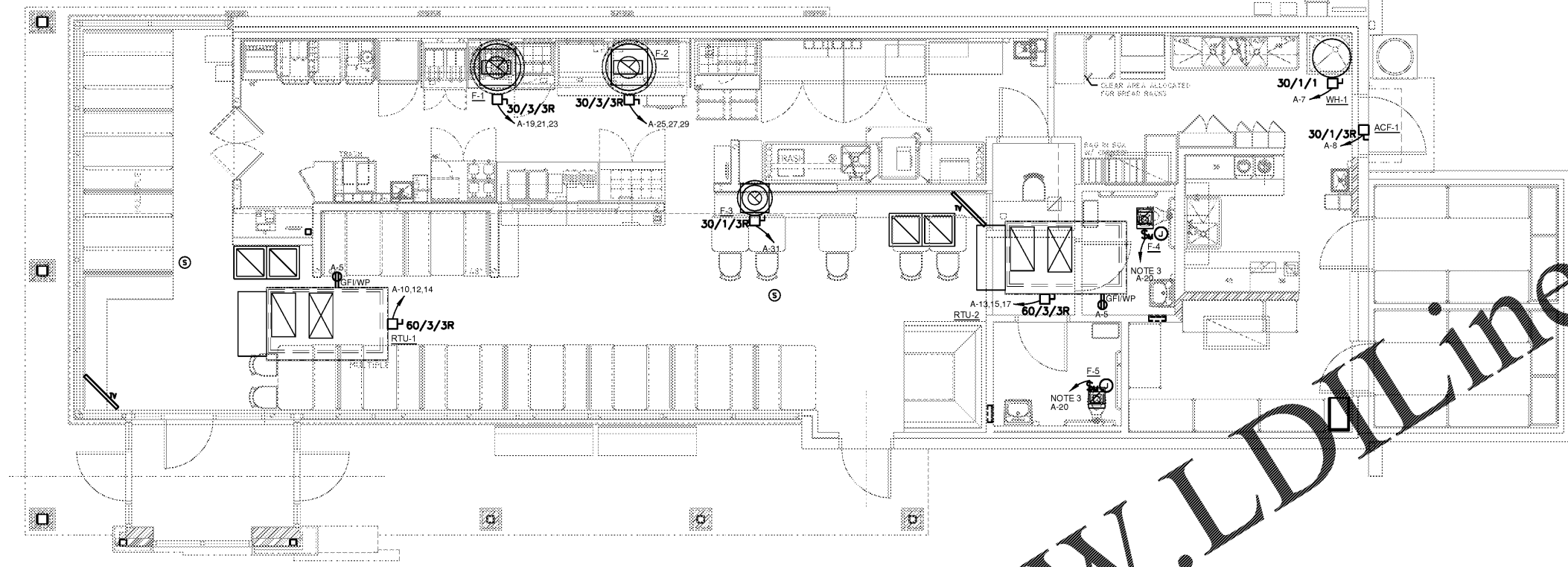

MECHANICAL FLOOR PLAN
 1/4" = 1'-0"

MECHANICAL NOTES:

1. PROVIDE JUNCTION BOX AND CONDUIT THROUGH SEALED OPENING FOR CONTROL WIRING/POWER WIRING TO MECHANICAL UNITS ON THE ROOF. COORDINATE EXACT EQUIPMENT LOCATIONS WITH MECHANICAL DRAWINGS PRIOR TO INSTALLATION.
2. EXTERIOR RECEPTACLE SHALL BE "WEATHER RESISTANT" TYPE AND LABELLED ACCORDINGLY BY THE MANUFACTURER. WEATHER PROOF COVER SHALL BE PROVIDED THAT IS WEATHER PROOF WHILE IN USE. THE RECEPTACLE SHALL BE GFI TYPE.
3. EXHAUST FANS TO BE INTERLOCKED WITH LIGHT FIXTURES AND CONTROLLED BY OCCUPANCY SENSOR SWITCH.

MECHANICAL EQUIPMENT SCHEDULE

EQUIPMENT NAME	LOCATION / SERVER	VOLTAGE	PHASE	HP	KW	KW / POLE	MCA	MDCP	BREAKER AMPACITY	PANEL	TERMINAL	DISCONNECT (NOTE 1)				
												SIZE	POLES	FUSE SIZE	ENCLOSURE	CONTROL
F-1	KITCHEN	208	3		0.36	3.0	1.7	20	20	A-19,21,23	2 2 12 14 12 G-1/2"	36	3	NE	NEMA 3R	BY DIVISION 15
F-2	KITCHEN	208	3		0.36	3.0	1.7	20	20	A-25,27,29	2 2 12 14 12 G-1/2"	36	3	NE	NEMA 3R	BY DIVISION 15
F-3	KITCHEN	208	3		0.49	3.8	2.2	20	20	A-21	2 2 12 14 12 G-1/2"	36	3	NE	NEMA 3R	BY DIVISION 15
F-4	RESTROOMS	120	1		0.05	0.4	0.5	20	20	A-28	2 2 12 14 12 G-1/2"					BY DIVISION 17
F-5	RESTROOMS	120	1		0.05	0.4	0.5	20	20	A-28	2 2 12 14 12 G-1/2"					BY DIVISION 18
RTU-1	EXTERIOR	208	3		4.03	33.6	42.0	50	50	A-10,12,14	1 2 6 14 10 G-1"	60	3	NE	NEMA 3R	BY DIVISION 15
RTU-2	EXTERIOR	208	3		4.87	39.9	42.4	50	50	A-13,15,17	1 2 6 14 10 G-1"	60	3	NE	NEMA 3R	BY DIVISION 15
A-F-1	EXTERIOR	120	1		0.61	5.1	6.4	20	20	A-8	2 2 12 14 12 G-1/2"	36	1	NE	NEMA 3R	BY DIVISION 15
WH-1	BOH	120	1		1.20	10.0	12.5	20	20	A-7	2 2 12 14 12 G-1/2"	36	1	NE	NEMA 1	BY DIVISION 15

NOTES

Order Plans @ www.LDILine.com

ELECTRICAL MECHANICAL PLAN