

**GENERAL NOTES**

A. PROVIDE CAT 6 CABLE FOR ALL TELECOMMUNICATIONS CABLING. CABLE MUST BE ROUTED TO IT CLOSET IN INTERSTITIAL SPACE, AND TERMINATED IN PATCH PANELS. PROVIDE JUNCTION BOX AT 18" A.F.F. UNLESS NOTED OR DESCRIBED OTHERWISE. PROVIDE 1" CONDUIT FOR EACH DROP. FROM JUNCTION BOX TO ABOVE CEILING WITH 90° ELBOW ROUTED TO NEAREST CABLE TRAY. (SEE TELECOMMUNICATIONS OUTLETS DETAIL AND TYPICAL OUTLET DETAILS ON SHEET EY501).

B. FOR ALL SYSTEMS NOTED BELOW THE CONTRACTOR LISTED ARE FOR BASIS OF DESIGN, VERIFY WITH OWNER PRIOR TO BID TO VERIFY THEY ARE STILL THE CONTRACTORS OF RECORD THAT ARE SERVICING THE LISTED EQUIPMENT FOR THE REST OF THIS FACILITY.

**FIRE ALARM SYSTEM NOTES**

A. CONTRACTOR SHALL PROVIDE A COMPLETE AND OPERATIONAL FIRE ALARM SYSTEM. FIRE ALARM EQUIPMENT IS A SEIMENS, NO EQUAL ACCEPTED. MAIN FIRE ALARM DISTRIBUTION ORIGINATES FROM BOILER ROOM GC200A. CONTACT CANDACE SANDUSKY AT 770-279-4832 OR JOE MCNERNEY AT 770-630-1247 WITH SEIMENS INDUSTRY INC. FOR EQUIPMENT AND INSTALLATION. CONTRACTOR SHALL PROVIDE BOXES AND CONDUIT PAINTED RED FROM DEVICE TO DEVICE AS SHOWN ON CONTRACTOR SHOP DRAWINGS. NEW FIRE ALARM EQUIPMENT SHALL BE COMPATIBLE WITH THE EXISTING CAMPUS SEIMENS FIRE ALARM SYSTEM. NEW FIRE ALARM PANELS SHALL BE PROVIDED WITH ALL NECESSARY EQUIPMENT TO CONNECT TO THE NETWORK AND FIRE ALARM INSTALLER SHALL MAKE CONNECTIONS TO EXISTING FACILITY FIRE ALARM SYSTEM. CONTRACTOR SHALL USE THE SOFTWARE AS NECESSARY FOR A COMPLETE AND OPERATIONAL SYSTEM.

**ACCESS CONTROL NOTES**

CONTRACTOR SHALL PROVIDE A COMPLETE AND OPERATIONAL ACCESS CONTROL SYSTEM. CONTRACTOR SHALL PROVIDE BOXES AND CONDUIT TO ABOVE CEILING CABLE TRAY FOR ALL DEVICES SHOWN ON THE PLANS. THE INSTALLER SHALL PROVIDE ALL EQUIPMENT NECESSARY TO CONNECT THIS SYSTEM TO THE NETWORK AND TIE IT INTO THE EXISTING SYSTEM THAT IS SERVICING THIS FACILITY. SYSTEM DEVICES AND CARDS SHALL BE COMPATIBLE WITH THE EXISTING CAMPUS SYSTEM.

**CCTV NOTE**

A. CONTRACTOR SHALL PROVIDE A COMPLETE AND OPERATIONAL CCTV SYSTEM. CONTACT STEVE SMITH AT 770-840-7007 WITH CONVERGENT TECHNOLOGIES FOR EQUIPMENT AND INSTALLATION. CONTRACTOR SHALL PROVIDE BOXES AND CONDUIT TO ABOVE CEILING CABLE TRAY FOR ALL DEVICES SHOWN ON THE PLANS. THE INSTALLER SHALL PROVIDE ALL EQUIPMENT NECESSARY TO CONNECT THIS SYSTEM TO THE NETWORK AND TIE IT INTO THE EXISTING CCTV SYSTEM THAT IS SERVICING THIS FACILITY. SYSTEM DEVICES AND CARDS SHALL BE COMPATIBLE WITH THE EXISTING SYSTEM.

**NURSE CALL NOTE**

A. CONTRACTOR SHALL PROVIDE A COMPLETE AND OPERATIONAL NURSE CALL SYSTEM. EXISTING SYSTEM IS A ASCOM TECHNOLOGIES, CONTACT STEVE MARKS WITH CONVERGENT TECHNOLOGIES AT 678-242-1201 FOR EQUIPMENT AND INSTALLATION. CONTRACTOR SHALL PROVIDE JUNCTION BOXES, CONDUIT, AND ALL EQUIPMENT NECESSARY FOR A COMPLETE AND OPERATIONAL SYSTEM.

- KEY NOTES**
- TELEMETRY FEED THRU BOX. REFERENCE NOTE 5, SHEET ED101.
  - PROVIDE NEW DATA PATCH PANEL, SEE DETAILS AND RISERS ON SHEET ET501.
  - PROVIDE NEW NURSE CALL ANNUNCIATOR PANEL.
  - PROVIDE CCTV PANEL.
  - COORDINATE LOCATION OF SYSTEMS DEVICES WITH HEADWALL UNIT. REFERENCE ARCHITECTURAL PLANS FOR EXACT LOCATION OF HEADWALL UNIT.
  - RELOCATE EXISTING SOFTWARE HOUSE ACCESS CONTROL ENCLOSURE TO THIS LOCATION.
  - PROVIDE FIBER ROUTING TO NEW DATA RACK.
  - MOUNT OUTLET 6" ABOVE BACKSPLASH.
  - PANIC/DURESS PUSHBUTTON. COORDINATE EXACT MOUNTING LOCATION WITH USER PRIOR TO ROUGH IN.
  - PROVIDE A B-LINE "FLEXTRAY" FT4X10X10 SERIES CABLE TRAY OR APPROVED EQUAL. PROVIDE TRAPEZE SUPPORT CLIPS AND 3/8" THREADED ROD ON BOTH SIDES OF TRAY TO STRUCTURE ABOVE PER MANUFACTURER'S RECOMMENDATIONS. PROVIDE A #6 COPPER GROUND CONDUCTOR FROM THE DATA CLOSET GROUND PLATE TO EACH SECTION OF TRAY AND EVERY CONDUIT ROUTED TO TRAY.
  - TELECOMMUNICATIONS GROUND BAR.
  - PROVIDE WOODEN BACKBOARD DOUBLE COATED WITH FIRE RETARDANT PAINT ON ALL WALLS IN THIS SPACE.
  - CONTRACTOR SHALL PROVIDE SINGLE GANG EMPTY BOX AND 1" CONDUIT TO ABOVE ACCESSIBLE CEILING AND CABLING AS NECESSARY FOR SECURITY MONITOR TO BE INSTALLED AT NURSES STATION. COORDINATE EXACT MOUNTING LOCATION WITH USER PRIOR TO ROUGH IN. MONITOR LOCATION SHALL ALSO BE INSTALLED AT POLICE STATION ON ANOTHER FLOOR. COORDINATE WITH POLICE DEPARTMENT FOR EXACT LOCATION. PROVIDE BOX, CONDUIT, CABLING, ETC. FOR A COMPLETE INSTALLATION. MONITOR AND EQUIPMENT TO BE PROVIDED BY OTHERS.
  - INTERCOM PHONE FOR COMMUNICATION BETWEEN NURSES STATION AND SALLY PORT. COORDINATE EXACT MOUNTING LOCATION WITH USER PRIOR TO ROUGH IN.
  - PROVIDE FIRE ALARM CONTROL PANEL.

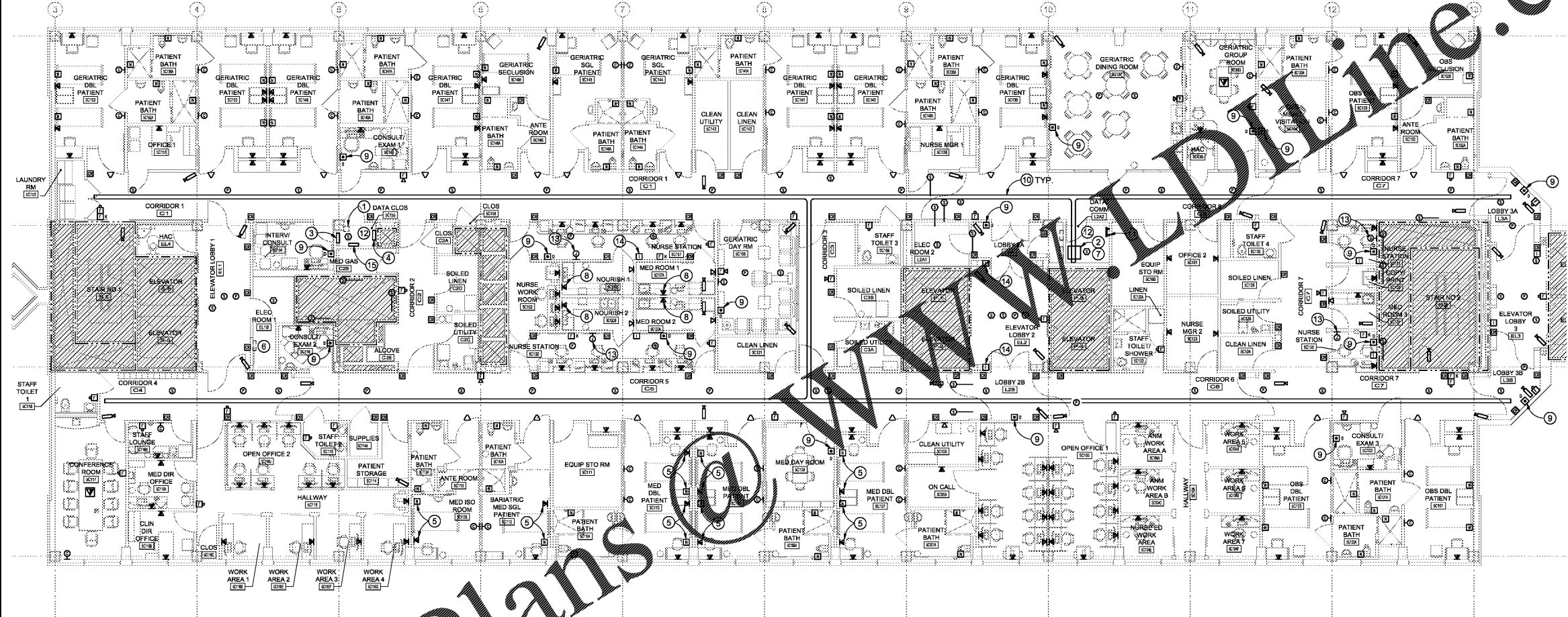

Order Plans

FIFTH FLOOR SPECIAL SYSTEMS PLAN  
SCALE: 1/8" = 1'-0"

Revisions:	Date:

**CONSULTANT**

**CLARKNEXSEN**

440 Martin Luther King Jr. Blvd  
Macon, GA 31201  
478.743.8415 Fax: 478.743.8239  
www.clarknexsen.com

**ARCHITECT/ENGINEER OF RECORD**

**TOLAND MIZELL MOLNAR**

590 MEANS STREET NW  
STE. 200  
ATLANTA, GA 30316

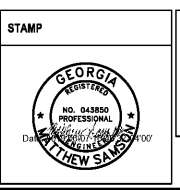

Office of Construction and Facilities Management  
VA U.S. Department of Veterans Affairs

Drawing Title  
**FIFTH FLOOR SPECIAL SYSTEMS PLAN**

Approved: Project Director

Phase  
**FINAL SUBMITTAL**

**FULLY SPRINKLERED**

Project Title <b>RENOVATE GERIATRIC-MED-PSYCH INPATIENT 5TH FLOOR</b>	Project Number <b>508-17-101</b>
Location <b>Atlanta VA Medical Center - Atlanta, Ga.</b>	Building Number <b>Bldg C: Main Tower</b>
Issue Date <b>06-07-2019</b>	Checked <b>PEW</b>
Drawn <b>TWG</b>	Drawing Number <b>ET101</b>