

GENERAL NOTES

- A. ALL TYPE D NIGHTLIGHT FIXTURES ARE WIRED AHEAD OF THE SWITCHES.
- B. PROVIDE ALL EMERGENCY FIXTURES WITH UL 924 RELAY. LIGHT SHALL SWITCH TO EMERGENCY CIRCUIT UPON LOSS OF NORMAL POWER.
- C. ALL EQUIPMENT INSTALLED IN AREAS WITH PATIENT ACCESS SHALL BE INSTALLED WITH TAMPER RESISTANT SCREWS.

NOTES:
(LIGHTING CONTROL RISER DIAGRAM ONLY)

- ① EXACT NUMBER OF DEVICES SHOWN ON PLANS.
- ② POWER CONNECTION TO LIGHT FIXTURE.
- ③ NORMAL LIGHTING CIRCUIT SERVING SPACE.
- ④ CAT 6 CABLE.
- ⑤ LIGHTING CONTROL CABLE NOT SHOWN ON FLOOR PLANS.
- ⑥ TO NEXT OCCUPANCY SENSOR.
- ⑦ PROVIDE 2 IN/1 OUT CAT 6 ADAPTER AT EACH DEVICE IF NOT PROVIDED INTEGRAL TO UNIT.
- ⑧ EACH ROOM THAT HAS AN OS IS TO HAVE A ROOM CONTROLLER.
- ⑨ EMERGENCY LIGHTING CIRCUIT SERVING THIS SPACE.

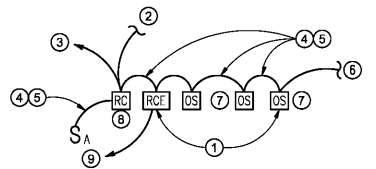

LIGHTING AND RECEPTACLE CONTROL RISER DIAGRAM
SCALE: NONE
(TYPICAL FOR ALL SPACES UTILIZING ROOM CONTROLLERS)

KEY NOTES

- 1. COORDINATE LOCATION OF SWITCH WITH HEADWALL UNIT. REFERENCE ARCHITECTURAL PLANS FOR EXACT LOCATION OF HEADWALL UNIT.

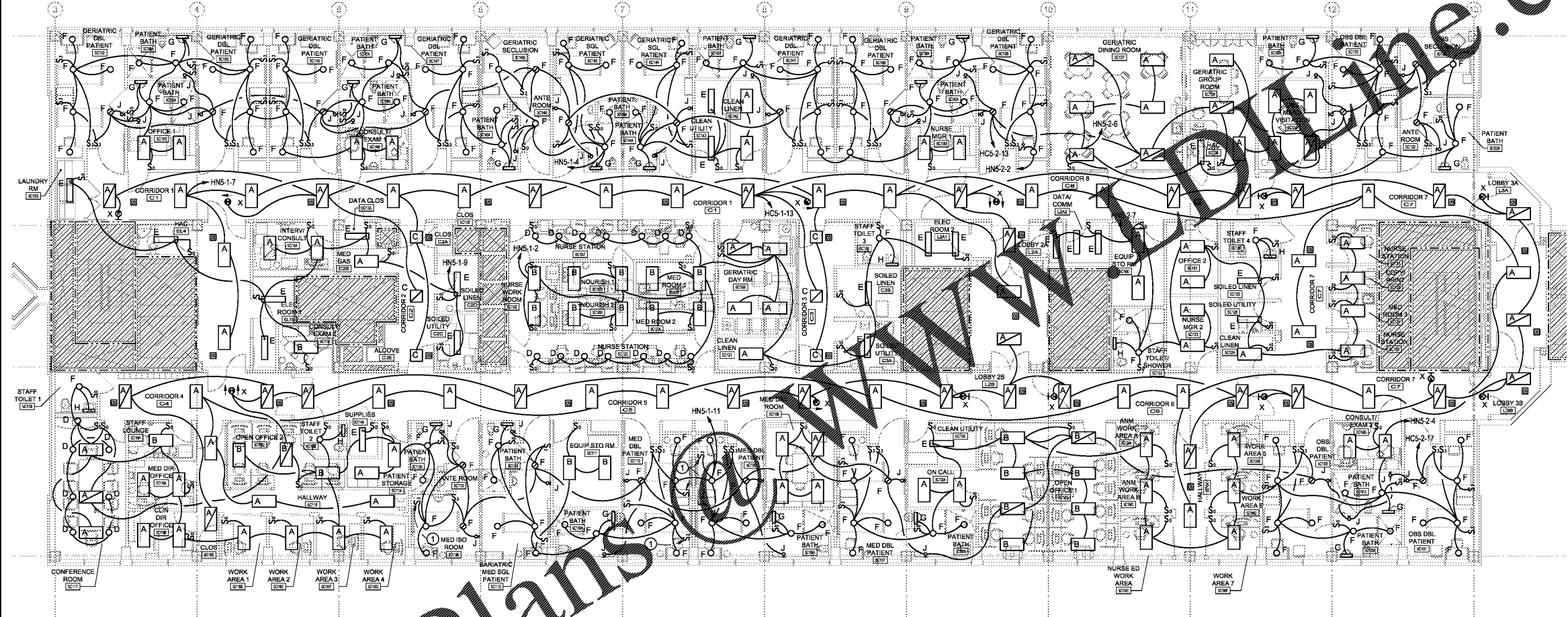

Order Plans

FIFTH FLOOR LIGHTING PLAN
SCALE: 1/8" = 1'-0"

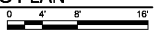

	<p>CONSULTANT</p> <p>CLARKNEXSEN</p> <p>440 Martin Luther King Jr. Blvd Macon, GA 31201 478.743.8415 Fax: 478.743.8239 www.clarknexsen.com</p>	<p>ARCHITECT/ENGINEER OF RECORD</p> <p>TOLAND MIZELL MOLNAR</p> <p>590 MEANS STREET NW STE. 200 ATLANTA, GA 30318</p>	<p>STAMP</p>	<p>Office of Construction and Facilities Management</p> <p>VA U.S. Department of Veterans Affairs</p>	<p>Drawing Title</p> <p>FIFTH FLOOR LIGHTING PLAN</p> <p>Approved: Project Director</p>	<p>Phase</p> <p>FINAL SUBMITTAL</p> <p>FULLY SPRINKLERED</p>	<p>Project Title</p> <p>RENOVATE GERIATRIC-MED-PSYCH INPATIENT 5TH FLOOR</p> <p>Location Atlanta VA Medical Center - Atlanta, Ga.</p>	<p>Project Number</p> <p>508-17-101</p> <p>Building Number</p> <p>Bldg C: Main Tower</p> <p>Drawing Number</p> <p>EL101</p>
<p>Revisions:</p>	<p>Date:</p>	<p>Issue Date: 06-07-2019 Checked: PEW Drawn: TWG</p>						

PROJECTS/2020/240-11M.VA.ATLANTA.RENOVATE.GERIATRIC.MED.PSYCH/240-11M.VA.ATLANTA.RENOVATE.GERIATRIC.MED.PSYCH/EL101.DWG