

A
B
C
D
E
F

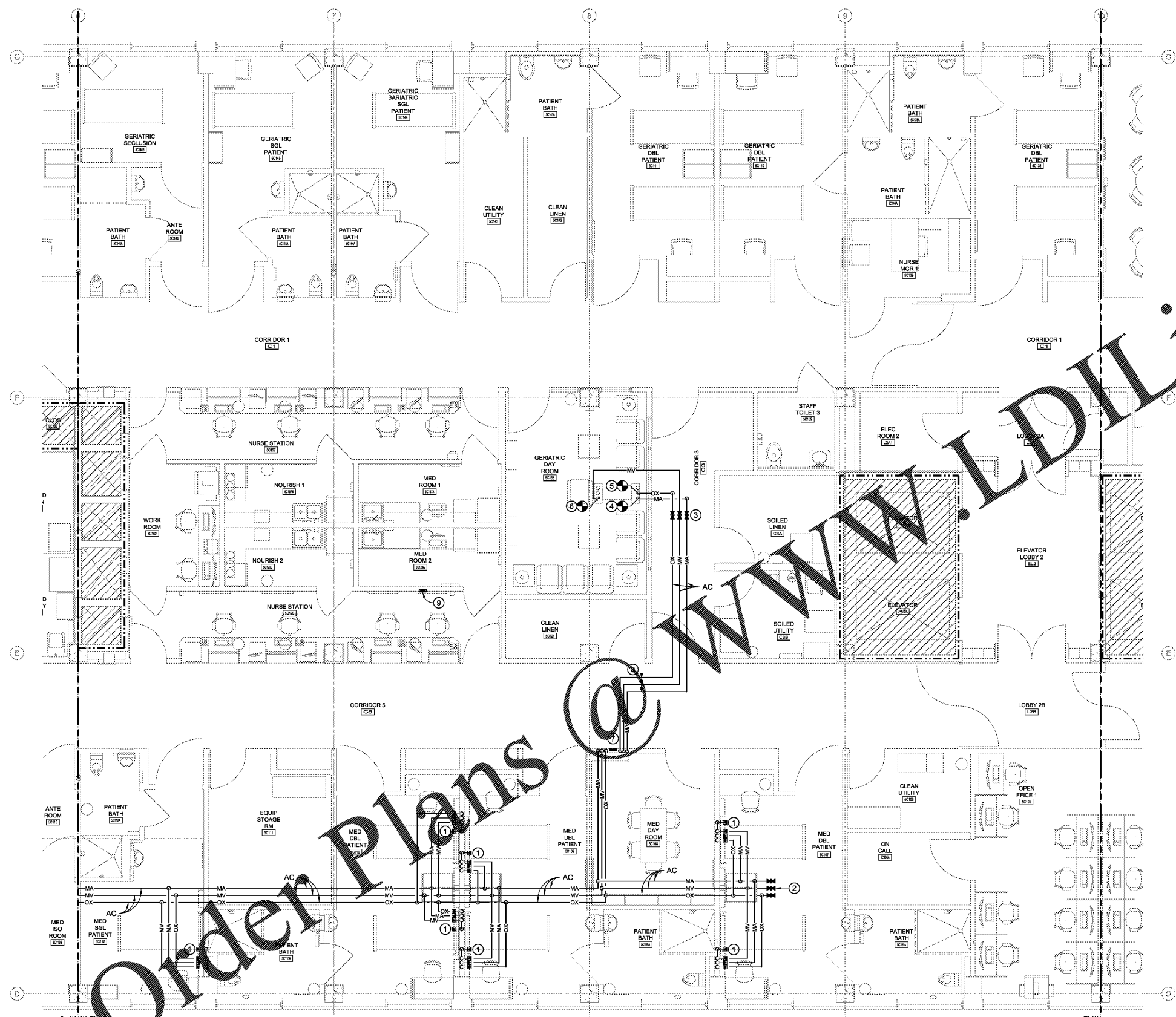

FIFTH FLOOR MEDICAL GAS AND VACUUM DISTRIBUTION PLAN CENTER
SCALE: 1/4" = 1'-0"

GENERAL NOTES

- A. CONTRACTOR SHALL REMOVE AND REPAIR PORTIONS OF FLOORS, CEILINGS AND/OR SLABS AFFECTED BY PLUMBING MODIFICATIONS. REPAIR SURFACES TO MATCH EXISTING UNLESS NOTED OTHERWISE ON ARCHITECTURAL DRAWINGS.
- B. CONNECT PRESSURE SWITCHES TO AREA ALARM PANEL. COORDINATE WITH ELECTRICAL CONTRACTOR TO PROVIDE ALL NECESSARY CONDUIT, CONNECTORS AND CONDUCTORS FOR COMPLETE AND OPERABLE LEVEL 1 ALARM SYSTEM PER NFPA 99. ALL ALARM COMMUNICATION WIRING SHALL BE ROUTED IN CONDUIT. PLUMBING CONTRACTOR SHALL COORDINATE WITH ELECTRICAL CONTRACTOR TO PROVIDE NECESSARY EMT CONDUIT.
- C. PRIOR TO PERFORMING ANY WORK OR PURCHASING ANY MATERIAL, THE CONTRACTOR SHALL VERIFY WITH COR FOR THE EXISTING STATUS OF OUTLET AND INLET TERMINAL.
- D. ALL IN LINE MEDICAL GAS SHUT OFF VALVES SHALL BE OF LOCKING TYPE AND LOCKED OPEN UNLESS OTHERWISE NOTED.
- E. SEE ARCHITECTURAL PLANS FOR WALL RATINGS.

KEY NOTES

1. CONNECT MEDICAL AIR, OXYGEN, AND MEDICAL VACUUM TO HEADWALL UNIT. REFER TO ARCHITECTURAL DRAWINGS FOR HEIGHT AND LOCATION OF OUTLETS/INLETS. 2 MEDICAL AIR, 2 OXYGEN OUTLETS, AND 4 MEDICAL VACUUM INLETS WITH SLIDES.
2. PROVIDE AND INSTALL LOCKING THREE PIECE BALL VALVES ABOVE THE FIFTH FLOOR CEILING AT APPROXIMATE LOCATION INDICATED. VALVES SHALL BE LOCKED CLOSED.
3. PROVIDE AND INSTALL LOCKING THREE PIECE BALL VALVES ABOVE THE FIFTH FLOOR CEILING AT APPROXIMATE LOCATION INDICATED. VALVES SHALL BE LOCKED OPEN.
4. CONNECT NEW MEDICAL AIR PIPING TO EXISTING MEDICAL AIR RISER ABOVE THE FIFTH FLOOR CEILING AT APPROXIMATE LOCATION INDICATED.
5. CONNECT NEW OXYGEN PIPING TO EXISTING OXYGEN RISER ABOVE THE FIFTH FLOOR CEILING AT APPROXIMATE LOCATION INDICATED.
6. CONNECT NEW MEDICAL VACUUM PIPING TO EXISTING MEDICAL VACUUM RISER ABOVE THE FIFTH FLOOR CEILING AT APPROXIMATE LOCATION INDICATED.
7. PROVIDE AND INSTALL NEW TRIPLE ZONE VALVES AND RECESSED BOX ASSEMBLY; MEDICAL AIR, OXYGEN, AND MEDICAL VACUUM.
8. PROVIDE AND INSTALL NEW PRESSURE AND VACUUM SWITCHES/SENSORS ABOVE THE FIFTH FLOOR CEILING AT APPROXIMATE LOCATION INDICATED. PROVIDE ORIFICE NIPTLE BETWEEN PIPE LINE AND SWITCHES/SENSORS. PLUMBING CONTRACTOR SHALL COORDINATE WITH ELECTRICAL CONTRACTOR TO PROVIDE 1/2" EMT CONDUIT FROM SWITCH TO AREA ALARM PANEL.
9. PROVIDE AND INSTALL NEW AREA ALARM PANEL AT APPROXIMATE LOCATION INDICATED. REFER TO SCHEDULE ON PLUMBING DRAWING P-501.

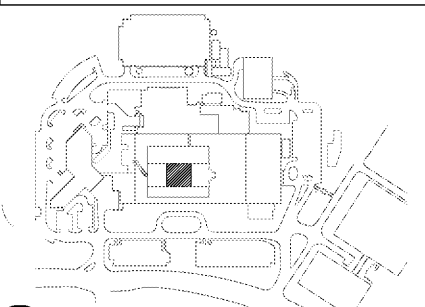

KEY PLAN
SCALE: NONE

Revisions:	Date:

CONSULTANT
CLARKNEXSEN
440 Martin Luther King Jr. Blvd
Macon, GA 31201
478.743.8415 Fax: 478.743.8239
www.clarknexsen.com

ARCHITECT/ENGINEER OF RECORD
TOLAND MIZELL MOLNAR
590 MEANS STREET NW
STE. 200
ATLANTA, GA 30316

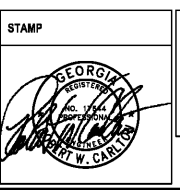

Office of Construction and Facilities Management
VA U.S. Department of Veterans Affairs

Drawing Title
FIFTH FLOOR MEDICAL GAS AND VACUUM DISTRIBUTION PLAN CENTER
Approved: Project Director

Phase
FINAL SUBMITTAL
FULLY SPRINKLERED

Project Title
RENOVATE GERIATRIC-MED-PSYCH INPATIENT 5TH FLOOR
Location
Atlanta VA Medical Center - Atlanta, Ga.
Issue Date
06-07-2019
Checked
WAW
Drawn
DLB

Project Number
508-17-101
Building Number
Bldg C: Main Tower
Drawing Number
PP108