

A
B
C
D
E
F

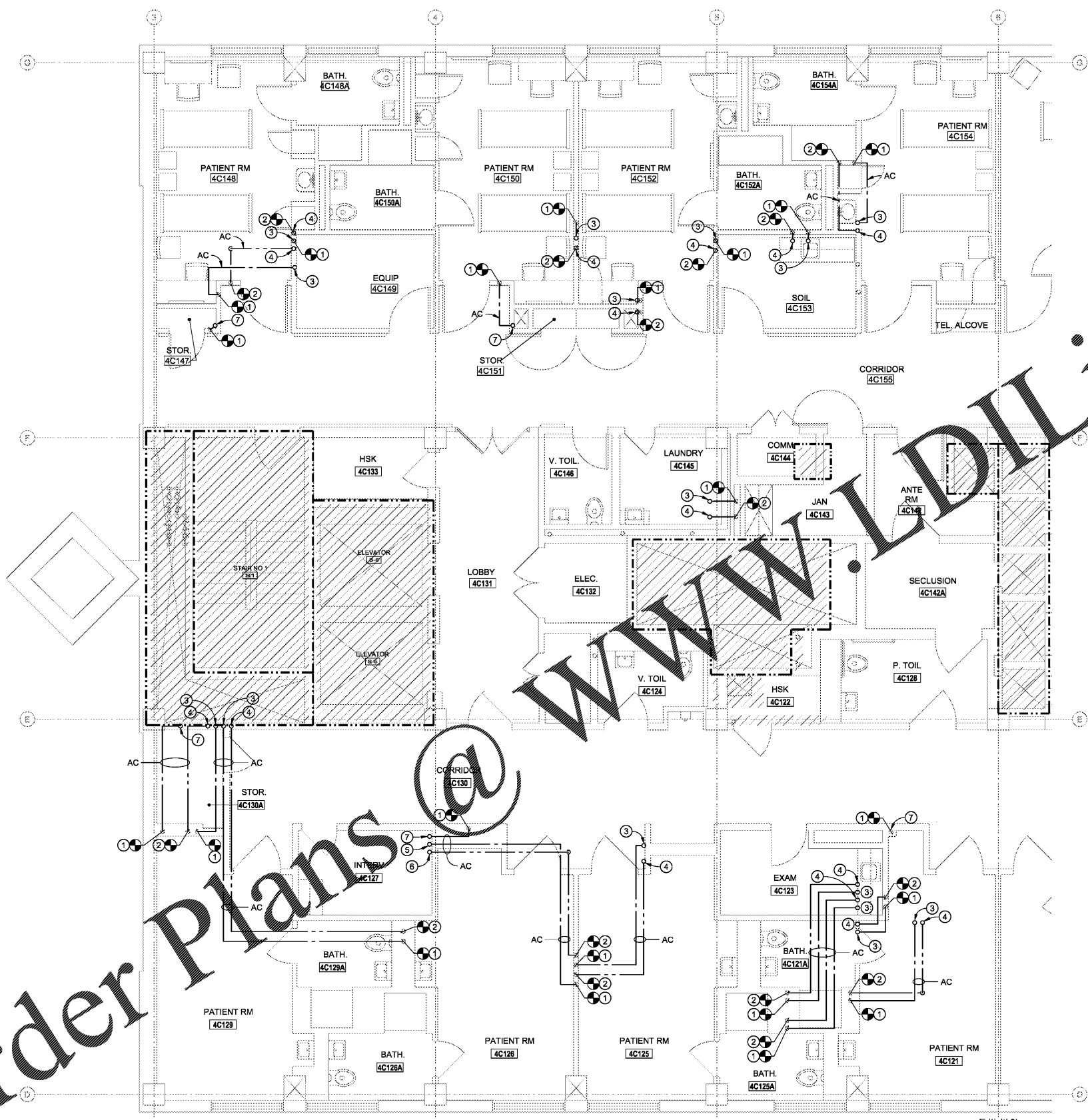

GENERAL NOTES

- A. ALL DOMESTIC WATER PIPING SHALL BE INSULATED, IN CEILING, INTERSTITIAL SPACES, AND IN WALLS. DOMESTIC COLD WATER INSULATION SHALL BE VAPOR RETARDER (VAPOR BARRIER).
- B. COORDINATE PIPE ROUTING WITH DUCT ROUTING, EQUIPMENT LOCATIONS, ELECTRICAL INSTALLATIONS, AND BUILDING STRUCTURAL MEMBERS. OFFSET PIPING WHERE REQUIRED TO AVOID CONFLICTS. AVOID PENETRATING ANY MAIN STRUCTURAL BEAM. NOTIFY COR AND ARCHITECT OF ANY CONFLICTS.
- C. CONTRACTOR SHALL REMOVE AND REPAIR PORTIONS OF FLOORS, CEILINGS AND/OR SLABS AFFECTED BY PLUMBING MODIFICATIONS. REPAIR SURFACES TO MATCH EXISTING UNLESS NOTED OTHERWISE ON ARCHITECTURAL DRAWINGS.
- D. PRIOR TO PERFORMING ANY PLUMBING WORK OR PURCHASING ANY MATERIALS, VERIFY EXACT LOCATION, ROUTING AND PIPE SIZES, ETC. OF ALL EXISTING DOMESTIC WATER PIPING.

KEY NOTES

1. CONNECT NEW DOMESTIC COLD WATER SUPPLY PIPING TO EXISTING DOMESTIC COLD WATER SUPPLY PIPING ABOVE 4TH FLOOR CEILING AT APPROXIMATE LOCATION INDICATED.
2. CONNECT NEW DOMESTIC HOT WATER SUPPLY PIPING TO EXISTING DOMESTIC HOT WATER SUPPLY PIPING ABOVE 4TH FLOOR CEILING AT APPROXIMATE LOCATION INDICATED.
3. 1" DCWS-UP.
4. 1" DHWS-UP.
5. 1-1/4" DCWS-UP.
6. 1-1/4" DHWS-UP.
7. 2" DCWS-UP.

Order Plans @

WWW.LDILine.com

FOURTH FLOOR DOMESTIC WATER DISTRIBUTION PLAN SOUTH
SCALE: 1/4" = 1'-0"

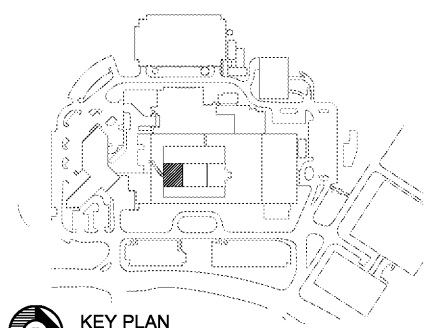

KEY PLAN
SCALE: NONE

Revisions:	Date:

CONSULTANT

CLARKNEXSEN

440 Martin Luther King Jr. Blvd
Macon, GA 31201
478.743.8415 Fax: 478.743.8239
www.clarknexsen.com

ARCHITECT/ENGINEER OF RECORD

TOLAND MIZELL MOLNAR

590 MEANS STREET NW
STE. 200
ATLANTA, GA 30316

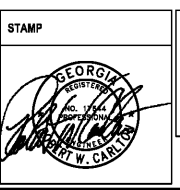

Office of Construction and Facilities Management

VA U.S. Department of Veterans Affairs

Drawing Title
FOURTH FLOOR DOMESTIC WATER DISTRIBUTION PLAN SOUTH

Approved: Project Director

Phase
FINAL SUBMITTAL

FULLY SPRINKLERED

Project Title
RENOVATE GERIATRIC-MED-PSYCH INPATIENT 5TH FLOOR

Location
Atlanta VA Medical Center - Atlanta, Ga.

Issue Date: 06-07-2019
Checked: GTK
Drawn: DLB

Project Number: 508-17-101
Building Number: Bldg C: Main Tower
Drawing Number: **PP101**