

- ### 5TH FLOOR PLAN NOTES
- A. THE CONTRACTOR SHALL VERIFY ALL EXISTING CONDITIONS INCLUDING DIMENSIONS OF INSTALLED CONSTRUCTION PRIOR TO COMMENCING WITH THE WORK. IN THE EVENT THAT ANY DISCREPANCIES BETWEEN THE INDICATED WORK AND EXISTING CONDITIONS ARE DISCOVERED, THE CONTRACTOR SHALL NOTIFY THE COR FOR INTERPRETATION AND DIRECTION PRIOR TO PROCEEDING WITH THE WORK.
 - B. CONTRACTOR SHALL MAINTAIN ALL FIRE-RATED ASSEMBLIES WITHIN THE PROJECT AREA DURING PERFORMANCE OF THE WORK.
 - C. ALIGN NEW WALLS WITH EXISTING TO REMAIN WHERE NOT OTHERWISE DIMENSIONED.
 - D. DIMENSIONS TYPICAL AMONG COMMON INPATIENT ROOMS BY TYPE.
 - E. ALL WALLS SHALL BE GCM UNLESS NOTED OTHERWISE.
 - F. ALL EXISTING CMU CONCRETE WALLS TO BE FURRED AS REQUIRED (ALL TYPICAL).

- ### 5TH FLOOR PLAN KEYNOTES
- FLOOR PLAN KEY NOTES
(ALL NOTES NOT USED ON ALL SHEETS)
- 1 ALIGN FRAMING AND FINISH WORK TO ALIGN WITH FINISH COLUMN ENCLOSURE TYPICAL.
 - 2 LOCKING LOCKERS. SEE SPECIFICATIONS.
 - 3 MTL FURRING, GYP BD AND PAINT FINISH AROUND EXIST MAIN FACILITY MED GAS LINES. DIMENSIONS OF OVERALL CHASE TO BE KEPT TO AN ABSOLUTE MINIMUM.
 - 4 REMOVE AND REPLACE EXISTING EXPANSION JOINT AND COVERS.
 - 4 PROVIDE NEW PNEUMATIC TUBE STATION. COORDINATE WITH SYSTEM SUPPLIER PEVCO, BALTIMORE, MD. (401)831-8800. DESIGN AND INSTALL BY PEVCO. CONFIRM EXACT LOCATION.

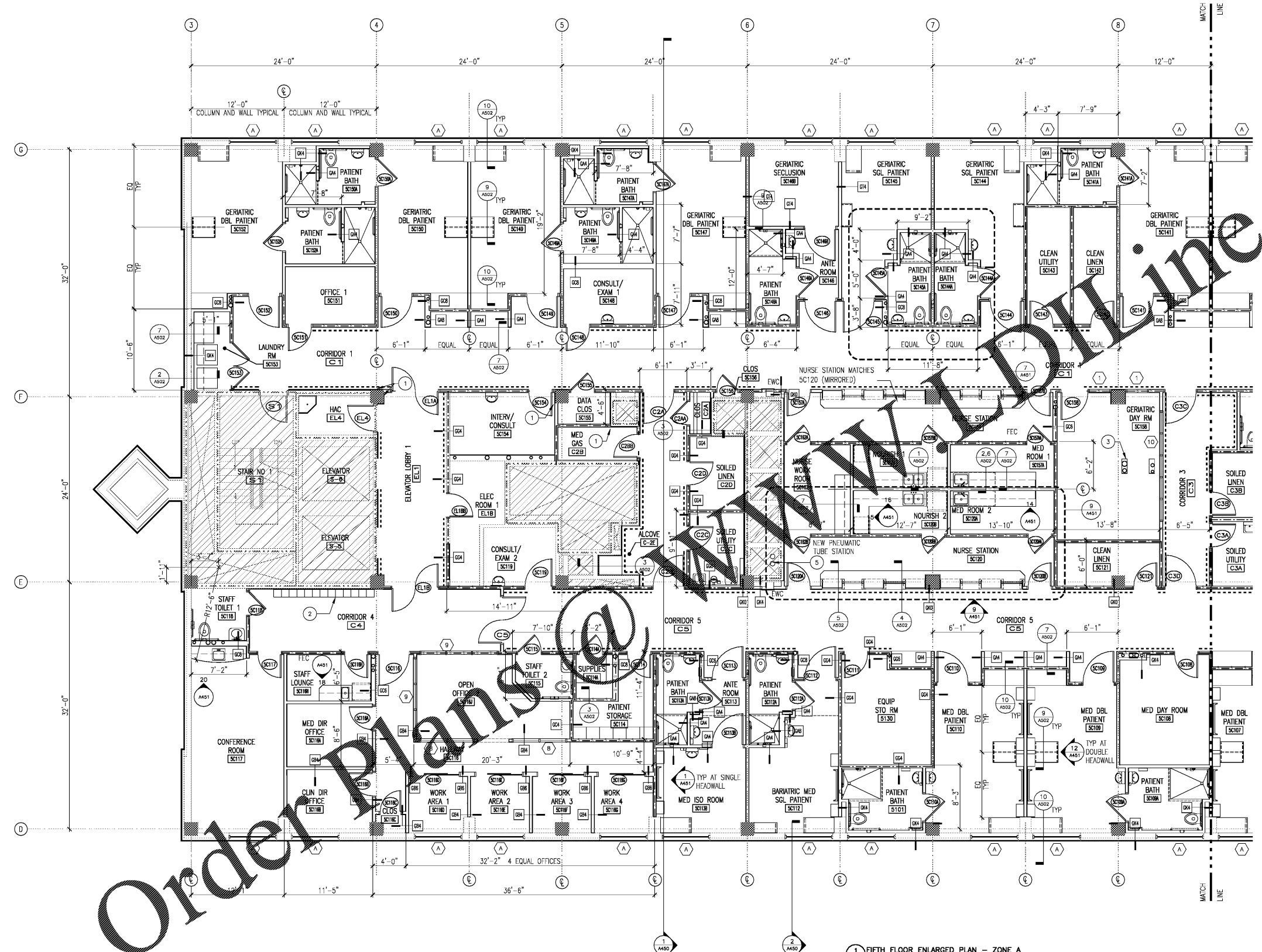

- ### 5TH FLOOR PLAN LEGEND
- S — SMOKE PARTITION (SMOKE-TIGHT)
 - 1HR FIRE BARRIERS
 - 2HR FIRE-SMOKE BARRIERS
 - EXISTING 2 HR FIRE BARRIERS
 - EXTENTS OF HANDRAILS/CRASHRAILS. SEE DETAIL 3/A503
 - MATCH LINE
 - # WINDOW - SEE A501
 - NOT IN CONTRACT AREAS (NIC) EXCEPT AS REQUIRED FOR UTILITY ACCESS. REPAIR TO MATCH EXISTING.

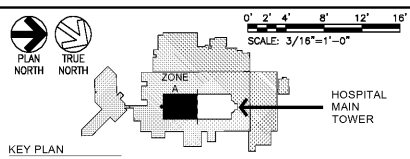

1 FIFTH FLOOR ENLARGED PLAN - ZONE A
A401 3/16" = 1'-0"

Revisions:	CONSULTANT	ARCHITECT/ENGINEER OF RECORD	STAMP	Drawing Title	Phase	Project Title	Project Number
	Date:	TOLAND MIZELL MOLNAR 590 MEANS STREET NW STE. 200 ATLANTA, GA 30316		FIFTH FLOOR ENLARGED PLAN - ZONE A	FINAL SUBMITTAL	RENOVATE GERIATRIC-MED-PSYCH INPATIENT 5TH FLOOR	508-17-101
				Approved: Project Director	FULLY SPRINKLERED	Location Atlanta VA Medical Center - Atlanta, Ga.	Building Number Bldg C: Main Tower
						Issue Date 06-07-2019	Drawing Number A401
						Checked AJT	
						Drawn DB/MCC	