

- WORK IN RIGHT-OF-WAY NOTES**
- All traffic control devices shall be accordance with Part 6 of Manual on Uniform Traffic Control Devices (MUTCD) 2009 edition.
 - All work in right-of-way shall comply with ALDOT specifications and requirements.
 - Contact DISTRICT ADMINISTRATOR 48 hours prior to beginning work on ALDOT right-of-way.
NAME: CHUCK CORDELL
 - Write a letter requesting to meet with District Permit Engineer upon completion of permitted work to evaluate punch list for completion of project.
 - Onsite Representative:
Name PAUL RONDEAU Phone # 813-298-2620
 - Onsite Representative will have on hand, at all times:
 - Approved permit and plans stamped by the Division Engineer,
 - Traffic Control Plan
 - Erosion Control Plan
 - All work in the right-of-way will shall meet or exceed ALDOT specifications.
 - All disturbed areas will be re-sodded or seeded as directed by the department of Transportation's District Administrator.
 - All traffic control markings and striping within right-of-way must be Class 2 Type A Thermoplastic.
 - Contractor must provide test reports for all materials used in construction of work described in this permit, as per ALDOT Standard Specifications for Highway Construction.
 -

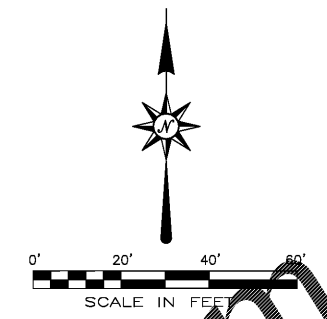
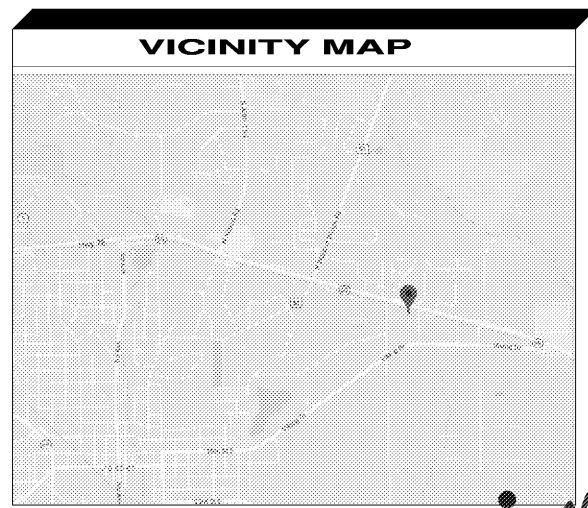

- KEY NOTE LEGEND**
- (A) 6" DEPTH ASPHALT PAVING REQUIRED. SEE DETAIL
 - (B) 2' WIDE STOP BAR REQUIRED - PER ALDOT SPEC DRAWING TCM-704
 - (C) TAPER BACK OF CURB FROM 6" TO 0" IN 6 FEET
 - (D) R-1 STOP SIGN REQUIRED.

APPLICANT:
HUDDLE HOUSE, INC
MR. PAUL RONDEAU
5901-B PEACHTREE DUNWOODY RD. NE #450
SANDY SPRINGS GA, 30328

PROJECT DESCRIPTION: REMOVAL OF EXISTING SERVICE DRIVE AND REPLACEMENT WITH NEW COMMERCIAL TURN-OUT INCLUDING ASPHALT PAVING AND STRIPING.

**POSTED SPEED LIMIT 45MPH
MILE POST 170.10**

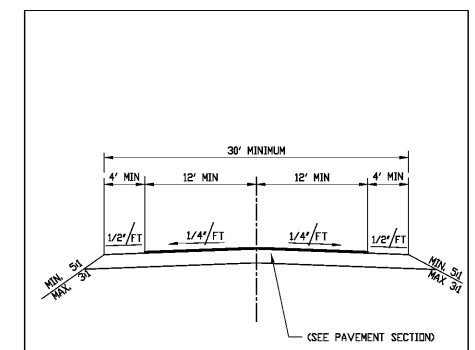

TYPICAL ROADWAY SECTION N.T.S.

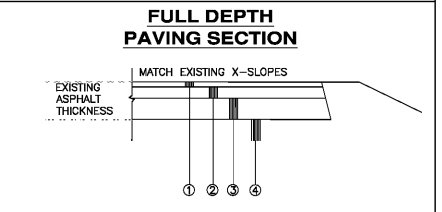

- STATE OF ALABAMA DEPARTMENT OF TRANSPORTATION
STANDARD SPECIFICATIONS FOR HIGHWAY CONSTRUCTION - LATEST EDITION
- ALDOT PAVEMENT**
- SUPERPAVE BITUMINOUS CONCRETE WEARING SURFACE LAYER, 1/2" MAX. AGGREGATE SIZE MIX, ESAL RANGE C/D, APPROXIMATELY 185 LBS/SY. ITEM: 424-A
 - SUPERPAVE BITUMINOUS CONCRETE BINDER LAYER, 1" MAX. AGGREGATE SIZE MIX, ESAL RANGE C/D. APPROXIMATELY 330 LBS/SY. ITEM: 424-B
 - SUPERPAVE ASPHALT BASE LAYER, 1" MAX. AGGREGATE SIZE MIX, ESAL RANGE C/D. APPROXIMATELY 660 LBS/SY. ITEM: 424-C
 - COMPACT SUBGRADE TO 100% PER AASHTO-99

AL.D.O.T. R.O.W. NOTES

- ALL WORK ON THE ALDOT ROW SHALL BE IN CONFORMANCE WITH THE LATEST EDITION OF ALDOT SPECIFICATIONS.
- ALL TRAFFIC CONTROL SHALL BE IN COMPLIANCE WITH THE LATEST EDITION OF THE MUTCD. SEE TRAFFIC CONTROL PLANS FOR DETAILS.
- ALL STRIPING ON ALDOT R.O.W. SHALL BE THERMOPLASTIC.
- ALL DISTURBED AREAS ON ALDOT R.O.W. NOT TO RECEIVE PAVING SHALL BE STABILIZED WITH SOLID SOD.

ANY UTILITY WORK PERFORMED ON ALDOT R.O.W. WILL REQUIRE A SEPERATE PERMIT(S) FROM THE UTILITY PERFORMING WORK

NOTE: ACCESS FOR FUTURE DEVELOPMENT OF DIVIDED PROPERTIES SHALL BE VIA PRIVATE PROPERTY AND NOT FROM THE ALDOT RIGHT OF WAY

NOTE: ALL STRIPING AND MARKINGS SHALL BE 5" WIDE CLASS 2 TYPE A THERMOPLASTIC AND PER THE LATEST EDITION OF THE MUTCD.

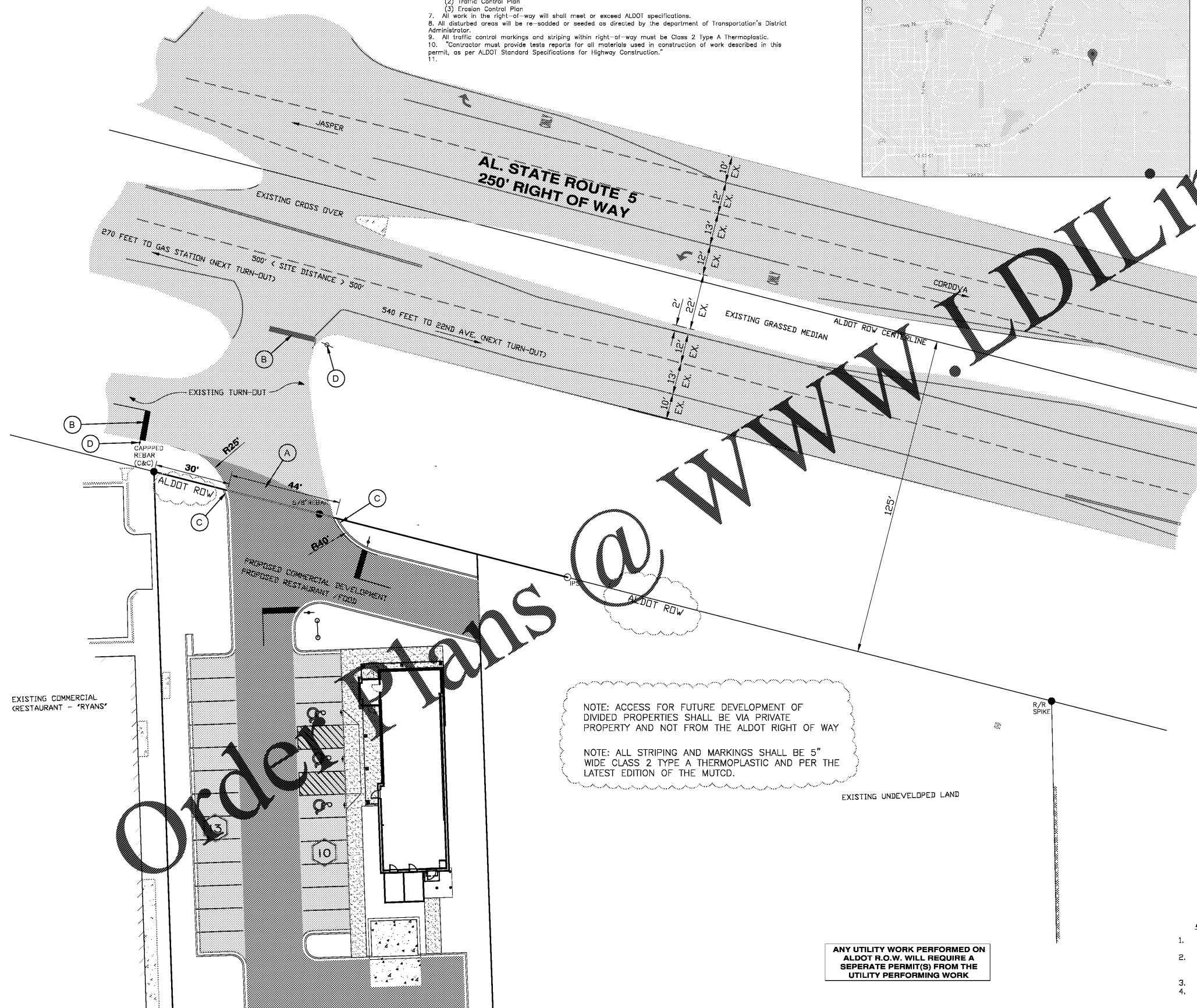

NO.	REVISIONS DESCRIPTION	DATE

QUARTER-SECTION
NORTHWEST QUARTER

TOWNSHIP 14 SOUTH
RANGE 7 WEST

SECTION 11

ALDOT LAYOUT PLAN

HUDDLE HOUSE
U.S. HWY 76, JASPER, AL

HUDDLE HOUSE
FOR SANDY SPRINGS, GEORGIA

DWN. BY: []
TT: []
CHK. BY: []
DAR: []
CREW CHIEF: []

FIELD BOOK/PAGE: []
DWG. NAME: []
COORDINATE FILE: []

LAST FIELD SURVEY DATE: 1/8/18
SCALE: 1" = 20'

GONZALEZ - STRENGTH & ASSOCIATES, INC.
CIVIL ENGINEERING, LAND SURVEYING, PLANNING, TRAFFIC & TRANSPORTATION

2176 PARKWAY LAKE DRIVE
PHOENIX, AZ 85024
PHONE: (602) 942-2466
FAX: (602) 942-3033
www.Gonzalez-Strength.com

© Copyright 2006

FOR PLAN REVIEW ONLY
NOT FOR CONSTRUCTION

JUNE 14 2019

DWG. NO. H2 - RO
PROJECT 19-0256