

- KEY NOTE LEGEND**
- (A) SAWCUT AND REMOVE EXISTING ASPHALT PAVING. ROAD TO BE REMOVED BY THE CITY OF JASPER.
 - (B) EXISTING WATER LINE TO REMAIN
 - (C) EXISTING GAS LINE TO REMAIN.
 - (D) EXISTING ASPHALT TO REMAIN
 - (E) EXISTING SANITARY SEWER TO REMAIN
 - (F) EXISTING STORM PIPE AND INLETS TO REMAIN.
 - (G) EXISTING POWER SERVICE POLE TO REMAIN.
 - (H) REMOVE EXISTING STORM PIPE
 - (I) SILT FENCE REQUIRED. SEE DETAIL.
 - (J) TYPE III BARRICADE WITH ROAD CLOSED SIGN REQUIRED. INSTALL BARRICADE AT EACH END OF THE SERVICE ROAD TO BE REMOVED. INSTALL SIGNAGE PRIOR TO BEGINNING ANY WORK.

- NOTES:**
1. All existing improvements shall be demolished inside the limits of demolition limits unless specified otherwise.
 2. All existing utilities shall remain UNLESS SHOWN TO BE REMOVED.
 3. Contractor shall safeguard all existing utilities within adjacent right-of-way and constructing limits.
 4. All demolition of existing improvements shall be hauled off and disposed of in a legal manner.
 5. Burning of debris on site is not permitted.
 6. Contractor shall have all utilities located on and adjacent to the site prior to beginning work. All utilities shown are approximate.
 7. Demolished pavement shall be hauled off and disposed of in a legal manner.
 8. Contractor shall sawcut existing paving along construction limits. Contractor shall replace paving in like kind assuring smooth transition and positive drainage.
 9. **Excavations.** All excavations shall be made and kept in compliance with the requirements of the U.S. Department of Labor Occupational Safety and Health Administration (OSHA) as defined in 29 CFR Part 1926 and other appropriate standards and regulations. These regulations require that excavations greater than 5 feet in depth be sloped, benched, sheeted or braced to protect employees working in the excavation against the risk of cave-ins. The contractor shall protect existing structures and improvements from start to finish of excavation.
 10. Excavation safety and proper adherence to Federal, state and local regulations is the responsibility of the excavation contractor. It is the responsibility of the contractor to develop the excavation plan and safety requirements for all excavations associated with this project using the soil conditions at the time of construction to determine the appropriate soil type and protection requirements.
 11. No work shall be permitted beyond the construction limits.
 12. Contractor shall repair any items damaged shown to remain after construction or as a result of construction related activities.
 13. Silt fence shall be installed prior to beginning any work within the state right of way. Silt fence shall be maintained until the project has been fully completed and a healthy stand of grass has been established.
 14. **WARNING:** Do not disturb survey markers located on A.L.D.O.T. Right of way. Any property markers disturbed during construction shall be re-established by an Alabama licensed professional land surveyor at the contractors expense.

- A.L.D.O.T. DEMOLITION NOTES**
1. PRIOR TO BEGINNING ANY WORK WITHIN THE RIGHT OF WAY, ALL EROSION CONTROL DEVICES SHALL BE INSTALLED AND INSPECTED BY THE ENGINEER OF RECORD.
 2. ALL TRAFFIC CONTROL SHALL BE IN COMPLIANCE WITH THE LATEST EDITION OF THE MUTCD. SEE TRAFFIC CONTROL PLANS FOR DETAILS.
 3. PRIOR TO BEGINNING ANY WORK WITHIN THE RIGHT OF WAY THE CONTRACTOR SHALL PROVIDE 72 HOUR NOTICE TO A.L.D.O.T. AND SCHEDULE A PRE CONSTRUCTION MEETING TO COORDINATE THE WORK.
 4. ALL DISTURBED AREAS ON A.L.D.O.T. R.O.W. NOT TO RECEIVE PAVING SHALL BE STABILIZED WITH SOLID SOD.

NO.	REVISIONS DESCRIPTION	DATE

ALDOT DEMOLITION PLAN
HUDDLE HOUSE
 U.S. HWY 78, JASPER, AL
 FOR
HUDDLE HOUSE
 SANDY SPRINGS, GEORGIA
 SCALE 1" = 20'
 DWN BY TT
 CHK BY TB
 FIELD BOOKPAGE
 CREW CHIEF TB
 LAST FIELD SURVEY DATE 1/8/18
 COORDINATE FILE

GONZALEZ - STRENGTH & ASSOCIATES, INC.
 CIVIL ENGINEERING, LAND SURVEYING, PLANNING, TRAFFIC & TRANSPORTATION
 2176 PARKWAY LAKE DRIVE
 HOOVER, ALABAMA 35244
 PHONE: (205) 942-2486
 FAX: (205) 942-3033
 www.Gonzalez-Strength.com
 © Copyright 2006

FOR PLAN REVIEW ONLY
 NOT FOR CONSTRUCTION
 JUNE 14 2019

DWG. NO.
H1 - R0
 PROJECT
19-0256

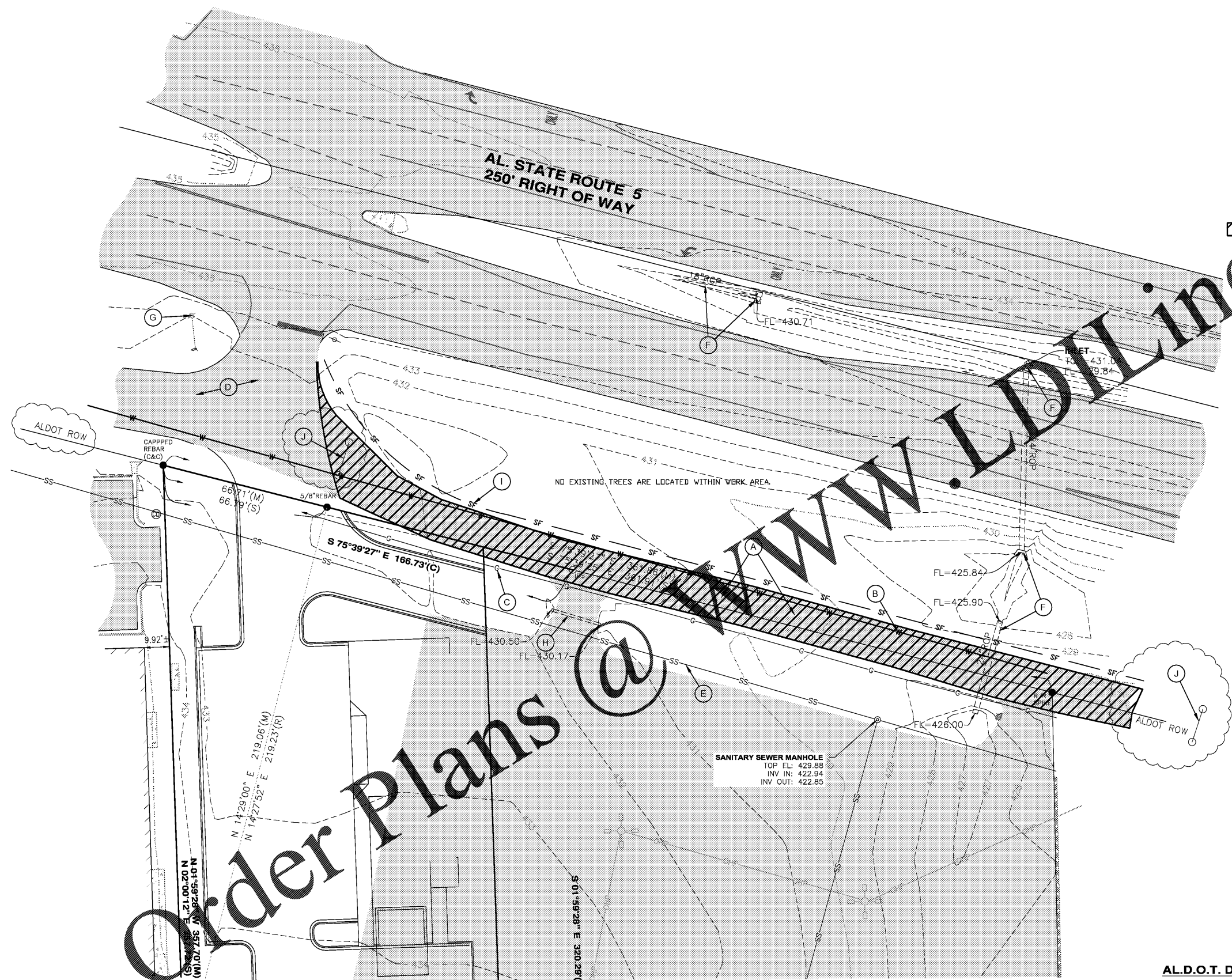

Know what's below
 Call before you dig.
 Dial 811
 Or Call 800-282-7411