

JOB NO. LI907

NORWOOD ARCHITECTS  
807 FOREST NW  
ATLANTA, GEORGIA 30318  
PH. 678-921-0302 FAX. 678-921-0301 WWW.NORWOODARCHITECTS.COM

HUDDLE HOUSE  
EVO 2000 RESTAURANT  
2029 HWY 78 E JASPER, AL  
WALKER CO. 35501

NO. ISSUE DATE  
PERMIT SET  
07/12/2019

DRAWING NUMBER

A101

KEY NOTES

- EXTERIOR DOOR TRANSITION; RE: HARDWARE SCHEDULE, SHT. A600
- 1/8" CLEAR ANODIZED ALUM. DIVIDER STRIP
- PRE-FABRICATED MOP SINK LOCATION; PROVIDE CONTINUOUS WATER PROOF SEALANT AT EDGES
- PROVIDE CONT. WATERPROOF MEMBRANE (LATICRETE HYDRO BAN DS 663.0-0509) BELOW FLOOR FINISH 4'-0" FROM ADJACENT WALL AS SHOWN HATCHED; RUN MEMBRANE UP WALL ABOVE DURCOCK & BELOW FRP/STAINLESS STEEL WALL FINISH TO 1'-6" A.F.F.
- TILE INTERIOR RESTROOM WALLS; RE: RESTROOM ELEVATIONS, SHT. A462
- START OF DINING TILE LAYOUT
- START OF KITCHEN TILE LAYOUT
- LEVEL 5 GYP. BD. FINISH ON WALLS ABOVE WAINSCOT PRIOR TO APPLYING WALL GRAPHIC
- NON-SLIP BROOM FINISH CONC. CURB & SIDEWALK W/ JOINTS; SLOPE 1/4" AWAY FROM BLDG. SEE CALL FOR FINAL DIMENSIONS & ADA COMPLIANT DESIGN
- LANDSCAPING PER CIVIL DRAWINGS
- NOT USED
- INSULATED COOLER/FREEZER FLOOR; EQUIPMENT VENDOR.
- NOT USED

GENERAL NOTES

- NOT USED.
- SEE SCHEDULE FOR FINISHES.
- SEE SCHEDULE FOR EQUIPMENT, EQUIPMENT LOCATIONS AND SCHEDULE.
- REFER TO INTERIOR ELEVATIONS FOR ADDITIONAL WALL INFORMATION.

INTERIOR FINISH LEGEND

SEE SHEET A003 FOR SCHEDULE

LEGEND

	TILE & GROUT FINISH (SEE INTERIOR FINISH SCHEDULE)		CONCRETE SIDEWALK (BROOM FINISH)
	TILE & GROUT FINISH (SEE INTERIOR FINISH SCHEDULE)		WATERPROOF MEMBRANE

FINISH FLOOR PLAN

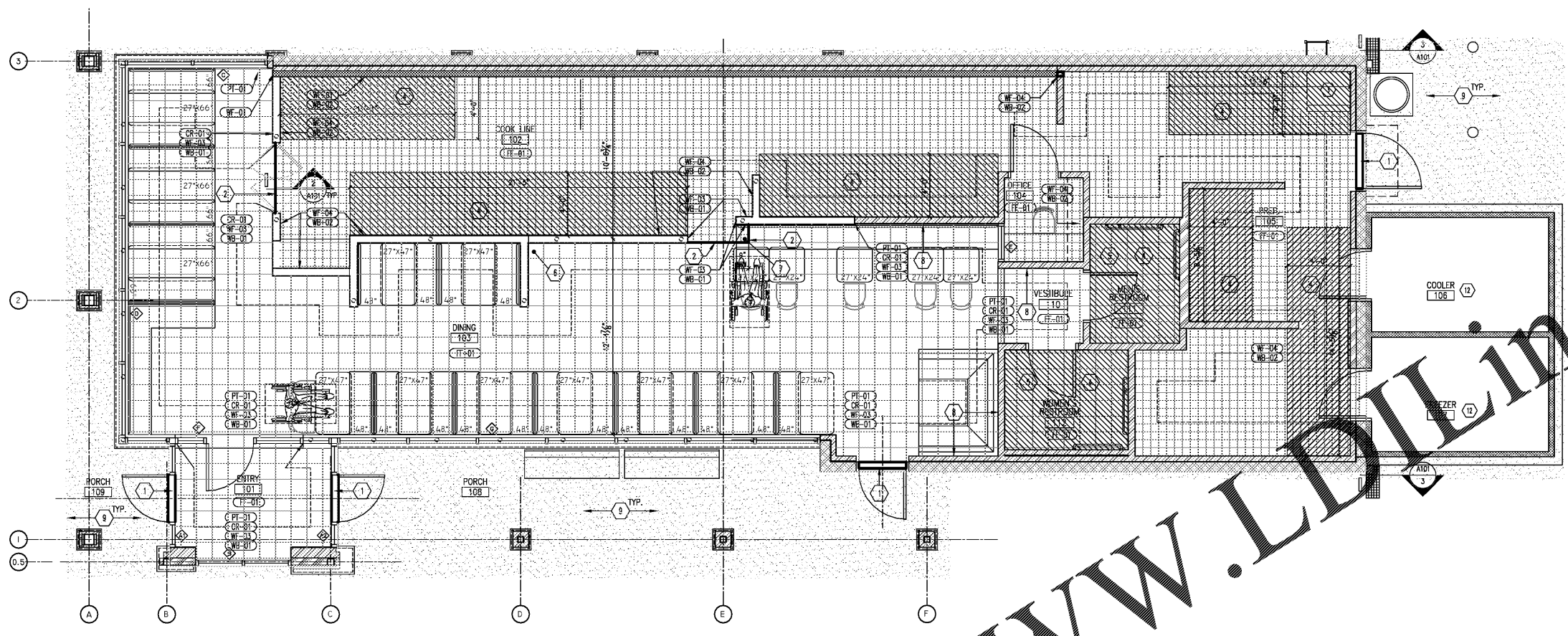

1 FINISH FLOOR PLAN

SCALE: 1/4"=1'-0"

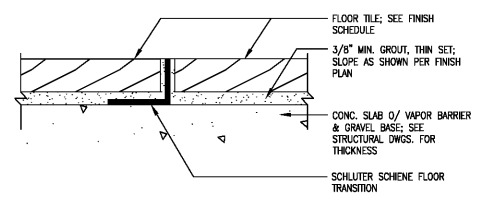

2 DETAIL @ TILE JOINT

SCALE: 1:4

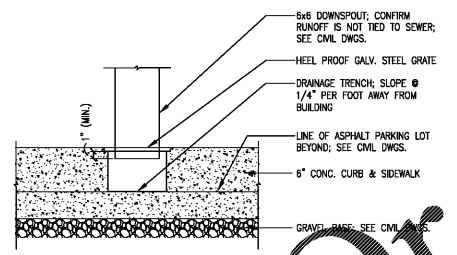

3 SIDEWALK GRATE (WHEN APPLICABLE)

SCALE: 1:4

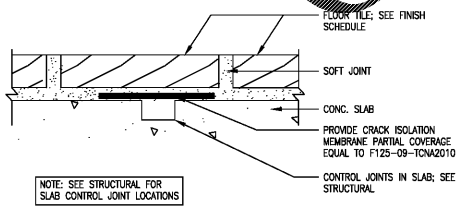

4 DETAIL @ SLAB CONTROL JOINT

SCALE: 1:4

Order Plans @ WWW.LDLINE.COM