

2 SOFFIT DETAIL @ SERVING COUNTER
A3.1 SCALE: 1-1/2" = 1'-0"

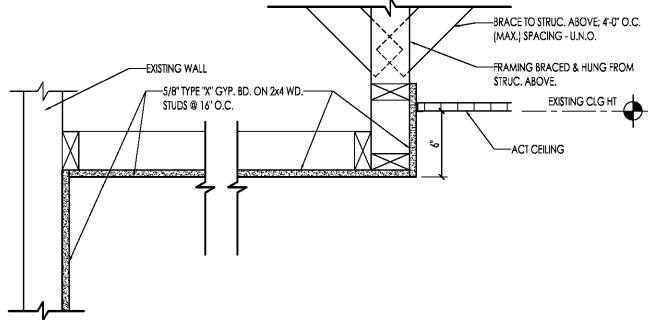

1 SOFFIT DETAIL
A3.1 SCALE: 1-1/2" = 1'-0"

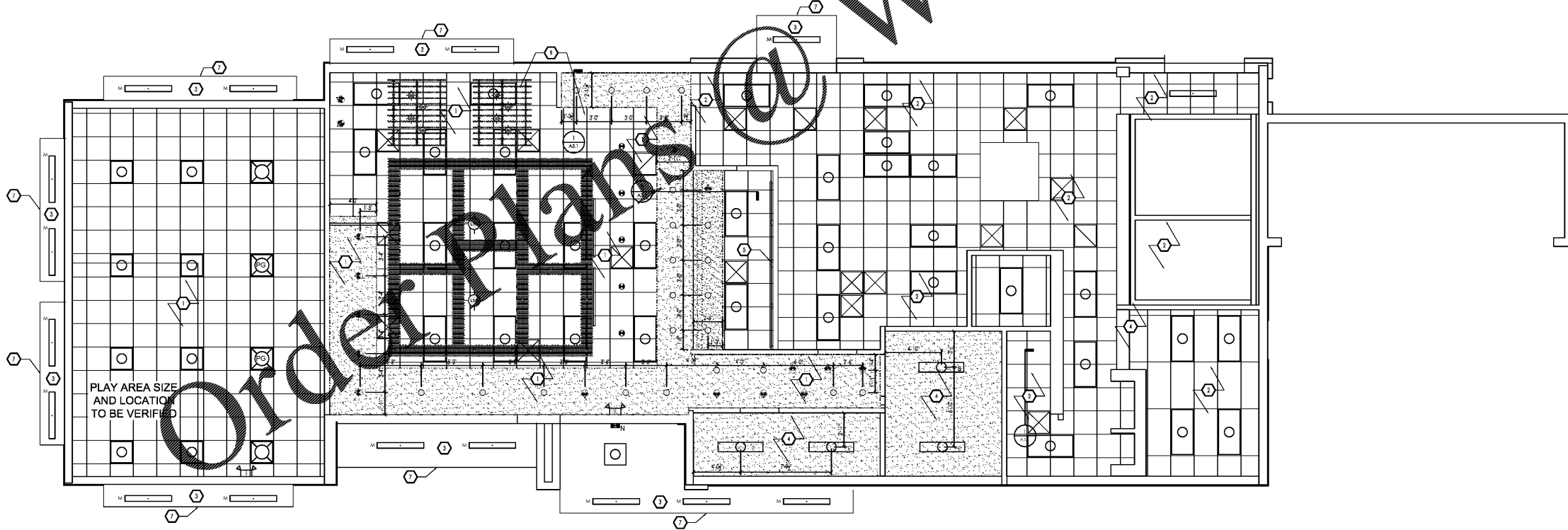

1 REFLECTED CEILING PLAN
A3.1 SCALE: 1/4" = 1'-0"

RCP GENERAL NOTES:

- ALL DIMENSIONS SHOWN ON REFLECTED CEILING PLAN ARE FROM FACE OF WALL FINISH UNLESS NOTED OTHERWISE.
- INDICATED HEIGHTS ON PLAN ARE FROM ABOVE FINISH FLOOR (A.F.F.).
- G.C. TO REPLACE ALL EXISTING LIGHTING AS NOTED WITH FIXTURES FROM ENERGYWISE. CONTACT: JENNIFER WADDICK - 225-276-0021 - JENNIFER@ENERGYWISEMAIL.COM. COORDINATE FINAL FIXTURE LOCATION AND TYPE WITH OWNER AND LIGHTING VENDOR PRIOR TO INSTALL.
- GC TO COORD. LIGHTING W/ INTERIOR DECOR (ID) DRAWINGS.
- CONTRACTOR SHALL VERIFY FIXTURE QUANTITIES AND MAKE PROPER ADJUSTMENTS FOR ANY CHANGES IN PLAN DUE TO ADDITIONAL REQUIREMENTS, LOCAL CODES, ETC.
- ALL FIXTURES SHALL BE LOCATED IN CENTER OF CEILING TILES UNLESS OTHERWISE NOTED. FIXTURES SHALL BE RE-PLACED APPROX. @ LOCATIONS OF EXIST. LIGHTS EXCEPT WHERE REPLACED / DISPLACED BY NEW CEILING ELEMENTS.
- CONTRACTOR TO REMOVE AND RE-INSTALL ALL EXIST. CEILING EQUIPMENT AND LIGHTING NOT SHOWN (EXIT SIGNS, SPEAKERS, ETC.) AS REQ'D. REPAIR AND REPLACE FOR "LIKE NEW" FINISHES AND AS FULLY WORKING.
- G.C. TO PROVIDE ALL ELECTRICAL ENGINEERING DESIGN-BUILD AND TO VERIFY ALL LOADS AND CIRCUITS.
- G.C. TO COORD. ANY ADDED OUTLETS WITH THESE PLANS AND DECOR VENDOR.
- CONTRACTOR TO REMOVE CEILING SOFFIT, GRID, & ECT. IN THE KITCHEN & EMPLOYEE AREAS. PREP AREA FOR NEW CEILING.

RCP KEYNOTES:

- REMOVE & REPLACE ALL EXISTING CEILING TILES @ 2'X4' ACOUSTICAL CEILING TILES & GRID. -SEE INTERIOR DECOR DRAWINGS.
- REMOVE & REPLACE ALL EXISTING CEILING TILES @ GRID @ KITCHEN / BACK OF HOUSE W/ 1/2" VINYL-COAATED 2'X4' ACOUSTICAL CEILING TILES & GRID. CLEAN AND REPAINT HVAC SUPPLY RETURN GRILLS. REMOVE AND REPLACE ALL EXIST. FIXTURES. - SEE A3.1
- NEW GYP. CEILING @ KITCHEN SERVICE EQUIPMENT - SEE INTERIOR DECOR DRAWINGS.
- REMOVE AND REPLACE ALL CEILING @ RESTROOMS AND PAINT CEILING WHITE. GYP. @ EX. FRAMING @ 16" O.C. PROVIDE NEW DIFFUSERS & NEW LIGHTING.
- NEW 1" BULB HEAD - PAINT AS SPECIFIED AT ID DRAWINGS. PROVIDE STAINLESS STEEL ISOLATION CAP AT BASE OF BULKHEAD AND AT WALL-ENDS INTERSECTION BULB HEAD.
- PROVIDE POWER AND CABLE CONNECTION FOR NEW TV. LOCATION NEW ART CANOPY - SEE DRAWINGS @ A8.3 - G.C. TO PROVIDE LIGHTING @ ART CANOPY.
- NEW INTERIOR DECOR CEILING TRAY - SEE INTERIOR DECOR DRAWINGS.
- NEW GYP. CEILING @ DINING PERIMETER EDGE. -SEE INTERIOR DECOR DRAWINGS.

RCP LEGEND:

M	TYPE M - ENERGYWISE - WET LISTED 4' LED CANOPY FIXTURE
L	TYPE L - ENERGYWISE - SURFACE MOUNT EXT. WALL SCENCE - COLOR TO MATCH ALUM. STOREFRONT FRAMES
N	TYPE N - ENERGYWISE - LED WALL PAK
SC-1L	TYPE SC-1L - WALL SCENCE - COORD. W/ DECOR VENDOR
D	TYPE D - ENERGYWISE LED RECESSED DOWNLIGHT FIXTURE - COORD. W/ DECOR AND OWNER
P4	TYPE P4 - ENERGYWISE LED A19 BULB (IN PENDANT FIXTURE AS SPECIFIED BY DECOR VENDOR) - COORD. W/ DECOR VENDOR.
B-1L	TYPE B - SCENCE LIGHTS - BESA LIGHT "TAMBURO" GARNET 704241-SN-LMPF-001-1-24 LAMP(S) NOTE: COORDINATE LOCATION AND QUANTITY WITH DECOR SUPPLIER. 4'-4" A.F.F. TO BOTTOM OF LIGHT.
B-2L	TYPE B - CEILING MOUNTED PENDANT LIGHT - BESA LIGHTING - LJT-14-001-GU24-SN-BK-LL
T1	TYPE T1 - ENERGYWISE RECESSED MOUNT EXT. SOFFIT LIGHT - USE EXIST. SOFFIT CIRCUIT; VERIFY LOAD AND ELEC. WALL WASHER TO ILLUMINATE ART BY G.C.
J	TYPE J - GOOSE NECK EXT. FIXTURE - STONCO - X1AFB132K1YFB01E - XPRESSIVES SERIES 4' LINEAR FLUOR. MARKED FOR WET LOCATION; ARM STYLE SL4 W/ AC33XX CABLE SUPPORT - USE EXIST. SOFFIT CIRCUIT; VERIFY LOAD AND ELEC.
EM	EMERGENCY LIGHTING
N	EXTERIOR EMERGENCY LIGHT - DAMP RATED LED LIGHT WIRED TO SAME-CIRCUIT AS INTERIOR & PROVIDED W/ INTERNAL BATTERY BACKUP. NEW ELECTRICAL OUTLET PROVIDE PER INTERIORS PLAN.
A	TYPE A - NAUTICAL BK304 & SP305-18-60D-927-03
B	TYPE B - NAUTICAL BK305 & LED 8W EDISON INCANDESCENT
B1	TYPE B1 - NAUTICAL BK305 & LED 8W EDISON INCANDESCENT
C6W	TYPE C6W - CREE LR6-10L-30K-120V-A-DR-RC6-12W-GU24 SECURITY SLDBKQL-18ALED30KW-H -LS LCD6 13 LED 30 48 UIE TRARL HAZ WH -JUNO SP34505-930-4-WWH -VAOPTO VO-DL-6WV20-85E26-110-WHITE -ENERGYWISE EWRR6130W-L7
C6W	TYPE C6W - CREE LE6C-GU24W-RR6-GU24 -LS PDL6KADJ-LED-07-30-120-PDL6KADJHSGNC -JUNO SP34506-27-6-WWH -ENERGYWISE EWRR6130W
E	TYPE E - JUNO R600L3KNBZ
F	TYPE F - HERMITAGE PRI-88D35A1-6SSW06
G	TYPE G - JUNO SP343788-9-F1SSN -ZANIBONI DZLUNA20930A3CSNP0BKOP
G1	TYPE G1 - JUNO SP34378A-930-F1SN -ZANIBONI DZLUNA20930A3CSNP0BKOD
G	TYPE G - ENERGYWISE 2' X 4' LED LIGHT FIXTURE
E	TYPE E - ENERGYWISE - 1' X 4' LED LIGHT FIXTURE
G3	TYPE G3 - ENERGYWISE 2' X 2' LED LIGHT FIXTURE
G4	TYPE G4 - ENERGYWISE 2' X 4' LED LIGHT FIXTURE (4000K)
TV	LOCATION OF EXISTING AND NEW TV'S - G.C. PROVIDE CABLE AND POWER AS REQUIRED. COORD. W/ DECOR AND OWNER
2'X2'	2'X2' SUSPENDED ACOUSTICAL CEILING TILE AND GRID
2'X2'	2'X2' SUSPENDED VINYL COATED ACOUSTICAL CEILING TILE AND GRID; PAINT TO MATCH EXIST. GRID.
2'X4'	VINYL-COAATED 2'X4' ACOUSTICAL CEILING TILE AND GRID
SOFFIT	GYP. SOFFIT BOARD CEILING

NO.	DATE	BY	CHKD.	DATE
1	06.17.19			

CHECKED BY: ENH
BY: ENH
SD / PERMIT SET



PREMIER KINGS, INC.
5529 CARMICHAEL RD
MONTGOMERY, AL 36117
PHONE: (334) 312-0849

2126 Morris Avenue
Montgomery, AL 36103
Phone: (205) 322-1251
Fax: (205) 322-1778
email: info@hukstein.com
www.hukstein.com

hukstein architects, PC
architecture • planning • interior design



PROJECT #1702/09
IMAGE 20/20 - DECEMBER 2016 STANDARDS
Burger King - RENOVATION
13049 MAIN ST. N.
JACKSONVILLE, FL 32218
07.17.19
REFLECTED CEILING PLAN