

DAVIDSON PLACE
(PRIVATE STREET)
40' INGRESS-EGRESS ESM'T D.B. 1850 PG. 1138
6.150 ADT

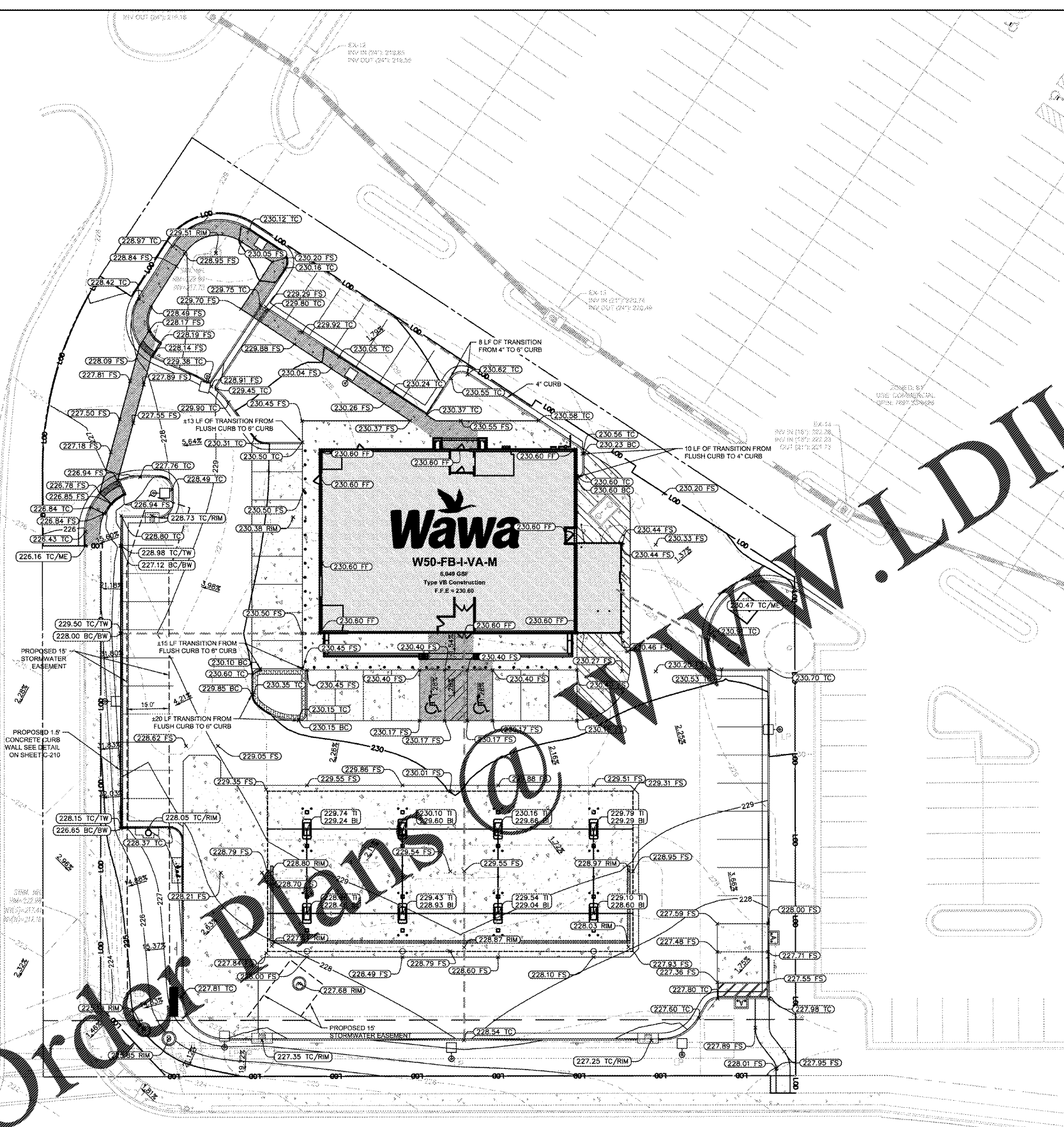

SUDLEY ROAD

(R/W VARIES)
POSTED SPEED: 45 MPH, DESIGN SPEED: 45 MPH
URBAN MINOR ARTERIAL
22,000 ADT

LEGEND

---	PROPERTY LINE/LEGAL ROW
---	PROPERTY SETBACK
---	LIMITS OF DISTURBANCE (1.46 AC)
---	EXISTING CONTOURS
---	PROPOSED CONTOURS
---	RIDGE LINE
---	PROPOSED SLOPE
---	CURB AND GUTTER CG-6
---	ADA ACCESSIBLE AREAS

SPOT ELEVATION LEGEND

TC	TOP OF CURB	BC	BOTTOM OF CURB
TW	TOP OF WALL	BW	BOTTOM OF WALL
TI	TOP OF ISLAND	BI	BOTTOM OF ISLAND
FF	FINISHED FLOOR	FS	FINISHED SLOPE
RIM	STRUCTURE RIM	ME	MATCH EXISTING

EARTHWORK QUANTITIES

CUT QUANTITY	1,250 CU
FILL QUANTITY	1,000 CU
ESTIMATED QUANTITIES NOT FOR BIDDING	

- NOTES**
- CONTRACTOR TO MATCH EXISTING GRADES AT LIMITS OF DISTURBANCE AND ENSURE POSITIVE DRAINAGE.
 - REFERENCE SHEET C-400 FOR STORM STRUCTURE INFORMATION.

- PRINCE WILLIAM COUNTY NOTES**
- AFTER THE CONSTRUCTION IS COMPLETE GEOTECHNICAL ENGINEER OF RECORD SHALL PROVIDE A WRITTEN CERTIFICATION THAT THE SLOPES HAVE BEEN CONSTRUCTED (INCLUDING BUT NOT LIMITED TO THE TYPE OF MATERIAL, DEGREE OF COMPACTION, DEPTH AND SPACING OF PILESPIERS, LOCATION, LENGTH, SPACING, STRENGTH AND TYPE OF GEO-GRID, AND GROUND COVER TO PROTECT THE SLOPE) IN ACCORDANCE WITH THE APPROVED PLANS AND SPECIFICATIONS.
 - AFTER THE CONSTRUCTION IS COMPLETE, THE PROJECT CIVIL ENGINEER OF RECORD OR LAND SURVEYOR DULY LICENSED IN THE COMMONWEALTH OF VIRGINIA SHALL PROVIDE A WRITTEN CERTIFICATION ON THE GRADIENT OF THE CONSTRUCTED SLOPE AS DIRECTED BY THE COUNTY STAFF.
 - THE STRUCTURAL DESIGN OF PROPOSED CANOPY MUST BE APPROVED AND APPROPRIATE PERMIT SHALL BE OBTAINED FROM PRINCE WILLIAM COUNTY BUILDING DIVISION PRIOR TO SITE IMPLEMENTATION.

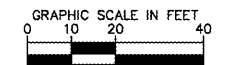
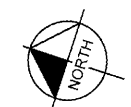

NO.	REVISIONS	DATE	BY
1	PWC COMMENTS - 1ST ROUND	09/10/2018	CAH
2	PWC COMMENTS - 2ND ROUND	11/02/2018	CAH
3	PWC COMMENTS - SIGNATURE SET	02/06/2019	CAH
4	UTILITY REVISIONS	07/25/2019	CAH

Kimley»Horn
© 2018 KIMLEY-HORN AND ASSOCIATES, INC.
11400 COMMERCE PARK DR., SUITE 400, RESTON, VA 20191
PHONE: 703-674-1300 FAX: 703-674-1350
WWW.KIMLEY-HORN.COM

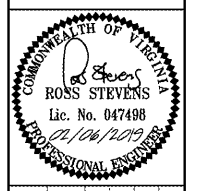

KHA PROJECT	110499001
DATE	02/06/2019
SCALE	AS SHOWN
DESIGNED BY	JLM
DRAWN BY	JLM
CHECKED BY	RSS

WAWA - SUDLEY ROAD
PREPARED FOR FRONTIER DEVELOPMENT
PRINCE WILLIAM COUNTY, VA

GRADING PLAN