

Project: E:\Horn\041818\041818_SUDLEY\041818_SUDLEY_TRANSCHEMATIC.dwg, Date: 02/06/2019, 11:14:12am, User: M...
 The information contained herein is the property of Kimley-Horn and Associates, Inc. and is confidential. It is to be used only for the project and for the purposes stated. No part of this document is to be reproduced or transmitted in any form or by any means electronic or mechanical, including photocopying, recording, or by any information storage and retrieval system, without the prior written permission of Kimley-Horn and Associates, Inc.

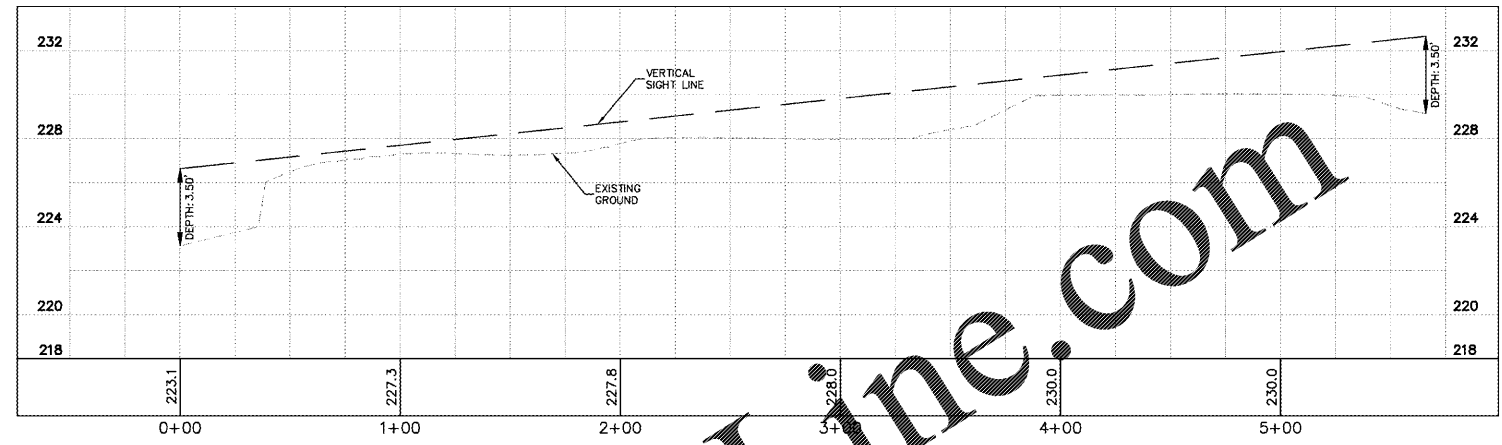

VERTICAL SIGHT DISTANCE LEFT PROFILE FOR SUDLEY ROAD
 SDL FOR 6-LANE DIVIDED MAJOR ROAD WITH DESIGN SPEED OF 45 MPH

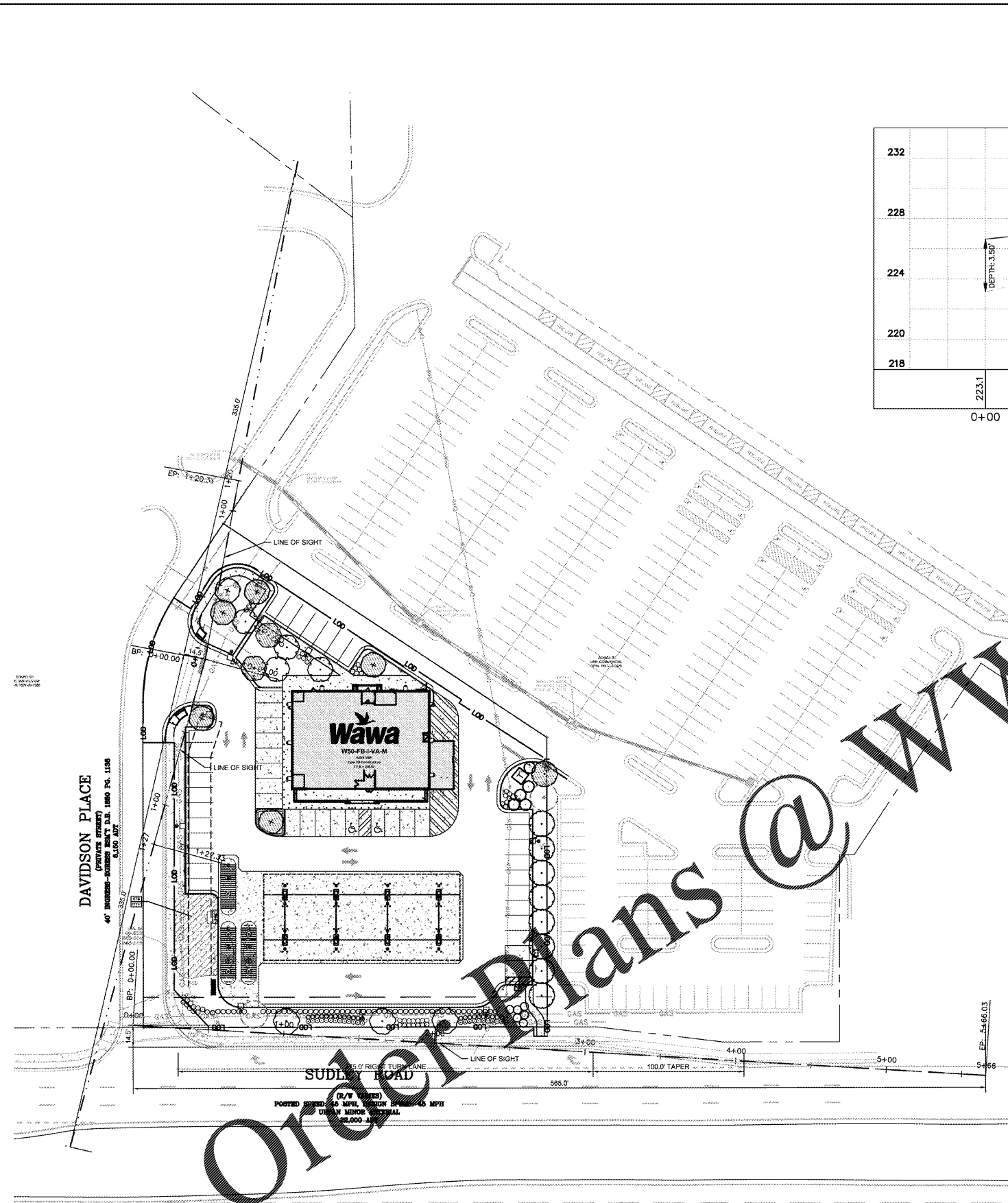
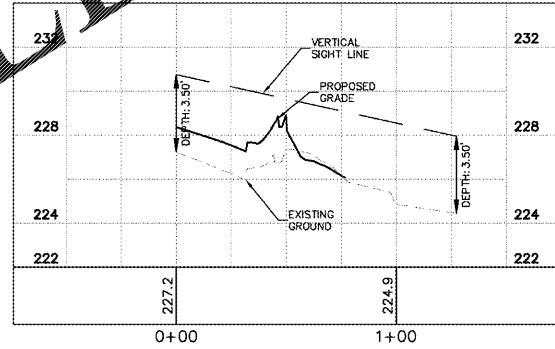

VERTICAL SIGHT DISTANCE LEFT PROFILE FOR DAVIDSON PLACE
 SDL FOR 2 LANE MAJOR ROAD, TURN FROM MINOR ROAD WITH DESIGN SPEED OF 30 MPH

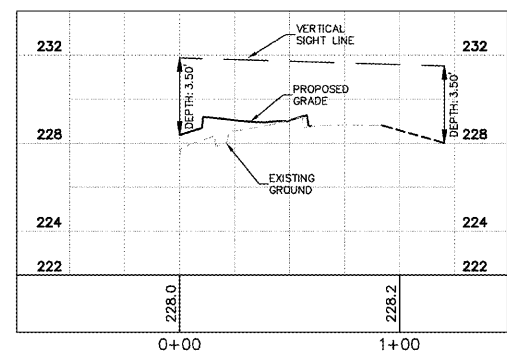

VERTICAL SIGHT DISTANCE LEFT PROFILE FOR DAVIDSON PLACE
 SDR FOR 2 LANE MAJOR ROAD, TURN FROM MINOR ROAD WITH DESIGN SPEED OF 30 MPH

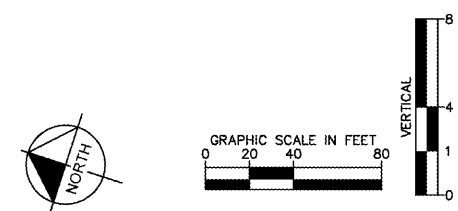

NO.	REVISIONS	DATE	BY
1	PWC COMMENTS - 1ST ROUND	09/10/2018	CAH
2	PWC COMMENTS - 2ND ROUND	11/02/2018	CAH
3	PWC COMMENTS - SIGNATURE SET	02/06/2019	CAH
4	UTILITY REVISIONS	07/25/2019	CAH

Kimley»Horn
 © 2018 KIMLEY-HORN AND ASSOCIATES, INC.
 11400 COMMERCE PARK DR., SUITE 400, RESTON, VA 20191
 PHONE: 703-674-1300 FAX: 703-674-1350
 WWW.KIMLEY-HORN.COM

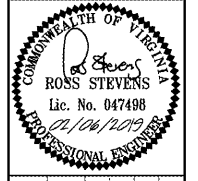

KHA PROJECT	DATE	DESIGNED BY	DRAWN BY	CHECKED BY
110499001	02/06/2019	CAH	CAH	RSS

SIGHT DISTANCE TRIANGLES

WAWA - SUDLEY ROAD
 PREPARED FOR FRONTIER DEVELOPMENT
 PRINCE WILLIAM COUNTY, VA