

CAMERA NOTES:
 1. ALL ELEVATORS IN BUILDING WILL HAVE (1) CAMERA LOCATED IN EACH CAB "NOT SHOWN ON SCHEDULE"
 2. SEE PARKING DECK FOR ADDITIONAL CAMERAS "NOT SHOWN ON SCHEDULE"

LYRIC @ NORTON COMMONS - CAMERA COUNT/BCR						25 CAMERAS
RISER/BCR	BASEMENT	FIRST FLOOR	SECOND FLOOR	THIRD FLOOR	FOURTH FLOOR	TOTAL CAMERAS
MCR	0	4	0	0	0	4
BCR 1A	4	0	0	0	0	4
BCR 2B	0	0	0	0	0	0
BCR 2C	0	0	0	0	0	0
BCR 2D	0	17	0	0	0	17
BCR 2E	0	0	0	0	0	0
BCR 2F	0	0	0	0	0	0
BCR 3A	0	0	0	0	0	0
BCR 4B	0	0	0	0	0	0
BCR 4C	0	0	0	0	0	0
BCR 4D	0	0	0	0	0	0
BCR 4E	0	0	0	0	0	0
BCR 4F	0	0	0	0	0	0
	0	0	0	0	0	25

READER NOTES:
 1. ALL ELEVATORS IN BUILDING WILL HAVE (1) READER LOCATED IN THE CAB "NOT SHOWN ON SCHEDULE"
 2. SEE MAIN BUILDING FOR ADDITIONAL READERS "NOT SHOWN ON SCHEDULE"

LYRIC @ NORTON COMMONS - READER COUNT/BCR						17 READERS
RISER/BCR	BASEMENT	FIRST FLOOR	SECOND FLOOR	THIRD FLOOR	FOURTH FLOOR	TOTAL READERS
MCR	0	5	2	2	2	11
BCR 1A	2	0	0	0	0	2
BCR 2B	0	0	0	0	0	0
BCR 2C	0	0	0	0	0	0
BCR 2D	0	4	0	0	0	4
BCR 2E	0	0	0	0	0	0
BCR 2F	0	0	0	0	0	0
BCR 3A	0	0	0	0	0	0
BCR 4B	0	0	0	0	0	0
BCR 4C	0	0	0	0	0	0
BCR 4D	0	0	0	0	0	0
BCR 4E	0	0	0	0	0	0
BCR 4F	0	0	0	0	0	0
	0	0	0	0	0	17

Order Plans @ www.lidline.com

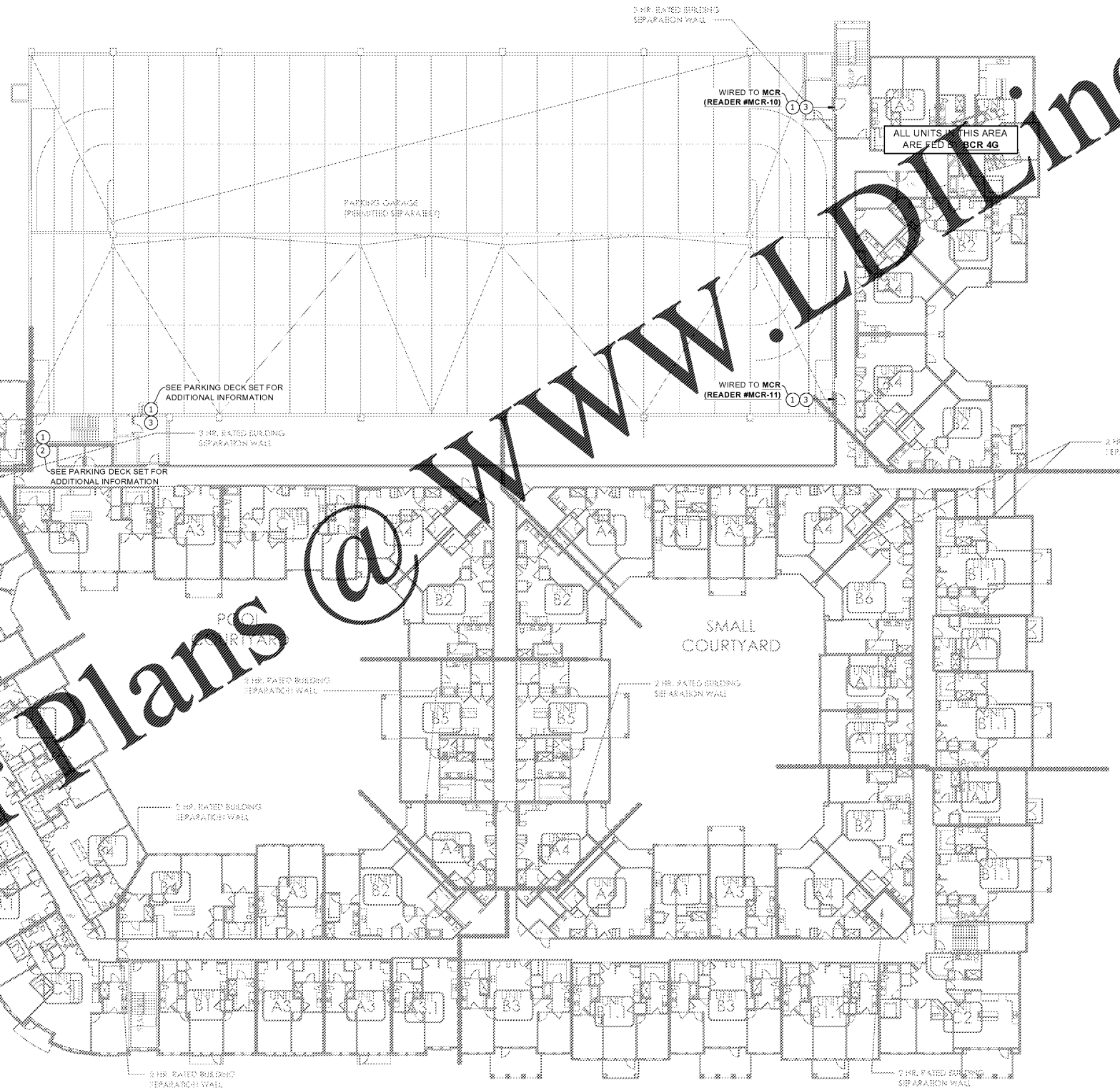

XX — CAMERA TYPE
 XX — MOUNTING TYPE

MOUNTING TYPE:
 1A - WALL MOUNTED CAMERA - MOUNT @ A MIN. 9'-0" A.F.F.
 1B - CEILING MOUNTED CAMERA
 1C - FLUSH MOUNTED CAMERA

* SEE SHEET T-208 FOR CAMERA MOUNTING TYPE DETAILS*

ACCESS CONTROL AND SURVEILLANCE VIDEO

- ① FOB READER
- ② MAGLOCK (BY OTHERS)
- ③ ELECTRIC STRIKE (BY OTHERS)
- ④ TELEPHONE ENTRY PANEL DOORING 1837
 (1) DATA CABLE TO MCR OR BCR FOR PHONE
 (1) DATA CABLE TO MCR OR BCR FOR DATA
- ⑤ NOT USED
- ⑦ INDOOR IP MEGAPIXEL CAMERA - PoE 5 MP MIN.
 (1) DATA CABLE TO MCR OR BCR AS NOTED
- ⑧ OUTDOOR IP MEGAPIXEL CAMERA - PoE 5 MP MIN.
 (1) DATA CABLE TO MCR OR BCR AS NOTED
- ⑨ ELEVATOR CAMERA FROM TRAVEL CABLE INTERFACE IN EMR TO NEAREST BCR VIA (1) 1" CONDUIT
 (2) CAT6 CABLES
 (1) RG-6 CABLE
 (1) 6 STRAND SINGLE MODE FIBER

① 04-FOURTH FLOOR PLAN ACC. CTRL. & SEC. CAMS
 SCALE 3/64" = 1'-0"

Common North, Prospect, KY
 Architect Name
 Charlton Brock & Associates, A/C000798
 Citation Brock & Associates, Inc. will retain all rights in these plans, ideas, and designs. These ideas, designs, and plans are not to be reproduced, changed or copied in any form or manner whatsoever, nor are they to be assigned to any third party, without first obtaining the express written permission from C.B.A., Inc. within dimensions that have precedence over scale dimensions.

INFINISYS
 MULTIFAMILY TECHNOLOGY
 1825 Business Park Blvd, Suite C
 Daytona Beach, FL 32114 USA
 386-235-1500
 E-Mail: caj@infm.com

NOTE: This drawing is the property of INFINISYS. All information that is not generally known shall be confidential except to the extent the information has been previously established. This drawing may not be reproduced, copied, or used as the basis for manufacture or sale without written permission. This design uses architectural CAD drawings provided by charlton brock associates for this project and are used with their permission.
 Copyright 2019 InfInSys. All rights reserved.

Lyric at Norton Commons
 Prospect, Kentucky
 Bristol Development Group
 381 MacLoy Station Rd, Suite 204
 Franklin, TN 37067

c b a
 charlton • brock
 associates
 architects • planners

1770 fennell street
 maitland florida 32751-7208
 407.660.8900 | f.407.875.9948
 www.cbarchitects.com

LOW VOLTAGE
 FOURTH FLOOR
 PLAN

date: 01-11-2019
 job no: 3789.15
 drawn by: G.UBIENSKI
 reviewed by: T.STENDER
 issue history:
 Δ Date

SCHMATIC SET
 T-204