

MOUNT CU'S PER DETAIL ON SHEET H6.11. CU'S MAY BE GROUPED AS NECESSARY TO SHORTEN REFRIGERANT LINES OR TO OPEN REFRIGERANT AND APPROVAL OF STRUCTURAL ENGINEER. TAG EACH CONDENSING UNIT WITH THE LIVING UNIT NUMBER SERVED, WITH A PERMANENT ENGRAVED TAG ON THE DISCONNECT AND THE STAND, AND FOR CONDENSING UNITS SERVING CORRIDORS AND PUBLIC SPACES TAG WITH THE PLAN MARK FROM THE SCHEDULE ON THESE PLANS.

PROVIDE UPSIZED SECTION LINES AND REFRIGERANT SPECIALTIES AS RECOMMENDED BY THE CONDENSING UNIT MANUFACTURER FOR THE LINE LENGTHS INSTALLED FOR MAXIMUM CAPACITY LOSS.

Order Plans @ www.LDILine.com

**1 PARTIAL BUILDING PLAN D - (05) ROOF - HVAC PLAN**  
 SCALE: 1/8" = 1'-0" 18025-H-BLDG

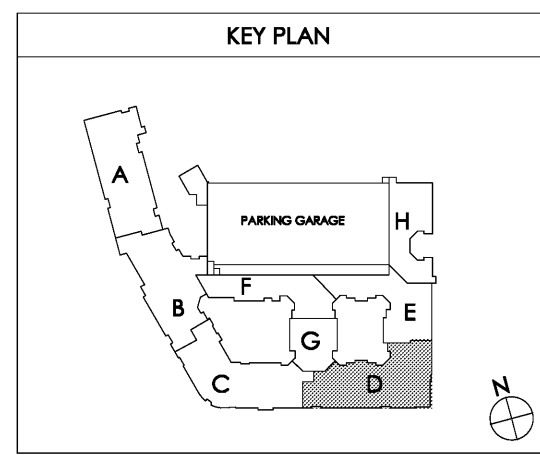

charlan brock associates, inc. hereby reserves all copyright, trademark, and other rights in these plans, ideas, and designs. These plans, ideas, and designs are not to be reproduced, changed or copied in any form or manner whatsoever, nor are they to be assigned to any third party, without first obtaining the express written permission from C.B.A., Inc. All dimensions and floor plan dimensions are in feet unless otherwise specified.