

Order Plans @ WWW.IDILine.com

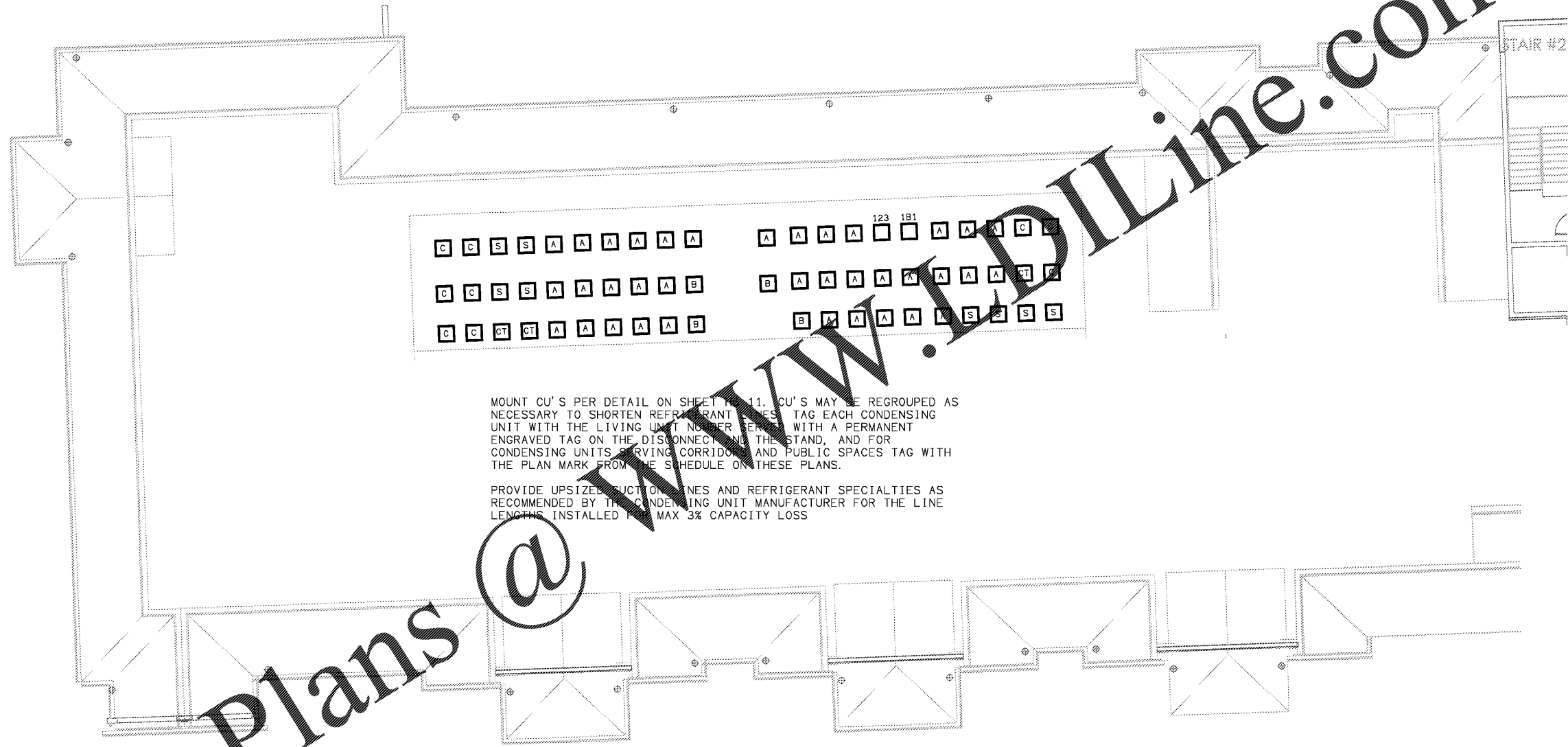

MOUNT CU'S PER DETAIL ON SHEET H-11. CU'S MAY BE REGROUPED AS NECESSARY TO SHORTEN REFRIGERANT LINES. TAG EACH CONDENSING UNIT WITH THE LIVING UNIT NUMBER. TAG WITH A PERMANENT ENGRAVED TAG ON THE DISCONNECT ON THE STAND, AND FOR CONDENSING UNITS SERVING CORRIDORS AND PUBLIC SPACES TAG WITH THE PLAN MARK FROM THE SCHEDULE ON THESE PLANS.

PROVIDE UPSIZED DUCTWORK LINES AND REFRIGERANT SPECIALTIES AS RECOMMENDED BY THE CONDENSING UNIT MANUFACTURER FOR THE LINE LENGTHS INSTALLED FOR MAX 3% CAPACITY LOSS

1 PARTIAL BUILDING PLAN A - (04) FOURTH FLOOR - HVAC PLAN  
SCALE: 1/8" = 1'-0"

18025-H-BLDG

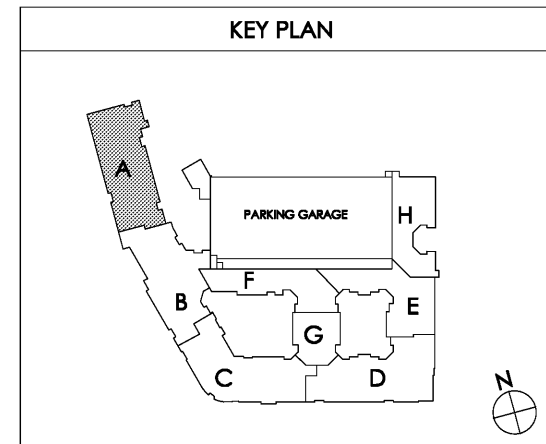

Common North, Prospect, KY



**MiGre**  
Engineers LLC

780 FLORIDA CENTRAL PARKWAY  
SUITE 224  
LONGWOOD, FL 32750  
PH: 407.336.7999  
PROJECT #: 18025

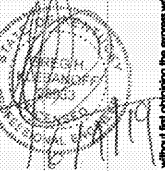

Lyric at Norton Commons  
Prospect, Kentucky

Bristol Development Group  
381 Mallory Station Rd, Suite 204  
Franklin, TN 37067

**charlan • brock**  
associates

architects • planners

1770 fennell street  
maitland florida 32751-7208  
407.660.8900 • 407.875.5948  
www.cbaarchitects.com

PARTIAL BUILDING

PLAN A - 4TH FLOOR

HVAC

PLAN

date: 06-04-2019  
job no: 3789.16  
drawn by: GNIK  
reviewed by: GNIK  
file: 18025-H-BLDG  
issue history:

H1.14A