

FIRE ZONE C

1 PARTIAL BUILDING PLAN H - (05) ROOF - FIRE PROTECTION PLAN

SCALE 1/8" = 1'-0"

18025-F-BLDG

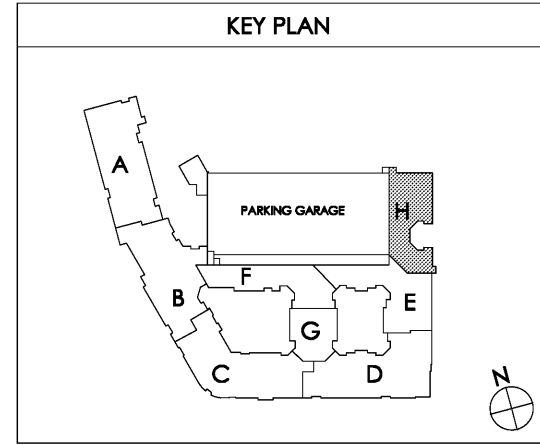

F1.15H

date: 06-04-2019
 job no: 3789.16
 drawn by: GJK
 reviewed by: GJK
 file: 18025-F-BLDG
 issue history:

**PARTIAL BUILDING
 PLAN H - ROOF
 FIRE PROTECTION
 PLAN**

1770 fennell street
 maitland florida 32751-7208
 407.660.8900 ; 407.875.5948
 www.cbaarchitects.com

**charlan • brock
 associates**
 architects • planners

**Lyric at Norton Commons
 Prospect, Kentucky**
 Bristol Development Group
 381 Mallory Station Rd, Suite 204
 Franklin, TN 37067

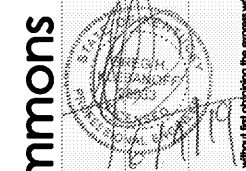

**MiGre
 Engineers LLC**

780 FLORIDA CENTRAL PARKWAY
 SUITE 224
 LONGWOOD, FL 32750
 PH: 407.336.7999
 PROJECT #: 18025

Common North, Prospect, KY



Architect: MiGre
 Charlan Brock & Associates, A4000796

Charlan Brock & Associates, Inc. hereby reserves all copyright and other rights in these plans, ideas, and designs. These plans, ideas, and designs are not to be reproduced, changed or copied in any form or manner whatsoever, nor are they to be assigned to any third party, without first obtaining the express written permission from C.B.A., Inc. All dimensions and floor plan dimensions are shown in inches unless otherwise specified. The plans and specifications comply with the applicable minimum building codes and the applicable regulatory jurisdiction.

MiGre Engineers, LLC - 18025-F-BLDG.dwg - P1.dwg - Plot Date: Thursday, June 06, 2019 10:58:11 AM