

Miller Engineers, LLC - 18025-P-BLDG - P-15H - Partial Building Plan, June 04, 2019 by William Douglas

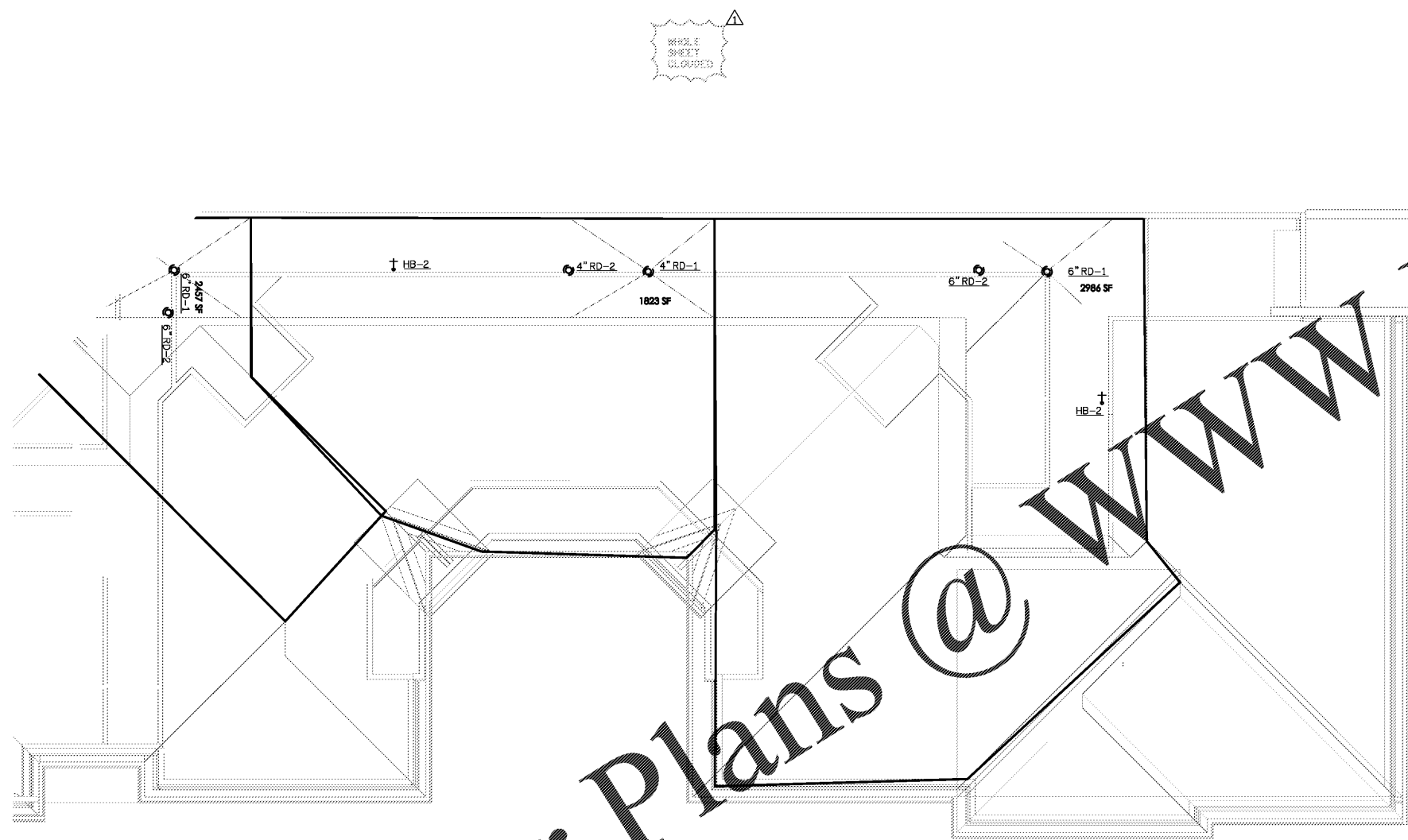

REPLACE SHEET  
UNGROUPED

**1 PARTIAL BUILDING PLAN H - (05) ROOF - PLUMBING PLAN**  
SCALE 1/8" = 1'-0"

18025-P-BLDG

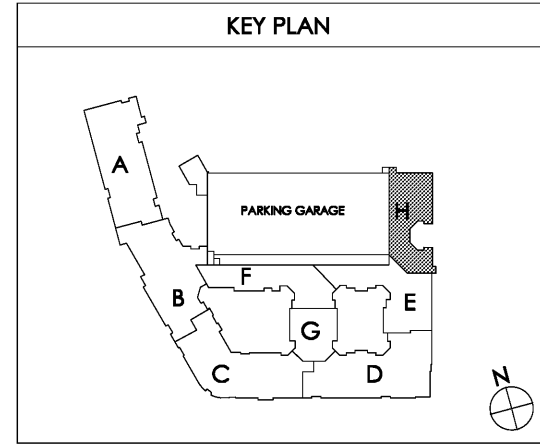

**P1.15H**

date: 06-04-2019  
job no: 3789.16  
drawn by: GNIK  
reviewed by: GNIK  
file: 18025-P-BLDG  
issue history:  
07-03-2019

**PARTIAL BUILDING**  
**PLAN H - ROOF**  
**PLUMBING**  
**PLAN**

1770 fennell street  
maitland florida 32751-7208  
407.660.8900 ; 407.875.5948  
www.cbaarchitects.com

**charlan • brock**  
**associates**  
architects • planners

Bristol Development Group  
381 Mallory Station Rd, Suite 204  
Franklin, TN 37067

**Lyric at Norton Commons**  
**Prospect, Kentucky**

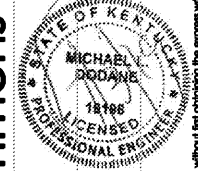

**MiGre**  
Engineers LLC

780 FLORIDA CENTRAL PARKWAY  
SUITE 224  
LONGWOOD, FL 32750  
PH: 407.336.7999  
PROJECT #: 18025

Common North, Prospect, KY



Architect/Engineer  
Charlan Brock & Associates, A4000796

Order Plans @ www.LDILine.com  
This drawing, including its contents, is copyright and other rights reserved by the copyright owner. It is to be used only for the project and location specified. Any other use, reproduction, or distribution without the express written permission from C.B.A., Inc. will result in legal action. All dimensions are in feet unless otherwise noted.