

Order Plans @ [www.dline.com](http://www.dline.com)

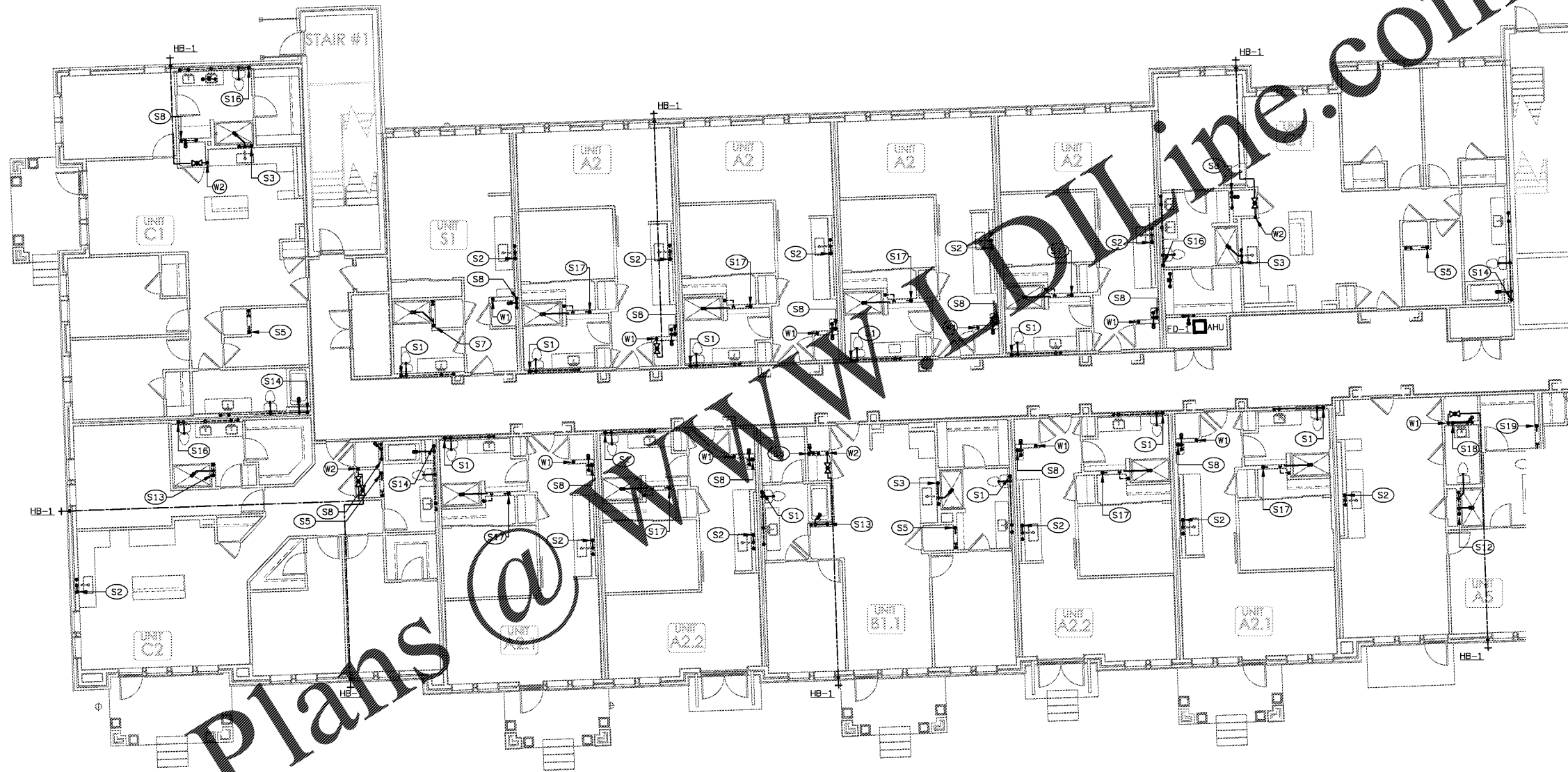

**1 PARTIAL BUILDING PLAN A - (00) BASEMENT - PLUMBING PLAN**  
 SCALE: 1/8" = 1'-0" 18025-P-BLDG

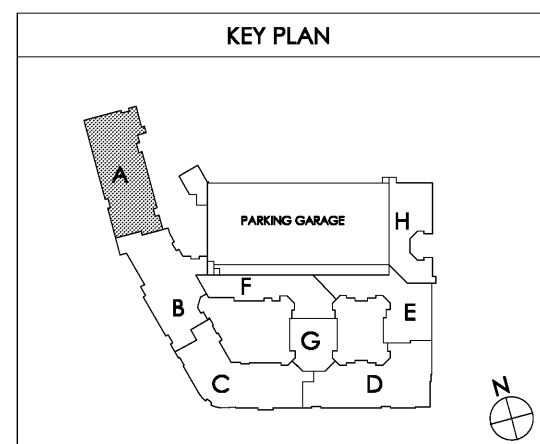

Common North, Prospect, KY  
 KY  
 KY

**MiGre**  
 Engineers LLC

780 FLORIDA CENTRAL PARKWAY  
 SUITE 224  
 LONGWOOD, FL 32750  
 PH: 407.338.7999  
 PROJECT #: 18025

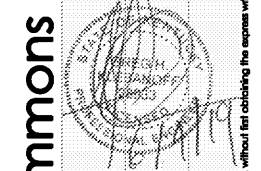

Lyric at Norton Commons  
 Prospect, Kentucky

Bristol Development Group  
 381 Mallory Station Rd, Suite 204  
 Franklin, TN 37067

**charlan • brock**  
 associates

architects • planners  
 1770 fennell street  
 maitland florida 32751-7208  
 407.660.8900 • 407.875.5948  
 www.cbaarchitects.com

PARTIAL BUILDING  
 PLAN A - BASEMENT  
 PLUMBING  
 PLAN

date: 06-04-2019  
 job no: 3789.16  
 drawn by: GNIK  
 reviewed by: GNIK  
 file: 18025-P-BLDG  
 issue history:

**P1.10A**

charlan • brock associates, Inc. hereby reserves all copyright, trademark, and other rights in these plans, ideas, and designs. These plans, ideas, and designs are the property of charlan • brock associates, Inc. and shall remain the property of charlan • brock associates, Inc. without dimensions and have precedence over text dimensions.