

① ROOF PARTIAL FRAMING PLAN E

SCALE: 1/8" = 1'-0"

LEGEND

| | |
|--|--|
| | LOAD BEARING WALL, REFER TO SCHEDULE FOR PACING INFORMATION |
| | ROOF TRUSS |
| | GIRDER TRUSS |
| | LOAD BEARING HEADER, REFER TO HEADER SCHEDULE FOR SPACE UNLESS NOTED OTHERWISE |

ROOF NOTES

- ALL TRUSSES SHALL BE DESIGNED AND CERTIFIED BY TRUSS MANUFACTURER'S REGISTERED ENGINEER
- ALL HANGERS AND ANCHORS SHALL BE SPECIFIED BY A REGISTERED ENGINEER
- TRUSS MANUFACTURER SHALL VERIFY ALL DIMENSIONS AND SUBMIT SHOP DRAWINGS TO ARCHITECT FOR APPROVAL
- TRUSS MANUFACTURER TO PROVIDE ALL GABLE END TRUSSES WITH INTERMEDIATE STUD MEMBERS @ 16" O.C.
- TRUSS MANUFACTURER TO PROVIDE INTERMEDIATE STUD MEMBERS AT TRUSSES ON EACH SIDE OF CONDENSER'S CUTOUT
- TRUSS MANUFACTURER TO INCLUDE A 200LB SURCHARGE PER CONDENSER UNIT TO THE ROOF TRUSSES SUPPORTING THE UNITS AND PROVIDE 2X6 BLOCKING BETWEEN TRUSSES
- PROVIDE TWO LAYERS OF ROOF SHEATHING AT ALL FLAT TOP CHORD TRUSSES. ADHERE PLYWOOD ON A CRIS-CROSS PATTERN. REFER TO SDT-4 FOR NAILING PATTERN
- CONTRACTOR TO COORDINATE ATTIC ACCESS DOOR LOCATION AND TRUSS LAYOUT / SPACING WITH THE TRUSS MANUFACTURER
- PROVIDE ROOF VENTING AS REQUIRED
- TRUSS MANUFACTURER TO VERIFY DESIGN CALCULATION AND LOCATION OF BEAMS AND TRUSSES
- REFER TO SHEET SDT-4 FOR NAILING PATTERN FOR ROOF SHEATHING
- TRUSS MANUFACTURER MUST COORDINATE TRUSS LAYOUT WITH MECHANICAL/PLUMBING DRAWINGS TO ENSURE ALL DUCT/PLUMBING WORK PASSES BETWEEN FLOOR JOISTS
- ATTENTION FRAMING CONTRACTOR: PRIOR TO ADHERING DECKING TO ENGINEERED TRUSS SYSTEM, ENSURE THAT ALL MECHANICAL / PLUMBING RUNS HAVE SUFFICIENT CLEARANCE. DO NOT CUT OR PENETRATE TOP OR BOTTOM TRUSS CHORD MEMBERS WITHOUT WRITTEN AUTHORIZATION FROM THE ENGINEER OF RECORD.

ROOF FRAMING KEYNOTES

| | |
|----|--|
| 8 | PRESSURE TREATED 4x6 COLUMN POST OR (4) 2x6 P.T. STUDS W/ HD-38 HOLD DOWN FOR EXTERIOR WALLS AND BALCONIES. PRESSURE TREATED COLUMNS ARE NOT REQUIRED IN INTERIOR CONDITIONS. USE CB-66 OR HD-38 CONNECTION AT BASE. |
| 9 | (3) 2x12 P.T. WITH (2) 1/2" PLYWOOD FLITCH. ALL BEAM SIZES TO BE VERIFIED BY TRUSS MANUFACTURER. |
| 10 | (2) 2X12 P.T. WITH (2) 1/2" PLYWOOD FLITCH. ALL BEAM SIZES TO BE VERIFIED BY TRUSS MANUFACTURER. |
| 14 | 3-1/2" x 18" LVL OR FLOOR TRUSS GIRDER (UPTURNED BEAM) SIZES TO BE VERIFIED BY TRUSS MANUFACTURER. |
| 15 | CONCRETE LINTEL. REFER TO SCHEDULE ON SDT SHEETS |
| 16 | (2) 2X12 LEDGER BEAM W/ (2) 1/2" DIAMETER x 7" WEDGE ANCHORS @ 16" O.C. SET ANCHORS 2" MINIMUM FROM TOP AND BOTTOM OF BEAM. 3" MINIMUM EMBED INTO CMU. |
| 6 | PRESSURE TREATED 4x4 COLUMN POST OR (3) 2x4 P.T. STUDS W/ HD-38 HOLD DOWN FOR EXTERIOR WALLS AND BALCONIES ONLY. P.T. COLUMNS AND HOLDDOWNS ARE NOT REQUIRED IN INTERIOR CONDITIONS AT BALCONY AND STAIR. |
| 7 | PRESSURE TREATED 4x6 COLUMN POST OR (4) 2x6 P.T. STUDS W/ HD-38 HOLD DOWN FOR EXTERIOR WALLS AND BALCONIES. PRESSURE TREATED COLUMNS ARE NOT REQUIRED IN INTERIOR CONDITIONS. USE CB-66 OR HD-38 CONNECTION AT BASE. |

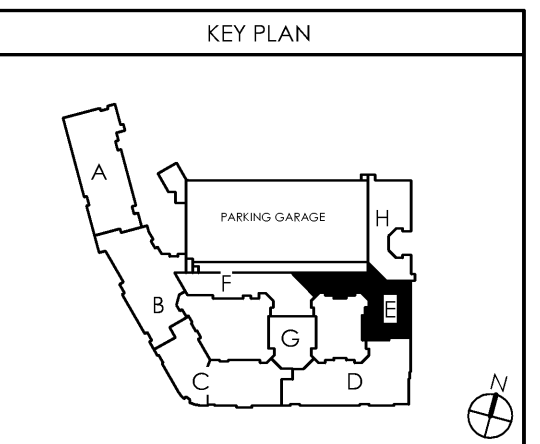

date: 06-04-2019
 job no: 3789.15
 drawn by: COOL
 reviewed by: CBA
 issue history:
 Δ Date
 1 7-3-2019

REV: 07-03-2019

S1.15E

Lyric at Norton Commons
 Prospect, Kentucky
 Bristol Development Group
 881 Malloy Station Rd, Suite 204
 Franklin, TN 37067

charlan • brock associates
 architects • planners
 1770 fennell street
 maitland florida 32751-7208
 407.660.8900 | f:407.875.9948
 www.cbarchitects.com

NALIN H. JOSHI, P.E.
 4321 MAYWOOD DRIVE
 JACKSONVILLE, FL 32277
 NALINJATSHREE@AOL.COM
 (904) 744-6133

Common North Prospect, KY

 Bulch L. Charlton, AIA
 Charlan Brock & Associates
 Charlan Brock & Associates shall have precedence over scale dimensions.