

1 ROOF PARTIAL FRAMING PLAN B

SCALE: 1/8" = 1'-0"

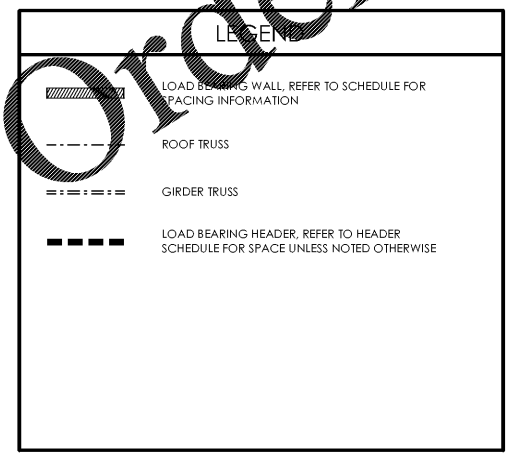

- ROOF NOTES**
1. ALL TRUSSES SHALL BE DESIGNED AND CERTIFIED BY TRUSS MANUFACTURER'S REGISTERED ENGINEER
 2. ALL HANGERS AND ANCHORS SHALL BE SPECIFIED BY A REGISTERED ENGINEER
 3. TRUSS MANUFACTURER SHALL VERIFY ALL DIMENSIONS AND SUBMIT SHOP DRAWINGS TO ARCHITECT FOR APPROVAL
 4. TRUSS MANUFACTURER TO PROVIDE ALL GABLE END TRUSSES WITH INTERMEDIATE STUD MEMBERS @ 16" O.C.
 5. TRUSS MANUFACTURER TO PROVIDE INTERMEDIATE STUD MEMBERS AT TRUSSES ON EACH SIDE OF CONDENSER'S CUTOUT
 6. TRUSS MANUFACTURER TO INCLUDE A 200LB SURCHARGE PER CONDENSER UNIT TO THE ROOF TRUSSES SUPPORTING THE UNITS AND PROVIDE 2X6 BLOCKING BETWEEN TRUSSES
 7. PROVIDE TWO LAYERS OF ROOF SHEATHING AT ALL FLAT TOP CHORD TRUSSES. ADHERE PLYWOOD ON A CRIS-CROSS PATTERN. REFER TO SDT-4 FOR NAILING PATTERN
 8. CONTRACTOR TO COORDINATE ATTIC ACCESS DOOR LOCATION AND TRUSS LAYOUT / SPACING WITH THE TRUSS MANUFACTURER
 9. PROVIDE ROOF VENTING AS REQUIRED
 10. TRUSS MANUFACTURER TO VERIFY DESIGN CALCULATION AND LOCATION OF BEAMS AND TRUSSES
 11. REFER TO SHEET SDT-4 FOR NAILING PATTERN FOR ROOF SHEATHING
 12. TRUSS MANUFACTURER MUST COORDINATE TRUSS LAYOUT WITH MECHANICAL/PLUMBING DRAWINGS TO ENSURE ALL DUCT/PLUMBING WORK PASSES BETWEEN FLOOR JOISTS
 13. ATTENTION FRAMING CONTRACTOR: PRIOR TO ADHERING DECKING TO ENGINEERED TRUSS SYSTEM, ENSURE THAT ALL MECHANICAL / PLUMBING RUNS HAVE SUFFICIENT CLEARANCE. DO NOT CUT OR PENETRATE TOP OR BOTTOM TRUSS CHORD MEMBERS WITHOUT WRITTEN AUTHORIZATION FROM THE ENGINEER OF RECORD.

- ROOF FRAMING KEYNOTES**
- 6 PRESSURE TREATED 4x4 COLUMN POST OR (3) 2x4 P.T. STUDS W/ HD-38 HOLD DOWN FOR EXTERIOR WALLS AND BALCONIES ONLY. P.T. COLUMNS AND HOLDDOWNS ARE NOT REQUIRED IN INTERIOR
 - 7 PRESSURE TREATED 4x6 COLUMN POST OR (4) 2x6 P.T. STUDS W/ HD-38 HOLD DOWN FOR EXTERIOR WALLS AND BALCONIES. PRESSURE TREATED COLUMNS ARE NOT REQUIRED IN INTERIOR CONDITIONS. USE CB-66 OR HD-38 CONNECTION AT BASE.
 - 8 PRESSURE TREATED 6x6 COLUMN POST OR (4) 2x6 P.T. STUDS W/ HD-38 HOLD DOWN FOR EXTERIOR WALLS AND BALCONIES. PRESSURE TREATED COLUMNS ARE NOT REQUIRED IN INTERIOR CONDITIONS. USE CB-66 OR HD-38 CONNECTION AT BASE.
 - 9 (3) 2x12 P.T. WITH (2) 1/2" PLYWOOD FLITCH. ALL BEAM SIZES TO BE VERIFIED BY TRUSS MANUFACTURER.
 - 10 (2) 2X12 P.T. WITH (2) 1/2" PLYWOOD FLITCH. ALL BEAM SIZES TO BE VERIFIED BY TRUSS MANUFACTURER.
 - 14 3-1/2" x 18" LVL OR FLOOR TRUSS GIRDER (UPTURNED BEAM) SIZES TO BE VERIFIED BY TRUSS MANUFACTURER.
 - 15 CONCRETE LINTEL. REFER TO SCHEDULE ON SDT SHEETS
 - 16 (2) 2X12 LEDGER BEAM W/ (2) 1/2" DIAMETER x 7" WEDGE ANCHORS @ 16" O.C. SET ANCHORS 2" MINIMUM FROM TOP AND BOTTOM OF BEAM. 3" MINIMUM EMBED INTO CMU.

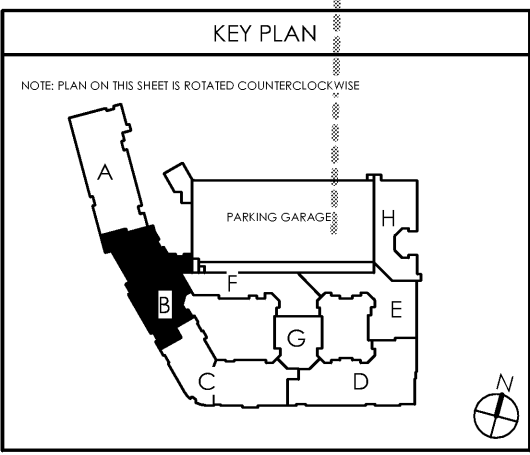

date: 06-04-2019
 job no: 3789.15
 drawn by: COOL
 reviewed by: CBA
 issue history:
 Δ Date
 1 7-3-2019

REV: 07-03-2019

S1.15B

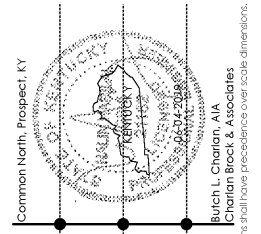

NALIN H. JOSHI, P.E.
 4321 MAYWOOD DRIVE
 JACKSONVILLE, FL 32277
 NALINJ@SHREE@AOL.COM
 (904) 744-6133

Lyric at Norton Commons
 Prospect, Kentucky
 Bristol Development Group
 881 Malloy Station Rd, Suite 204
 Franklin, TN 37067

charlan • brock
 associates
 architects • planners
 1770 fennell street
 maitland florida 32751-7208
 407.660.8900 f:407.875.9948
 www.cbarchitects.com

ROOF FRAMING
 PLAN

Bulch L. Charlton, AIA
 Charlan Brock & Associates
 Charlan Brock & Associates shall have precedence over scale dimensions.