

PARTIAL FOUNDATION PLAN

SCALE: 1/8" = 1'-0"

BOTTOM OF FOUNDATION HAS BEEN ADDED AT RETAINING WALLS CONDITIONS. FOR ELEVATIONS NOT IDENTIFIED, FOUNDATION IS AT GRADE AND SHALL BE BY DETAIL REFERENCED

FOOTING DESIGN		
MARK	SIZE	REINFORCEMENT
⊕	30' X 30' X 30"	3 #5 EACH WAY
⊕	30' X 30' X 30"	3 #5 EACH WAY
⊕	48' X 48' X 24"	4 #5 EACH WAY
⊕	48' X 48' X 24"	5 #5 EACH WAY
⊕	60' X 60' X 24"	6 #5 EACH WAY

NOTE: ALL TOP OF FOOTING ON SLOPED PORTION OF SLAB TO BE 8" FROM TOP OF SLAB ALL STEEL FOOTING TO BE MIN. 4" FROM T.O. SLAB

FOUNDATIONS NOTES									
1	CONC. REINFORC. ON GRADE W/ 10 MIL POLY BARRIER ON CLEAN COMPACTED FILL, 95% DENSITY	2	RECESSED SLAB FOR CONCRETE PAVER SYSTEM IN SAND BED	3	PRESSURE TREATED 4x4 COLUMN POST OR (3) 2x4 P.T. STUDS W/ HD-38 HOLD DOWN FOR EXTERIOR WALLS AND BALCONIES. P.T. COLUMNS AND HOLD DOWNS ARE NOT REQUIRED IN INTERIOR CONDITIONS AT BALCONY AND STAIR.	4	PRESSURE TREATED 4x6 COLUMN POST OR (4) 2x6 P.T. STUDS W/ HD-38 HOLD DOWN FOR EXTERIOR WALLS AND BALCONIES. P.T. COLUMNS ARE NOT REQUIRED IN INTERIOR CONDITIONS. USE CB-66 OR HD-38 CONNECTION AT BASE.	5	PRESSURE TREATED 6x6 COLUMN POST OR (4) 2x6 P.T. STUDS W/ HD-38 HOLD DOWN FOR EXTERIOR WALLS AND BALCONIES. P.T. COLUMNS ARE NOT REQUIRED IN INTERIOR CONDITIONS. USE CB-66 OR HD-38 CONNECTION AT BASE.

SHEARWALL SCHEDULE							
MARK	APPROX. LENGTH	MATERIALS	FOUNDATION TO 2ND FLOOR	2ND TO 3RD/ 3RD TO 4TH	4TH FLOOR TO ROOF	INTERMEDIATE FASTENER	HOLD DOWNS
SW-1	+/- 20'-0"	7/16" O.S.B. @ EXT. WALLS	8d NAILS @ 3" O.C. @ ALL PANEL EDGES, 675 LB/LF	8d NAILS @ 4" O.C. W/BLOCK @ ALL PANEL EDGES, 425 LB/LF	8d NAILS @ 4" O.C. W/BLOCK @ ALL PANEL EDGES, 425 LB/LF	8d NAILS @ 6" O.C.	1/2" A.B. W/HD-58 @ EA. END
SW-2	+/- 12'-0"		8d NAILS @ 3" O.C. @ ALL PANEL EDGES, 675 LB/LF	8d NAILS @ 4" O.C. W/BLOCK @ ALL PANEL EDGES, 425 LB/LF	8d NAILS @ 4" O.C. W/BLOCK @ ALL PANEL EDGES, 425 LB/LF	8d NAILS @ 6" O.C.	1/2" A.B. W/HD-58 @ EA. END
SW-3	SW-3		8d NAILS @ 3" O.C. @ ALL PANEL EDGES, 675 LB/LF	8d NAILS @ 4" O.C. W/BLOCK @ ALL PANEL EDGES, 425 LB/LF	8d NAILS @ 4" O.C. W/BLOCK @ ALL PANEL EDGES, 425 LB/LF	8d NAILS @ 6" O.C.	1/2" A.B. W/HD-58 @ EA. END
SW-4	+/- 12'-0"	5/8 GYP. BOARD	NO. 6 BUGLE HEAD DRYWALL SCREWS @ 3" O.C. @ ALL PANEL EDGES, 675 LB/LF	NO. 6 BUGLE HEAD DRYWALL SCREWS @ 4" O.C. @ ALL PANEL EDGES, 425 LB/LF	NO. 6 BUGLE HEAD DRYWALL SCREWS @ 4" O.C. @ ALL PANEL EDGES, 425 LB/LF	NO. 6 DRYWALL SCREWS @ 6" O.C.	1/2" A.B. W/HD-58 @ EA. END
SW-5	+/- 16'-0"		NO. 6 BUGLE HEAD DRYWALL SCREWS @ 3" O.C. @ ALL PANEL EDGES, 675 LB/LF	NO. 6 BUGLE HEAD DRYWALL SCREWS @ 4" O.C. @ ALL PANEL EDGES, 425 LB/LF	NO. 6 BUGLE HEAD DRYWALL SCREWS @ 4" O.C. @ ALL PANEL EDGES, 425 LB/LF	NO. 6 DRYWALL SCREWS @ 6" O.C.	1/2" A.B. W/HD-58 @ EA. END
SW-6	+/- 20'-0"		NO. 6 BUGLE HEAD DRYWALL SCREWS @ 3" O.C. @ ALL PANEL EDGES, 675 LB/LF	NO. 6 BUGLE HEAD DRYWALL SCREWS @ 4" O.C. @ ALL PANEL EDGES, 425 LB/LF	NO. 6 BUGLE HEAD DRYWALL SCREWS @ 4" O.C. @ ALL PANEL EDGES, 425 LB/LF	NO. 6 DRYWALL SCREWS @ 6" O.C.	1/2" A.B. W/HD-58 @ EA. END
SW-7	SW-7		NO. 6 BUGLE HEAD DRYWALL SCREWS @ 3" O.C. @ ALL PANEL EDGES, 675 LB/LF	NO. 6 BUGLE HEAD DRYWALL SCREWS @ 4" O.C. @ ALL PANEL EDGES, 425 LB/LF	NO. 6 BUGLE HEAD DRYWALL SCREWS @ 4" O.C. @ ALL PANEL EDGES, 425 LB/LF	NO. 6 DRYWALL SCREWS @ 6" O.C.	1/2" A.B. W/HD-58 @ EA. END

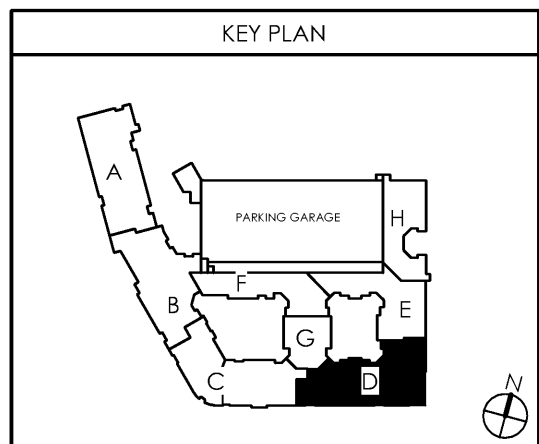

date: 06-04-2019
 job no: 3789.15
 drawn by: COOL
 reviewed by: NHJ
 issue history:
 Δ Date 1-7-3-2019

REV: 07-03-2019

S1.11D

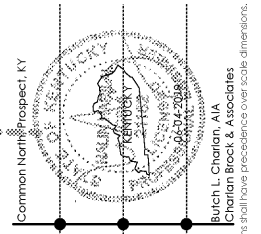

NALIN H. JOSHI, P.E.
 4321 MAYWOOD DRIVE
 JACKSONVILLE, FL 32277
 NALIN@DLINE.COM
 (904) 744-6133

Lyric at Norton Commons
 Prospect, Kentucky
 Bristol Development Group
 881 Malloy Station Rd, Suite 204
 Franklin, TN 37067

charlan • brock associates
 architects • planners
 1770 fennell street
 maitland florida 32751-7208
 407.660.8900 f:407.875.9948
 www.cbarchitects.com

FOUNDATION PLAN